

SCALE 1:200

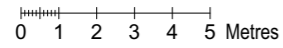

# COMPARISON OF FOOTPRINT (MEASURED EXTERNALLY) AND VOLUME

EXISTING  
BUILDING

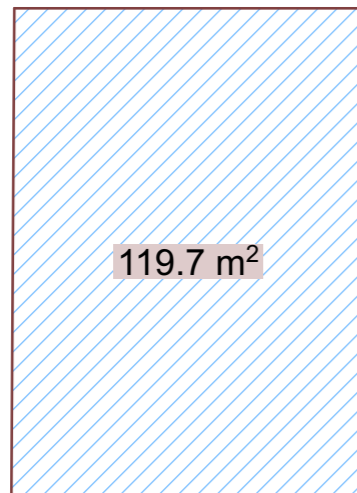

SECTION

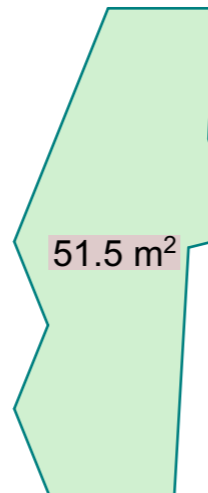

APPROVED  
PRIOR APPROVAL SCHEME  
(23/00456/CUPRIO)

PLAN

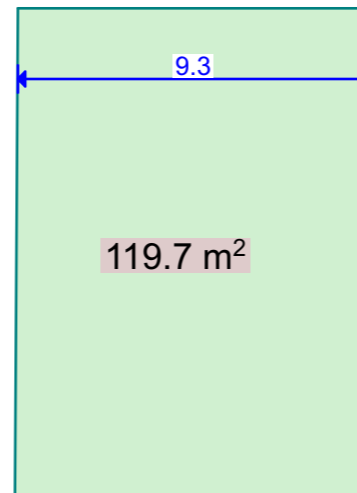

PROPOSED  
DWELLING

SECTION



PLAN

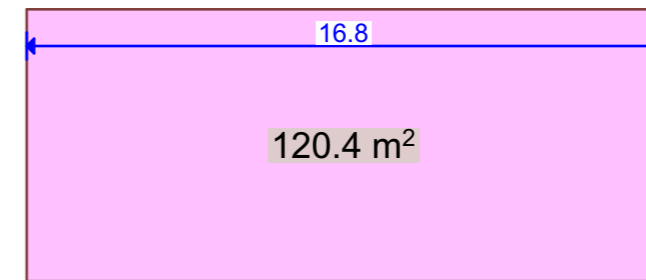

	EXISTING/ APPROVED PRIOR APPROVAL SCHEME	PROPOSED DWELLING
FOOTPRINT	119.7m <sup>2</sup>	120.4m <sup>2</sup>
VOLUME	51.5m <sup>2</sup> x 9.3m = 478.95m <sup>3</sup>	28.1m <sup>2</sup> x 16.8m = 472.8m <sup>3</sup>

**Steve Haskey Design Ltd.**

20 St. John Street  
Bromsgrove  
Worcestershire  
B61 8QY  
TEL: 01527 832587  
E-MAIL: steve@haskey.co.uk

The copyright of this drawing and design is retained by Steve Haskey Design LTD.  
It must not be copied or reproduced without consent in writing.

Sheet SCHEME - Area Comparison

Project Proposed New Dwelling  
The Piggery  
Dusthouse Lane  
Finstall  
Bromsgrove  
B60 3AE  
Client Ann Wheeler-Vine

REVISIONS:  
A- Volume calculations added to drawing.  
GGP 24/11/2023

Drawn By	G.G. Pugh	Drawing Number	22-31-215A	Sheet Size	A3
Date	Oct 2023				