

For external materials and landscaping schedules see drawing no. BSC/01

For full extent of property boundaries see drwg no BSC/01

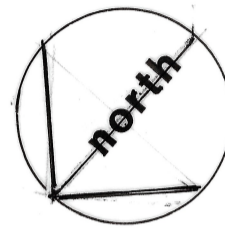
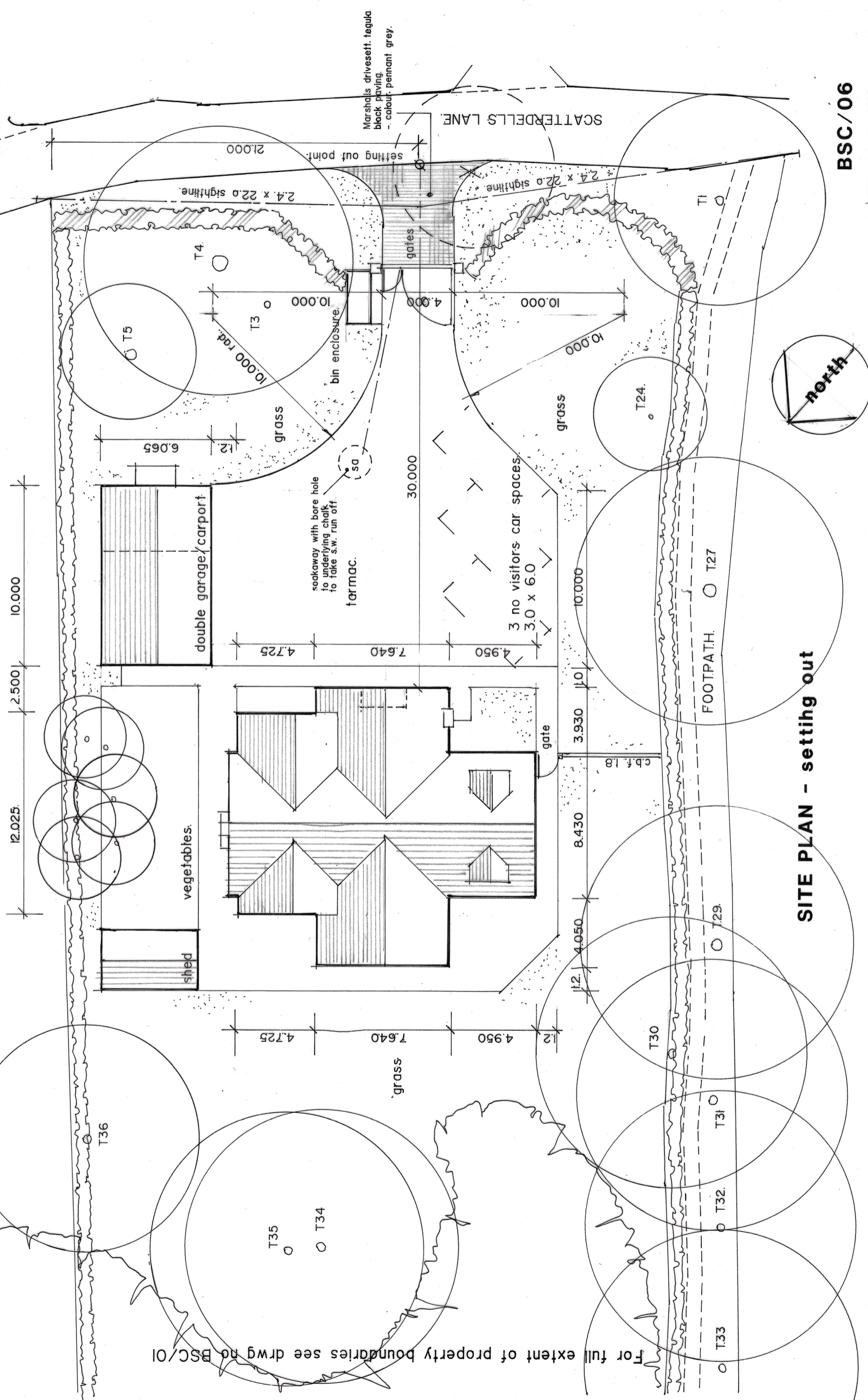

SITE PLAN - setting out

BSC/06

scale: 1/200 date: Nov. 2023 drawn: A.D.

Hazel Croft, 47 Scatterdells Lane, Chipperfield, Kings Langley, Herts, WD4 9EU

A.D.PARTNERSHIP

Tel. 01829 458231

Proposed Re-design of Detached Dwelling approved under application no 21/00209/FUL for Mr & Mrs K Barnes