

- KEY:**
1. Mains operated & interlinked smoke detector.
 - Heat detector.
 - 30 minute fire door.
 - 2 number trimmers to stairs.
 - Clear landing at head & foot of stairs.
 - New roof structure formed with new manufactured loft trusses. Designed & specified by specialist subcontractor.

The existing inner timber frame and structure is to be checked that its structurally adequate to accommodate additional loads.

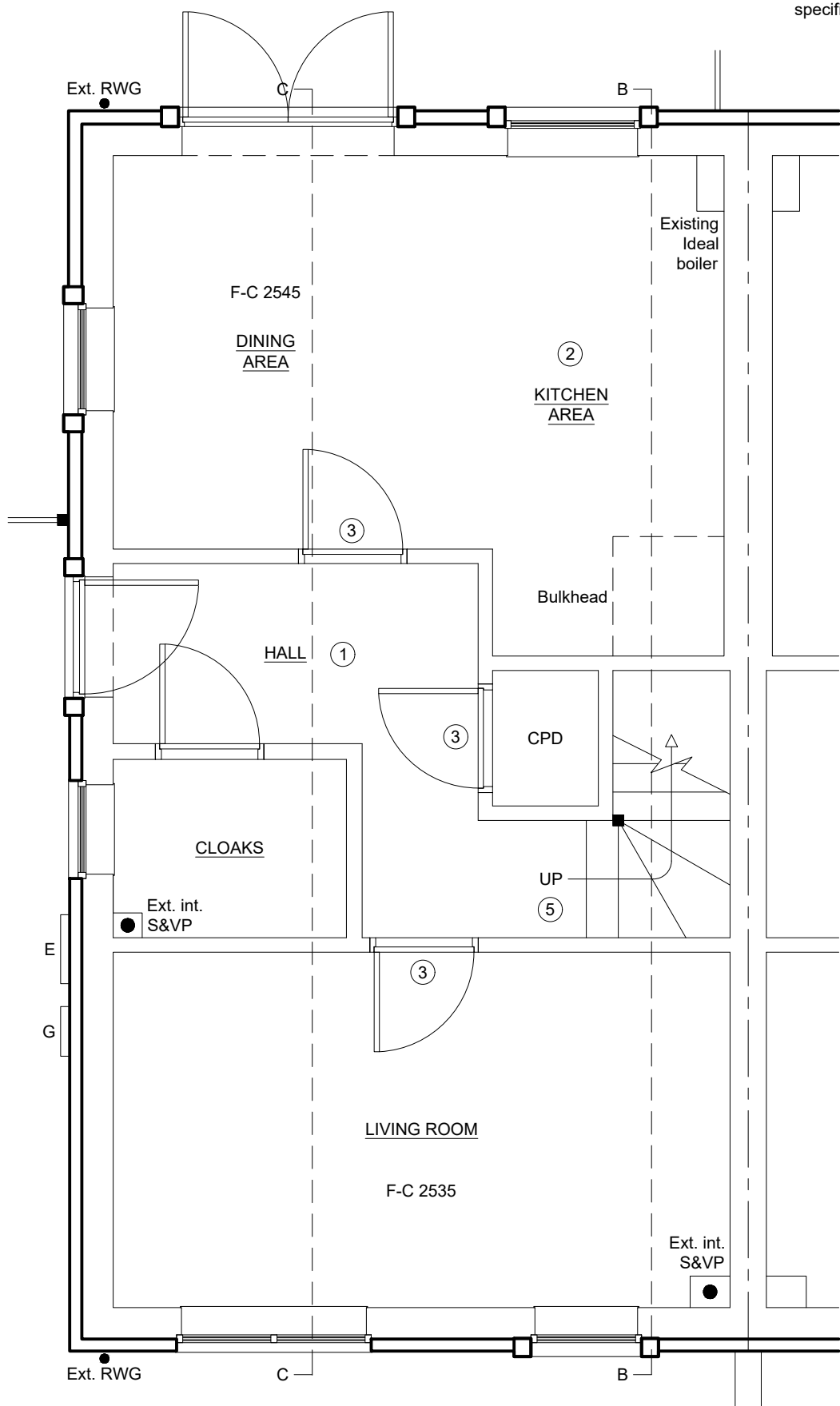

PROPOSED GROUND FLOOR PLAN

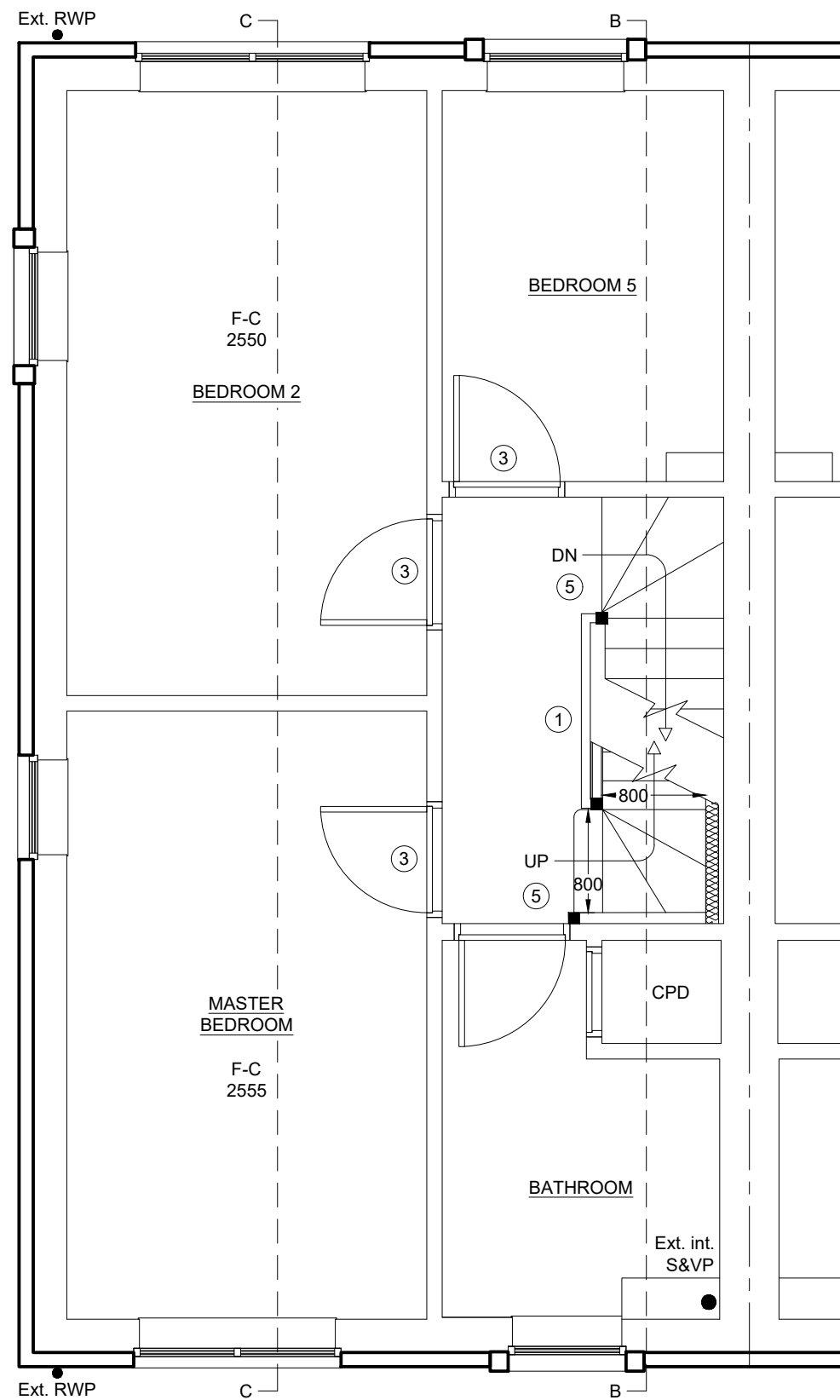

PROPOSED FIRST FLOOR PLAN

NOTE:
CONTRACTOR TO VERIFY ALL SIZES ON SITE BEFORE COMMENCEMENT.

NOTE:
PLEASE DO NOT SCALE FROM THIS DRAWING.

Party Wall Act
Notices under the Party Wall Act are to be served by the building owner or appropriate body appointed by the building owner. For further clarification on the Party Wall etc Act 1996 contact: Cairn Wharf Consultancy Ltd, 2 Boroughgate, Off Bay Horse Court, Otley, LS21 1SB M 07739 576181 cw@cairnwharf.com For further information on the Party Wall etc Act 1996: http://www.communities.gov.uk/documents/planningandbuilding/pdf/133214.pdf

Building Contract
It is recommended that a formal written agreement is put in place between the building owner and the building contractor. A typical agreement that protects both owner and builder would be produced by the JCT. For further information on building contracts contact: Cairn Wharf Consultancy Ltd, 2 Boroughgate, Off Bay Horse Court, Otley, LS21 1SB M 07739 576181 cw@cairnwharf.com

CDM 2015 Regulations
The Construction (Design and Management) Regulations 2015 applies to all construction work. Designers, builders and Clients all have duties under the regulations. For further information on the CDM 2015 Regulations contact: Cairn Wharf Consultancy Ltd, 2 Boroughgate, Off Bay Horse Court, Otley, LS21 1SB M 07739 576181 cw@cairnwharf.com

GENERAL NOTES
Materials to match existing.

These notes do not comprise a full specification. The drawings are for building regulation purposes only and are not working plans. They do not comprise of a complete specification for the whole of the works. Their primary function is to assist the local authority inspector to determine compliance in line with building regulation standards.

Where further clarifications are required contractor shall refer to the client for details and instruction.

All dimensions must be checked by the contractor and any discrepancies noted in writing to MAS Design Consultants Ltd.

All works must be carried out in accordance with current Building Regulations, Codes of Practice and Planning Officers requirements.

All materials must comply with current British Standards in situations used.

REV

www.masdesignconsultants.com
1 Oxford Street, Guiseley, Leeds, LS20 9AX

PROPOSED

EXTENT OF PROJECT:
PROPOSAL: PROPOSED LOFT CONVERSION WITH VELUX WINDOWS; FORMING 2 BEDROOMS / BATHROOM.

CLIENT DETAILS:
MR ROBBINSON.
51 CLIFFE LANE WEST,
BILDON, SHIPLEY.
BD17 5QL.

DRAWING TITLE:
PROPOSED FLOOR PLANS.

PAPER	SCALE	DATE	DRAWING No	REV
A3	1:50	08/23	M4078/04/102	.