

Processing Centre  
Date Received:  
19 OCT 2023

<b>Kerr AT architects</b>		Firthview Offices : Lentrans : Inverness : IV3 8RJ 01463 831 738 : admin@KerrATarchitects.co.uk	
CLIENT		MR MACFADYEN	
PROJECT		OUTBUILDING + HOLIDAY CABINS : LOG HOUSE : LENTRANS : IV3 8RN	
DRAWING TITLE		PROPOSED OUTBUILDING PLAN + SITE SECTION	
DRAWN BY	DATE	SCALE	PROJECT NO.
aT	October 2023	As Stated at A3	657
DO NOT SCALE FROM THIS DRAWING. CONTRACTOR MUST CHECK ALL DIMENSIONS BEFORE COMMENCING WORK. REPORT ANY DISCREPANCIES TO THE ARCHITECTS IMMEDIATELY. COPYRIGHT + REPRODUCTION RESERVED BY Kerr AT architects			DWG. NO.
			04

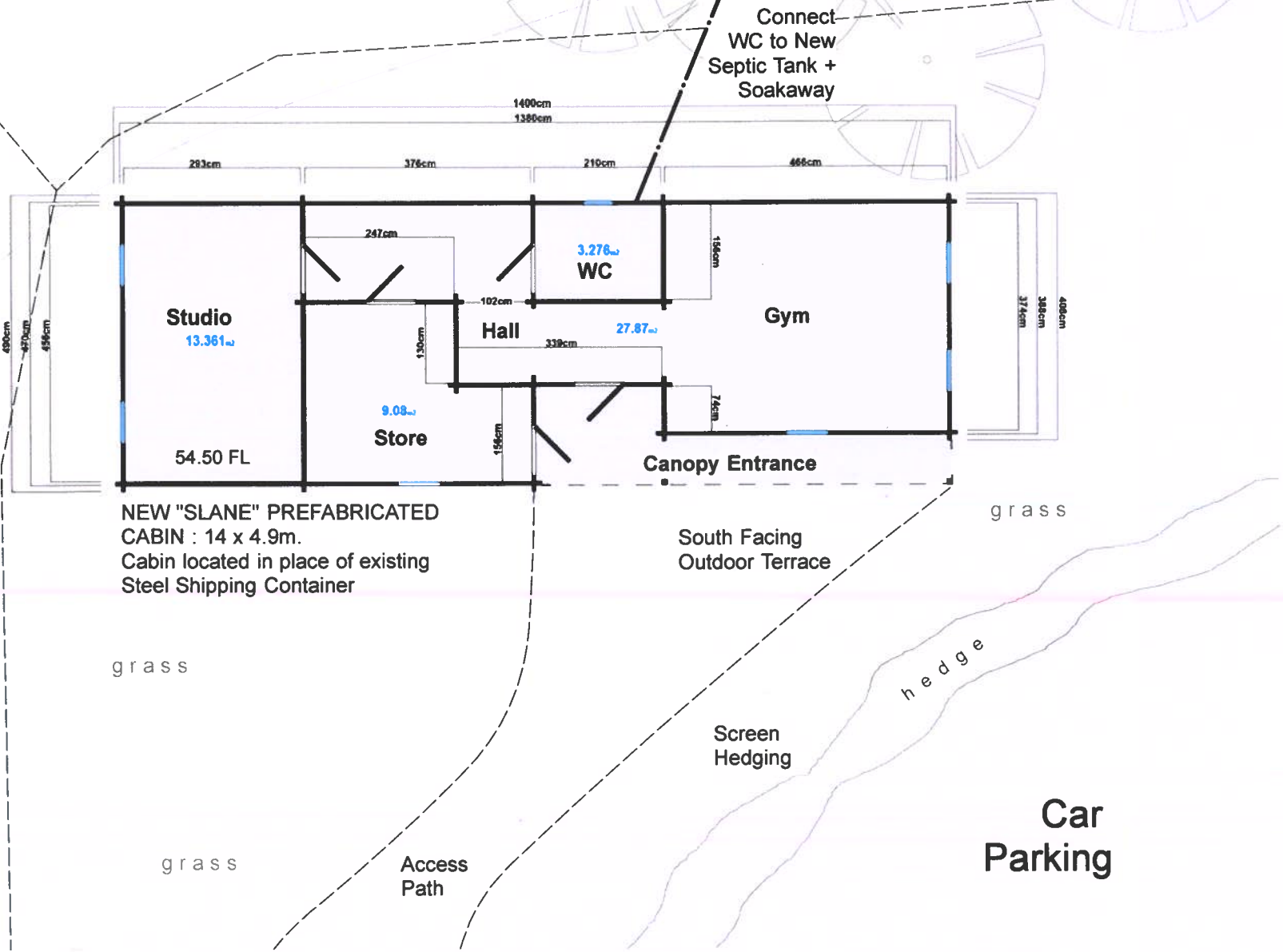

PROPOSED OUTBUILDING / ANCILLARY ACCOMMODATION PLAN

1 : 100

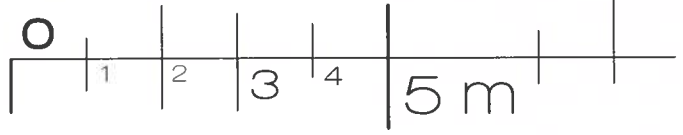

NOTES

- 1 Proposed New Annexe Outbuilding to Log House
- 2 Visitor Car parking on Existing Hardstanding
- 4 No. New Holiday Cabins stepped downhill
- 5 New Sewage Treatment Tanks + Surface Water Soakaways

SITE CROSS SECTION WITH CABINS

1 : 500

