



Do not scale from this drawing. If in doubt, ask. This drawing is the property of Stewart Drawing Services and must not be copied, reproduced or disclosed other than for the purposes of this project.

 LAND REGISTER OF SCOTLAND	Officer's ID / Date	TITLE NUMBER
	6440 12/7/2016	REN139142
ORDNANCE SURVEY NATIONAL GRID REFERENCE 	 70m	
	NS49629E NS60625W	Survey Scale 1/1250

OSMAP Copyright © This copy has been produced from the OS Digital Mapping System on 14/07/2016 with the authority of Ordnance Survey under Section 47 of the Copyright, Designs and Patents Act 1988. Where there is a discrepancy between the OS Digital Mapping System and the original data, the OS Digital Mapping System shall prevail. The OS Digital Mapping System is a registered trademark of Ordnance Survey. OS Services Ltd. 2008411 Ltd.

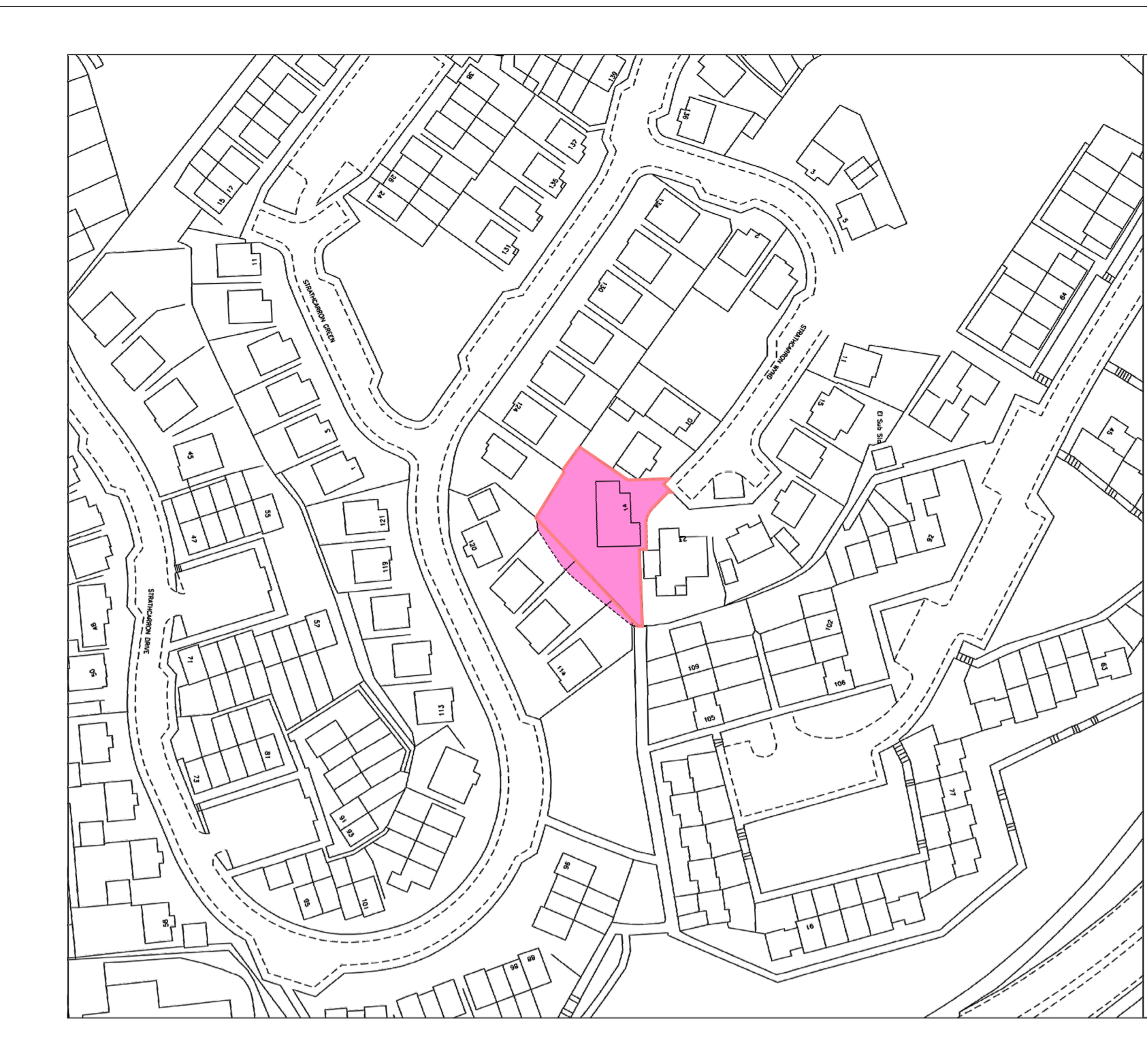

Block Plan as Existing
1:200

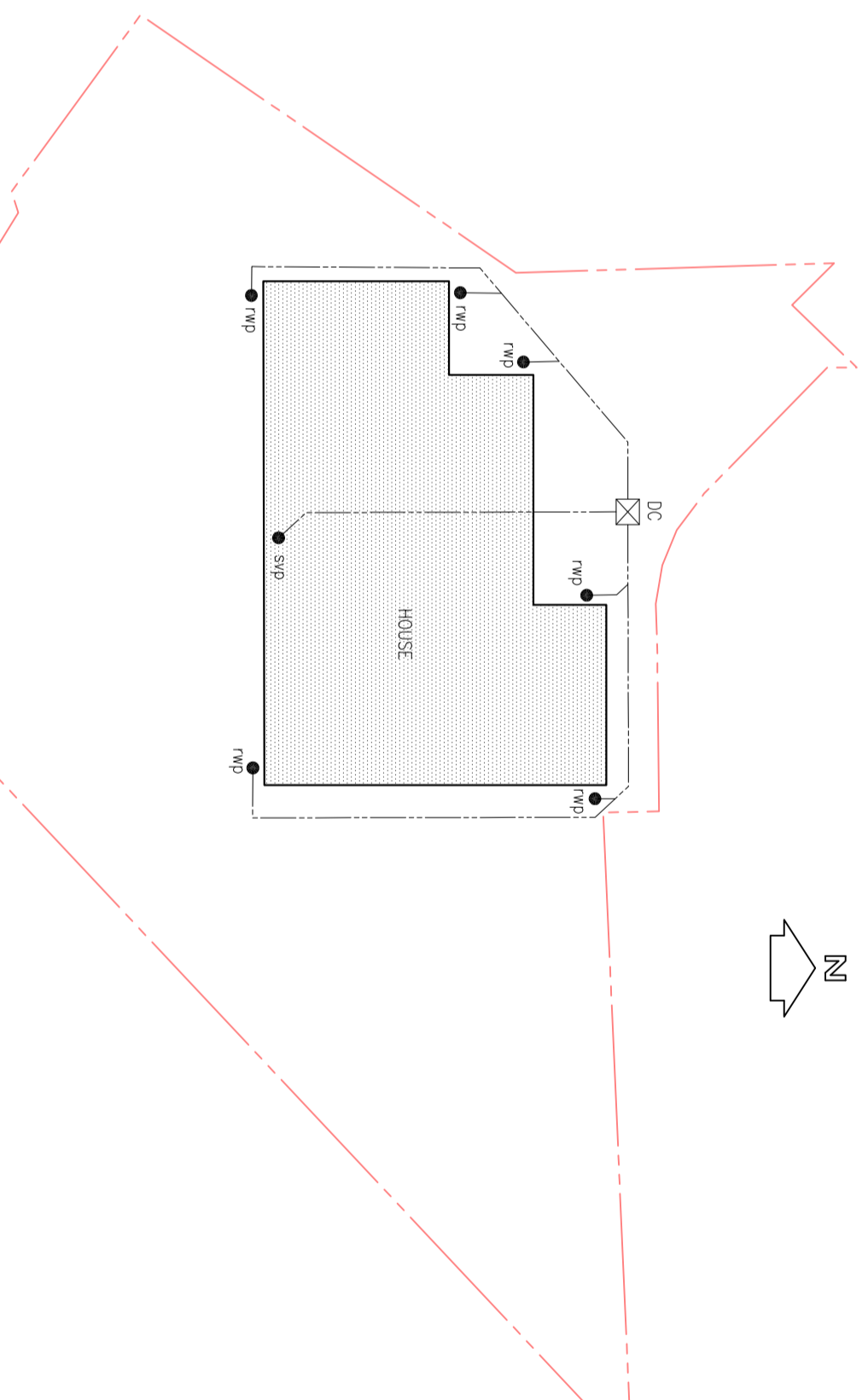

DRAINAGE
Prior to works commencing plumber to investigate on site to confirm existing drainage layout, any alterations to proposed drainage layout to Building Control and client approval. Grab out any redundant underground drainage. Ensure that all underground drainage complies with B.S. EN 752 and be agreed with the responsible Building Control Officer prior to the commencement of any works, and laid and tested to the Council's entire satisfaction. Fit new 100mm deepflow uPVC gutters with deepflow uPVC downpipes and connect into existing surface water drainage, fit rodding eyes at change of direction. Fit vented traps at base of rainwater pipes only if drainage system is combined system. All drainage uncovered in the process of excavation must be fully exposed, supported and encased in 150mm pea gravel. Ensure that foundations are taken below level of any drain that passes below proposed extension.
All new underground drainage to be in 100mm uPVC, bedded and haunched in pea gravel and laid to falls, all to connect into existing. Where waste to be suspended below floor joists, ensure no joists are cut or notched. All drainage passing through external walls and sleeper walls to be linted over and haunched with 150mm pea gravel with rocker joint either side. All wastes to be laid to fall, gradient to be 1 in 80. Above floor drainage to be boxed in at floor level. Allow for access at all bends in drainage.
Pipework from new sinks to be 42mm diameter uPVC, from new RWP's to be 100mm uPVC. Sanitary pipe work should be constructed and installed in accordance with the recommendations in BS EN 12056-2: 2000. All pipework to be installed in accordance with manufacturers instructions. Hot and cold water pipes are to be fully insulated to BS 5422:2009.

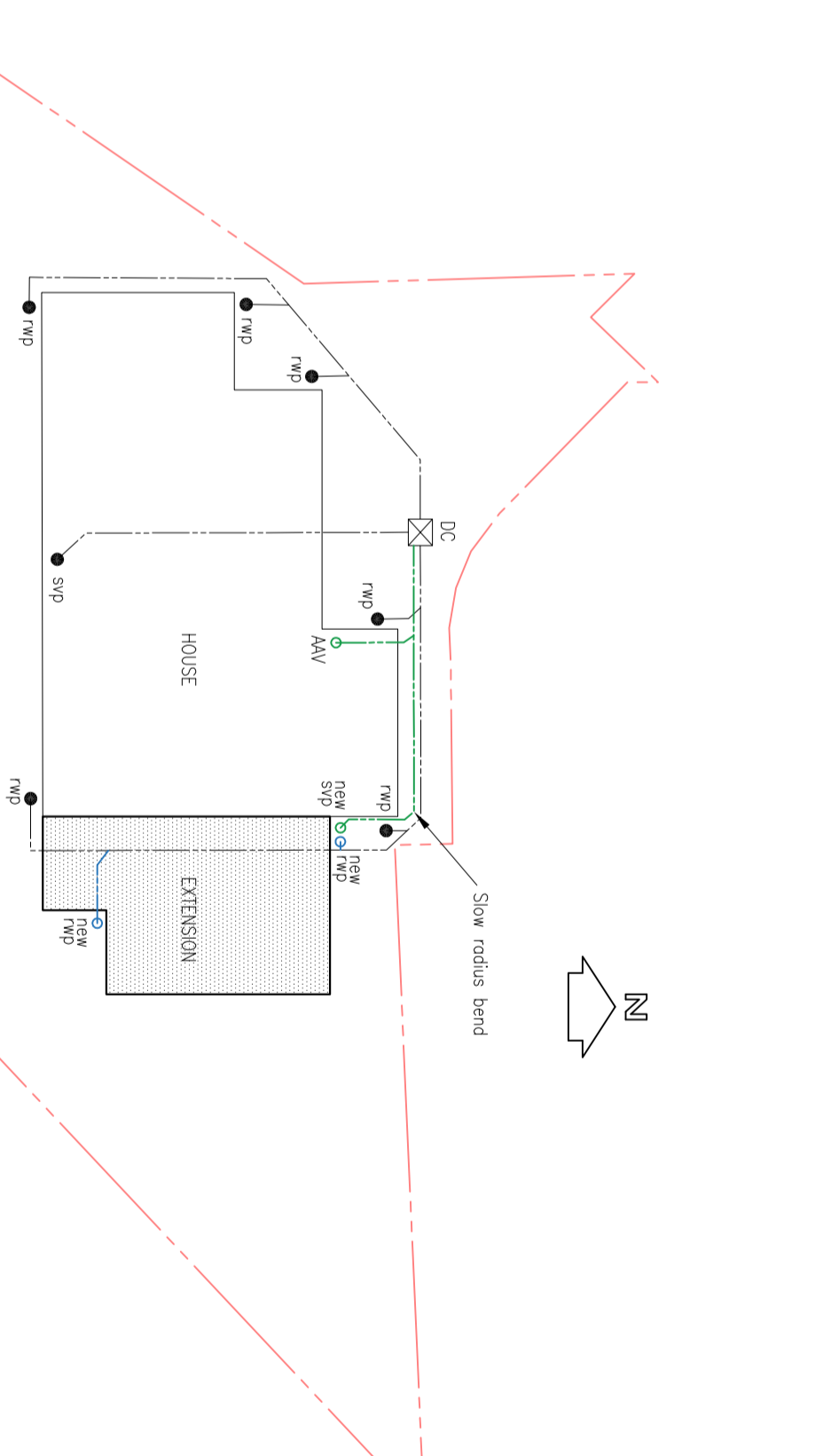

Block Plan as Proposed
1:200

--- Denotes new SW drainage.
--- Denotes new FW drainage.

Rev	Date	Details

Stewart Drawing Services
11 Balmoral Drive
Bearsden
G61 1DH
tel : 07967 613094
email : john@stewardrawing.com

Planning & Building Warrant
Proposed Extension For
Mr & Mrs McGowan
14 Strathcarron Wynd, Paisley PA2 7AU
- Location and Block Plans

Scale	Drawn By
-	A2
Date	Drawing No.
Nov 2023	23042 - 07
	Rev