

hunters

CAMBRIDGE CRESCENT, MAIDSTONE

November 2023

Reserved Matters Application  
Design and Access Statement

golding  homes

# PHASING PLAN

# PHASING PLAN

Existing Site Plan with over proposed phasing overlay

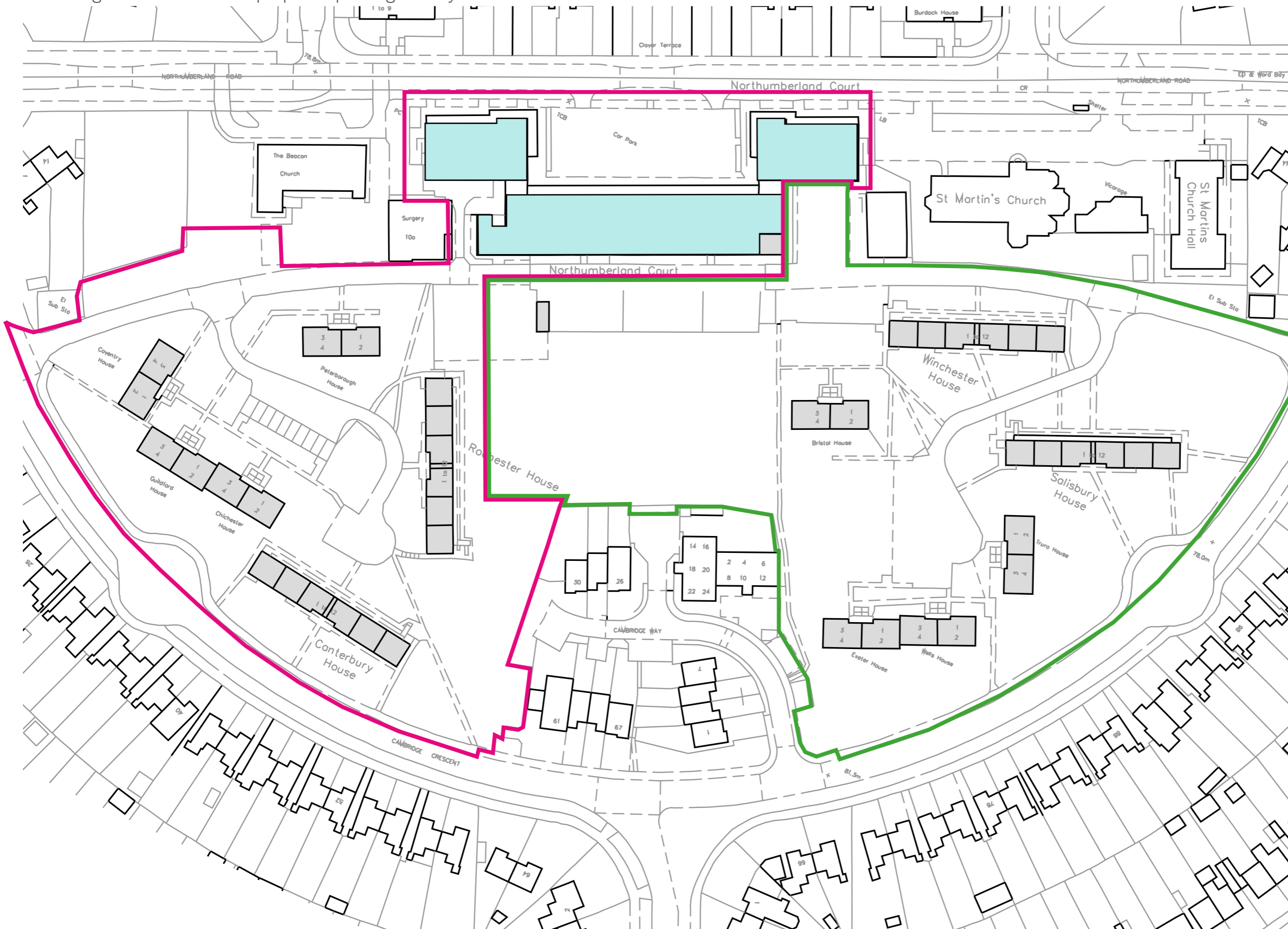

- PHASE 1
- FUTURE PHASES
- Existing Commercial Space

There is circa 1,200m<sup>2</sup> of existing commercial floor space within the retail park.

The proposed phase 1 retains the existing retail park, including the rear servicing road and vehicular access off Cambridge Crescent.

This ensures the local services were maintained throughout the construction of phase 1.

# PHASING PLAN

Proposed phase 1

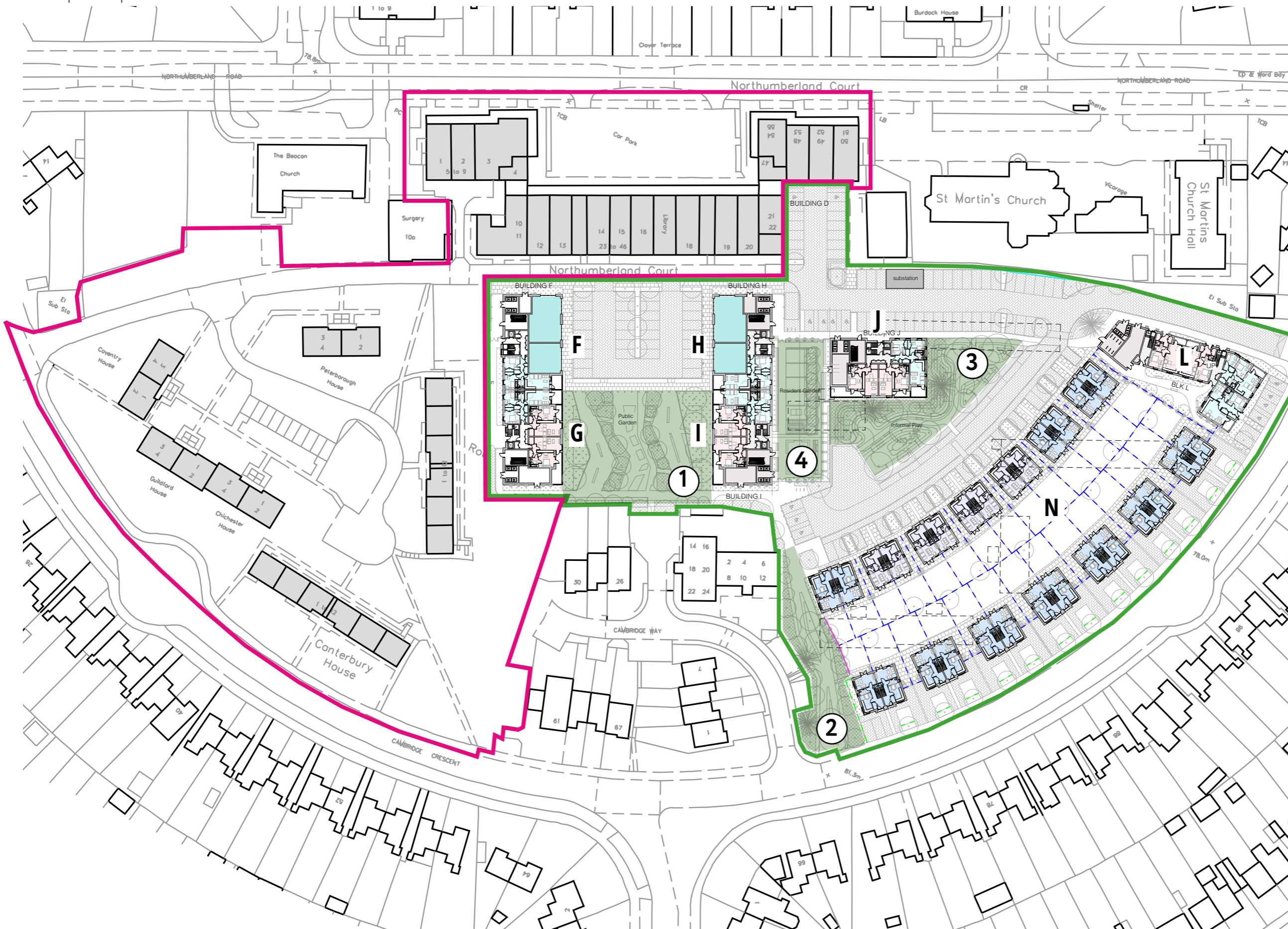

- PHASE 1
- FUTURE PHASES
- Proposed Commercial
- Public Areas/Landscaping

The proposed phase 1 comprises Block F, G, H, I, J, L and N (inclusive of 28 houses).

In total 119 residential units (including 91 apartments and 28 houses) as well as 316m<sup>2</sup> of commercial floor space will be delivered.

The commercial space delivered would facilitate some of the local services to be relocated and retained on site.

In addition, the proposed landscaping and public areas including :

1. "Public Garden Square",
  2. "Linear Green Walkways",
  3. "Eastern Shared Street/ Play Zone",
  4. "Communal Gardens"
- will be delivered as part of the phase 1 development.

# PHASING PLAN

Proposed all phases

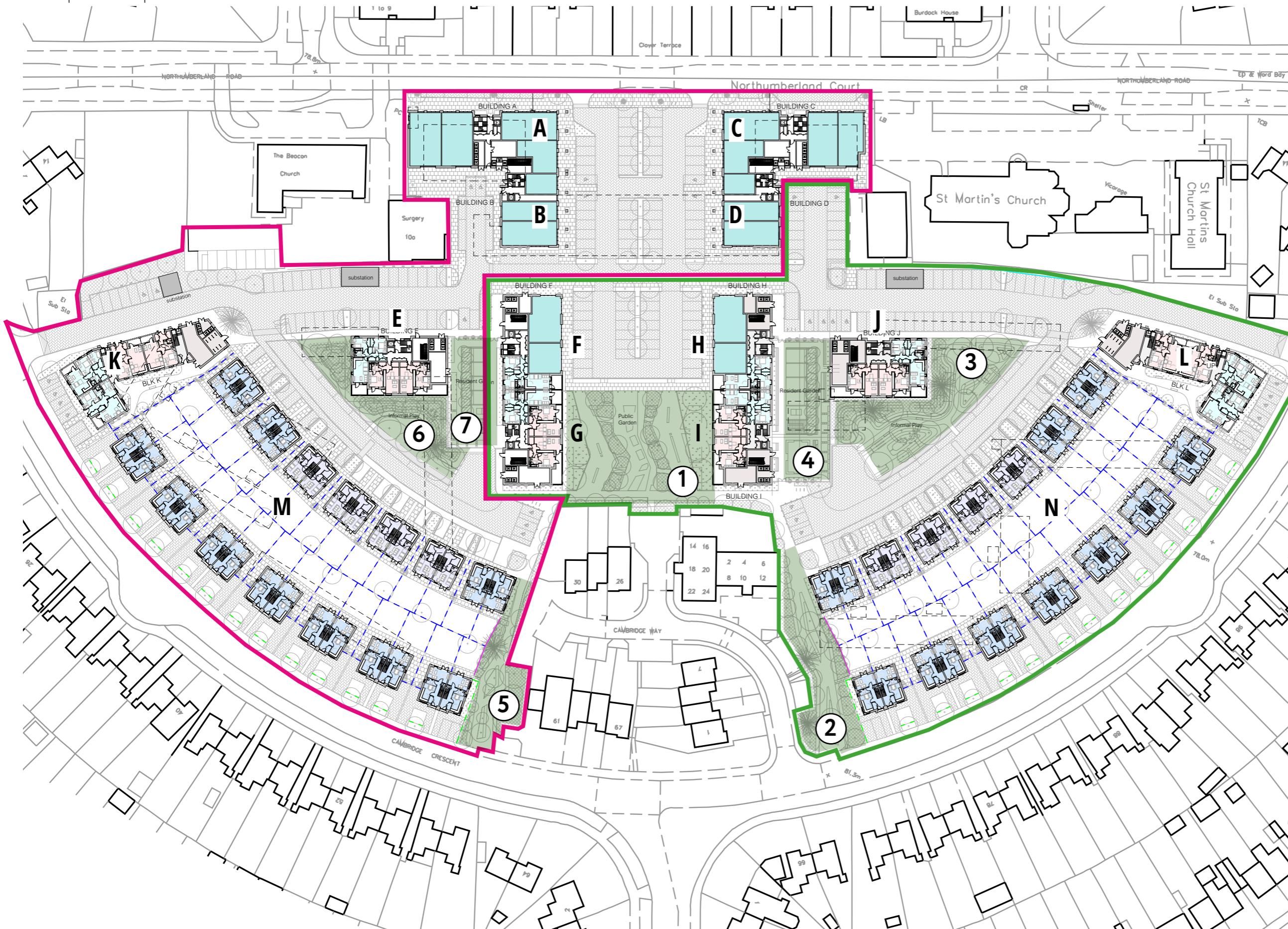

- PHASE 1
- FUTURE PHASES

The future phases comprise Block A, B, C, D, E, K & M (inclusive of 28 houses)..

117 residential units (including 29 apartments and 28 houses) and 1092m<sup>2</sup> of commercial floor space will be delivered in the future phases.

In total, the scheme provides 1400m<sup>2</sup> in total, creating an additional 200m<sup>2</sup> of commercial floor space.

The proposed landscaping and public areas delivered in the future phases include :

5. "Linear Green Walkways",
6. "Western Shared Street/ Play Zone",
7. "Communal Gardens"

hunters

ARCHITECTURE | BUILDING CONSULTANCY | COST CONSULTANCY | EMPLOYER'S AGENT

Space One Beadon Road  
London W6 0EA  
020 8237 8200  
mail@hunters.co.uk

 @hunterslondon  Hunters Architects & Building Consultants

[www.hunters.co.uk](http://www.hunters.co.uk)