

1 Sash Window Elevation
1 : 10

Upside down hooks in window are to be reused in the new windows. These are an unusual feature of these sash windows and this detail is found on several adjacent windows along the street. Bampton Fair was historically a major event for the town where livestock from Exmoor was brought in to market. Buildings along the main streets of Bampton erected scaffolding and awnings to protect the windows and also to sell wares. These hooks could be remaining evidence of this practice - refer to photos.

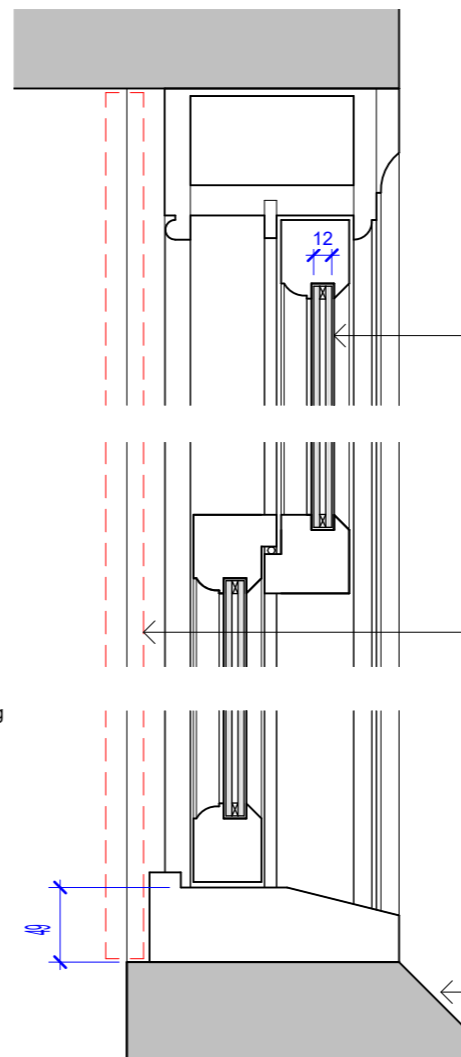

2 Sash Window Section
1 : 5

12mm double glazed units. External pane to be made from cylinder glass to preserve the historic aesthetic when viewed from the street, which is part of the Bampton Conservation Area.

Raw aluminium secondary glazing to be removed. It is not performing its function, it detracts from the beauty of the windows and in some cases is jammed closed and impossible to use.

Existing stone cill

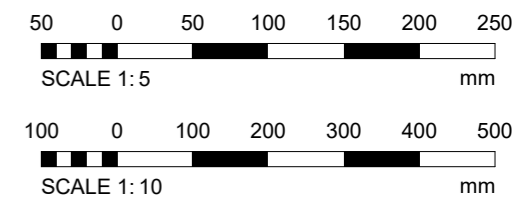

Listed Building Consent
Sheet Issue Date: 03/11/23



XL Planning Ltd, 1A Fore Street, Cullompton, Devon EX15 1JW
T: 01884 38662
E: info@xlplanning.co.uk
Copyright © 2023 XL Planning Ltd

Drawings are based on survey data and may not accurately represent what is physically present. All dimensions are to be verified on site before proceeding with the work.
XL Planning Ltd shall be notified of any discrepancies.

Client
R White
Site Address
8 Brook Street

Drawing Title
Sash Window Details

Scale **As indicated**
Size **A3L**
Drawn **DC**

Job No. 2320	Drawing No. 3000	Rev.
------------------------	----------------------------	------

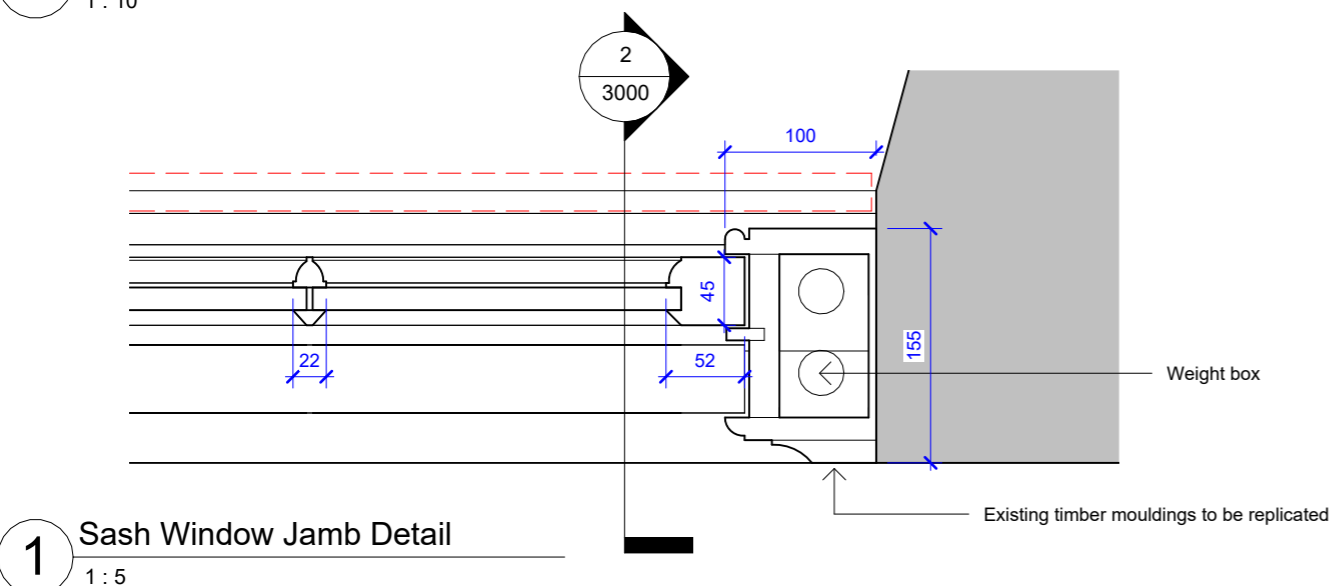

1 Sash Window Jamb Detail
1 : 5

