

N
approx

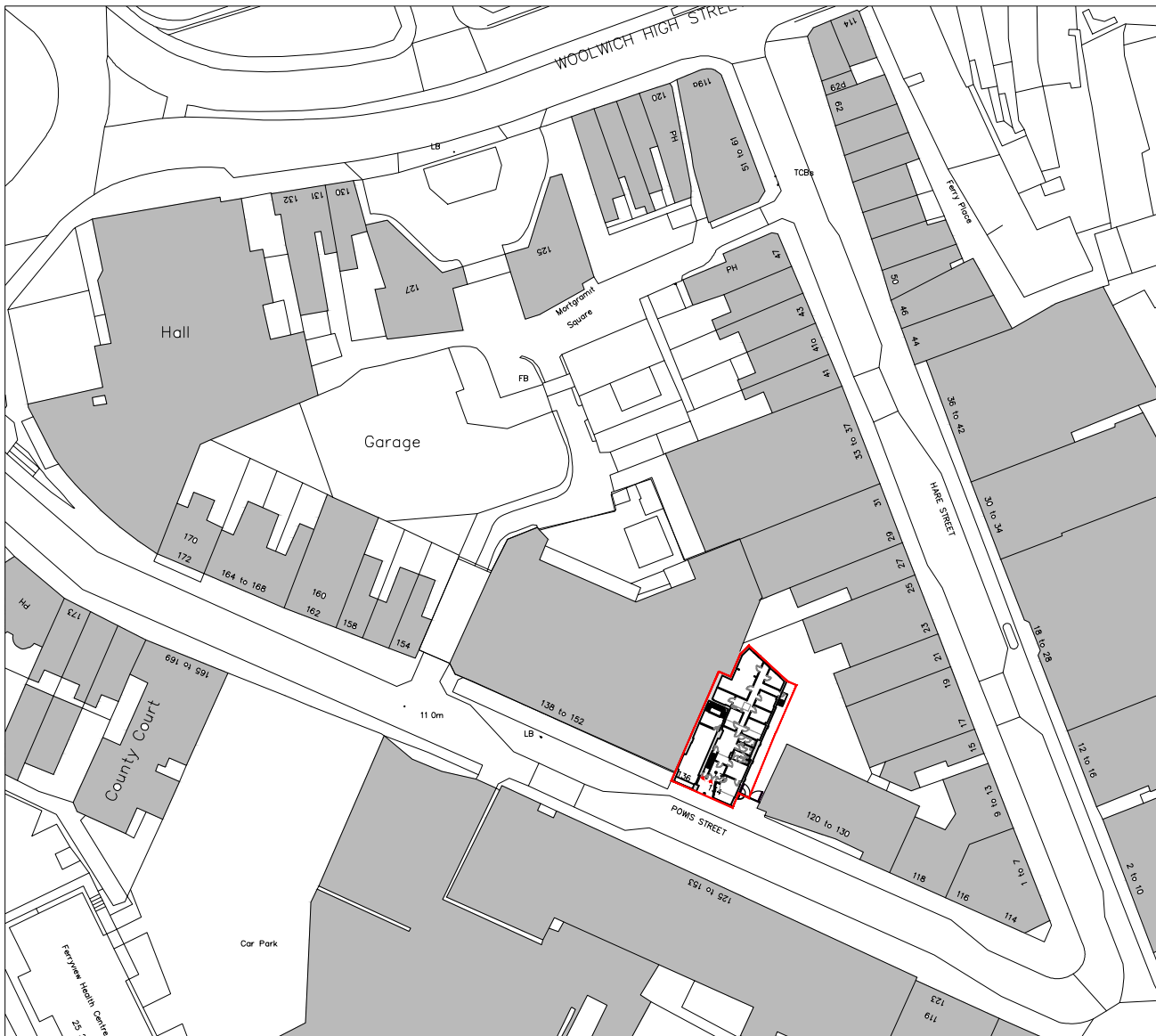

LOCATION PLAN
SCALE 1:1250

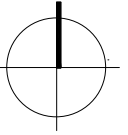
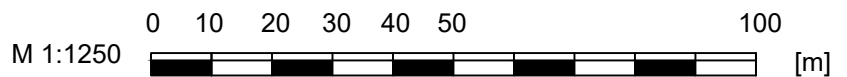

PLANNING

antic

NOTES :

- All works to be carried out in accordance with current Building Regulations
- All dimensions and levels to be checked and verified on site before commencing any work and notify the architect of any errors, omissions or discrepancies.
- The drawings to be read in conjunction with contract documents, project working drawings, specification and all consultants/specialist and engineers drawings, details and specification.
- This drawing is made on behalf of Antic London
- Do not scale in this drawing

Antic London
74 Malham Road,
Forest Hill,
London, SE23 1AG

Address :
132-136 Powis Street, London, SE18 6NL

Date:
27.11.2023

Drawing
Drawing n0.
Scale

PROJECT NAME
PW-NMA

LOCATION PLAN
PW LP
1:1250 @ A4