

POWIS STREET

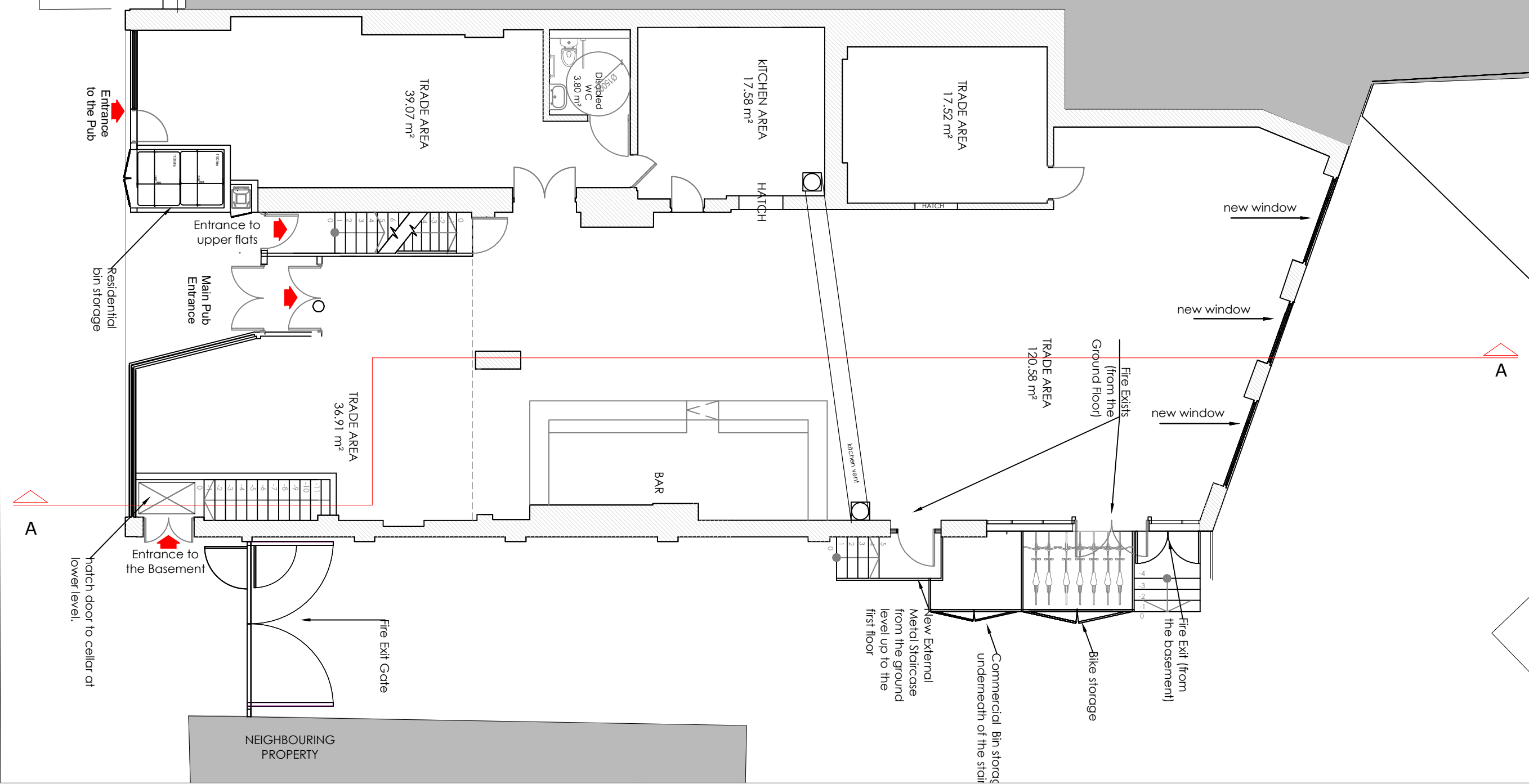

PROPOSED GROUND FLOOR PLAN
SCALE 1:100

PLANNING

antic

NOTES :

- All works to be carried out in accordance with current Building Regulations
- All dimensions and levels to be checked and verified on site before commencing any work and notify the architect of any errors, omissions or discrepancies.
- The drawings to be read in conjunction with contract documents, project working drawings, specification and all consultants/specialist and engineers drawings, details and specification.
- This drawing is made on behalf of Antic London, 77 Malham Road, Forest Hill, London.
- Do not scale from this drawing.

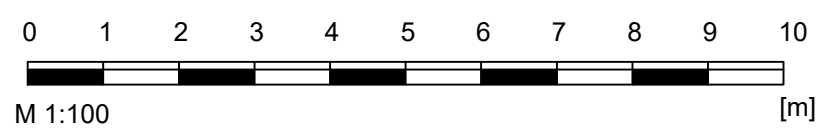

Issue Notes

Antic London 77 Malham Road, Forest Hill, London, SE23 1AH	Address : 132-136 Powis Street, London, SE18 6NL		PROJECT NAME PW-NMA
	Date: 23.11.2023	Drawing Drawing no. Scale	Proposed Ground Floor PW 200 GA 00 rev3 1:100 @ A3