

Notes

This plot has been prepared with a scaling accuracy for a plot at a scale of 1/200

All levels are in metres and related to GPS.

The co-ordinate grid is based on GPS values.

All tree heights and spreads are approximate.

We have tried to identify tree types, however if tree species are critical specialist advice should be gained.

Drainage pipe sizes have been measured from the surface, chamber access has not been gained for safety reasons, therefore sizes should be regarded as approximate.

Station	Easting	Northing	Level
ST01	428255.646	270832.255	89.796
ST03	428263.339	270838.611	89.633
ST04	428243.536	270821.928	89.846
ST05	428263.782	270831.552	89.761
ST06	428269.475	270844.714	89.270

- bl bed level
- cl cover level
- il invert level
- tl threshold level
- utl unable to lift
- wl water level
- wfc water filled chamber

270850N

428250E

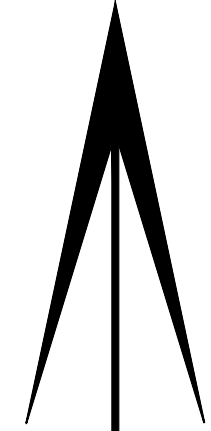
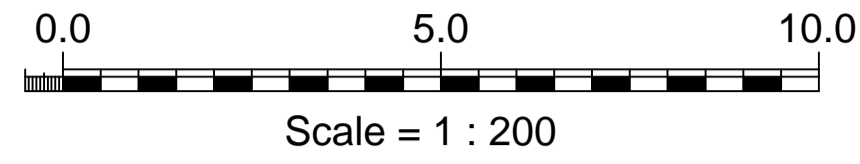

CPB Surveys



Grid North

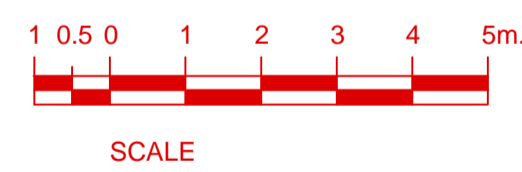

Richard S. Baily

Dip Arch. R.I.B.A Chartered Architect
 3 Alpha House, Farmer Ward Road, Kenilworth
 Warwickshire, CV8 2ED,
 Tel: 01926 859007
 Fax: 01926 859789
 Email: richardsbaily@aol.com

Description:

PROPOSED GARAGE/WORKSHOP
 TO BE BUILT UNDER PERMITTED
 DEVELOPMENT
 62 ROUNDS HILL
 KENILWORTH
 CV8 1DU

EXISTING SITE PLAN

Scale: 1:200@ A3 Date:10/23 Drawn:MAB

Drawing No. 5051/16

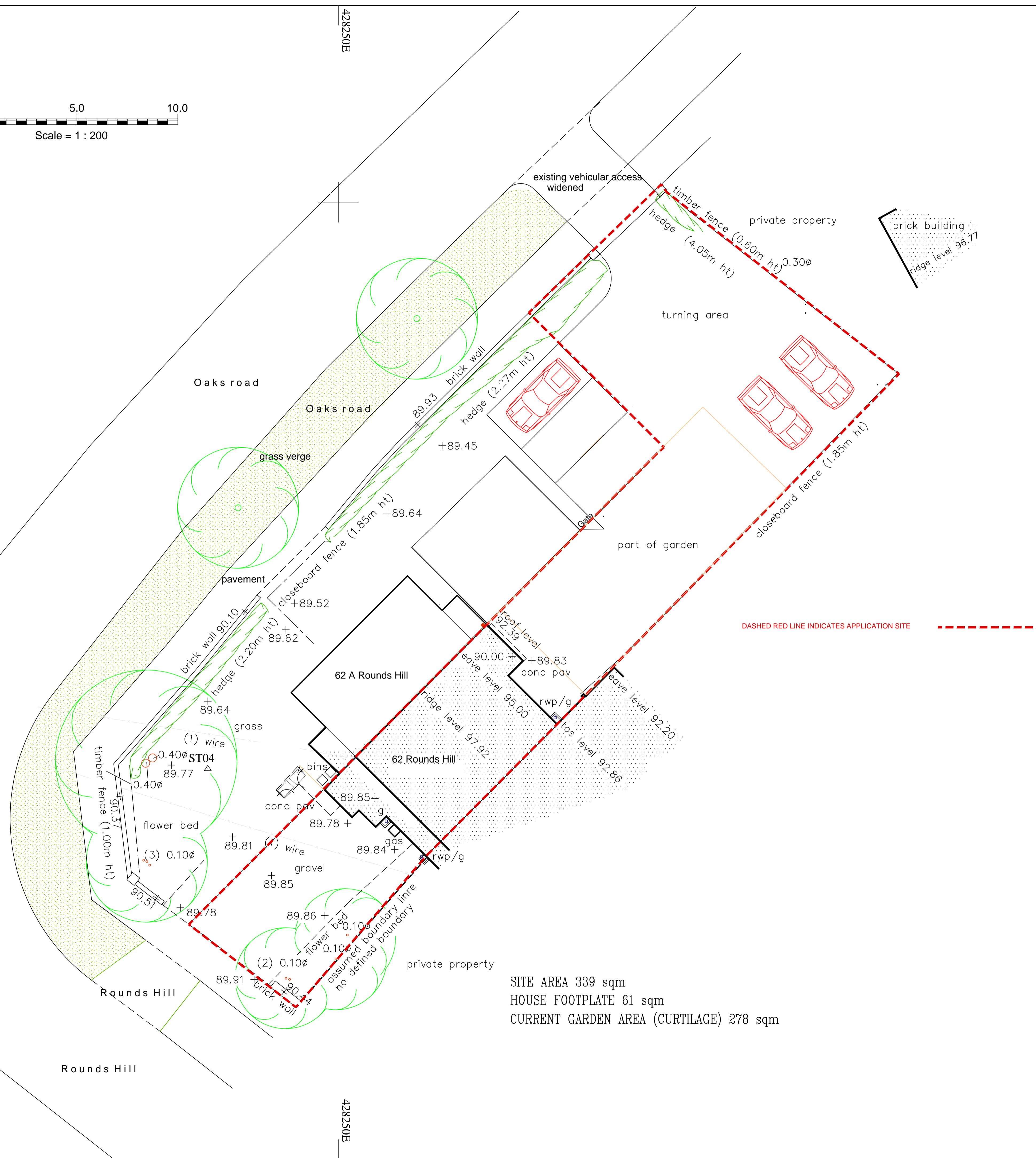

DASHED RED LINE INDICATES APPLICATION SITE

SITE AREA 339 sqm
 HOUSE FOOTPLATE 61 sqm
 CURRENT GARDEN AREA (CURTILAGE) 278 sqm

428300E

428250E