

Proposed Staircase Window Head Scale 1:2

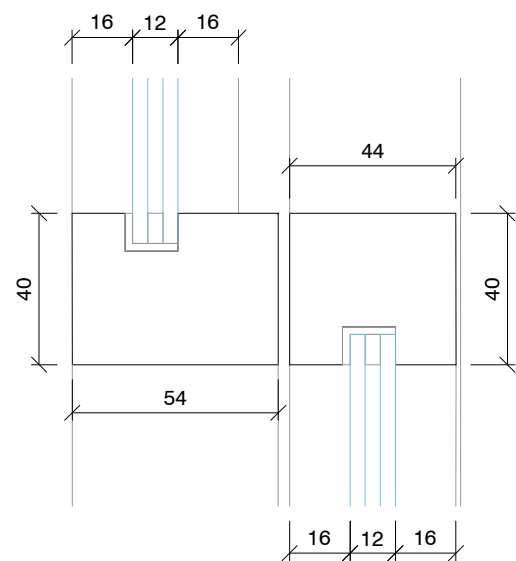

Proposed Staircase Window Mid-Style Scale 1:2

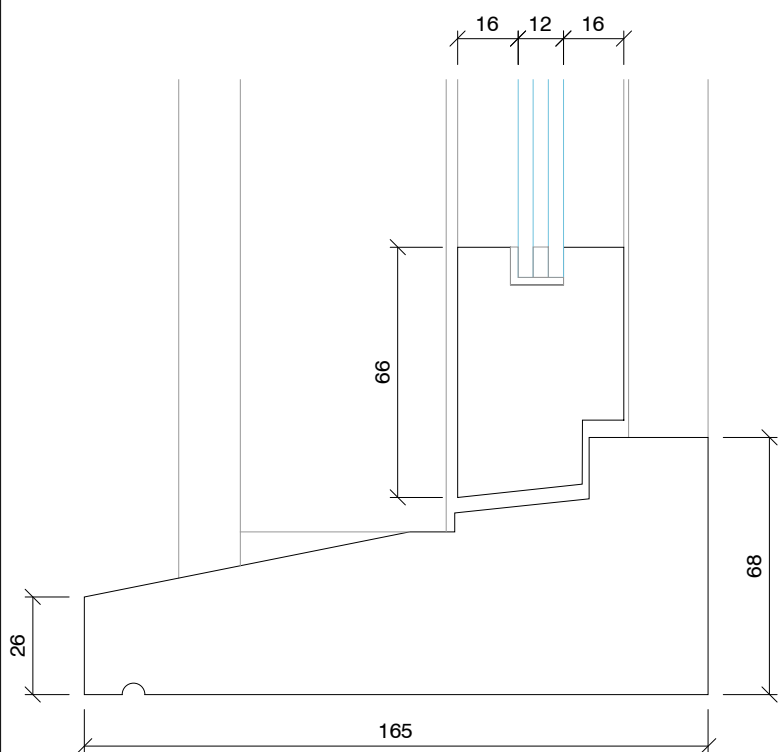

Proposed Staircase Window Cill Scale 1:2

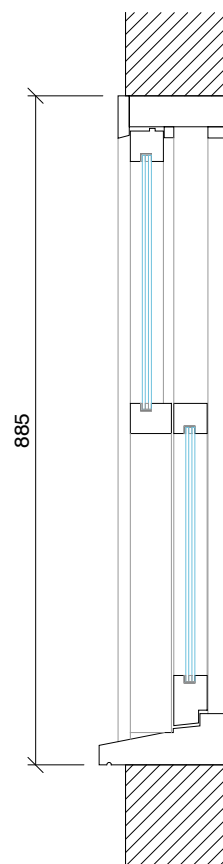

Proposed Staircase Window Section Scale 1:10

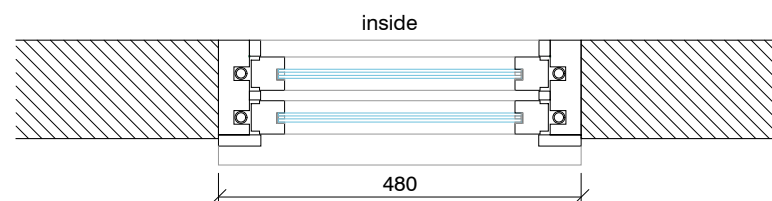

Proposed Staircase Window Section Scale 1:10

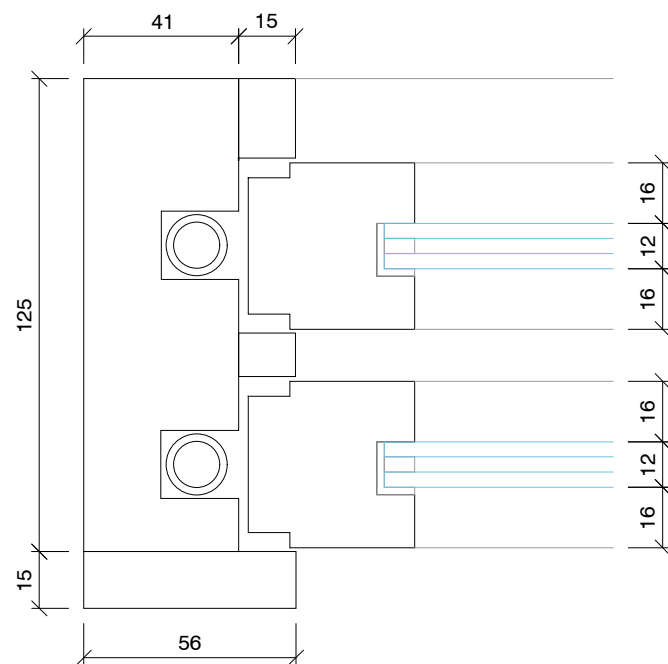

Proposed Staircase Window Jamb Scale 1:2

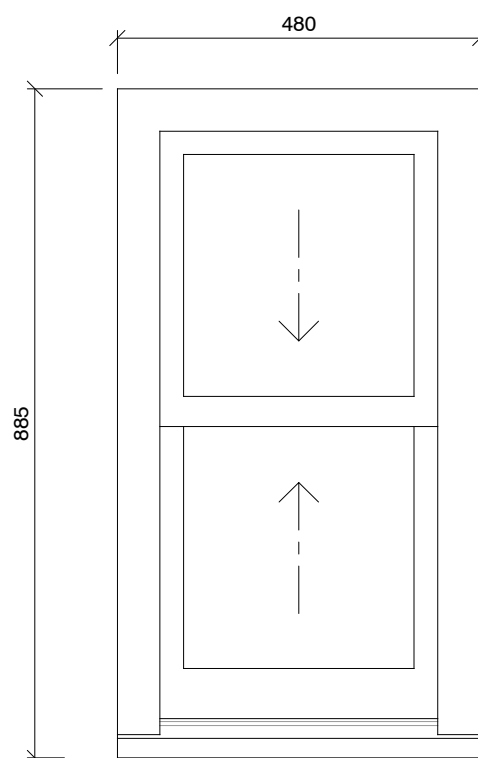

Proposed Staircase Window Elevation viewed from outside - Scale 1:10

Painted timber sliding sash window with SlimLine double glazing (4mm float external pane - 4mm Krypton filled cavity - 4mm Planitherm Total Plus Low E internal pane).

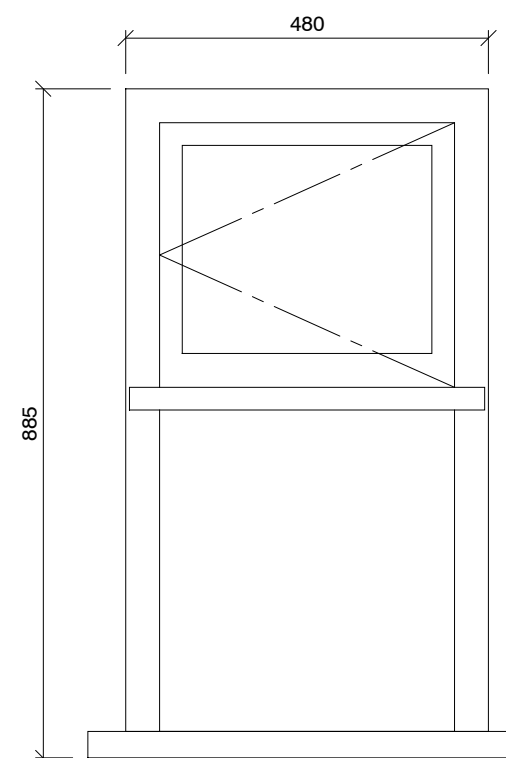

Existing Staircase Window Elevation viewed from outside - Scale 1:10

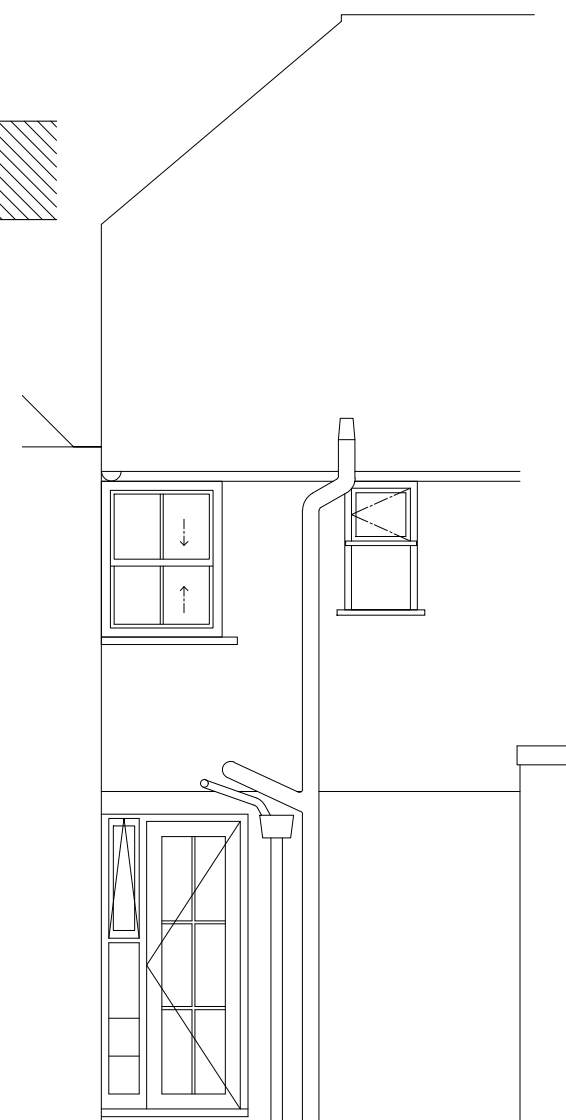

Existing South Elevation Showing Landing Window Scale 1:50

NOTES:
Dimensions to be checked on site before commencing work. any discrepancies shall be reported to Curtis Leeves Technical Ltd. immediately.
Do not scale from these drawings except for planning purposes. Use figured dimensions only.
Where applicable this drawing is to be read in conjunction with other consultants' drawings.
This drawing is the copyright of Curtis Leeves Technical Ltd. and may not be copied, altered or reproduced in any way, or passed to a third party, without written authority.

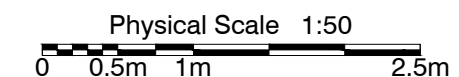
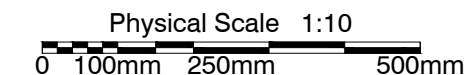
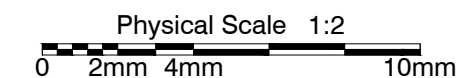

rev	description	date
PLANNING		



CURTIS LEEVES TECHNICAL LTD
01243 378070 | mail@cltechnical.co.uk

client Ms. J de Heger			
project 24 North Walls Chichester PO19 1BY			
title Staircase Window Existing Elevation, Existing & Proposed Window Sections & Details			
date Oct 2023	scale @ A3 As Shown	drawn MRL	chkd GBC
project no. 2326	drawing no. 102	rev P2	