

Key

- Existing wall
- Proposed wall
- +180 Floor level
- 3000 Ceiling level
- EW.01 Door/window tag
- ↗ Foul drainage route
- ↘ Rainwater drainage route

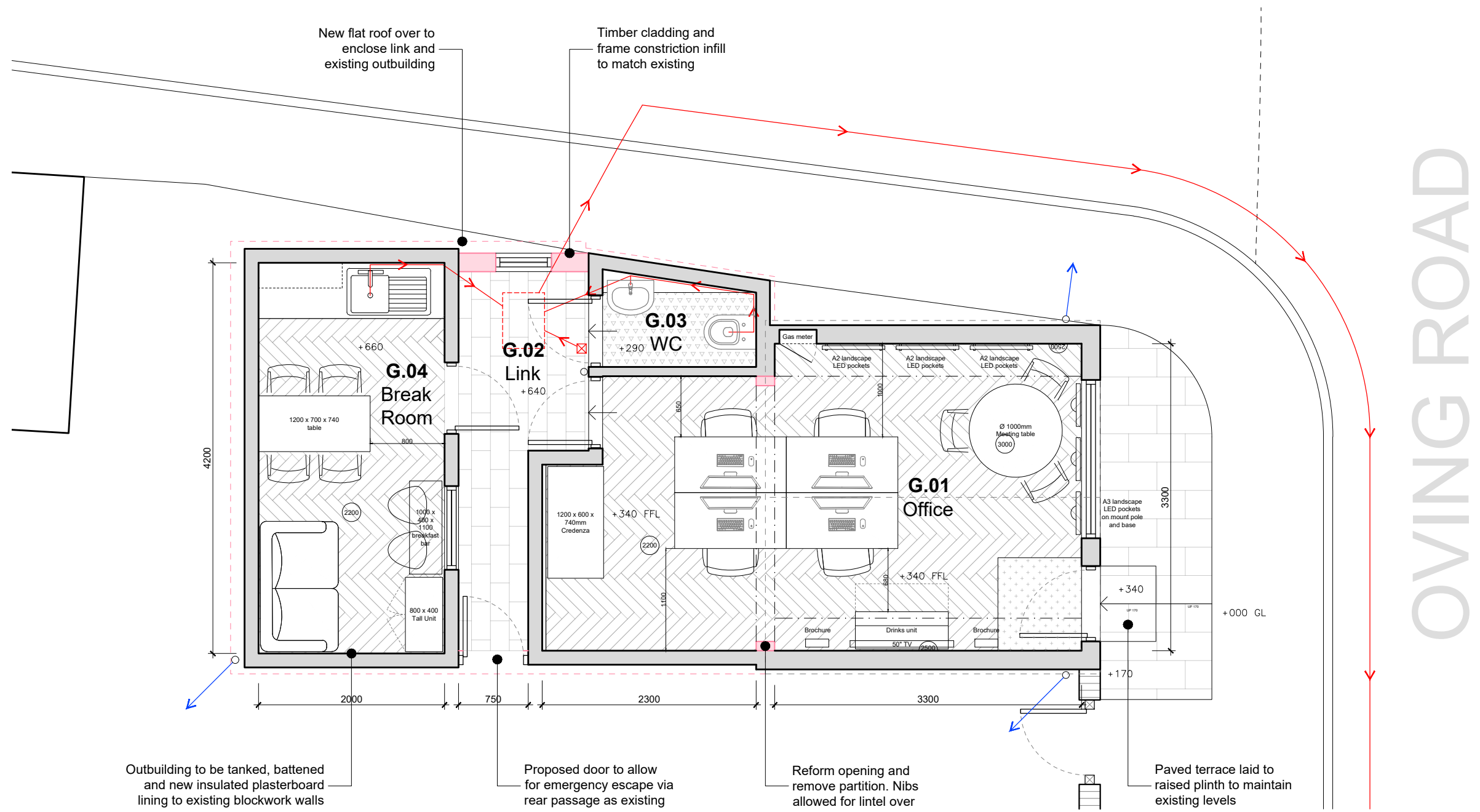

OVING ROAD

① GROUND FLOOR PLAN - AS PROPOSED
Scale: 1:50

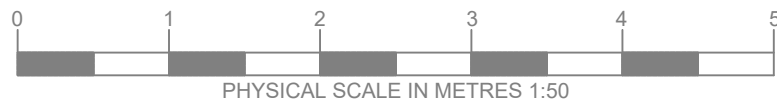

Notes
This drawing has been prepared for the purpose of gaining planning permission only and does not purport to be a working or contractual drawing and should not be used for any building or contractual purposes. This drawing has been prepared based on survey drawings and information prepared by others. All dimensions and levels on all drawings must be checked and verified on site before commencement of works.

© Copyright
This drawing is the property of B Newton Architecture. No disclosure or copy of it may be made without the written permission of B Newton Architecture.

Area:
Site: 25.92m²
GIA: 25.92m²



PLAN

Revisions		
Date	Rev	Details
30/10/2023	/	
06/11/2023	A	Issued for information
10/11/2023	B	Issued for information

B.N. Newton Architecture
B. Newton Architecture
Chichester, West Sussex
T: +44 788 609 1177
E: bnewtonarchitecture@gmail.com

Project Title & Address Fine & Country 13A Oving Road, Chichester West Sussex, PO19 7EG		
Drawing Title Ground Floor Plan as Proposed		
Scale 1:50@A3	Creation Date Oct 2023	Status PLAN
Project No. 139	Drawing No. 110	Revision B