

**Ground Floor Plan**  
Plot 16  
**2-Bedroom 4-Person Affordable**  
79.3 sqm / 853 sqft GIA (to finishes)  
Min. 2.0sqm storage where shown to NDS requirements

**Ground Floor Plan**  
Plot 15  
**2-Bedroom 4-Person Affordable**  
81.3 sqm / 875 sqft GIA (to finishes)  
Min. 2.0sqm storage where shown to NDS requirements

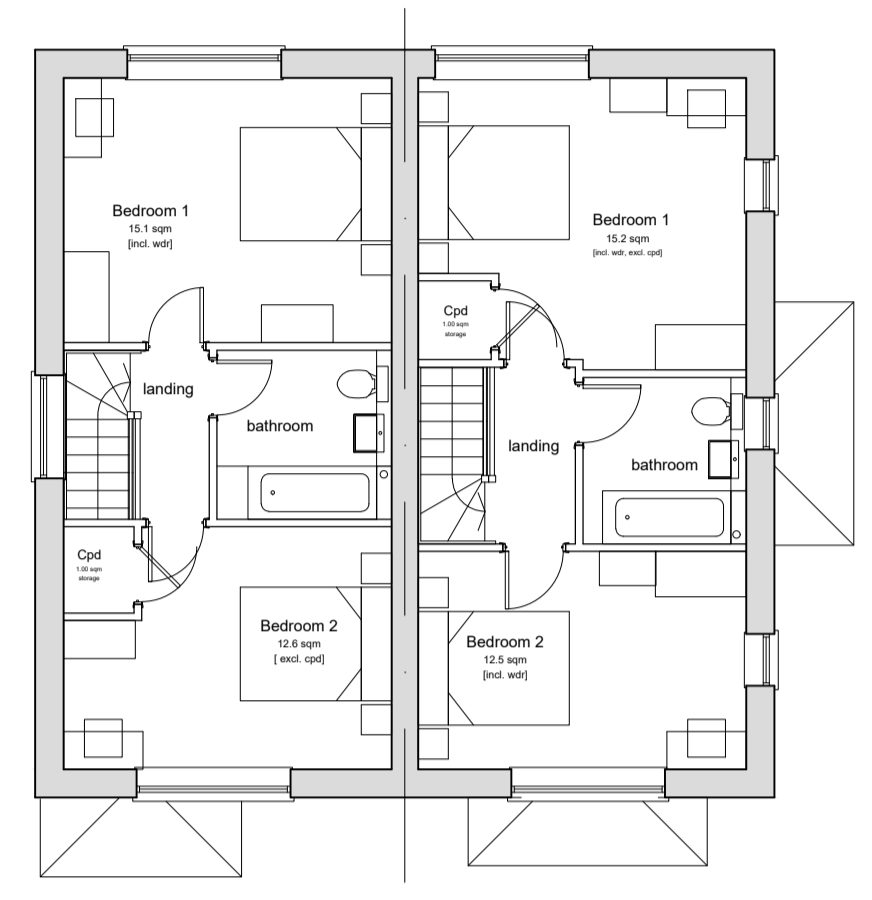

**First Floor Plan**



**Front Elevation**



**Side Elevation**



**Rear Elevation**



**Side Elevation**

- Materials Key:**
- 1 - Brick multi red - Light
  - 2 - Brick multi red - Dark
  - 3 - Detail Brick - Smooth face red brick
  - 4 - Clay tile - Red
  - 5 - Clay tile - Grey
  - 6 - Cedar boarding
  - 7 - Door set - RAL 7032
  - 8 - Window set UPVC - RAL 7032
  - 9 - Windows set UPVC - white
  - 10 - Brick soldier header
  - 11 - Brick cill
  - 12 - Stone cill
  - 13 - Banding in detailing brick
  - 14 - Hung clay tile bullnose detail
  - 15 - GRP chimney
  - 16 - Functional chimney
  - 17 - Timber surround
  - 18 - Gallows bracket
  - 19 - Garage door - RAL 7032
  - 20 - Timber post

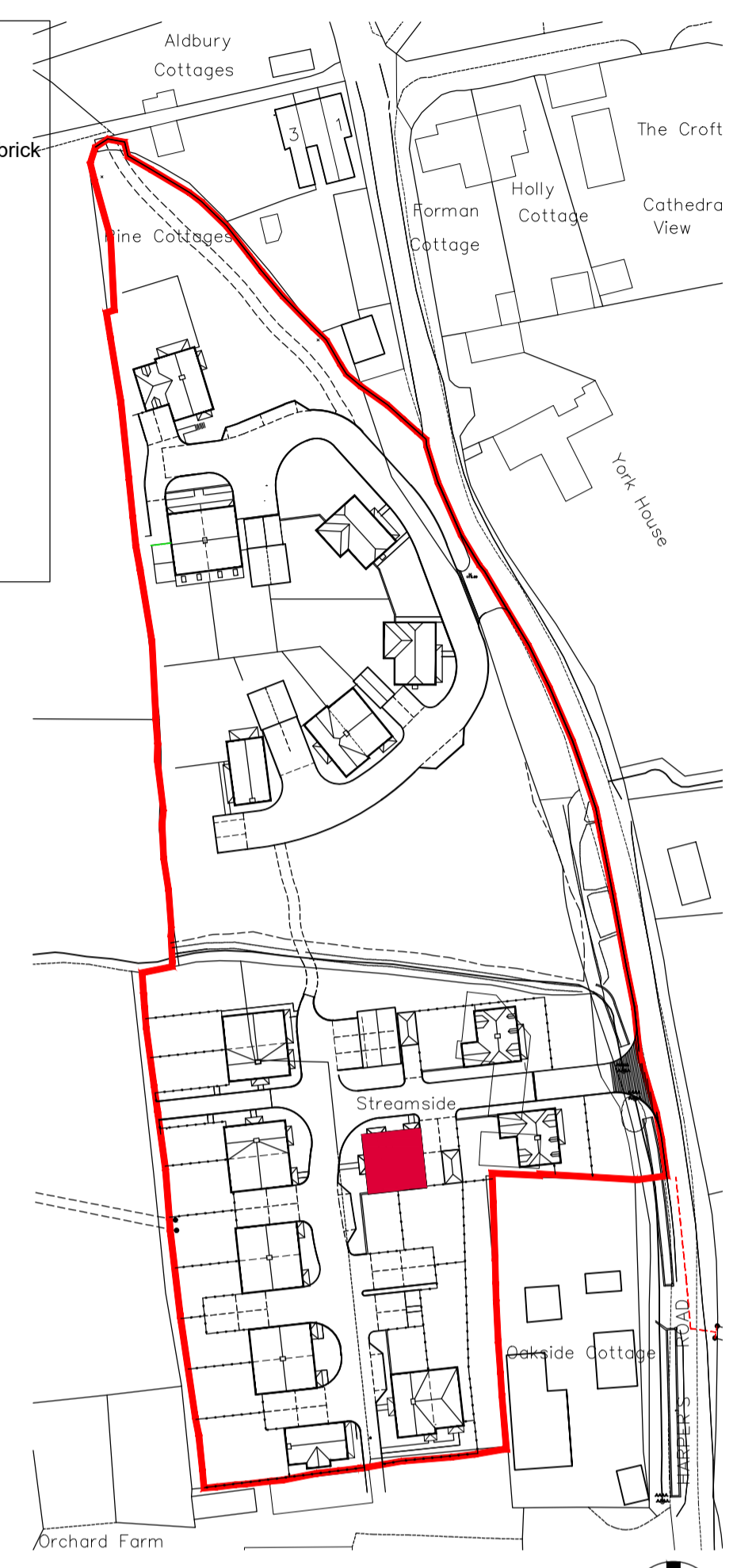

**KEY PLAN**  
1:1000

Rev	Date	Revision Details	Dr	Ch
C	27.11.23	Dimensions amended	LP	MP
B	14.11.23	Amended to client comments	LP	MP
A	09.11.23	Amended to client comments	JR	MP

**ECE Architecture**

London: Unit 1 West Coate House 3 Coate Street London E2 9AG  
T 020 7729 5505 E london@ecearchitecture.com

Sussex: Brooklyn Chambers 11 Goring Road Worthing West Sussex BN12 4AP  
T 01903 248777 E sussex@ecearchitecture.com  
www.ecearchitecture.com

Client's Name  
**Bourne Homes**

Job Title  
**Streamside and Land Adjacent, Harpers Road, Ash**

Drawing Title  
**Proposed Floor Plans and Elevations Plots 15 and 16**

Scale  
**1:100 @ A1 / 1:200 @ A3**

Drawn	Checked	Date
JR	MP	03.11.23

Job No	Drawing No	Rev
6502	PL-48	C

Status  
**APPROVAL**