

Ground Floor Plan

Plot 4

3-Bedroom 5-Person House
96.2sqm / 1036 sqft GIA (to finishes)

Min. 2.5sqm storage where shown to NDIS requirements

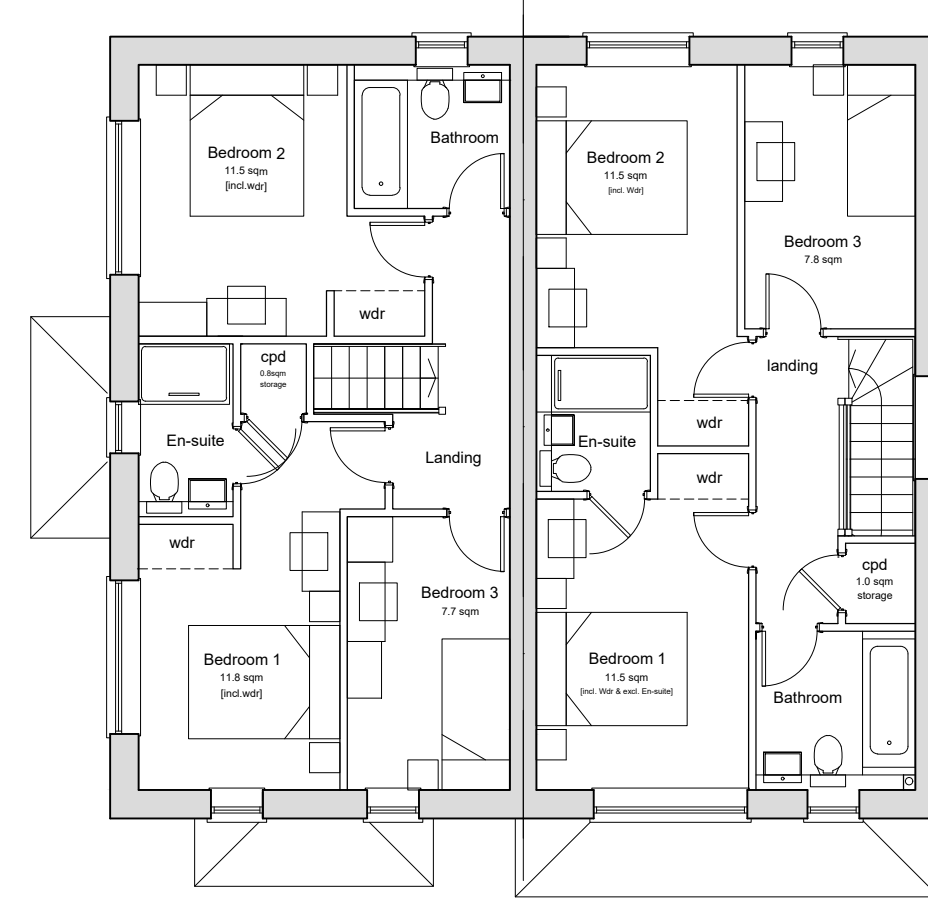

First Floor Plan

Plot 3

3-Bedroom 5-Person House
98.2sqm / 1056sqft GIA (to finishes)

Min. 2.5sqm storage where shown to NDIS requirements



Front Elevation



Side Elevation



Rear Elevation



Side Elevation

- Materials Key:**
- 1 - Brick multi red - Light
 - 2 - Brick multi red - Dark
 - 3 - Detail Brick - Smooth face red brick
 - 4 - Clay tile - Red
 - 5 - Clay tile - Grey
 - 6 - Cedar boarding
 - 7 - Door set - RAL 7032
 - 8 - Window set UPVC - RAL 7032
 - 9 - Windows set UPVC - white
 - 10 - Brick soldier header
 - 11 - Brick cill
 - 12 - Stone cill
 - 13 - Banding in detailing brick
 - 14 - Hung clay tile bullnose detail
 - 15 - GRP chimney
 - 16 - Functional chimney
 - 17 - Timber surround
 - 18 - Gallows bracket
 - 19 - Garage door - RAL 7032
 - 20 - Timber post

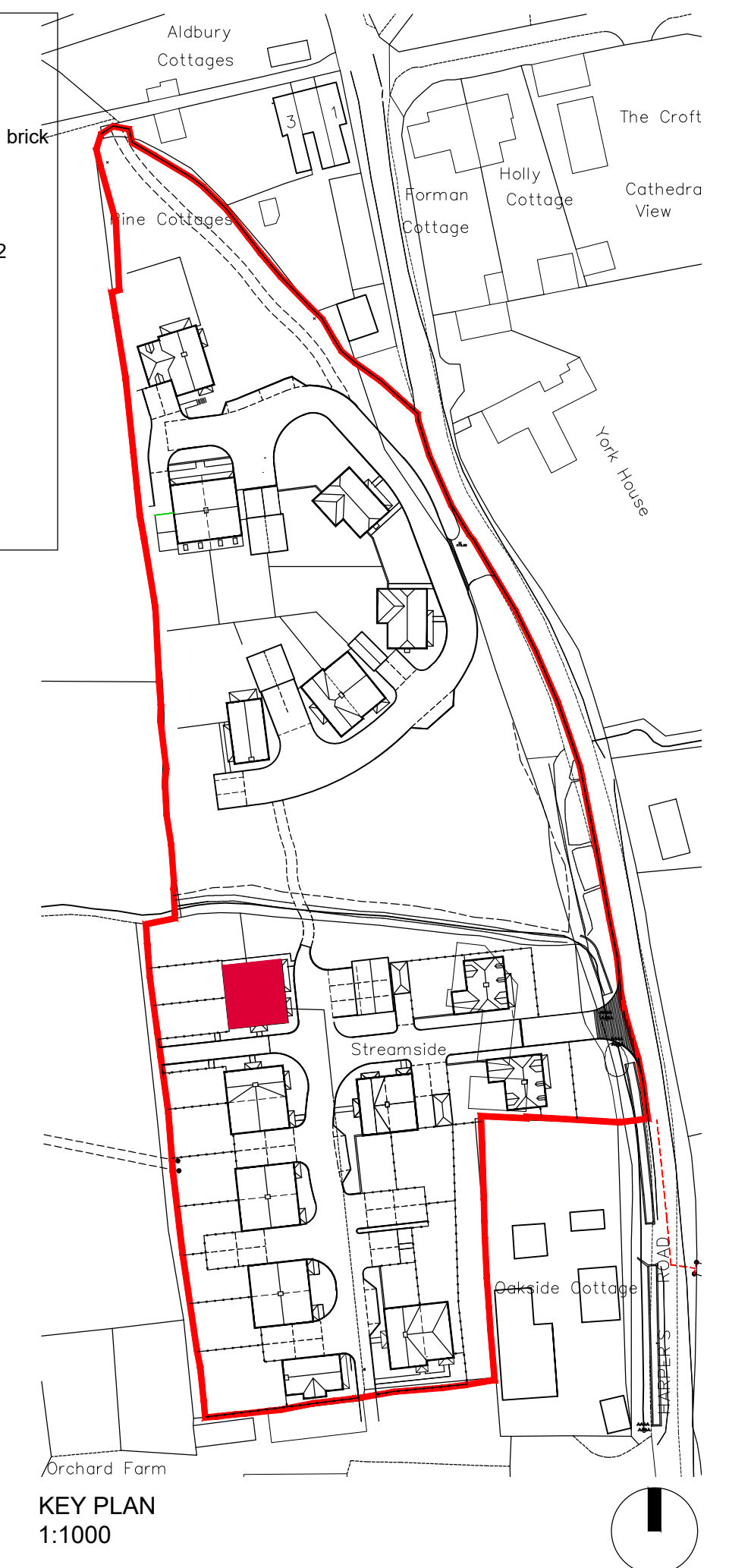

KEY PLAN
1:1000

Rev	Date	Revision Details	Dr	Ch
C	27.11.23	Dimensions amended	LP	MP
B	14.11.23	Amended to client comments	LP	MP
A	09.11.23	Amended to client comments	JR	MP

ECE Architecture

London: Unit 1 West Coate House 3 Coate Street
London E2 9AG
T 020 7729 5505 E london@ecearchitecture.com

Sussex: Brooklyn Chambers 11 Goring Road
Worthing West Sussex BN12 4AP
T 01903 248777 E sussex@ecearchitecture.com
www.ecearchitecture.com

Client's Name
Bourne Homes

Job Title
**Streamside and Land Adjacent,
Harpers Road, Ash**

Drawing Title
**Proposed Floor Plans and Elevations
Plots 3 and 4**

Scale
1:100 @ A1 / 1:200 @ A3

metres 2 4 6 8 10

Drawn	Checked	Date
JR	MP	03.11.23

Job No	Drawing No	Rev
6502	PL-42	C

Status
APPROVAL