

Produced on 21 March 2023 from the Ordnance Survey National Geographic Database and incorporating surveyed revision available at this date.
 This map shows the area bounded by 502291, 282841, 502433, 282841, 502433, 282983, 502291, 282983, 502291, 502433.
 Crown copyright and database rights 2023 OS 100054120. Supplied by cadis for treating as UKPlanning@ps.com a licensed Ordnance Survey partner (OS 100054120).
 Data licence expires 21 March 2024. Unique plan reference: v2c/r24972/1248207

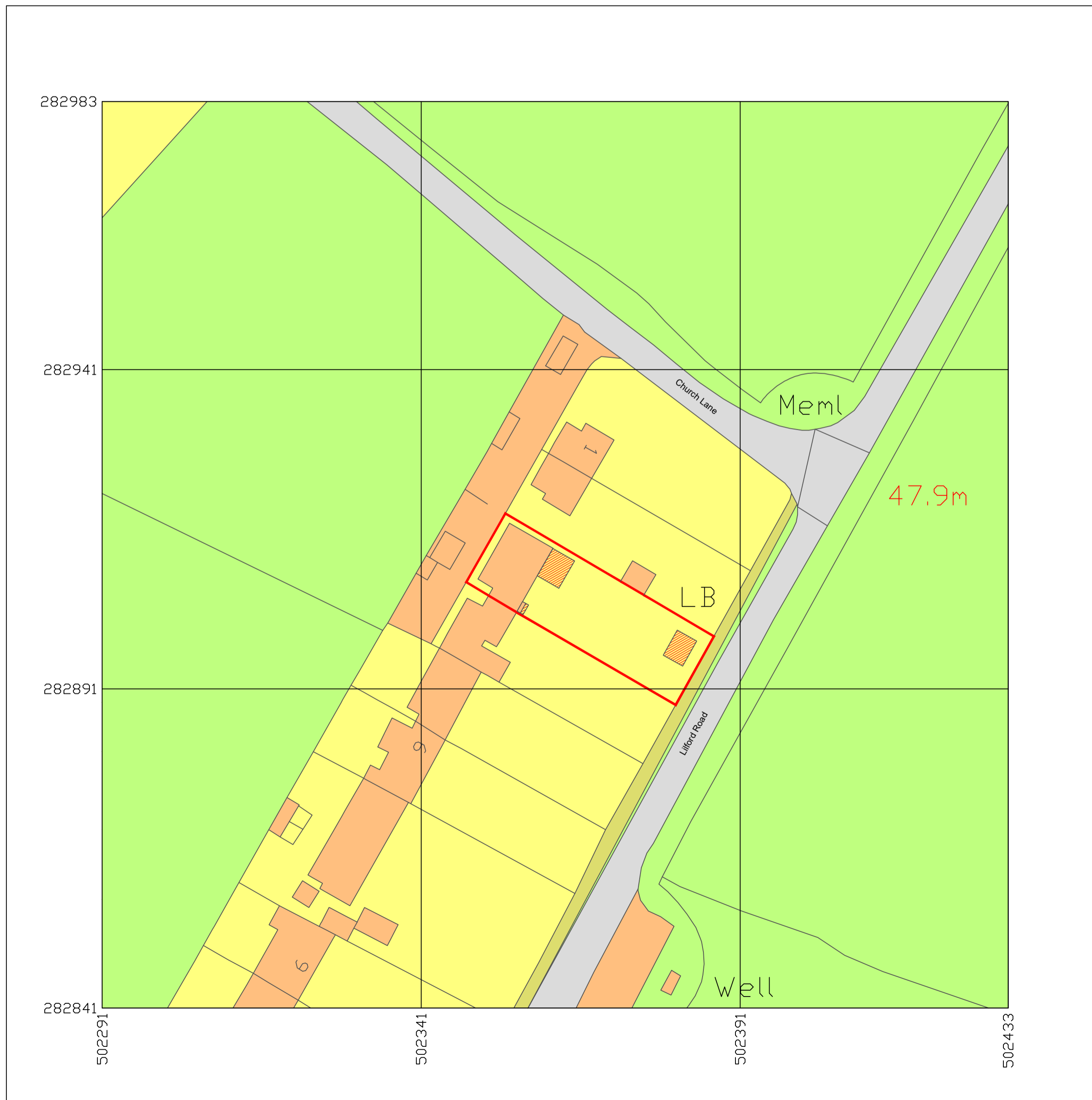

Site Location Plan
 Scale 1:1250



Proposed Block Plan
 Scale 1:500

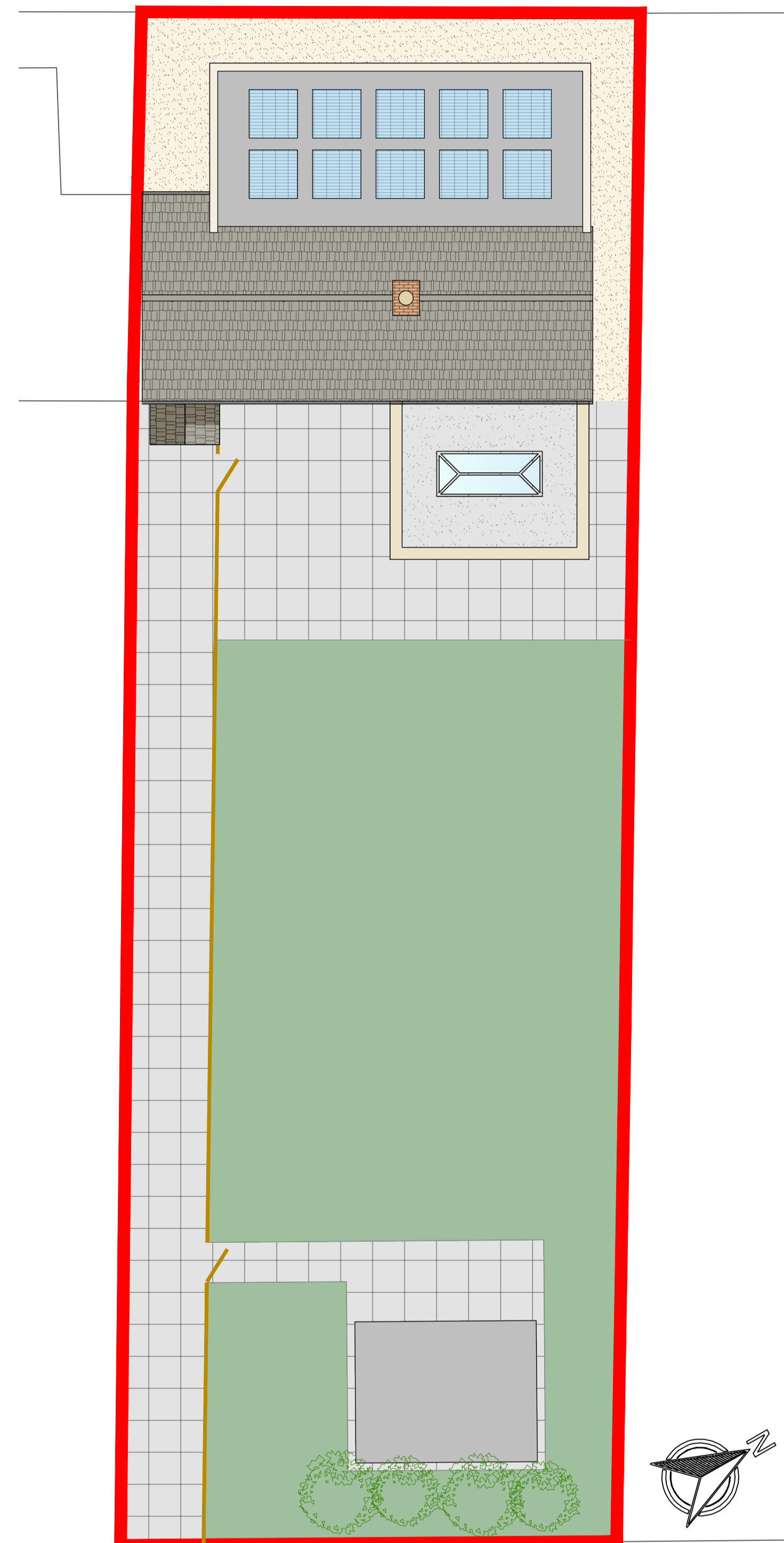

Proposed Site Plan
 Scale 1:100

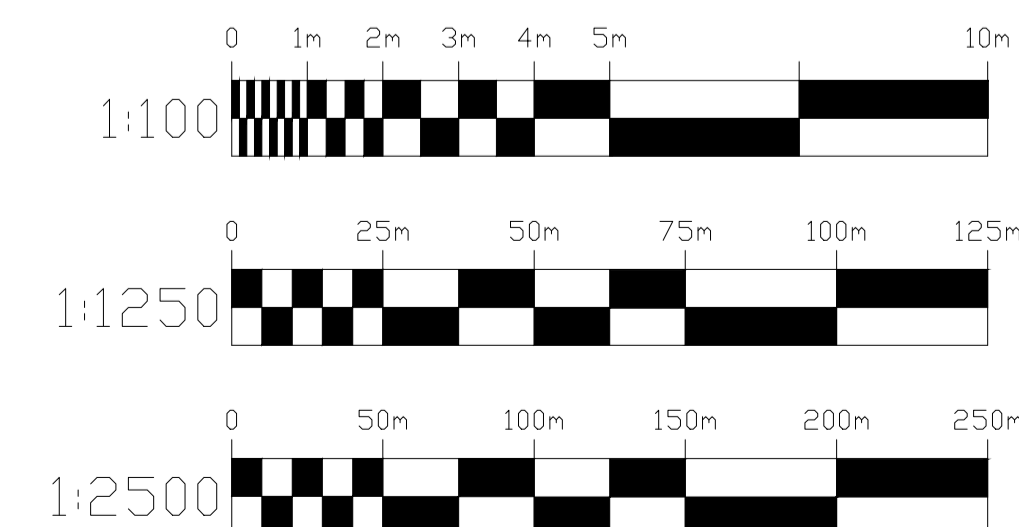

Disclaimer
PLANNING DRAWINGS
 All drawings are provided for planning purposes only. Drawings have been created from a non-intrusive survey and all dimensions must be checked on site before any work commences.
 If in doubt please contact the main contractor if one has been appointed.
 No responsibility can be taken with from any errors when measuring off this drawing.

Revision notes:

Rev:	Date:	Notes:
-	--	--

PLANNING

Drawn by: TB
Checked by: HR

Client:
 Rebecca Hewes & Duncan Smith

Project:
 Extensions, General Remodelling and Garden Office
 3 Lilford Road, Achurch, PE8 5SL

Drawing Title:
 Existing Site Location Plan, Proposed Block Plan and Site Plan

Scale @ A1: As Noted	Date: 13.04.2023	Revision: A
--------------------------------	----------------------------	-----------------------



Project no. 2022013	Drawing no. 2022013-P-005
------------------------	------------------------------

Contact:
 07720866003
 info@seabrookdesign.com
 www.seabrookdesign.com