

LEVEL MONITORING

for Subsidence Management Services

Oakfield, Saint John's Avenue, Thorne, West Yorkshire, LS14 3BZ

Client:	Subsidence Management Services
Client Contact:	Michael Yuill
Claim Number:	4004419529
Client Reference:	IFS-ESU-SUB-18-0078349
Policy Holder:	Mr Mark Christie
Report Date:	24 October 2023
Our Ref:	M19641

Level Monitoring Readings

The following table shows the reading levels of the various Level Monitoring Station points.

Date	1	2	3	4	5	6	7	8	9	10
27/11/2022	10.0000	9.9080	9.9723	9.8767	9.8798	10.1363	10.0231	9.9252	9.9250	9.9593
30/01/2023	10.0000	9.9084	9.9730	9.8788	9.8817	10.1360	10.0247	9.9263	9.9248	9.9604
20/03/2023	10.0000	9.9081	9.9736	9.8791	9.8817		10.0232	9.9253	9.9232	9.9584
13/05/2023	10.0000	9.9088	9.9745	9.8808	9.8827			9.9253	9.9252	9.9590
08/07/2023	10.0000	9.9079	9.9722	9.8745	9.8783			9.9226	9.9251	9.9593
04/09/2023	10.0000	9.9078	9.9717	9.8742	9.8771			9.9230	9.9251	9.9601
23/10/2023	10.0000	9.9083	9.9726	9.8786	9.8810			9.9223	9.9255	9.9602

Date	6a	7a
27/11/2022		
30/01/2023		
20/03/2023	9.9662	
13/05/2023	9.9666	10.1364
08/07/2023	9.9613	10.1330
04/09/2023	9.9599	10.1333
23/10/2023	9.9612	10.1361

Level Monitoring Difference Graphs

The following graphs display the progressive movement that each Level Monitoring Station recorded at each separate site visit date to give an overall look at how much the property is moving.

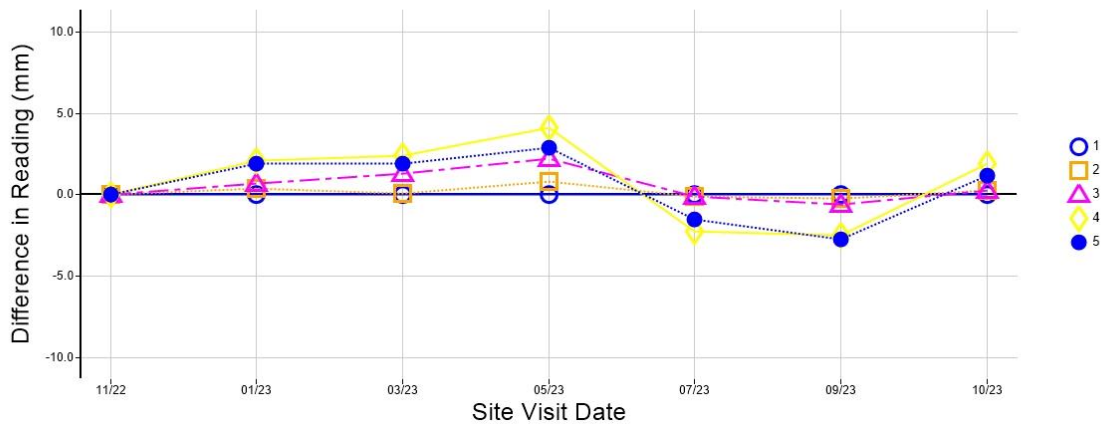

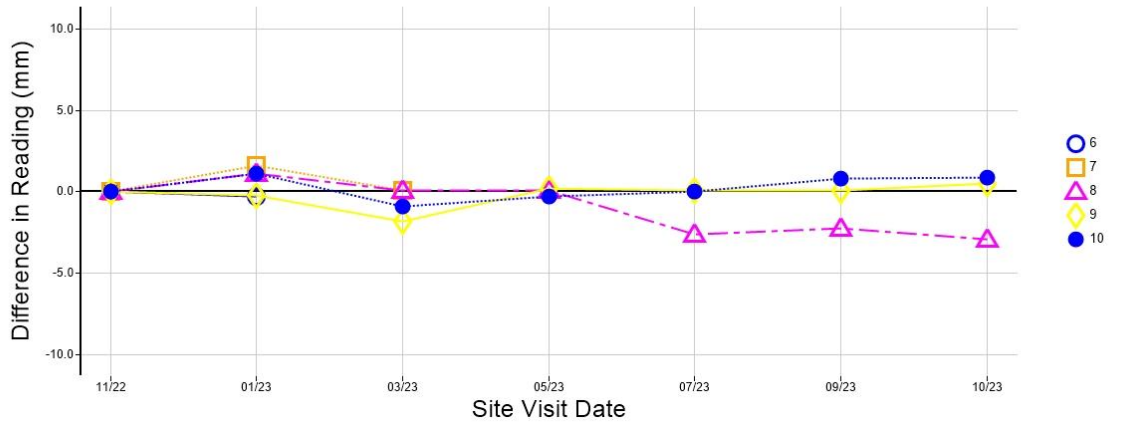

Level Monitoring Displacement Map

The following image shows an isometric representation of the movement of the property, based on the Level Monitoring Stations that were installed.

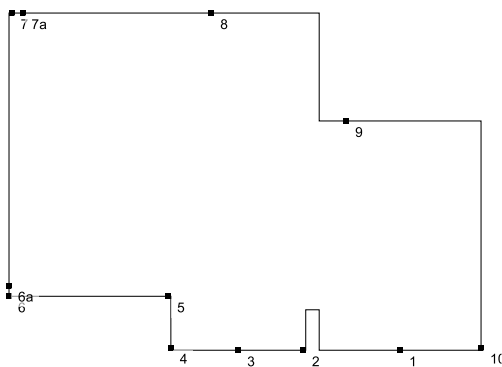
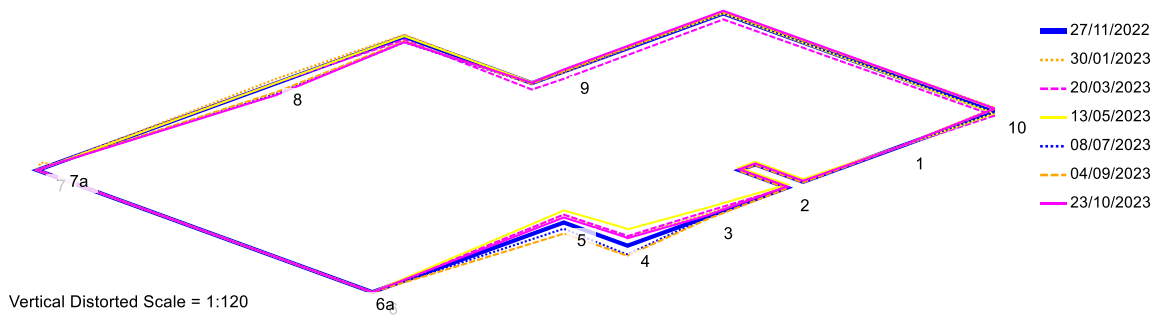

FRONT

Site Visit Notes

Datum is level station 1, it has an assumed value of 10,000m. No suitable secondary datum available. If this is not suitable, please advise if a deep datum is required. Relative survey.

Site Visit: 13 May 2023

Station 7 snapped off.