

# Ben Pentreath

## Prebendal House Pool Design & Access Statement

DOCUMENT NUMBER: DAS

REVISION: PI

28 November 2023

### Introduction

The gardens of Prebendal house currently have approval for a landscape scheme designed by Pip Morrison which includes an architectural proposal of a garden pavillion designed by Ben Pentreath.

The details of these sympathetic landscape works can be found under planning and listed building applications 2023/0398/FUL and 2023/0398/FUL.

This application is for the addition of an outdoor pool into the existing approved scheme.

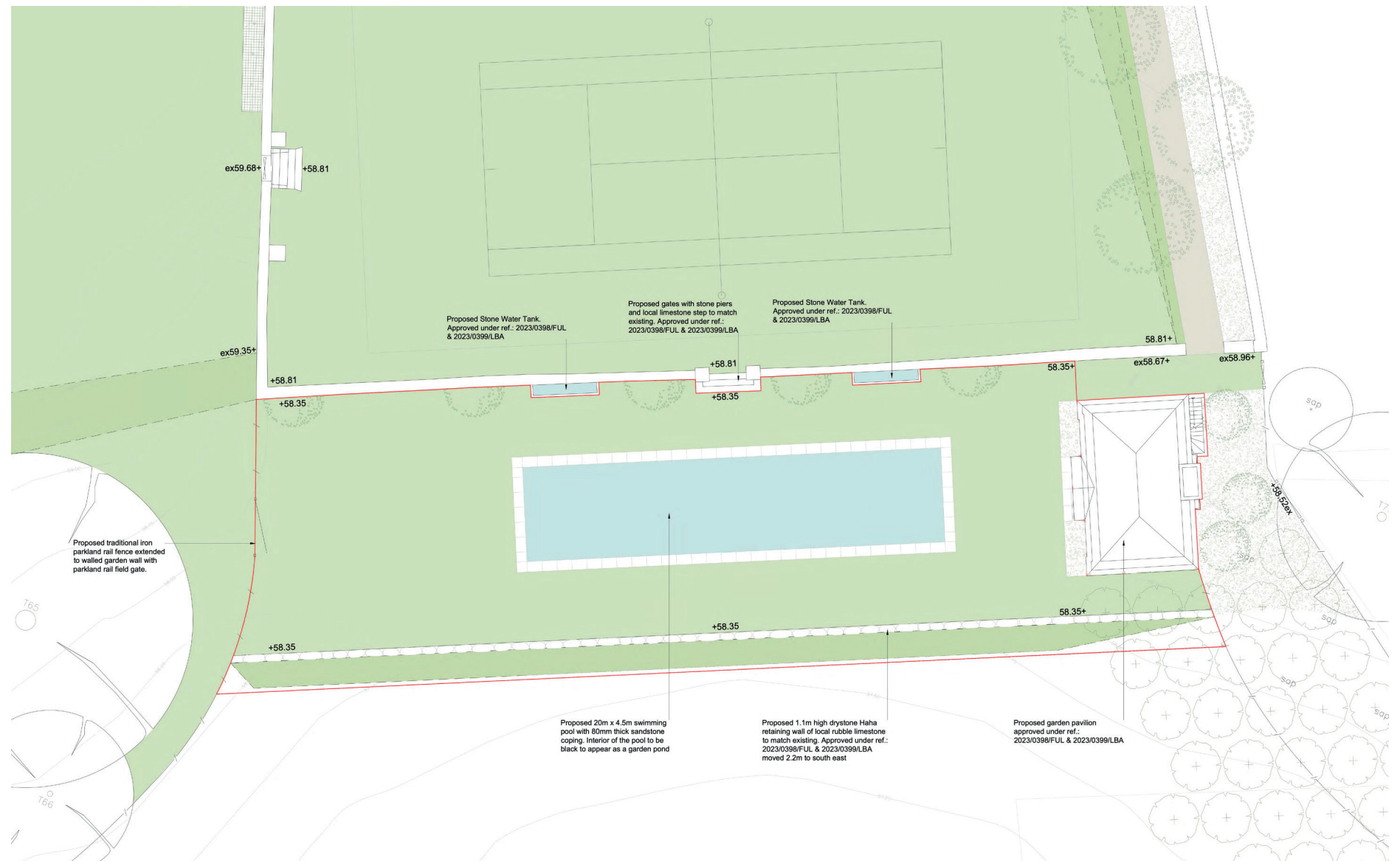

PLAN SHOWING PROPOSED NEW POOL AND STAIRS TO REAR OF PAVILION TO ACCESS THE PROPOSED PLANTROOM AT BASEMENT LEVEL.



AIRIAL VIEW SHOWING PREVIOUS AREA OF MODERN INFILLED OUTDOOR POOL IN BLUE.



# Design

The approved landscape works which seek to reinstate the house's historic relationship with the Gwash valley as well as reaffirm other important relationships between the house and its surroundings. This application concerns a wish to reinstate an outdoor swimming pool within the garden.

The previous outdoor pool was a modern intervention made in the mid-late 20th century which was later infilled. It was positioned to the north-east of the house with little consideration of the buildings historic positioning and situation of the site within the wider landscape (See aerial image on previous page).

Following careful study of the site, this proposal seeks to position a pool to the south-east of the walled garden. The pool is oriented and centered on both the historic central axis of the walled garden and the centre of proposed (approved) pavillion building. As well as acknowledging the orientation of the walled garden, this position also restates the sites historic relationship to the Gwash valley.

The pool is to appear as a traditional reflecting pond rather than a pool and this will be achieved through a coping of reclaimed yorkstone callibrated to a constant 50mm thickness and a pool lining of large format very dark grey porcelain tiles. The reference is the Canal Terrace at Bodnant Gardens (pictured on this page).

The pool size of 20 x 4.5m has been considered to be proportional to the surrounding constraints whilst still being sizeable enough to be usable and able to produce the pleasing effect which can be observed at Bodnant Gardens.

The plant equipment to service the pool is proposed to be discreetly located within a basement of the pavillion building. Updated drawings showing the approved pavillion with the addition of a basement and stairs to access this are included in the application.

## Access

This proposal has no effect on access to any of the existing buildings on the site. It also does not interfere affect access around the gardens.

Access to the proposed basement within the pavillion building will be via stairs to the rear of the building which will be compliant to building regulations.



IMAGE OF THE CANAL TERRACE AT BODNANT GARDENS