

works we will have monitoring stations set up for noise, dust and vibration during working hours.

For the demolition of FEAA, a suitable cut line will be identified to separate it from Building FEAC. FEAC is not covered by this Prior Notification. The cut line will have secure and airtight screens erected internally to prevent the transfer of dust and debris, and the resultant elevation of FEAC will have a weatherproof temporary cladding applied.

Site establishment

A contractor's compound and site offices will be located on the site of Building FEAH, which has already been demolished by others. Vehicular access to the compound will be between the retained Buildings FEAD and FEAF; pedestrian access will be between Building FEAF and the boundary with B&Q

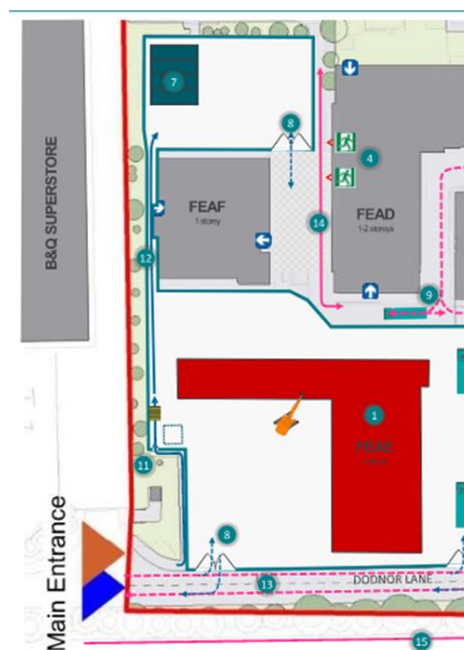

Material Disposal

All demolition materials will be segregated by type and any hazardous materials separated out. Materials will be stockpiled or stored in suitable skips or containers before removal to an appropriately licenced disposal site or facility.

Programme of Works

Demolition of FEAE will be between 8/1/24 and 4/3/24

Isle of Wight College

Prior Notification of Demolition



Demolition of FEAA will be between 19/2/24 and 20/5/24

Other Impacts

No Public Rights of Way will be affected by these works
Some small trees and shrubs in the courtyard of FEAA will be lost through the demolition. A tree survey is included with this application.

Future use of the demolition site

The cleared site will be used for the construction of a new 4,660m² teaching building for the College, with construction commencing in May 2024. A Public Information Day has taken place outlining the proposals for the new build development.