

1) This drawing is the copyrighted and may not be altered or reproduced in any way without written permission

2) Written dimensions supersede manual or electronically scaled dimensions. All dimensions must be checked on site by Contractor before commencement of the works or fabrication

3) This drawing is to be used only for the purposes intended as described in the Drawing Title box

4) This drawing must be read in conjunction with all other Consultants drawings & specifications applicable to this project

5) The information contained herein is confidential and may not be copied or disclosed to any other person or used for any purpose other than that for which it was originally prepared and supplied without the prior written consent

CONSTRUCTION DESIGN & MANAGEMENT REGULATIONS 2015
DESIGNERS HAZARD INFORMATION FOR CONSTRUCTION

The notes below refer specifically to the information shown on this drawing. Refer to the Construction Phase Health and Safety Plan for further information.

1) If you do not fully understand the risks involved during the construction of the items indicated on this drawing ask your Manager, Health & Safety Advisor or a member of the Design Team before proceeding.

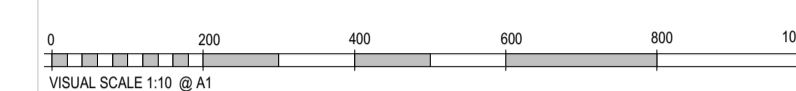

KEY PLAN

Provide min. 100 x 50mm SW joists to door head fixed back to existing floor

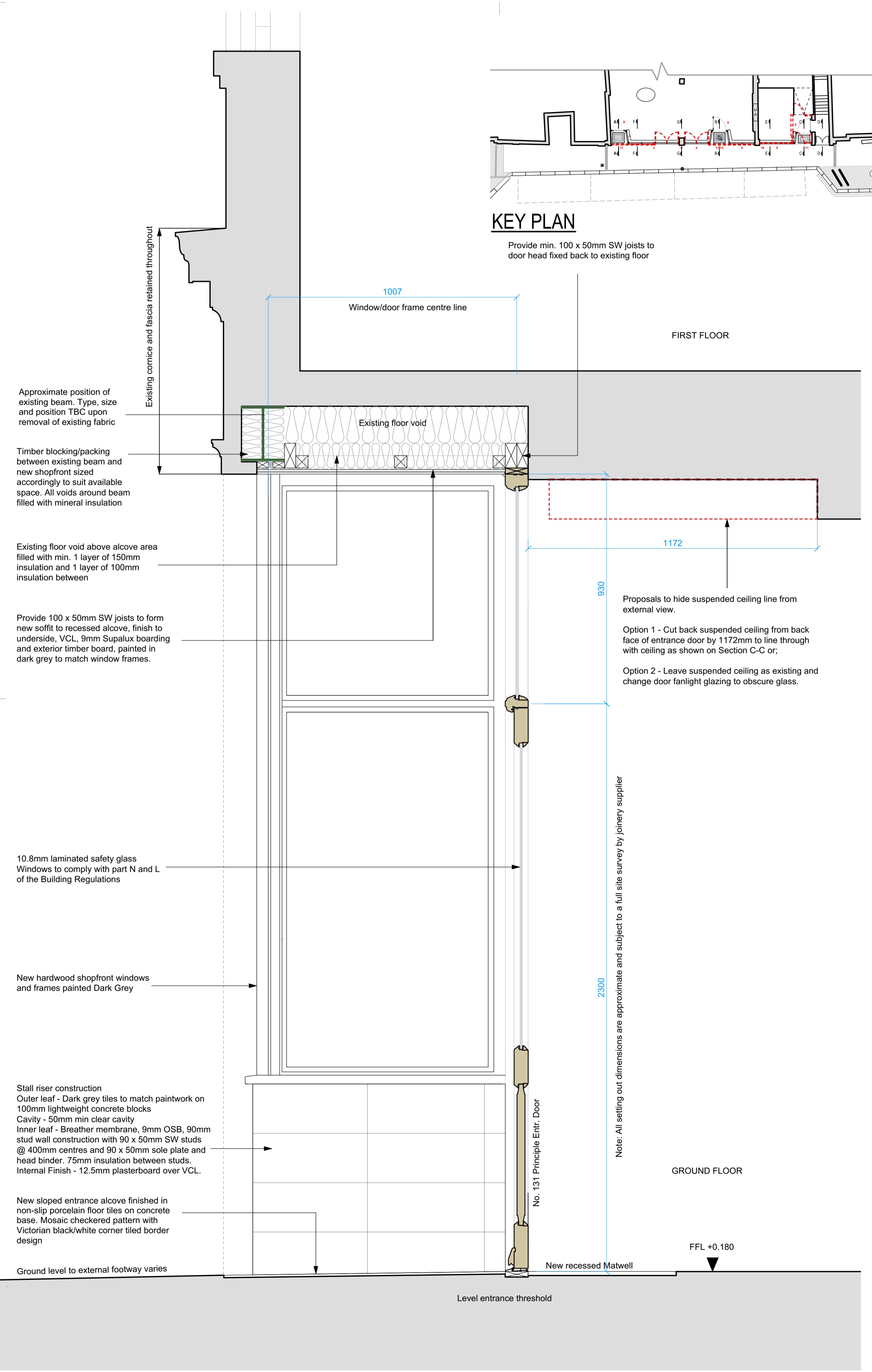

SECTION B-B
1:10 @ A1

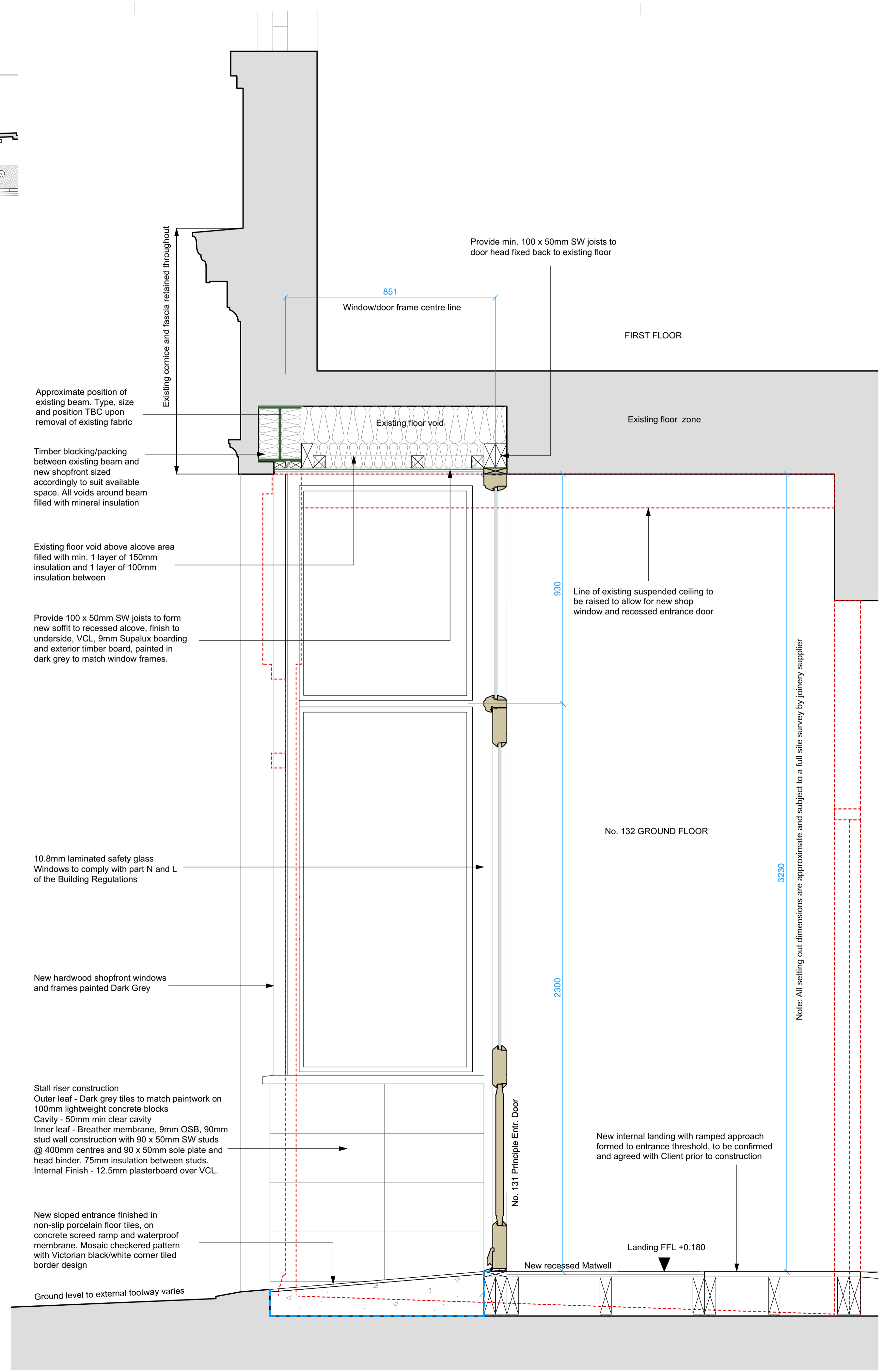

SECTION C-C

GLAZING

10.8mm laminated safety glass

EXTERNAL DOORS

External Door - Opening Inwards
Hung on Stainless Steel Butt Hinges
Easy T 5 Lever Sash Lock Stainless Steel
Hampstead Lever Lock Handle Polished or Satin Chrome TBC
Satin Stainless Steel Box Section Flush Bolt 200 x 19mm TBC
Timber Type: Sapele Hardwood

WINDOW FRAMES

Timber Type: Sapele Hardwood

WOOD FINISH

Linseedpaint.com - Brouns & Co
Linseed Oil and Paint Exterior Collection
All timber sanded with 120 grit
Treat all Knots with Shellac Knotting Primer
Prime wood with one coat of Primer #1
Finish with three coats of top coat.
NOTE: Refer to Linseedpaint.com for full preparation and application directions.

Ref.	Date	Description	By	Chkd
P1		PLANNING		

ermc

03300 240365 www.ermc.co.uk info@ermc.co.uk

Client: Stainless Games

Project Title: Shopfront alterations
130-132 High Street
Newport PO30 1TP

Drawing Title / Description: Replacement Shopfront
Large Scale Section Details Sheet 1

Our Project Ref.	Scale	Date	Drawn	Chkd
2827	1:10 @ A1	23/11/22	TH	

Client Project Ref.	Originator	Zone	Level	Type	Rev	Drawing No.	Rev.
2827	ERM	00	00	DR	A	0016	