

# **Electronic Report**

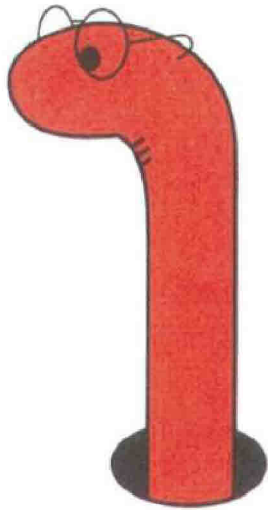

## **WORMS EYE**

**52 Bank Parade  
Burnley  
BB11 1TS  
Phone  
01282 414649 / 458410**

Our Ref: Duncan Street/BB12 6EQ/2019 Date: 4 September 2020

DB Associates Northwest Ltd St James House  
St James Road  
Burnley

Email: dennisberrytd@gmail.com

**DUNCAN STREET, ROSEGROVE, BURNLEY, BB12 6EZ**  
**PRELIMINARY RISK ASSESSMENT (DESK STUDY)**

**INTRODUCTION**

A residential development is proposed. The objective is to carry out a Preliminary Risk Assessment (PRA) to consider contamination and, landfill gas and issues.

**SITE DESCRIPTION**

The site is a triangular plot, about 38 by 36 metres, located to the south of Duncan Street in Burnley and at OS Grid Reference 381527, 432413. In 2019 the site comprised an uneven, overgrown plot, with a concrete strip along the southwest. Along the north, east and south boundaries was a grassy berm up to 2 metres high. There was fly-tipping seen throughout the site.

Re-inspected on 28/08/2020, the site has been stripped to 300mm below finished ground level, except for a concrete slab at the southwest (former garage bases). The stripped material being formed into a stockpile at the southeast.

This is a residential area with houses surrounding the site and a pub to the southeast. The area slopes down to the northwest.

**PROPOSED DEVELOPMENT**

It is proposed to build five 2.5 storey terrace town houses on the southeast of the site, with tarmac surfaced drives to the front (northwest) and patios/gardens to the rear (southeast).

The site will be raised by 300mm above existing ground level.

### **TREES**

On the north of the site was a deciduous tree up to 5 metres high and on the south of the site a deciduous tree up to 12 metres high.

This is not an accurate arboricultural survey.

### **LEGAL/COPYRIGHT**

Material may be included in this report from Ordnance Survey (Licence No. AL100031635), Landmark, Environment Agency, Coal Authority and others. It may be copyright and the usual restrictions apply. This report can only be relied upon if the invoice has been paid promptly and in full. This report may be signed by an individual, but only on behalf of Worms Eye Limited.

### **NOT INCLUDED IN THE REPORT**

- Arboricultural Survey.
- Asbestos Survey
- Invasive Plant Survey (Japanese Knotweed etc.).
- Mining Risk Assessment.
- River/Tidal Flood Risk Assessment.
- Surface Water Flooding.
- Underground Services Survey.

General comments may be made with regards to the above where there are obvious features seen on site, in the data review or where they are applicable to the environmental and geotechnical risk assessment. These general comments do not constitute a detailed risk assessment.

### **DATA SOURCES**

The following data sources have been viewed in compiling this report.

- BGS, Geology Map, 1:50000 scale, Solid and Drift Edition
- BGS, on-shore boreholes scans
- Landmark Envirocheck Report, 10/5/2019
- Ordnance Survey, Historical Maps, 1:10000 and 1:2500 scale
- Walkover Survey, 13/05/2019

This report is referred to as a Preliminary Risk Assessment (PRA) and may involve a site inspection. Alternative names for such reports are 'Phase I' Report (Phase II being the intrusive work involving boreholes etc.) or a Desk Study.

### ENVIRONMENTAL DATA

A Landmark Envirocheck report and geological maps have been reviewed, the following is a summary of the data. The Envirocheck report indicated none of the following within 250 metres:

- Contaminated land register entries
- Discharge consents
- Substantiated pollution incidents
- Water abstraction points
- Source protection zones
- Radioactive sites
- Areas of flooding from rivers
- Hazardous substances sites

### Geology of Site

The geological map indicates that the underlying solid rocks are Tim Bobbin Sandstones.

Surface drift is shown as glacial till (boulder clay) of unknown thickness and natural subsidence hazards are shown as very low to no hazard.

### Radon

The site is in a lower probability radon area as less than 1% of homes in the area are above the radon action level. Radon protection measures are not required.

### Surface Water (Hydrology)

The nearest surface water feature is the canal 196 metres northwest.

There are three pollution incident to surface water listed within 250 metres:

- 171 metres north, significant incident, oils, diesel to unknown receiver in 1993 \*
- 207 metres west, minor incident, fire water/foam, to freshwater stream/river in 1998 \*
- 207 metres west, minor incident, oils, diesel to canal in 1997 \*

The area slopes down to the northwest, the flow of surface water is expected to be in this direction.

\* not relevant due to distance/severity/significance/age

### Flooding - General

Information is obtained from the EA flood maps and suggests areas where rivers would flood. There are two zones:

- 'normal' flooding, based on a 1 in 100 chance of it happening in any year (1:200 if flooding is from the sea). This is normally closer to the river.
- 'extreme' flooding, further away from the river and having a 1 in 1000 chance.

Flooding can occur for many reasons other than those dealt with by the EA maps. These include:

- burst pipes
- blocked drains, sewers and culverts
- inadequate drainage
- cloudbursts/flash flooding overwhelming normally satisfactory drainage systems

Statements in this report such as 'clear of flooding/flood plain' and 'flooding – no further action' are references to the EA river and sea flood maps and are no guarantee that flooding will not occur.

### Groundwater Flooding

The site is shown to be in an area with limited potential for groundwater flooding to occur.

### Flooding from Rivers

The site is shown to be clear of flooding from rivers.

### Surface Water Flooding

An area at risk of 1 in 1000 year surface water flooding is shown 10 metres northeast.

### Groundwater (Hydrogeology)

The solid rocks under the site are indicated as a Secondary A aquifer.

Superficial (drift) deposits are classed as a Secondary Undifferentiated aquifer.

Groundwater flow is likely to follow the topography and move to the northwest.

### Landfill Sites

There is a historical landfill sites listed 35 metres southeast, deposited waste included unknown material at former railway sidings.

There is one Local Authority recorded landfill site 101 metres southeast.

Nearby Industry

There is one LAPPC Listing within 250 metres as follows:

- 229 metres west, PG1/1 waste oil burners, 2001. Authorisation revoked \*

There is one persecution relating to authorised processes 246 metres northeast as follows:

- Rose Grove Iron Works, depositing and keeping controlled waste on land at Rose Grove Iron Works on 26 November 1998 \*

There are four Trade Directory Entries listed within 100 metres, as follows:

- 78 metres north, damp and dry rot control, inactive \*
- 85 metres east, car customisation and conversion specialist, Active \*
- 87 metres east, car dealers, inactive \*

\* not relevant due to distance/severity/significance/age

Sensitive Land Uses

Nitrate vulnerable zones on southwest of site \*

\* not relevant due to distance/severity/significance

SITE HISTORY

Date	On Site	Off Site
1848 (1:10,560)	Undeveloped plot.	Railway 125m south. Leeds and Liverpool canal 190m northwest.
1893 (1:2,500)	Little or no change.	Housing 5m southeast. Public House 5m southeast. Rose Grove Preserverly 155m northeast.
1912 (1:2,500)	Outbuilding at Junction Hotel on southeast of site.	Housing 5m south, 5m east and 10m northeast. Railway sidings now 35m east. Church 35m north. St. Marks Mission Church 70m northwest School 100m north Baptist Chapel 100m southwest Tin, iron and copper works 170m northwest. Iron works 175m west.
1931 (1:2,500)	Building on centre of site. Building at east corner.	Building immediately southwest, demolished Sawmill 140m northwest Filled ground 167m west.
1958 (1:1,250)	Building on site demolished. Garages present throughout site.	Site is a residential area with surrounding housing. Factory 50 metres southeast.
1964 – 1987 (1:1,250)	Original garages demolished and replaced with garage in 3 formal rows.	Church to north demolished. Timber yard 155m southwest. Sidings filled and M65 constructed circa 1980.
2003 (1:10,000)	Little or no change.	Railway to east no longer present, sidings filled.
2019 (1:10,000)	Garages all demolished. Vacant plot.	No relevant change.

## **DISCUSSION**

### **Contamination**

The site was originally developed with several small buildings, thought to be associated with the nearby pub. Since they were demolished a garage colony was constructed, although these too have been demolished. It is considered raised levels of contaminants may be present from the following:

- If madeground was imported prior to construction, of the original buildings or garages.
- In demolition rubble from original buildings or garages.
- From the use of a garage colony.

Contaminants are not expected at very high levels, but may exceed stringent residential thresholds.

The site is in a residential area. There are no nearby land uses which will affect the site and no no pollution incidents on or close to the site.

The proposed development will be houses with gardens. Potential pollutant linkages are:

- Direct contact with soil.
- Ingestion of soil.
- From homegrown vegetables and soil attached to vegetables.
- Inhalation and ingestion of dust.
- Sulphate attack on buried concrete.
- Contaminants entering drinking water pipes.

A low to moderate risk to householders is anticipated.

### **Controlled Waters**

There is an underlying Secondary A aquifer beneath clay. There are no nearby water abstraction points or source protection zones.

The canal is 196 metres northwest.

Although the gardens will allow rainwater to pass through the surface soils and migrate towards the aquifer and canal, contamination is not expected at high levels. The underlying clay will further impede the migration of water, and it is anticipated there will be only a very low risk to controlled waters.

### Landfill Gas/Ground Gas

The site is within 250 metres of 2 former landfill sites. These are potential landfill gases which may pose a risk to the development.

Bearing in mind their distance from the site, and underlying clay, it is considered that there is a possible low to moderate risk to the development.

### Radon

Radon protection measures are not required.

### Flooding

The Environment Agency maps show that this site is clear of flooding.

The site is shown to be in an area with limited potential for groundwater flooding to occur.

For greater confidence a detailed flood risk assessment should be obtained.

### Foundations

It is expected that made ground will be present, with underlying clay. This can provide variable conditions for foundations and a range of options may need to be considered, including reinforced concrete raft to a piled foundation.

If foundations are to be on clay the shrinkage potential of the clay needs to be determined, to ensure foundations are below the potential effects of tree root shrinkage.

### INDUSTRY PROFILE

The site was formerly a garage colony and made ground/demolition rubble is also expected.

Industry	Possible Contaminants
Potential Contaminants	Metals: eg, copper, zinc, chromium, nickel, lead, arsenic, Inorganic compounds: cyanide, sulphates Mineral oils, fuel oils (TPHs) Asbestos General hydrocarbons (PAHs)

Asbestos from buildings and TPHs/PAHs from oil or fuel, from spills or repairs, are expected.



## **CONCEPTUAL MODEL**

A conceptual model based on the source-pathway-receptor concept is included with this desk study to show the potential pollutant linkages with this site.

Source	Receptors	Pathway	Potential/Likely Pollutant Linkage
Asbestos	Construction workers	Inhalation	Yes
	End-users	Inhalation	Yes
	Off-site	Migration off-site	Yes
Inorganic contaminants	Construction workers	Short-term direct contact, inhalation of dust, ingestion	Possible
	Householders	Direct contact, ingestion, from home grown vegetables, ingestion and inhalation of dust	Yes
	Groundwater	Leaching towards	No
	River/stream	Leaching towards	No
Sulphate	Building fabric	Concrete directly in contact with soil	Possible
Hydrocarbons	Construction workers	Short-term direct contact, inhalation of dust, ingestion	Yes
	Householders	Direct contact, ingestion, from home grown vegetables, ingestion and inhalation of dust	Yes
	Service pipes	Seeping into drinking water pipes	Yes
	Groundwater	Leaching towards	No
	River/stream	Leaching towards	No
Hydrocarbon vapours	Construction workers	Short-term inhalation	No
	Householders	Inhalation of vapours indoors and outdoors	No
Landfill gas	End-users - in buildings	Seeping into buildings, explosion, asphyxiation	Yes
Radon	End-users - in buildings	Seeping into buildings	No

## **CONCLUSION**

### **Contamination**

Taking into account the past use of the site it is thought likely that contamination will be present on the site. High levels are not expected, but may exceed stringent residential thresholds in places.

There are no specific point sources for contamination and an intrusive investigation will need to target proposed gardens.

Controlled Waters

A very low risk to controlled water is expected and no further action is considered necessary at this stage. This may need to be reviewed following the soil tests.

Landfill Gas/Ground Gas

There are two nearby landfill sites. Bearing in mind their distance and underlying clay, a low to moderate risk is anticipated.

A gas testing programme is recommended.

Radon

Radon protection measures are not required.

Flooding

The maps indicate that the area is clear of flooding.

Yours faithfully  
on behalf of Worms Eye Ltd

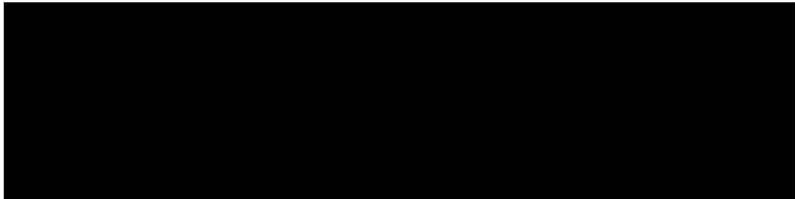

David Lord  
BSc (Hons)  
FGS, MIEvSc, AIEMA

**DUNCAN STREET, ROSEGROVE, BURNLEY, BB12 6EZ**

**LIST OF APPENDICES – PRELIMINARY RISK ASSESSMENT (Desk Study)**

**Existing Site Plan**

**Photographs of Site**

**Proposed Site Plan**

**Landmark Summary Map**

**Landmark Envirocheck Report**

**Historical Maps**

**Conceptual Model**

## ABBREVIATIONS

<u>Chemical</u>	BAP	Benzo(a)pyrene
	BTEX	Benzene, toluene, ethylbenzene, xylene
	DAHA	Dibenzo(ah)anthracene
	MTBE	Methyl tertiaryt-butyl ether (additive to petrol)
	EPH	Extractable Petroleum Hydrocarbons (formerly Diesel Range Organics – DRO)
	NFD	No fibres detected (asbestos test)
	PAH	Polycyclic aromatic hydrocarbons
	PCB	Polychlorinated biphenyls
	PID	Photo ionisation detector
	PRO/GRO	Petrol range organics/gasoline range organics
	SVOC	Semi-volatile organic compounds
	TCE	Trichloroethylene
	TPH	Total petroleum hydrocarbons
	VOC	Volatile organic compounds
<u>Other</u>	AGS	Association of Geotechnical Specialists
	BGS	British Geological Survey
	BRE	Building Research Establishment
	CBR	California Bearing Ratio
	CIEH	Chartered Institute of Environmental Health
	CIRIA	Construction Industry Research and Information Association
	CLEA	Contaminated Land Exposure Assessment (Environment Agency)
	CLR 8	Contaminated Land Research Report 8 (Environment Agency)
	DWQ	Drinking water quality
	EA	Environment Agency
	EQS	Environmental quality standards
	ICRCL	Inter-departmental Commission for the Reclamation of Contaminated Land
	LQM	Land Quality Management Ltd (Land and Environmental Consultancy)
	NHBC	National House Builders Council
	SGV	Soil Guideline Values
	SPT	Standard penetration test
	TPHWG	TPH Working Group

1. This report should be considered in relation to the objectives agreed between Worms Eye and the Client, outlined in the introduction.
2. For the work, reliance has been placed on publicly available data, obtained from the sources identified in the report. The information is not exhaustive and further information may be available from other sources. When using the information it has been assumed it is correct, and no attempt has been made to verify the information.
3. This report has been produced in accordance with current UK policy and guidelines, for land and groundwater contamination, enforced by the Local Authority and the Environment Agency.
4. During the site walkover, reasonable effort was made to obtain an overview of the site. However, no attempt was made to enter areas that are unsafe, a risk to health and safety, locked, barricaded, overgrown, or areas not made accessible.
5. Access, the presence of services and activities on the site, limited locations where sampling could be carried out and the techniques that could be used.
6. Assessments are based on available information at the time of writing and are ultimately for the decision of the regulatory authorities.
7. The conclusions and recommendations provide an overview and guidance only and should not be specifically relied upon without considering the context of the report in full.
8. Worms Eye cannot be held responsible for any use of the report or its contents for any purpose other than that for which it was prepared. The copyright of this report, and other plans or documents prepared by Worms Eye, is owned by them, and no such plans or documents may be reproduced, published or adapted without written consent. Complete copies may be made and distributed by the client, as expected, in dealing with matters related to its commission. Should the client pass copies of the report to other parties for information, the whole report should be copied, but no professional liability, or warranties, shall be extended to other parties by Worms Eye, without their written agreement.
9. New information, revised practices, or changes in legislation, may necessitate the re-interpretation of the report, in whole or in part.

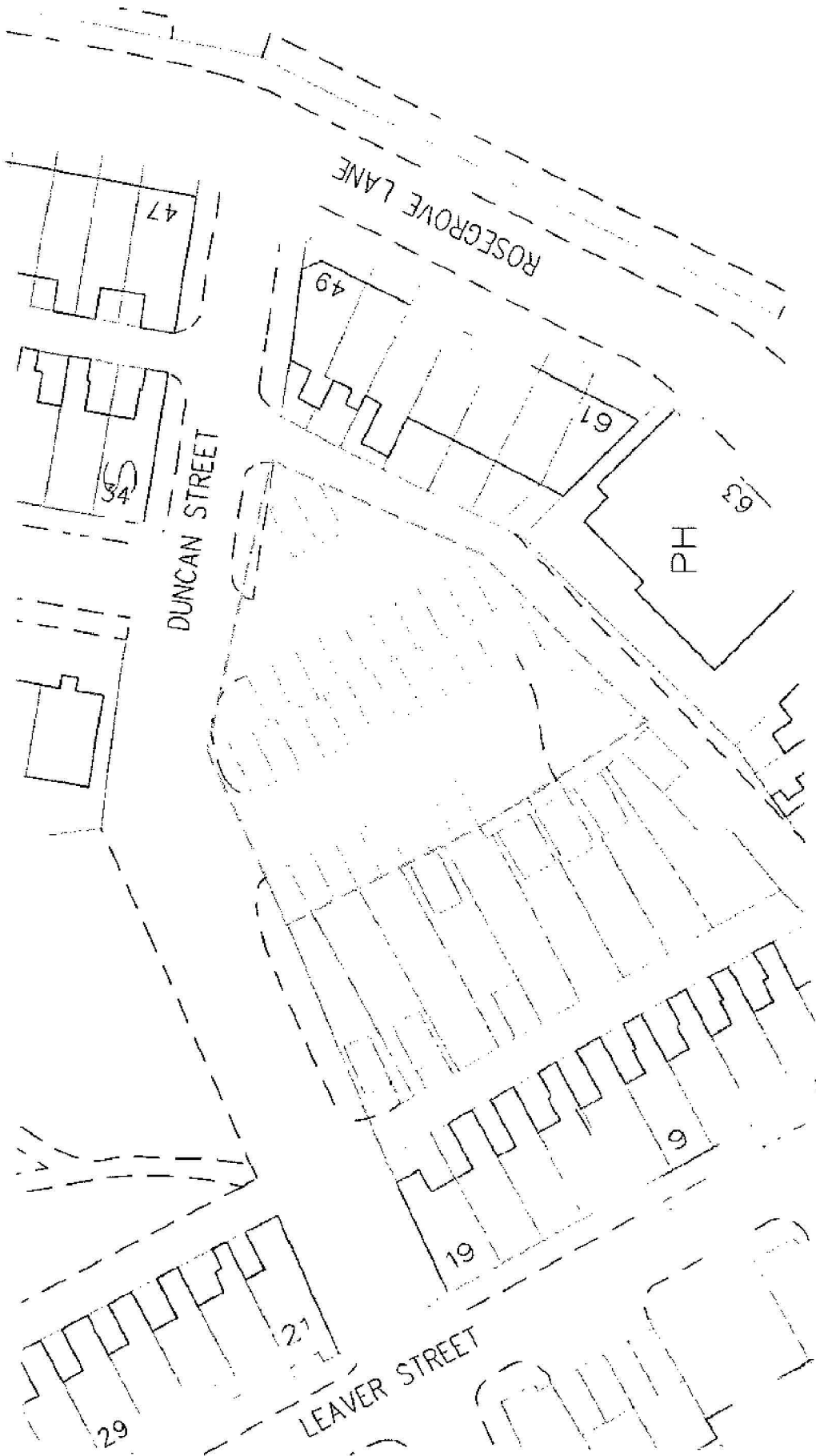

WORMS EYE LTD  
52, Bank Parade  
Burnley BB11 1TS  
Tel: 01282 414 649

Duncan Street, Bacup BB12 6EZ  
Existing Site Plan 1: 500

# Duncan Street, Rosegrove, Burnley, BB12 6EZ



panoramic view of site looking southwest



panoramic view of site looking southeast

DUNCAN STREET, ROSEGROVE, BURNLEY, BB12 6EZ - 2020



Looking Southeast



Looking Southwest



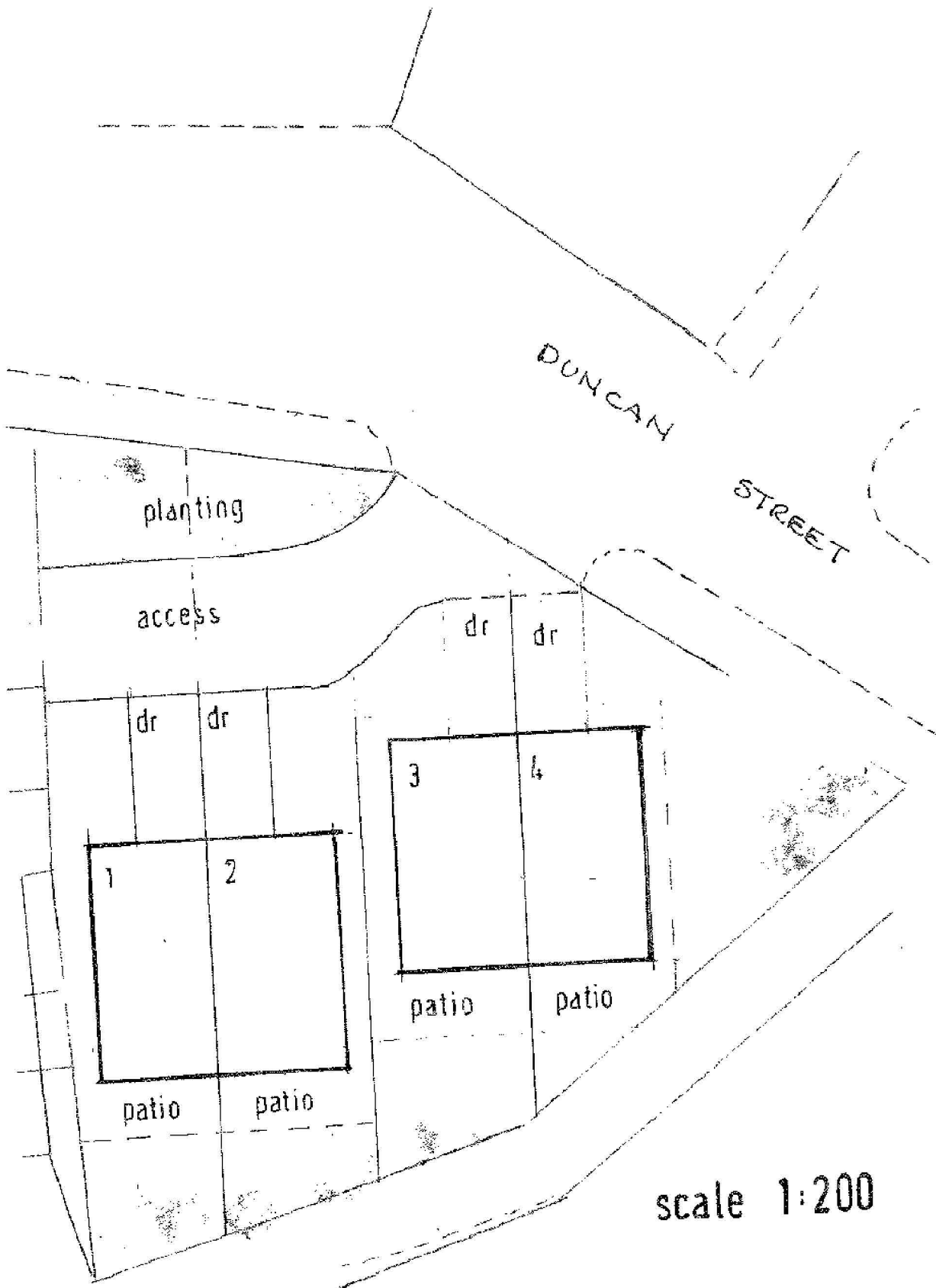

Proposed Plan  
Duncan Street  
Burnley  
BB12 6EZ

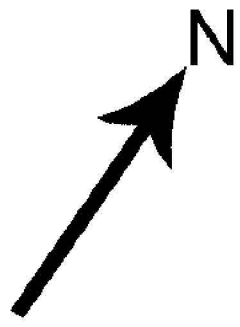

scale 1:200



## Envirocheck<sup>®</sup> Report:

### Datasheet

#### Order Details:

**Order Number:**

203537848\_1\_1

**Customer Reference:**

BB12 6EZ

**National Grid Reference:**

381520, 432410

**Slice:**

A

**Site Area (Ha):**

0.1

**Search Buffer (m):**

250

#### Site Details:

Duncan Street

Bacup

Burnley

BB12 6EZ

#### Client Details:

Mr D Lord

Worms Eye Ltd

52 Bank Parade

Burnley

Lancashire

BB11 1TS

Report Section	Page Number
Summary	-
Agency & Hydrological	1
Waste	4
Hazardous Substances	-
Geological	5
Industrial Land Use	7
Sensitive Land Use	11
Data Currency	12
Data Suppliers	17
Useful Contacts	18

### Introduction

The Environment Act 1995 has made site sensitivity a key issue, as the legislation pays as much attention to the pathways by which contamination could spread, and to the vulnerable targets of contamination, as it does the potential sources of contamination. For this reason, Landmark's Site Sensitivity maps and Datasheet(s) place great emphasis on statutory data provided by the Environment Agency/Natural Resources Wales and the Scottish Environment Protection Agency; it also incorporates data from Natural England (and the Scottish and Welsh equivalents) and Local Authorities; and highlights hydrogeological features required by environmental and geotechnical consultants. It does not include any information concerning past uses of land. The datasheet is produced by querying the Landmark database to a distance defined by the client from a site boundary provided by the client. In this datasheet the National Grid References (NGRs) are rounded to the nearest 10m in accordance with Landmark's agreements with a number of Data Suppliers.

### Copyright Notice

© Landmark Information Group Limited 2019. The Copyright on the information and data and its format as contained in this Envirocheck® Report ("Report") is the property of Landmark Information Group Limited ("Landmark") and several other Data Providers, including (but not limited to) Ordnance Survey, British Geological Survey, the Environment Agency/Natural Resources Wales and Natural England, and must not be reproduced in whole or in part by photocopying or any other method. The Report is supplied under Landmark's Terms and Conditions accepted by the Customer. A copy of Landmark's Terms and Conditions can be found with the Index Map for this report. Additional copies of the Report may be obtained from Landmark, subject to Landmark's charges in force from time to time. The Copyright, design rights and any other intellectual rights shall remain the exclusive property of Landmark and/or other Data providers, whose Copyright material has been included in this Report.  
© Environment Agency & United Kingdom Research and Innovation 2019. © Natural Resources Wales & United Kingdom Research and Innovation 2019.

### Natural England Copyright Notice

Site of Special Scientific Interest, National Nature Reserve, Ramsar, Special Protection Area, Special Conservation Area, Marine Nature Reserve data (derived from Ordnance Survey 1:10000 raster) is provided by, and used with the permission of, Natural England who retain the copyright and Intellectual Property Rights for the data.

### Scottish Natural Heritage Copyright

Contains SNH information licensed under the Open Government Licence v3.0.

### Ove Arup Copyright Notice

The Mining Instability data was obtained on licence from Ove Arup & Partners Limited (for further information, contact [mining.review@arup.com](mailto:mining.review@arup.com)). No reproduction or further use of such Data is to be made without the prior written consent of Ove Arup & Partners Limited. The supplied Mining Instability data is derived from publicly available records and other third party sources and neither Ove Arup & Partners nor Landmark warrant the accuracy or completeness of such information or data.

### Peter Brett Associates Copyright Notice

The cavity data presented has been extracted from the PBA enhanced version of the original DEFRA national cavity databases. PBA/DEFRA retain the copyright & intellectual property rights in the data. Whilst all reasonable efforts are made to check that the information contained in the cavity databases is accurate we do not warrant that the data is complete or error free. The information is based upon our own researches and those collated from a number of external sources and is continually being augmented and updated by PBA. In no event shall PBA/DEFRA or Landmark be liable for any loss or damage including, without limitation, indirect or consequential loss or damage arising from the use of this data.

### Radon Potential dataset Copyright Notice

Information supplied from a joint dataset compiled by The British Geological Survey and Public Health England.

### Natural Resources Wales Copyright Notice

Contains Natural Resources Wales information © Natural Resources Wales and Database Right. All rights Reserved. Contains Ordnance Survey Data. Ordnance Survey Licence number 100019741. Crown Copyright and Database Right. Contains Natural Resources Wales information © Natural Resources Wales and Database Right. All rights Reserved. Some features of this information are based on digital spatial data licensed from the Centre for Ecology & Hydrology © NERC (CEH), Defra, Met Office and DARD Rivers Agency © Crown copyright. © Cranfield University, © James Hutton Institute. Contains OS data © Crown copyright and database right 2019. Land & Property Services © Crown copyright and database right.

### Report Version v53.0

Data Type	Page Number	On Site	0 to 250m (*up to 500m)
<b>Agency &amp; Hydrological</b>			
BGS Groundwater Flooding Susceptibility	pg 1	Yes	Yes
Contaminated Land Register Entries and Notices			
Discharge Consents			
Prosecutions Relating to Controlled Waters			n/a
Enforcement and Prohibition Notices			
Integrated Pollution Controls			
Integrated Pollution Prevention And Control			
Local Authority Integrated Pollution Prevention And Control			
Local Authority Pollution Prevention and Controls	pg 1		1
Local Authority Pollution Prevention and Control Enforcements			
Nearest Surface Water Feature	pg 1		Yes
Pollution Incidents to Controlled Waters	pg 1		3
Prosecutions Relating to Authorised Processes	pg 2		1
Registered Radioactive Substances			
River Quality	pg 2		1
River Quality Biology Sampling Points			
River Quality Chemistry Sampling Points			
Substantiated Pollution Incident Register			
Water Abstractions	pg 2		(*1)
Water Industry Act Referrals			
Groundwater Vulnerability Map	pg 2	Yes	n/a
Groundwater Vulnerability - Soluble Rock Risk			n/a
Groundwater Vulnerability - Local Information			n/a
Bedrock Aquifer Designations	pg 2	Yes	n/a
Superficial Aquifer Designations	pg 2	Yes	n/a
Source Protection Zones			
Extreme Flooding from Rivers or Sea without Defences			
Flooding from Rivers or Sea without Defences			
Areas Benefiting from Flood Defences			
Flood Water Storage Areas			
Flood Defences			
OS Water Network Lines	pg 3		1

Data Type	Page Number	On Site	0 to 250m (* up to 500m)
<b>Waste</b>			
BGS Recorded Landfill Sites			
Historical Landfill Sites	pg 4		1
Integrated Pollution Control Registered Waste Sites			
Licensed Waste Management Facilities (Landfill Boundaries)			
Licensed Waste Management Facilities (Locations)			
Local Authority Landfill Coverage	pg 4	2	n/a
Local Authority Recorded Landfill Sites	pg 4		1
Potentially Infilled Land (Non-Water)			
Potentially Infilled Land (Water)			
Registered Landfill Sites			
Registered Waste Transfer Sites			
Registered Waste Treatment or Disposal Sites			
<b>Hazardous Substances</b>			
Control of Major Accident Hazards Sites (COMAH)			
Explosive Sites			
Notification of Installations Handling Hazardous Substances (NIHHS)			
Planning Hazardous Substance Consents			
Planning Hazardous Substance Enforcements			

Data Type	Page Number	On Site	0 to 250m (*up to 500m)
<b>Geological</b>			
BGS 1:625,000 Solid Geology	pg 5	Yes	n/a
BGS Estimated Soil Chemistry	pg 5	Yes	Yes
BGS Recorded Mineral Sites			
BGS Urban Soil Chemistry			
BGS Urban Soil Chemistry Averages			
CBSCB Compensation District			n/a
Coal Mining Affected Areas	pg 5	Yes	n/a
Mining Instability	pg 5	Yes	n/a
Man-Made Mining Cavities			
Natural Cavities			
Non Coal Mining Areas of Great Britain			
Potential for Collapsible Ground Stability Hazards	pg 5	Yes	
Potential for Compressible Ground Stability Hazards	pg 5		Yes
Potential for Ground Dissolution Stability Hazards			
Potential for Landslide Ground Stability Hazards	pg 5	Yes	Yes
Potential for Running Sand Ground Stability Hazards	pg 6	Yes	
Potential for Shrinking or Swelling Clay Ground Stability Hazards	pg 6	Yes	
Radon Potential - Radon Affected Areas			n/a
Radon Potential - Radon Protection Measures			n/a
<b>Industrial Land Use</b>			
Contemporary Trade Directory Entries	pg 7		27
Fuel Station Entries	pg 9		1
Points of Interest - Commercial Services	pg 9		5
Points of Interest - Education and Health			
Points of Interest - Manufacturing and Production	pg 9		4
Points of Interest - Public Infrastructure	pg 10		5
Points of Interest - Recreational and Environmental	pg 10		1
Gas Pipelines			
Underground Electrical Cables			

Data Type	Page Number	On Site	0 to 250m (*up to 500m)
<b>Sensitive Land Use</b>			
Ancient Woodland			
Areas of Adopted Green Belt			
Areas of Unadopted Green Belt			
Areas of Outstanding Natural Beauty			
Environmentally Sensitive Areas			
Forest Parks			
Local Nature Reserves			
Marine Nature Reserves			
National Nature Reserves			
National Parks			
Nitrate Sensitive Areas			
Nitrate Vulnerable Zones	pg 11	1	
Ramsar Sites			
Sites of Special Scientific Interest			
Special Areas of Conservation			
Special Protection Areas			
World Heritage Sites			



Map ID	Details	Quadrant Reference (Compass Direction)	Estimated Distance From Site	Contact	NGR
	<b>BGS Groundwater Flooding Susceptibility</b> Flooding Type: Limited Potential for Groundwater Flooding to Occur	A13NW (SW)	0	1	381524 432415
	<b>BGS Groundwater Flooding Susceptibility</b> Flooding Type: Potential for Groundwater Flooding of Property Situated Below Ground Level	A13NE (NE)	163	1	381650 432550
	<b>BGS Groundwater Flooding Susceptibility</b> Flooding Type: Potential for Groundwater Flooding of Property Situated Below Ground Level	A13SE (SE)	190	1	381650 432250
	<b>BGS Groundwater Flooding Susceptibility</b> Flooding Type: Limited Potential for Groundwater Flooding to Occur	A13SW (S)	192	1	381524 432200
	<b>BGS Groundwater Flooding Susceptibility</b> Flooding Type: Limited Potential for Groundwater Flooding to Occur	A13SE (S)	193	1	381550 432200
	<b>BGS Groundwater Flooding Susceptibility</b> Flooding Type: Limited Potential for Groundwater Flooding to Occur	A13SE (S)	206	1	381600 432200
	<b>BGS Groundwater Flooding Susceptibility</b> Flooding Type: Potential for Groundwater Flooding of Property Situated Below Ground Level	A13NE (E)	207	1	381750 432450
	<b>BGS Groundwater Flooding Susceptibility</b> Flooding Type: Potential for Groundwater Flooding to Occur at Surface	A13NE (E)	218	1	381750 432500
	<b>BGS Groundwater Flooding Susceptibility</b> Flooding Type: Potential for Groundwater Flooding of Property Situated Below Ground Level	A13SE (SE)	227	1	381700 432250
	<b>BGS Groundwater Flooding Susceptibility</b> Flooding Type: Potential for Groundwater Flooding of Property Situated Below Ground Level	A13NE (N)	231	1	381600 432850
1	<b>Local Authority Pollution Prevention and Controls</b> Name: Futaba Tenneco Uk Ltd Location: Liverpool Road, BURNLEY, Lancashire, BB12 6HJ Authority: Burnley Borough Council, Planning and Environment Permit Reference: Wo 3 Dated: 27th June 2001 Process Type: Local Authority Air Pollution Control Description: PG1/Waste oil burners, less than 0.4MW net rated thermal input Status: Authorisation revoked Positional Accuracy: Manually positioned to the address or location	A13NW (W)	229	2	381278 432454
	<b>Nearest Surface Water Feature</b>	A13NW (NW)	196	-	381388 432583
2	<b>Pollution Incidents to Controlled Waters</b> Property Type: Not Given Location: Location Description Not Available Authority: Environment Agency, North West Region Pollutant: Oils - Diesel (Including Agricultural) Note: Not Supplied Incident Date: 24th March 1993 Incident Reference: 93330099 Catchment Area: Leeds Liverpool Canal - North Receiving Water: Not Given Cause of Incident: Unknown Incident Severity: Category 2 - Significant Incident Positional Accuracy: Located by supplier to within 100m	A13NW (N)	171	3	381500 432800
3	<b>Pollution Incidents to Controlled Waters</b> Property Type: Industrial: Other Location: Burnley Road, RAWTENSTALL Authority: Environment Agency, North West Region Pollutant: Miscellaneous - Fire water / Foam Note: Not Supplied Incident Date: 6th June 1998 Incident Reference: SO980998 Catchment Area: Irwell Receiving Water: Freshwater Stream/River Cause of Incident: Fire Incident Severity: Category 3 - Minor Incident Positional Accuracy: Located by supplier to within 100m	A13SW (W)	207	3	381300 432395

Map ID	Details	Quadrant Reference (Compass Direction)	Estimated Distance From Site	Contact	NGR
3	<p><b>Pollution Incidents to Controlled Waters</b></p> <p>Property Type: Not Given            Location: Leeds Liverpool Canal, ROSE GROVE            Authority: Environment Agency, North West Region            Pollutant: Oils - Diesel (Including Agricultural)            Note: Leeds Liverpool Canal: Diesel            Incident Date: 15th January 1997            Incident Reference: 97330036            Catchment Area: Calder - Lincs            Receiving Water: Canal            Cause of Incident: Unknown            Incident Severity: Category 3 - Minor Incident            Positional Accuracy: Located by supplier to within 100m</p>	A13SW (W)	207	3	381300 432400
4	<p><b>Prosecutions Relating to Authorised Processes</b></p> <p>Location: Rose Grove Ironworks, White Street, Burnley, Lancashire, BB12 6JQ            Prosecution Text: EA News Release 26/11/1998 (Case 1 of 2), Depositing &amp; keeping controlled waste on land at Rose Grove Ironworks.            Prosecution Act: EPA90 s33(1a)(1b)(6)            Hearing Date: 28th November 1998            Verdict: Guilty            Fine: 20000            Costs: 398.5            Positional Accuracy: Manually positioned to the road within the address or location</p>	A13NE (NE)	246	3	381649 432648
	<p><b>River Quality</b></p> <p>Name: Leeds/Liverpool Canal            GQA Grade: River Quality C            Reach: Rishton To Blakey Hall            Estimated Distance (km): 29.1            Flow Rate: Flow greater than 80 cumecs            Flow Type: Canal            Year: 2000</p>	A13NW (NW)	211	3	381413 432616
	<p><b>Water Abstractions</b></p> <p>Operator: British Waterways            Licence Number: 2671331014            Permit Version: 100            Location: Leeds And Liverpool Canal, At Rose Grove, Burnley.            Authority: Environment Agency, North West Region            Abstraction: Other Industrial/Commercial/Public Services: General Cooling (Existing Licences Only) (Low Loss)            Abstraction Type: Water may be abstracted from a single point            Source: Surface            Daily Rate (m3): 295            Yearly Rate (m3): 68190            Details: Waterside Mill Burnley.            Authorised Start: 01 January            Authorised End: 31 December            Permit Start Date: 30th April 1975            Permit End Date: Not Supplied            Positional Accuracy: Located by supplier to within 100m</p>	A13NE (N)	280	3	381600 432700
	<p><b>Groundwater Vulnerability Map</b></p> <p>Combined Classification: Secondary Superficial Aquifer - Low Vulnerability            Combined Vulnerability: Low            Combined Aquifer: Productive Bedrock Aquifer, Productive Superficial Aquifer            Pollutant Speed: Low            Bedrock Flow: Well Connected Fractures            Dilution: &gt;550 mm/year            Baseflow Index: &lt;40%            Superficial Patchiness: &gt;90%            Superficial Thickness: 3-10m            Superficial Recharge: Low</p>	A13NW (SW)	0	4	381524 432415
	<p><b>Groundwater Vulnerability - Soluble Rock Risk</b></p> <p>None</p>				
	<p><b>Bedrock Aquifer Designations</b></p> <p>Aquifer Designation: Secondary Aquifer - A</p>	A13NW (SW)	0	4	381524 432415
	<p><b>Superficial Aquifer Designations</b></p> <p>Aquifer Designation: Secondary Aquifer - Undifferentiated</p>	A13NW (SW)	0	4	381524 432415
	<p><b>Extreme Flooding from Rivers or Sea without Defences</b></p> <p>None</p>				

Map ID	Details	Quadrant Reference (Compass Direction)	Estimated Distance From Site	Contact	NGR
	<b>Flooding from Rivers or Sea without Defences</b> None				
	<b>Areas Benefiting from Flood Defences</b> None				
	<b>Flood Water Storage Areas</b> None				
	<b>Flood Defences</b> None				
5	<b>OS Water Network Lines</b> Watercourse Form: Canal Watercourse Length: 2368.8 Watercourse Level: On ground surface Permanent: True Watercourse Name: Leeds and Liverpool Canal Catchment Name: Ribble Primacy: 1	A13NW (NW)	204	5	381382 432589

Map ID	Details	Quadrant Reference (Compass Direction)	Estimated Distance From Site	Contact	NGR
6	<b>Historical Landfill Sites</b> Licence Holder: Not Supplied Location: Off Rose Grove Lane, Rose Grove, Burnley, Lancashire Name: Railway Sidings Operator Location: Not Supplied Boundary Accuracy: As Supplied Provider Reference: EAHLD07400 First Input Date: Not Supplied Last Input Date: Not Supplied Specified Waste: Deposited Waste included Unknown Material Type: EA Waste Ref: 0 Regis Ref: Not Supplied WRC Ref: 2300/0547 BGS Ref: Not Supplied Other Ref: K1/12/048	A13SE (SE)	35	3	381567 432390
	<b>Local Authority Landfill Coverage</b> Name: Burnley Borough Council - Has supplied landfill data		0	6	381524 432415
	<b>Local Authority Landfill Coverage</b> Name: Lancashire County Council - Had landfill data but passed it to the relevant environment agency		0	7	381524 432415
7	<b>Local Authority Recorded Landfill Sites</b> Location: Not Supplied Reference: Not Supplied Authority: Burnley Borough Council Last Reported: Unknown Status: Types of Waste: Not Supplied Date of Closure: Not Supplied Positional Accuracy: Positioned by the supplier Boundary Quality: Moderate	A13SE (SE)	101	6	381575 432304

Map ID	Details	Quadrant Reference (Compass Direction)	Estimated Distance From Site	Contact	NGR
	<b>BGS 1:625,000 Solid Geology</b> Description: Pennine Lower Coal Measures Formation And South Wales Lower Coal Measures Formation (Undifferentiated)	A13NW (SW)	0	1	381524 432415
	<b>BGS Estimated Soil Chemistry</b> Source: British Geological Survey, National Geoscience Information Service Soil Sample Type: Sediment Arsenic: <15 mg/kg Concentration: Cadmium: 1.8 - 2.2 mg/kg Concentration: Chromium: 60 - 90 mg/kg Concentration: Lead Concentration: <100 mg/kg Nickel: 15 - 30 mg/kg Concentration:	A13NW (SW)	0	1	381524 432415
	<b>BGS Estimated Soil Chemistry</b> Source: British Geological Survey, National Geoscience Information Service Soil Sample Type: Sediment Arsenic: <15 mg/kg Concentration: Cadmium: 2.2 - 3.0 mg/kg Concentration: Chromium: 60 - 90 mg/kg Concentration: Lead Concentration: <100 mg/kg Nickel: 15 - 30 mg/kg Concentration:	A13NW (W)	5	1	381500 432415
	<b>BGS Measured Urban Soil Chemistry</b> No data available				
	<b>BGS Urban Soil Chemistry Averages</b> No data available				
	<b>Coal Mining Affected Areas</b> Description: In an area which may be affected by coal mining activity. It is recommended that a coal mining report is obtained from the Coal Authority. Contact details are included in the Useful Contacts section of this report.	A13NW (SW)	0	9	381524 432415
	<b>Mining Instability</b> Mining Evidence: Inconclusive Coal Mining Source: Ove Arup & Partners Boundary Quality: As Supplied	A13NW (SW)	0	-	381524 432415
	<b>Non Coal Mining Areas of Great Britain</b> No Hazard				
	<b>Potential for Collapsible Ground Stability Hazards</b> Hazard Potential: Very Low Source: British Geological Survey, National Geoscience Information Service	A13NW (SW)	0	1	381524 432415
	<b>Potential for Compressible Ground Stability Hazards</b> Hazard Potential: No Hazard Source: British Geological Survey, National Geoscience Information Service	A13NW (SW)	0	1	381524 432415
	<b>Potential for Compressible Ground Stability Hazards</b> Hazard Potential: Moderate Source: British Geological Survey, National Geoscience Information Service	A13SE (S)	117	1	381564 432282
	<b>Potential for Compressible Ground Stability Hazards</b> Hazard Potential: Very Low Source: British Geological Survey, National Geoscience Information Service	A13SW (SW)	144	1	381393 432325
	<b>Potential for Compressible Ground Stability Hazards</b> Hazard Potential: Very Low Source: British Geological Survey, National Geoscience Information Service	A13SW (SW)	147	1	381448 432265
	<b>Potential for Compressible Ground Stability Hazards</b> Hazard Potential: Very Low Source: British Geological Survey, National Geoscience Information Service	A13SE (SE)	247	1	381712 432233
	<b>Potential for Ground Dissolution Stability Hazards</b> Hazard Potential: No Hazard Source: British Geological Survey, National Geoscience Information Service	A13NW (SW)	0	1	381524 432415
	<b>Potential for Landslide Ground Stability Hazards</b> Hazard Potential: Very Low Source: British Geological Survey, National Geoscience Information Service	A13NW (SW)	0	1	381524 432415

Map ID	Details	Quadrant Reference (Compass Direction)	Estimated Distance From Site	Contact	NGR
	<b>Potential for Landslide Ground Stability Hazards</b> Hazard Potential: Low Source: British Geological Survey, National Geoscience Information Service	A13SE (S)	196	1	381539 432196
	<b>Potential for Running Sand Ground Stability Hazards</b> Hazard Potential: Very Low Source: British Geological Survey, National Geoscience Information Service	A13NW (SW)	0	1	381524 432415
	<b>Potential for Shrinking or Swelling Clay Ground Stability Hazards</b> Hazard Potential: Very Low Source: British Geological Survey, National Geoscience Information Service	A13NW (SW)	0	1	381524 432415
	<b>Radon Potential - Radon Affected Areas</b> Affected Area: The property is in a Lower probability radon area (less than 1% of homes are estimated to be at or above the Action Level). Source: British Geological Survey, National Geoscience Information Service	A13NW (SW)	0	1	381524 432415
	<b>Radon Potential - Radon Protection Measures</b> Protection Measure: No radon protective measures are necessary in the construction of new dwellings or extensions Source: British Geological Survey, National Geoscience Information Service	A13NW (SW)	0	1	381524 432415

Map ID	Details	Quadrant Reference (Compass Direction)	Estimated Distance From Site	Contact	NGR
8	<b>Contemporary Trade Directory Entries</b> Name: D D Dampproofing Location: 6, Melcalfe Street, Burnley, Lancashire, BB12 6HN Classification: Damp & Dry Rot Control Status: Inactive Positional Accuracy: Automatically positioned to the address	A13NE (N)	78	-	381559 432502
8	<b>Contemporary Trade Directory Entries</b> Name: Kelth Hanns Location: 15, Rosegrove Lane, Burnley, Lancashire, BB12 6HX Classification: Food Products - Manufacturers Status: Inactive Positional Accuracy: Automatically positioned to the address	A13NE (NE)	85	-	381576 432504
9	<b>Contemporary Trade Directory Entries</b> Name: Motorpoint Location: Rosegrove Lane, Burnley, Lancashire, BB12 6EH Classification: Car Customisation & Conversion Specialists Status: Active Positional Accuracy: Automatically positioned to the address	A13SE (E)	87	-	381630 432408
9	<b>Contemporary Trade Directory Entries</b> Name: Motorpoint Of Burnley Location: Rosegrove Lane, Burnley, Lancashire, BB12 6EH Classification: Car Dealers Status: Inactive Positional Accuracy: Automatically positioned to the address	A13SE (E)	87	-	381630 432408
10	<b>Contemporary Trade Directory Entries</b> Name: Rosegrove Service Station Location: Liverpool Road, Burnley, Lancashire, BB12 6HH Classification: Petrol Filling Stations Status: Inactive Positional Accuracy: Automatically positioned to the address	A13NW (W)	143	-	381365 432452
10	<b>Contemporary Trade Directory Entries</b> Name: Liverpool Road Garage Location: Liverpool Rd, Burnley, Lancashire, BB12 6HQ Classification: Garage Services Status: Inactive Positional Accuracy: Manually positioned to the road within the address or location	A13NW (W)	163	-	381344 432451
11	<b>Contemporary Trade Directory Entries</b> Name: Farnworth Motor Care Location: Dorset St, Burnley, Lancashire, BB12 6HS Classification: Garage Services Status: Inactive Positional Accuracy: Manually positioned within the geographical locality	A13NW (NW)	160	-	381413 432557
11	<b>Contemporary Trade Directory Entries</b> Name: Complete Tile & Stone Solutions Location: 3, Radcliffe Court, Burnley, Lancashire, BB12 6EY Classification: Commercial Cleaning Services Status: Inactive Positional Accuracy: Automatically positioned to the address	A13NW (NW)	177	-	381393 432563
12	<b>Contemporary Trade Directory Entries</b> Name: L B S Location: Unit 7 Beech House, Smallshaw Lane, Burnley, Lancashire, BB11 5SQ Classification: Sheet Metal Work Status: Active Positional Accuracy: Automatically positioned to the address	A13SE (S)	167	-	381539 432225
13	<b>Contemporary Trade Directory Entries</b> Name: R T C Safety Surfaces Location: Woodland House, Smallshaw Lane, Burnley, BB11 5SQ Classification: Asphalt & Coated Macadam Laying Contractors Status: Active Positional Accuracy: Automatically positioned to the address	A13SE (SE)	170	-	381606 432243
14	<b>Contemporary Trade Directory Entries</b> Name: Gannow Lane Car Sales Location: Unit 15, Old Dexter Paints Building, Gannow Lane, Burnley, Lancashire, BB12 6HY Classification: Car Dealers - Used Status: Inactive Positional Accuracy: Manually positioned within the geographical locality	A13NE (NE)	189	-	381665 432571

Map ID	Details	Quadrant Reference (Compass Direction)	Estimated Distance From Site	Contact	NGR
14	<b>Contemporary Trade Directory Entries</b> Name: Barnes J B Ltd Location: Chapel House, Gannow Lane, Burnley, BB12 6HY Classification: Hardware Status: Inactive Positional Accuracy: Automatically positioned to the address	A13NE (NE)	195	-	381635 432599
14	<b>Contemporary Trade Directory Entries</b> Name: Jesscam Transport Location: Gannow La, Burnley, Lancashire, BB12 6HY Classification: Road Haulage Services Status: Inactive Positional Accuracy: Manually positioned to the road within the address or location	A13NE (NE)	199	-	381666 432583
15	<b>Contemporary Trade Directory Entries</b> Name: Utility Vehicles UK Location: Liverpool Road, Burnley, Lancashire, BB12 6HH Classification: Commercial Vehicle Dealers Status: Inactive Positional Accuracy: Manually positioned within the geographical locality	A13NW (NW)	201	-	381335 432533
15	<b>Contemporary Trade Directory Entries</b> Name: Premier Cars Of Burnley Location: Liverpool Rd, Burnley, Lancashire, BB12 6HH Classification: Car Dealers - Used Status: Inactive Positional Accuracy: Manually positioned to the road within the address or location	A13NW (NW)	212	-	381310 432510
16	<b>Contemporary Trade Directory Entries</b> Name: Wise World Enterprises Ltd Location: Unit 4, Beech House, Smallshaw Lane, Burnley, Lancashire, BB11 5SQ Classification: Textile Manufacturing Status: Active Positional Accuracy: Automatically positioned to the address	A13SE (SE)	204	-	381679 432259
17	<b>Contemporary Trade Directory Entries</b> Name: Futaba Tenneco UK Ltd Location: Liverpool Road, Burnley, Lancashire, BB12 6HJ Classification: Exhaust System Manufacturers & Wholesalers Status: Inactive Positional Accuracy: Automatically positioned to the address	A13NW (W)	227	-	381280 432454
17	<b>Contemporary Trade Directory Entries</b> Name: Futaba-Tenneco (UK) Ltd Location: Liverpool Road, Burnley, Lancashire, BB12 6HJ Classification: Exhaust System Manufacturers & Wholesalers Status: Inactive Positional Accuracy: Automatically positioned to the address	A13NW (W)	227	-	381280 432454
17	<b>Contemporary Trade Directory Entries</b> Name: Futaba-Tenneco Location: Liverpool Road, Burnley, Lancashire, BB12 6HJ Classification: Manufacturers Status: Inactive Positional Accuracy: Automatically positioned to the address	A13NW (W)	227	-	381280 432454
18	<b>Contemporary Trade Directory Entries</b> Name: First European Logistics Ltd Location: 2, Empire Way, Burnley, BB12 6HA Classification: Road Haulage Services Status: Inactive Positional Accuracy: Automatically positioned to the address	A13NW (NW)	243	-	381346 432610
18	<b>Contemporary Trade Directory Entries</b> Name: Best Merc Deals Location: Suite 303 Burnley Business Centre, Liverpool Road, Burnley, Lancashire, BB12 6HA Classification: Car Component Manufacturers Status: Active Positional Accuracy: Manually positioned within the geographical locality	A13NW (NW)	243	-	381346 432610
18	<b>Contemporary Trade Directory Entries</b> Name: Two Way Radio Sales & Hire Location: 2 Empire Way, Burnley, Lancashire, BB12 6HH Classification: Radio Communication Equipment Status: Active Positional Accuracy: Manually positioned within the geographical locality	A13NW (NW)	243	-	381346 432610



Map ID	Details	Quadrant Reference (Compass Direction)	Estimated Distance From Site	Contact	NGR
18	<b>Contemporary Trade Directory Entries</b> Name: Dugdale Davies Pet Treats Ltd Location: Burnley, BB12 6LT Classification: Pet Foods & Animal Feeds Status: Active Positional Accuracy: Automatically positioned to the address	A13NW (NW)	245	-	381347 432614
18	<b>Contemporary Trade Directory Entries</b> Name: Dave Burnett Vehicle Solutions Ltd Location: Office 303, Empire Business Centre, 2, Empire Way, Burnley, BB12 6HA Classification: Car Dealers Status: Active Positional Accuracy: Automatically positioned to the address	A13NW (NW)	245	-	381347 432614
18	<b>Contemporary Trade Directory Entries</b> Name: E P Bitumen Location: Office 311-312 Liverpool Road, Burnley, Lancashire, BB12 6HH Classification: Asphalt & Macadam Suppliers Status: Active Positional Accuracy: Manually positioned to the address or location	A13NW (NW)	245	-	381346 432613
19	<b>Contemporary Trade Directory Entries</b> Name: Acorn Office Equipment Ltd Location: Systems House, Rosegrove Lane, Burnley, Lancashire, BB11 5AA Classification: Office Furniture & Equipment Status: Inactive Positional Accuracy: Automatically positioned to the address	A13SW (S)	243	-	381438 432164
19	<b>Contemporary Trade Directory Entries</b> Name: Acorn Leisurewear Location: Systems House, Rosegrove Lane, Burnley, Lancashire, BB11 5AA Classification: T-Shirts Status: Inactive Positional Accuracy: Manually positioned to the address or location	A13SW (S)	244	-	381438 432163
20	<b>Fuel Station Entries</b> Name: Rosegrove Service Station Location: Liverpool Road, Rose Grove, Burnley, Lancashire, BB12 6HH Brand: Unbranded Premises Type: Not Applicable Status: Obsolete Positional Accuracy: Automatically positioned to the address	A13NW (W)	143	-	381365 432452
21	<b>Points of Interest - Commercial Services</b> Name: Wards of Burnley Location: 320 Gannow Lane, Burnley, BB12 6HY Category: Repair and Servicing Class Code: Vehicle Repair, Testing and Servicing Positional Accuracy: Positioned to address or location	A13NE (NE)	150	10	381620 432556
22	<b>Points of Interest - Commercial Services</b> Name: C K Motors Location: Unit, 7 Chestnut Business Park Smallshaw Lane, Burnley, BB11 5SQ Category: Repair and Servicing Class Code: Vehicle Repair, Testing and Servicing Positional Accuracy: Positioned to address or location	A13SE (S)	167	10	381538 432225
22	<b>Points of Interest - Commercial Services</b> Name: L B S Location: Unit 7 Beech House, Smallshaw Lane, Burnley, BB11 5SQ Category: Construction Services Class Code: Metalworkers Including Blacksmiths Positional Accuracy: Positioned to address or location	A13SE (S)	167	10	381539 432225
23	<b>Points of Interest - Commercial Services</b> Name: First European Logistics Ltd Location: 2 Empire Way, Burnley, BB12 6HA Category: Transport, Storage and Delivery Class Code: Distribution and Haulage Positional Accuracy: Positioned to address or location	A13NW (NW)	243	10	381346 432610
23	<b>Points of Interest - Commercial Services</b> Name: R B Asbestos Consultants Location: Unit 2 Empire Way, Burnley, BB12 6HA Category: Recycling Services Class Code: Recycling, Reclamation and Disposal Positional Accuracy: Positioned to address or location	A13NW (NW)	245	10	381347 432614
24	<b>Points of Interest - Manufacturing and Production</b> Name: Works Location: Not Supplied Category: Industrial Features Class Code: Unspecified Works Or Factories Positional Accuracy: Positioned to an adjacent address or location	A13NW (NW)	173	10	381426 432580

Map ID	Details	Quadrant Reference (Compass Direction)	Estimated Distance From Site	Contact	NGR
24	<b>Points of Interest - Manufacturing and Production</b> Name: B 1 Business Centre Ltd Location: Liverpool Road, Burnley, BB12 6HH Category: Industrial Features Class Code: Business Parks and Industrial Estates Positional Accuracy: Positioned to address or location	A13NW (NW)	243	10	381346 432610
25	<b>Points of Interest - Manufacturing and Production</b> Name: Works Location: BB12 Category: Industrial Features Class Code: Unspecified Works Or Factories Positional Accuracy: Positioned to address or location	A13NW (W)	224	10	381283 432458
25	<b>Points of Interest - Manufacturing and Production</b> Name: Works Location: Not Supplied Category: Industrial Features Class Code: Unspecified Works Or Factories Positional Accuracy: Positioned to an adjacent address or location	A13NW (W)	227	10	381291 432503
26	<b>Points of Interest - Public Infrastructure</b> Name: Rose Grove Rail Station Location: BB11 Category: Public Transport, Stations and Infrastructure Class Code: Railway Stations, Junctions and Halts Positional Accuracy: Positioned to address or location	A13SW (S)	136	10	381513 432258
26	<b>Points of Interest - Public Infrastructure</b> Name: Rose Grove Station Location: Nr Woodsley Street, BB12 Category: Public Transport, Stations and Infrastructure Class Code: Railway Stations, Junctions and Halts Positional Accuracy: Positioned to address or location	A13SW (S)	136	10	381513 432258
27	<b>Points of Interest - Public Infrastructure</b> Name: Rosegrove Service Station Location: Liverpool Road, Burnley, BB12 6HH Category: Road And Rail Class Code: Petrol and Fuel Stations Positional Accuracy: Positioned to address or location	A13NW (W)	143	10	381365 432452
27	<b>Points of Interest - Public Infrastructure</b> Name: Rosegrove Service Station Location: Liverpool Road, Burnley, BB12 6HH Category: Road And Rail Class Code: Petrol and Fuel Stations Positional Accuracy: Positioned to address or location	A13NW (W)	143	10	381365 432452
27	<b>Points of Interest - Public Infrastructure</b> Name: Rosegrove Service Station Location: Liverpool Road, Burnley, BB12 6HH Category: Road And Rail Class Code: Petrol and Fuel Stations Positional Accuracy: Positioned to address or location	A13NW (W)	143	10	381365 432452
28	<b>Points of Interest - Recreational and Environmental</b> Name: Play Area Location: Not Supplied Category: Recreational Class Code: Playgrounds Positional Accuracy: Positioned to an adjacent address or location	A13NW (NW)	55	10	381492 432480

Map ID	Details	Quadrant Reference (Compass Direction)	Estimated Distance From Site	Contact	NGR
29	<p><b>Nitrate Vulnerable Zones</b></p> <p>Name: Calder - Pendle Water To Conf Ribble Nvz</p> <p>Description: Surface Water</p> <p>Source: Environment Agency, Head Office</p>	A13NW (SW)	0	4	381524 432415

Agency & Hydrological	Version	Update Cycle
<b>Contaminated Land Register Entries and Notices</b> Burnley Borough Council - Planning and Environment	February 2013	Annual Rolling Update
<b>Discharge Consents</b> Environment Agency - North West Region	January 2019	Quarterly
<b>Enforcement and Prohibition Notices</b> Environment Agency - North West Region	March 2013	Annual Rolling Update
<b>Integrated Pollution Controls</b> Environment Agency - North West Region	October 2008	Variable
<b>Integrated Pollution Prevention And Control</b> Environment Agency - North West Region	January 2019	Quarterly
<b>Local Authority Integrated Pollution Prevention And Control</b> Burnley Borough Council - Planning and Environment	November 2014	Variable
<b>Local Authority Pollution Prevention and Controls</b> Burnley Borough Council - Planning and Environment	November 2014	Not Applicable
<b>Local Authority Pollution Prevention and Control Enforcements</b> Burnley Borough Council - Planning and Environment	November 2014	Variable
<b>Nearest Surface Water Feature</b> Ordnance Survey	January 2019	
<b>Pollution Incidents to Controlled Waters</b> Environment Agency - North West Region	January 2000	Not Applicable
<b>Prosecutions Relating to Authorised Processes</b> Environment Agency - North West Region	March 2013	Annual Rolling Update
<b>Prosecutions Relating to Controlled Waters</b> Environment Agency - North West Region	March 2013	Annual Rolling Update
<b>Registered Radioactive Substances</b> Environment Agency - North West Region	June 2016	
<b>River Quality</b> Environment Agency - Head Office	November 2001	Not Applicable
<b>River Quality Biology Sampling Points</b> Environment Agency - Head Office	July 2012	Annually
<b>River Quality Chemistry Sampling Points</b> Environment Agency - Head Office	July 2012	Annually
<b>Substantiated Pollution Incident Register</b> Environment Agency - North West Region - Central Area Environment Agency - North West Region - North Area	January 2019 January 2019	Quarterly Quarterly
<b>Water Abstractions</b> Environment Agency - North West Region	January 2019	Quarterly
<b>Water Industry Act Referrals</b> Environment Agency - North West Region	October 2017	Quarterly
<b>Groundwater Vulnerability Map</b> Environment Agency - Head Office	June 2018	Annually
<b>Bedrock Aquifer Designations</b> Environment Agency - Head Office	January 2018	Annually
<b>Superficial Aquifer Designations</b> Environment Agency - Head Office	January 2018	Annually
<b>Source Protection Zones</b> Environment Agency - Head Office	January 2019	Quarterly
<b>Extreme Flooding from Rivers or Sea without Defences</b> Environment Agency - Head Office	February 2019	Quarterly
<b>Flooding from Rivers or Sea without Defences</b> Environment Agency - Head Office	February 2019	Quarterly

Agency & Hydrological	Version	Update Cycle
<b>Areas Benefiting from Flood Defences</b> Environment Agency - Head Office	February 2019	Quarterly
<b>Flood Water Storage Areas</b> Environment Agency - Head Office	February 2019	Quarterly
<b>Flood Defences</b> Environment Agency - Head Office	February 2019	Quarterly
<b>OS Water Network Lines</b> Ordnance Survey	January 2019	Quarterly
<b>Surface Water 1 in 30 year Flood Extent</b> Environment Agency - Head Office	October 2013	Annually
<b>Surface Water 1 in 100 year Flood Extent</b> Environment Agency - Head Office	October 2013	Annually
<b>Surface Water 1 in 1000 year Flood Extent</b> Environment Agency - Head Office	October 2013	Annually
<b>Surface Water Suitability</b> Environment Agency - Head Office	October 2013	Annually
<b>BGS Groundwater Flooding Susceptibility</b> British Geological Survey - National Geoscience Information Service	May 2013	Annually
Waste	Version	Update Cycle
<b>BGS Recorded Landfill Sites</b> British Geological Survey - National Geoscience Information Service	June 1996	Not Applicable
<b>Historical Landfill Sites</b> Environment Agency - Head Office	July 2018	Quarterly
<b>Integrated Pollution Control Registered Waste Sites</b> Environment Agency - North West Region	October 2008	Not Applicable
<b>Licensed Waste Management Facilities (Landfill Boundaries)</b> Environment Agency - North West Region - Central Area Environment Agency - North West Region - North Area	July 2018 July 2018	Quarterly Quarterly
<b>Licensed Waste Management Facilities (Locations)</b> Environment Agency - North West Region - Central Area Environment Agency - North West Region - North Area	January 2019 January 2019	Quarterly Quarterly
<b>Local Authority Landfill Coverage</b> Burnley Borough Council Lancashire County Council - Waste Management Group	May 2000 May 2000	Not Applicable Not Applicable
<b>Local Authority Recorded Landfill Sites</b> Burnley Borough Council Lancashire County Council - Waste Management Group	May 2000 May 2000	Not Applicable Not Applicable
<b>Potentially Infilled Land (Non-Water)</b> Landmark Information Group Limited	December 1999	Not Applicable
<b>Potentially Infilled Land (Water)</b> Landmark Information Group Limited	December 1999	Not Applicable
<b>Registered Landfill Sites</b> Environment Agency - North West Region - Central Area Environment Agency - North West Region - North Area	March 2003 March 2003	Not Applicable Not Applicable
<b>Registered Waste Transfer Sites</b> Environment Agency - North West Region - Central Area Environment Agency - North West Region - North Area	March 2003 March 2003	Not Applicable Not Applicable
<b>Registered Waste Treatment or Disposal Sites</b> Environment Agency - North West Region - Central Area Environment Agency - North West Region - North Area	March 2003 March 2003	Not Applicable Not Applicable

<b>Hazardous Substances</b>	<b>Version</b>	<b>Update Cycle</b>
<b>Control of Major Accident Hazards Sites (COMAH)</b> Health and Safety Executive	April 2018	Bi-Annually
<b>Explosive Sites</b> Health and Safety Executive	March 2017	Annually
<b>Notification of Installations Handling Hazardous Substances (NIHHS)</b> Health and Safety Executive	November 2000	Not Applicable
<b>Planning Hazardous Substance Enforcements</b> Burnley Borough Council - Planning Services Lancashire County Council	February 2016 February 2016	Variable Variable
<b>Planning Hazardous Substance Consents</b> Burnley Borough Council - Planning Services Lancashire County Council	February 2016 February 2016	Variable Variable
<b>Geological</b>	<b>Version</b>	<b>Update Cycle</b>
<b>BGS 1:625,000 Solid Geology</b> British Geological Survey - National Geoscience Information Service	January 2009	Not Applicable
<b>BGS Estimated Soil Chemistry</b> British Geological Survey - National Geoscience Information Service	October 2015	Annually
<b>BGS Recorded Mineral Sites</b> British Geological Survey - National Geoscience Information Service	April 2019	Bi-Annually
<b>CBSCB Compensation District</b> Cheshire Brine Subsidence Compensation Board (CBSCB)	August 2011	Not Applicable
<b>Coal Mining Affected Areas</b> The Coal Authority - Property Searches	March 2014	Annual Rolling Update
<b>Mining Instability</b> Ove Arup & Partners	October 2000	Not Applicable
<b>Non Coal Mining Areas of Great Britain</b> British Geological Survey - National Geoscience Information Service	May 2015	Not Applicable
<b>Potential for Collapsible Ground Stability Hazards</b> British Geological Survey - National Geoscience Information Service	January 2019	Annually
<b>Potential for Compressible Ground Stability Hazards</b> British Geological Survey - National Geoscience Information Service	January 2019	Annually
<b>Potential for Ground Dissolution Stability Hazards</b> British Geological Survey - National Geoscience Information Service	January 2019	Annually
<b>Potential for Landslide Ground Stability Hazards</b> British Geological Survey - National Geoscience Information Service	January 2019	Annually
<b>Potential for Running Sand Ground Stability Hazards</b> British Geological Survey - National Geoscience Information Service	January 2019	Annually
<b>Potential for Shrinking or Swelling Clay Ground Stability Hazards</b> British Geological Survey - National Geoscience Information Service	January 2019	Annually
<b>Radon Potential - Radon Affected Areas</b> British Geological Survey - National Geoscience Information Service	July 2011	Annually
<b>Radon Potential - Radon Protection Measures</b> British Geological Survey - National Geoscience Information Service	July 2011	Annually

<b>Industrial Land Use</b>	<b>Version</b>	<b>Update Cycle</b>
<b>Contemporary Trade Directory Entries</b> Thomson Directories	January 2019	Quarterly
<b>Fuel Station Entries</b> Catalist Ltd - Experian	May 2019	Quarterly
<b>Gas Pipelines</b> National Grid	July 2014	
<b>Points of Interest - Commercial Services</b> PointX	November 2018	Quarterly
<b>Points of Interest - Education and Health</b> PointX	November 2018	Quarterly
<b>Points of Interest - Manufacturing and Production</b> PointX	November 2018	Quarterly
<b>Points of Interest - Public Infrastructure</b> PointX	November 2018	Quarterly
<b>Points of Interest - Recreational and Environmental</b> PointX	November 2018	Quarterly
<b>Underground Electrical Cables</b> National Grid	December 2015	

<b>Sensitive Land Use</b>	<b>Version</b>	<b>Update Cycle</b>
<b>Ancient Woodland</b> Natural England	August 2018	Bi-Annually
<b>Areas of Adopted Green Belt</b> Burnley Borough Council	March 2019	As notified
<b>Areas of Unadopted Green Belt</b> Burnley Borough Council	March 2019	As notified
<b>Areas of Outstanding Natural Beauty</b> Natural England	August 2018	Bi-Annually
<b>Environmentally Sensitive Areas</b> Natural England	January 2017	
<b>Forest Parks</b> Forestry Commission	April 1997	Not Applicable
<b>Local Nature Reserves</b> Natural England	March 2019	Bi-Annually
<b>Marine Nature Reserves</b> Natural England	January 2018	Bi-Annually
<b>National Nature Reserves</b> Natural England	August 2018	Bi-Annually
<b>National Parks</b> Natural England	April 2017	Bi-Annually
<b>Nitrate Vulnerable Zones</b> Environment Agency - Head Office Department for Environment, Food and Rural Affairs (DEFRA - formerly FRCA)	December 2017 October 2015	Bi-Annually
<b>Ramsar Sites</b> Natural England	April 2019	Bi-Annually
<b>Sites of Special Scientific Interest</b> Natural England	March 2019	Bi-Annually
<b>Special Areas of Conservation</b> Natural England	August 2018	Bi-Annually
<b>Special Protection Areas</b> Natural England	April 2019	Bi-Annually



A selection of organisations who provide data within this report

Data Supplier	Data Supplier Logo
Ordnance Survey	
Environment Agency	
Scottish Environment Protection Agency	
The Coal Authority	
British Geological Survey	 <b>British Geological Survey</b> NATURAL ENVIRONMENT RESEARCH COUNCIL
Centre for Ecology and Hydrology	 <b>Centre for Ecology &amp; Hydrology</b> NATURAL ENVIRONMENT RESEARCH COUNCIL
Natural Resources Wales	
Scottish Natural Heritage	
Natural England	
Public Health England	
Ove Arup	
Peter Brett Associates	

Contact	Name and Address	Contact Details
1	<b>British Geological Survey - Enquiry Service</b> British Geological Survey, Environmental Science Centre, Keyworth, Nottingham, Nottinghamshire, NG12 5GG	Telephone: 0115 936 3143 Fax: 0115 936 3276 Email: enquiries@bgs.ac.uk Website: www.bgs.ac.uk
2	<b>Burnley Borough Council - Planning and Environment</b> 1st Floor, Parker Lane, Burnley, Lancashire, BB11 2DT	Telephone: 01282 425011 Fax: 01282 779012 Website: www.burnley.gov.uk
3	<b>Environment Agency - National Customer Contact Centre (NCCC)</b> PO Box 544, Templeborough, Rotherham, S60 1BY	Telephone: 03708 506 506 Email: enquiries@environment-agency.gov.uk
4	<b>Environment Agency - Head Office</b> Rio House, Waterside Drive, Aztec West, Almondsbury, Bristol, Avon, BS32 4UD	Telephone: 01454 624400 Fax: 01454 624409
5	<b>Ordnance Survey</b> Adanac Drive, Southampton, Hampshire, SO16 0AS	Telephone: 03456 05 05 05 Email: customerservices@ordnancesurvey.co.uk Website: www.ordnancesurvey.gov.uk
6	<b>Burnley Borough Council</b> Town Hall, Manchester Road, Burnley, Lancashire, BB11 1JA	Telephone: 01282 425011 Fax: 01282 414799 Website: www.burnley.gov.uk
7	<b>Lancashire County Council - Waste Management Group</b> Environment Directorate, Guild House, Cross Street, Preston, Lancashire, PR1 8RD	Website: www.lancashire.gov.uk
8	<b>Burnley Borough Council - Planning Services</b> POBox 29, Parker Lane Offices, Burnley, Lancashire, BB11 2DT	Telephone: 01282 425011 Fax: 01282 477272 Email: planning@burnley.gov.uk Website: www.burnley.gov.uk
9	<b>The Coal Authority - Property Searches</b> 200 Lichfield Lane, Mansfield, Nottinghamshire, NG18 4RG	Telephone: 0345 762 6848 Fax: 01623 837 338 Email: groundstability@coal.gov.uk Website: www2.groundstability.com
10	<b>PointX</b> 7 Abbey Court, Eagle Way, Sowton, Exeter, Devon, EX2 7HY	Website: www.pointx.co.uk
11	<b>Natural England</b> County Hall, Spetchley Road, Worcester, WR5 2NP	Telephone: 0300 060 3900 Email: enquiries@naturalengland.org.uk Website: www.naturalengland.org.uk
-	<b>Public Health England - Radon Survey, Centre for Radiation, Chemical and Environmental Hazards</b> Chilton, Didcot, Oxfordshire, OX11 0RQ	Telephone: 01235 822622 Fax: 01235 833891 Email: radon@phe.gov.uk Website: www.ukradon.org
-	<b>Landmark Information Group Limited</b> Imperium, Imperial Way, Reading, Berkshire, RG2 0TD	Telephone: 0844 844 9952 Fax: 0844 844 9951 Email: customerservices@landmarkinfo.co.uk Website: www.landmarkinfo.co.uk

Please note that the Environment Agency / Natural Resources Wales / SEPA have a charging policy in place for enquiries.

## Lancashire And Furness Published 1848

### Source map scale - 1:10,560

The historical maps shown were reproduced from maps predominantly held at the scale adopted for England, Wales and Scotland in the 1840's. In 1854 the 1:2,500 scale was adopted for mapping urban areas; these maps were used to update the 1:10,560 maps. The published date given therefore is often some years later than the surveyed data. Before 1930, all OS maps were based on the Cassini Projection, with independent surveys of a single area being carried out at different times. In the late 1940's, a Provisional Edition was produced, which updated the 1:10,560 mapping on a number of sections. The maps appear unfinished - with all military camps and other strategic sites removed. These maps were initially overlaid with the National Grid. In 1970, the first 1:10,000 maps were produced using the Transverse Mercator Projection. The revision process continued until recently, with new editions appearing every 10 years or so for urban areas.

### Map Name(s) and Date(s)

05/600	1848	1:10,560
06/400	1848	1:10,560

### Historical Map - Slice A

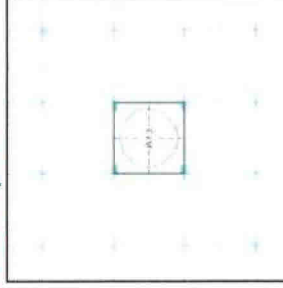

### Order Details

Order Number: 203537848\_1\_1  
 Customer Ref: BB12 6EZ  
 National Grid Reference: 381520, 432410  
 Slice: A  
 Site Area (Ha): 0.1  
 Search Buffer (m): 250

### Site Details

Duncan Street, Bacup, Burnley, BB12 6EZ

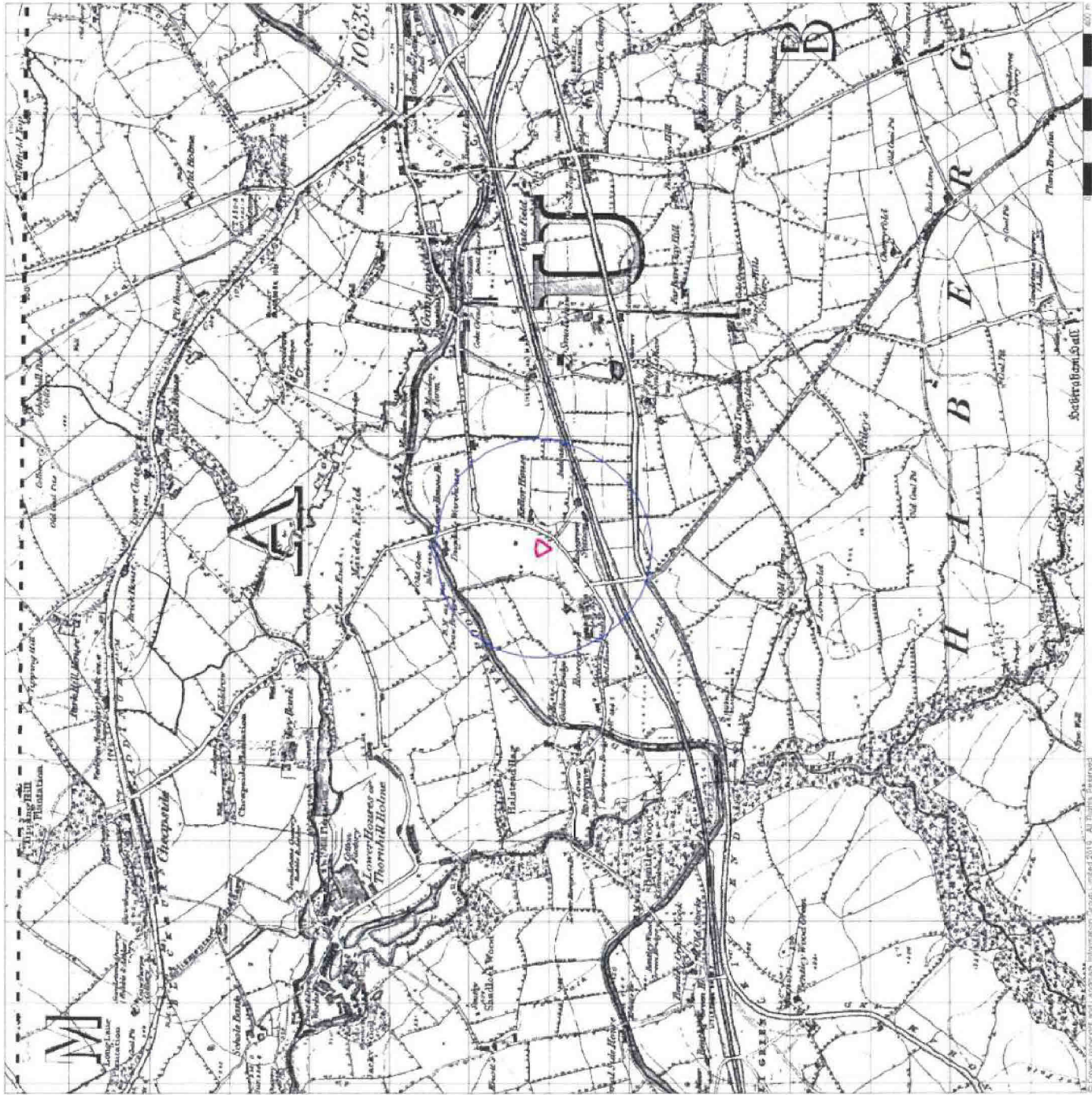

## Lancashire And Furness

Published 1893

Source map scale - 1:2,500

The historical maps shown were reproduced from maps predominantly held at the scale adopted for England, Wales and Scotland in the 1840's. In 1854 the 1:2,500 scale was adopted for mapping urban areas and by 1859 for the whole of Great Britain. The published date given below is often the date of the original survey. The published date given below is often the date of the original survey. The published date given below is often the date of the original survey. The published date given below is often the date of the original survey.

### Map Name(s) and Date(s)

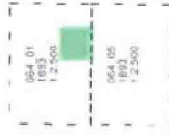

### Historical Map - Segment A13

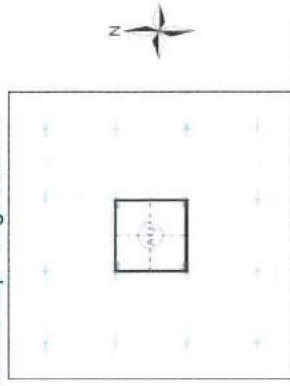

### Order Details

Order Number: 203537848\_1\_1  
 Customer Ref: BB12 6EZ  
 National Grid Reference: 381520, 432410

Site: A  
 Site Area (Ha): 0.1  
 Search Buffer (m): 100

### Site Details

Duncan Street, Bacup, Burnley, BB12 6EZ

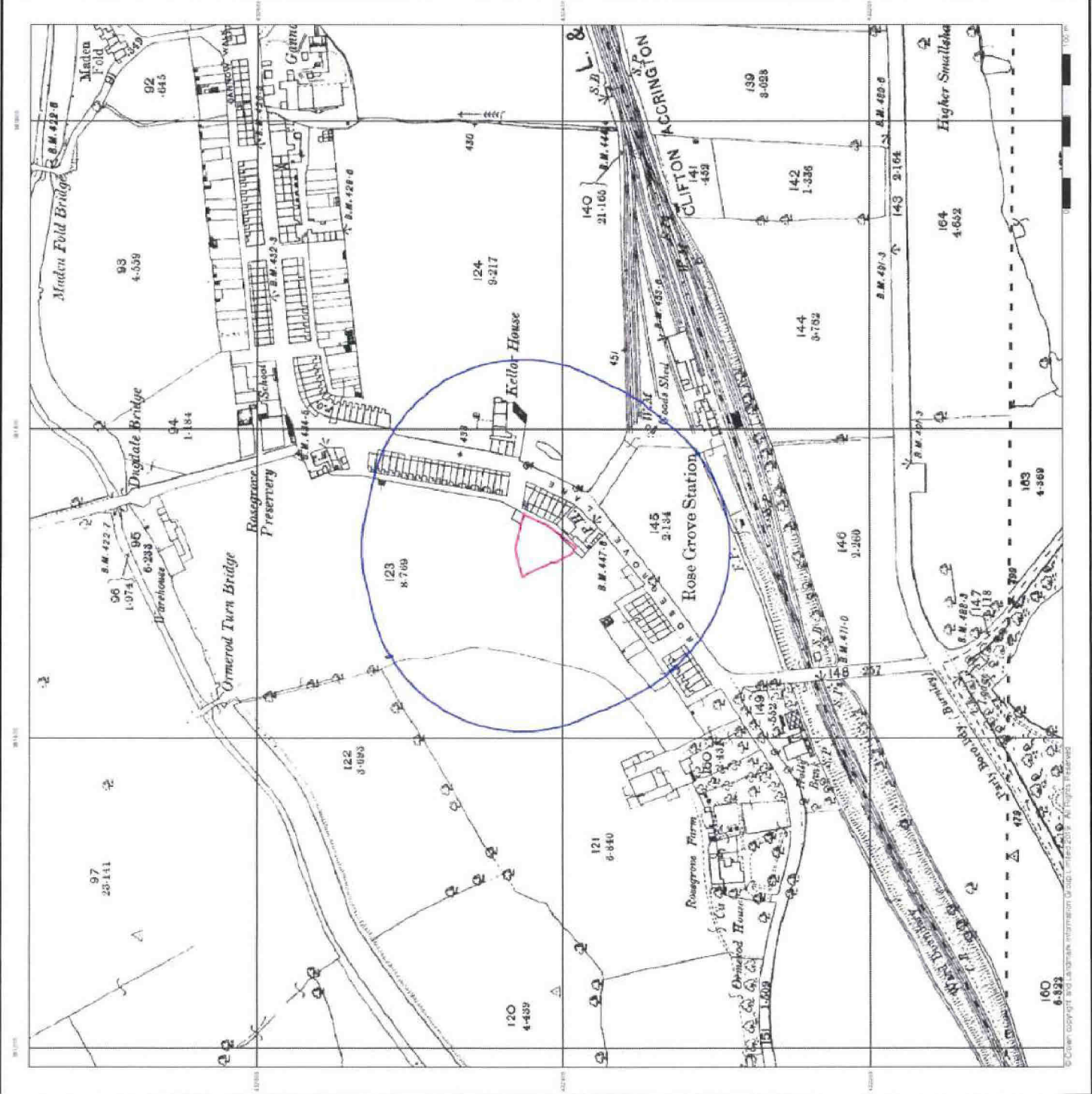

## Lancashire And Furness

Published 1912

Source map scale - 1:2,500

The historical maps shown were reproduced from maps predominantly held at the scale adopted for England, Wales, and Scotland in the 1940's. In 1854 a 1:2,500 scale was adopted for mapping urban areas and by 1899 it covered the whole of Great Britain. The published date given below is often some years later than the surveyed date. Before 1838 all OS maps were based on the Cassin Projection, with independent surveys of a single county or group of counties giving rise to significant inaccuracies in outlying areas.

### Map Name(s) and Date(s)

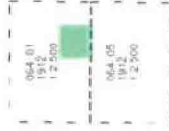

### Historical Map - Segment A13

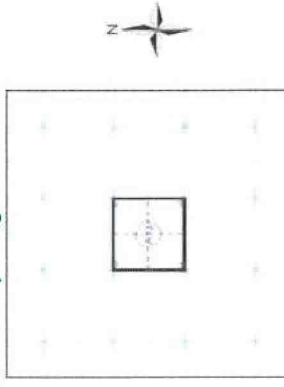

### Order Details

Order Number: 203537848\_1\_1  
 Customer Ref: BB12 6EZ  
 National Grid Reference: 381520, 432410

Slice: A  
 Site Area (Ha): 0.1  
 Search Buffer (m): 100

### Site Details

Duncan Street, Bacup, Burnley, BB12 6EZ



The historical maps shown were reproduced from maps predominantly held at the scale adopted for England, Wales and Scotland in the 1840's. In 1854 the 1:2,500 scale was adopted for mapping urban areas and by 1856 it covered the whole of what were considered to be the cultivated parts of Great Britain. The maps were produced by the Ordnance Survey from the surveyed data. Before 1938 all OS maps were based on the Cassin Projection, with independent surveys of a single county or group of counties, giving rise to significant inaccuracies in outlying areas.

#### Map Name(s) and Date(s)

064 01	1931	1:2,500
064 05	1931	1:2,500

#### Historical Map - Segment A13

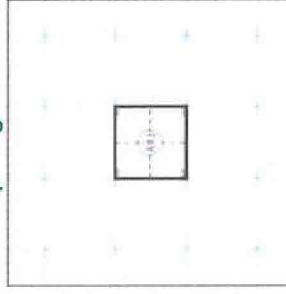

#### Order Details

Order Number: 203537948\_1\_1  
 Customer Ref: BB12 6EZ  
 National Grid Reference: 381520, 432410  
 Slice: A  
 Site Area (Ha): 0.1  
 Search Buffer (m): 100

#### Site Details

Duncan Street, Bacup, Burnley, BB12 6EZ

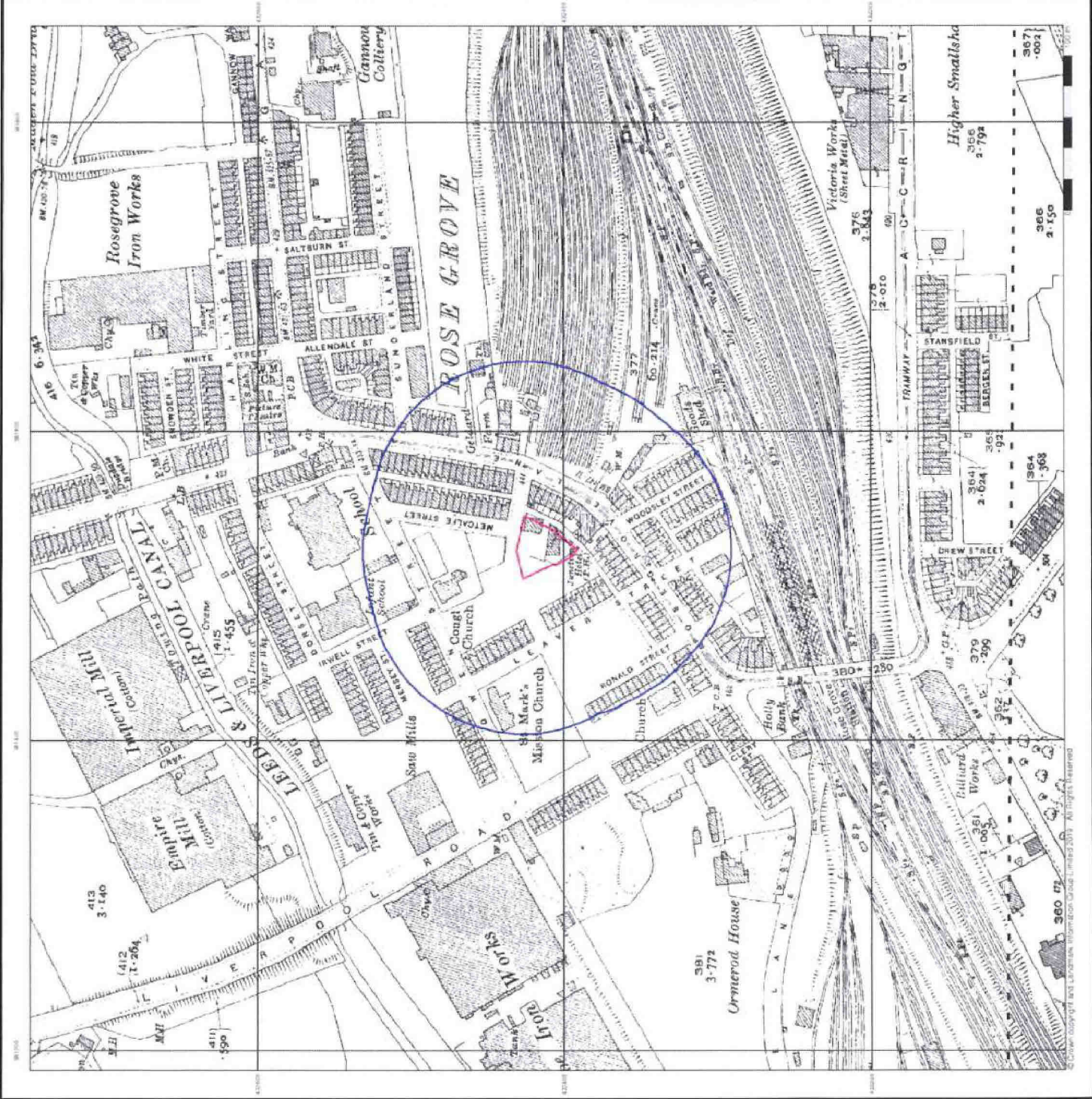

© Crown Copyright and Landmark Information Group Limited 2019. All Rights Reserved

## Ordnance Survey Plan Published 1958

### Source map scale - 1:1,250

The historical maps shown were reproduced from maps predominantly held at the scale adopted for England, Wales and Scotland in the 1940's. In 1854 the 1:2,500 scale was adopted for mapping urban areas and by 1895 it covered the whole of what were considered to be the cultivated parts of Great Britain. The published date given below is often some years later than the surveyed date. Before 1958, all OS maps were based on the Cassini projection, except in the case of a single county or group of counties, giving rise to significant inaccuracies in surveying areas.

### Map Name(s) and Date(s)

EDMUNDSON	1958	11 250
ROSEBANK	1958	11 250
ROSEBANK	1958	11 250
ROSEBANK	1958	11 250

### Historical Map - Segment A13

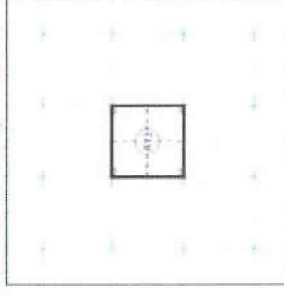

### Order Details

Order Number: 203537848\_1\_1  
 Customer Ref: 8812 6EZ  
 National Grid Reference: 381520, 432410  
 Slice: A  
 Site Area (Ha): 0.1  
 Search Buffer (m): 100

### Site Details

Duncan Street, Bacup, Burnley, BB12 6EZ

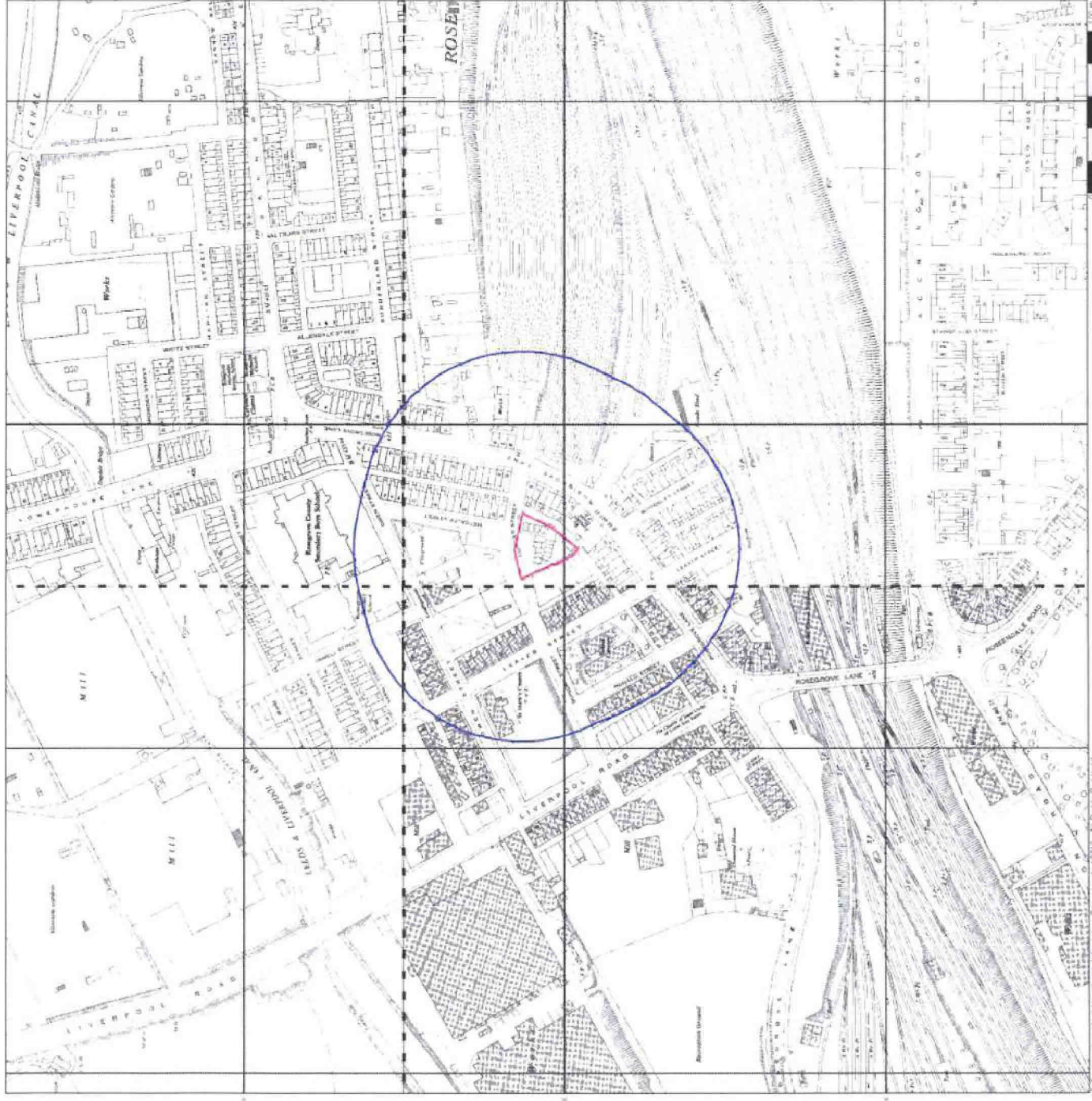

© Crown copyright and Landmark Information Group Limited 2019. All Rights Reserved.

## Ordnance Survey Plan Published 1960

Source map scale - 1:2,500

The historical maps shown were reproduced from maps predominantly held at the scale adopted for England, Wales and Scotland in the 1840's. In 1854 the 1:2,500 scale was adopted for mapping urban areas and by 1895 it covered the whole or part of the cultivated parts of Great Britain. The published date given below is often some years later than the date the map was first published. The maps are based on the Cassini projection with independent surveys for any one or group of countries, giving rise to significant inaccuracies in outlying areas.

### Map Name(s) and Date(s)



### Historical Map - Segment A13

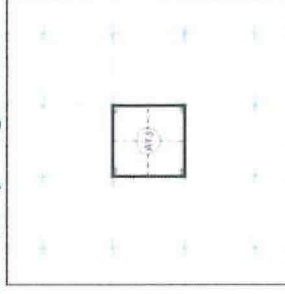

### Order Details

Order Number: 203537848\_L1  
 Customer Ref: BB12 6EZ  
 National Grid Reference: 381520, 432410  
 Slice: A  
 Site Area (Ha): 0.1  
 Search Buffer (m): 100

### Site Details

Duncan Street, Bacup, Burnley, BB12 6EZ

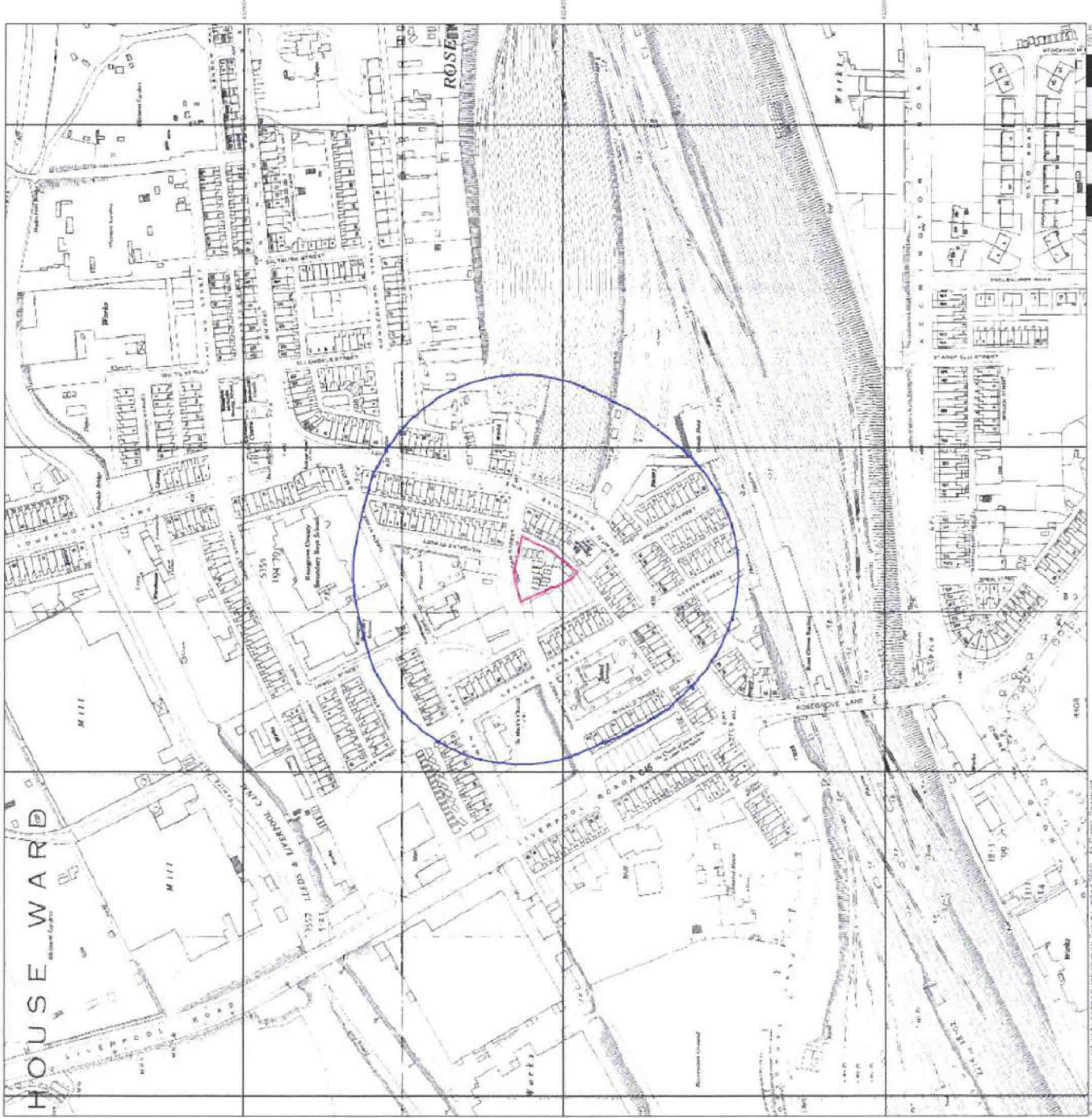



## Ordnance Survey Plan Published 1964 - 1987

Source map scale - 1:1,250

The historical maps shown were reproduced from maps predominantly held at the scale adopted for England, Wales and Scotland in the 1840's. In 1854 the 1:2,500 scale was adopted for mapping urban areas and by 1895 it covered the whole of what were considered to be the cultivated parts of Great Britain. The published date given below is often some years later than the date of the original map. All OS maps were based on the Cassini Projection, with independent surveying of any territory or group of countries, giving rise to significant inaccuracies in outlying areas.

### Map Name(s) and Date(s)

SO8132NW	SO8132NE
1970	1984
11,250	11,250
SO8133W	SO8133E
1970	1973
11,250	11,250

### Historical Map - Segment A13

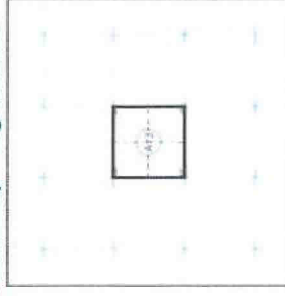

### Order Details

Order Number: 203537848\_L1  
 Customer Ref: BB12 6EZ  
 National Grid Reference: 361520, 432410  
 Slice: A  
 Site Area (Ha): 0.1  
 Search Buffer (m): 100

### Site Details

Duncan Street, Bacup, Burnley, BB12 6EZ

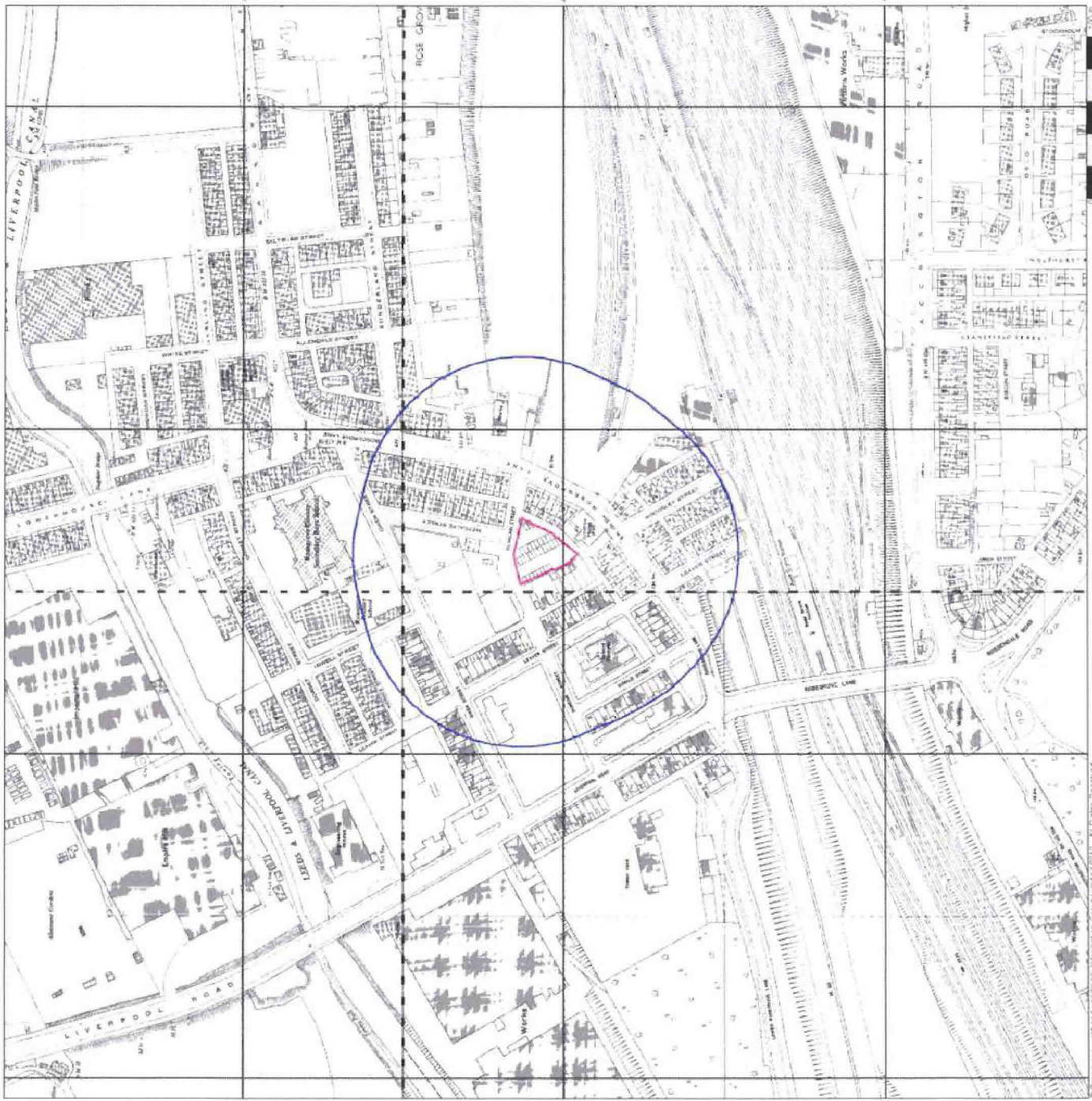

© Crown Copyright and Landmark Information Group Limited 2019. All Rights Reserved.

## VectorMap Local Published 2019

Source map scale - 1:10,000

VectorMap Local (Resier) is Ordnance Survey's highest detailed 'backdrop' mapping product. These maps are produced from OS's VectorMap Local, a simple vector dataset at a nominal scale of 1:10,000, covering the whole of Great Britain, that has been designed for creating graphical mapping. OS VectorMap Local is derived from large-scale information surveyed at 1:1250 scale (covering major towns and cities), 1:2500 scale (smaller towns, villages and dispersed rural areas), and 1:10,000 scale (mountain, moorland and river estuary areas).

### Map Name(s) and Date(s)



### Historical Map - Slice A

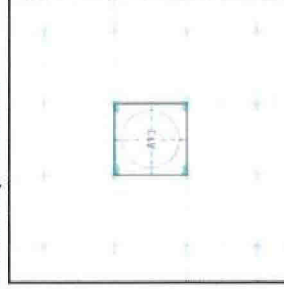

### Order Details

Order Number: 203637948\_1\_1  
 Customer Ref: BB'12 6EZ\_41  
 National Grid Reference: 381520, 432410  
 Slice: A  
 Site Area (Ha): 0.1  
 Search Buffer (m): 250

### Site Details

Duncan Street, Bacup, Burnley, BB'12 6EZ

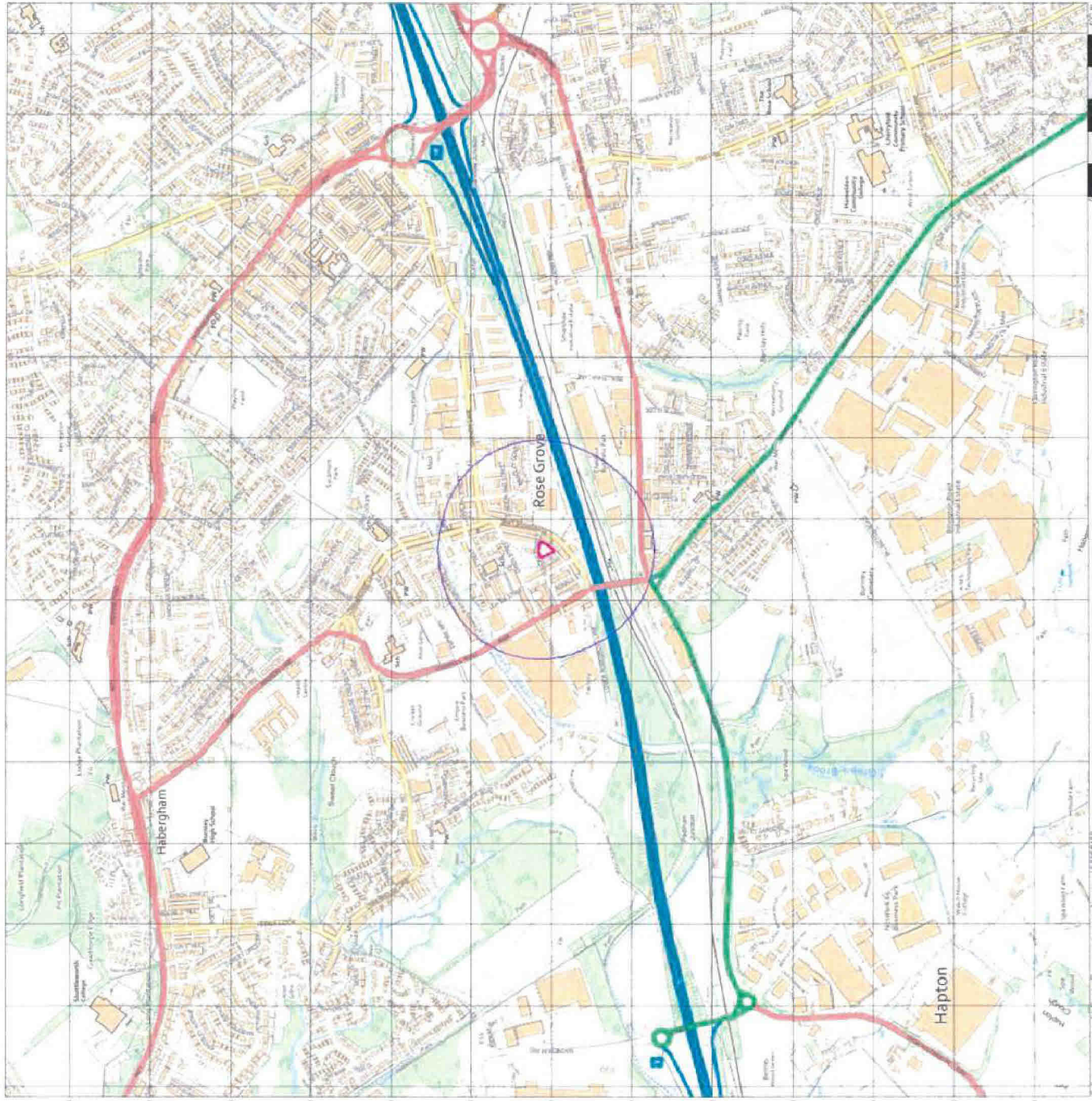

© Crown copyright. All Rights Reserved. Licence Number: 100052439

site is a former garage colony.

potential contaminants: Heavy metals, cyanide, sulphate, TPHs, PAHs, Asbestos.

low to moderate risk to householders anticipated.

very low risk to controlled waters expected.

low to moderate gas risk anticipated.

radon protection not required.

DUNCAN STREET, ROSEGROVE,  
BURNLEY, BB12 6EZ,

Conceptual Model based on PRA

Not to Scale      22.05.19

WORMS EVE

52 Bank Parade  
Burnley, BB11 1TS

01282 414 649

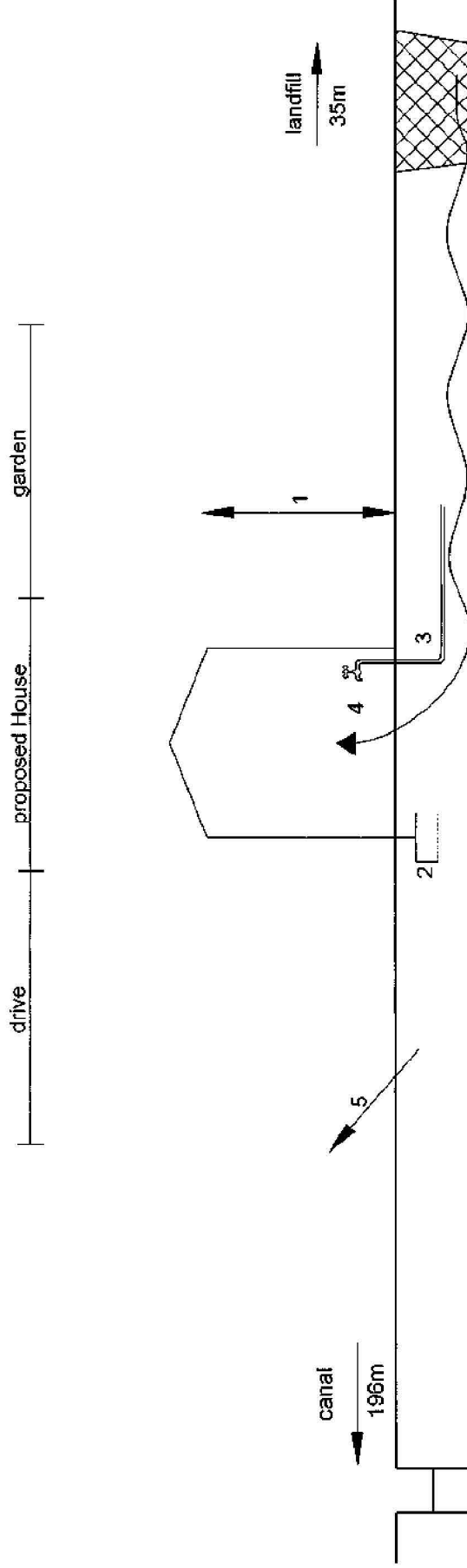

landfill / ground gas

clay (secondary undifferentiated aquifer)  
sandstone (secondary aquifer)

1. direct contact / ingestion / inhalation and ingestion of dust.
2. direct contact with building pipes.
3. contaminants entering drinking water pipes.
4. inhalation / explosion of gases.
5. migration off-site.