

**MEDIUM INSPECTION CHAMBER DETAIL**  
0.6m-1.2m FROM COVER TO INVERT  
FOR USE IN LANDSCAPED AREAS

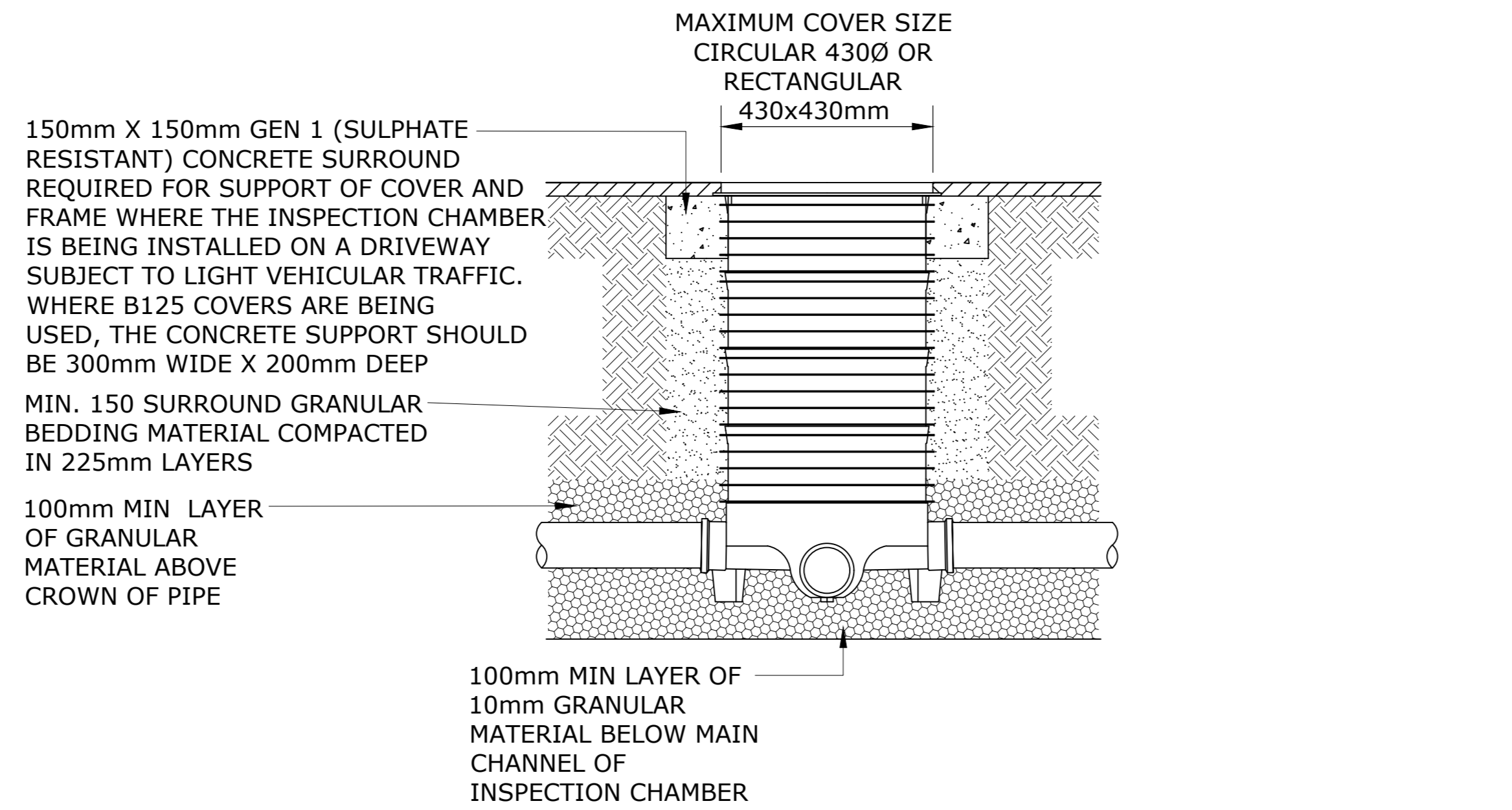

**MEDIUM INSPECTION CHAMBER DETAIL**  
0.6m-1.2m FROM COVER TO INVERT  
FOR USE IN HARD PAVED (LIGHTLY TRAFFICKED) AREAS

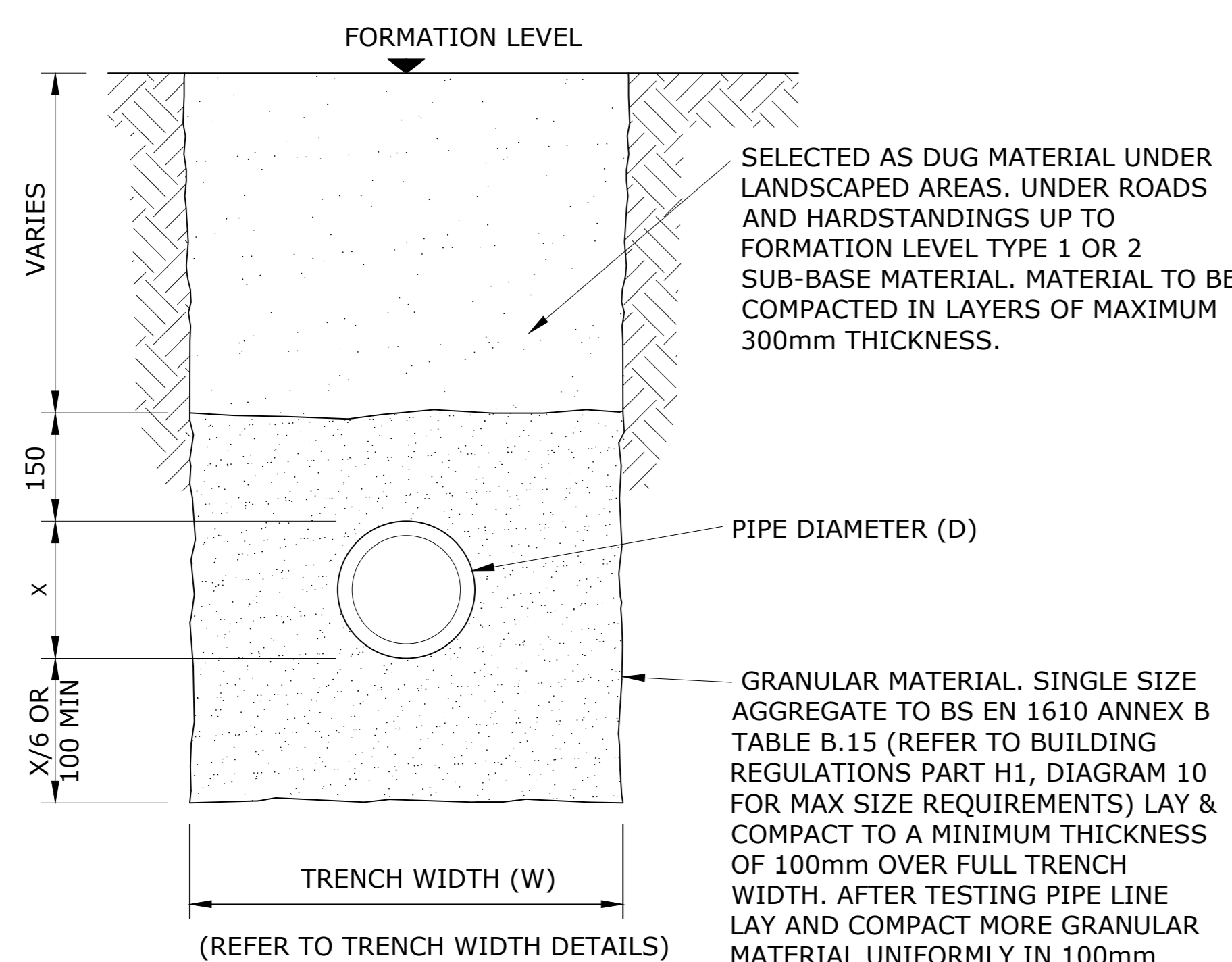

**CLASS S BEDDING**

TO ALL PIPES WITH COVER FROM FINISHED SURFACE TO CROWN GREATER THAN 900mm IN TRAFFICKED AREAS OR GREATER THAN 600mm COVER IN LANDSCAPED AREAS.

D	150	225	300	375	450	525	600
W	600	750	750	1050	1150	1200	1350

TRENCH WIDTH DETAILS

PIPES BENEATH BUILDING TO BE LAID WITH CLASS Z BEDDING

**TYPICAL PIPE BEDDING DETAILS**

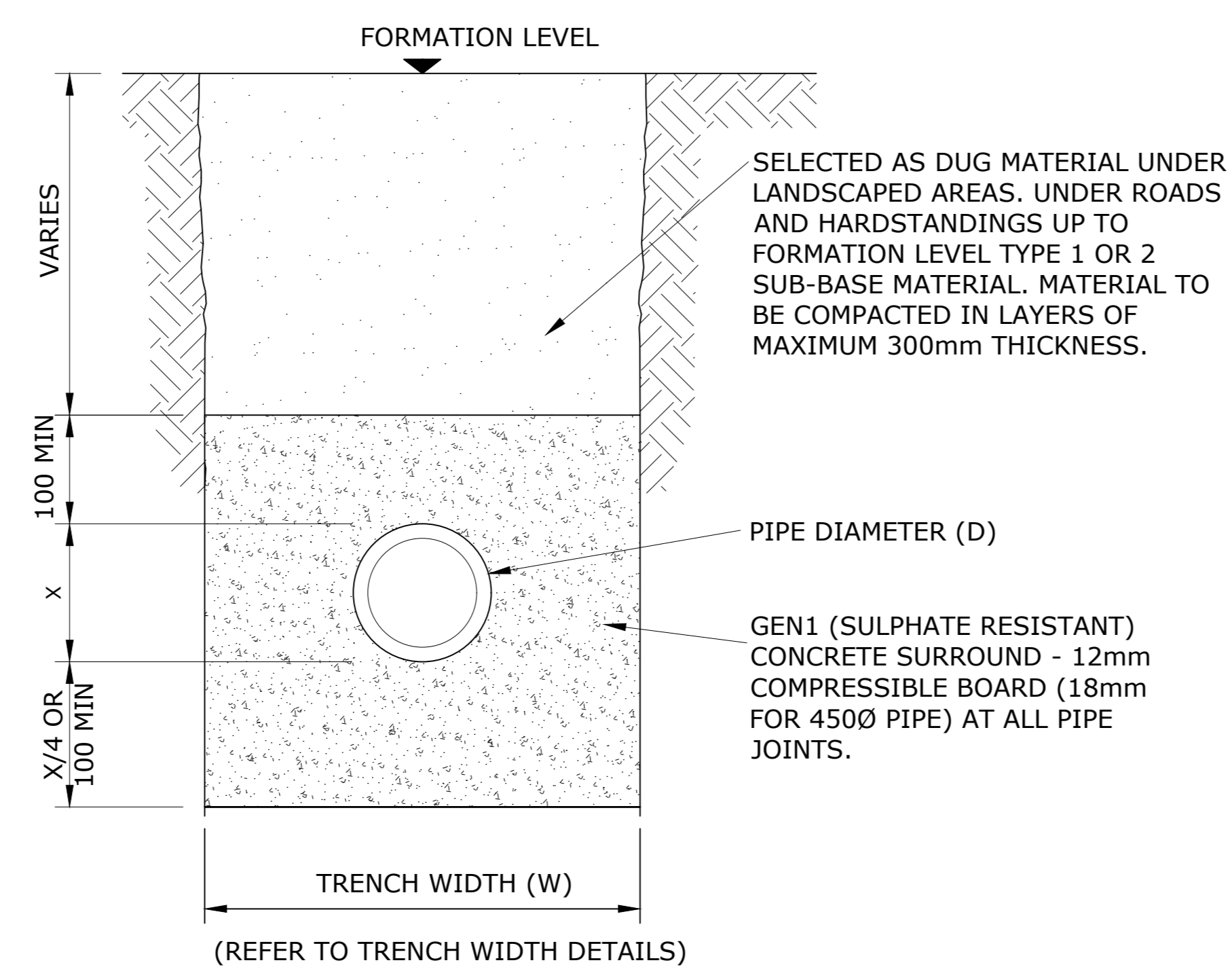

**CLASS Z BEDDING**

TO ALL PIPES WITH COVER FROM FINISHED SURFACE TO CROWN LESS THAN OR EQUAL TO 900mm IN TRAFFICKED AREAS OR LESS THAN 600mm COVER IN LANDSCAPED AREAS.

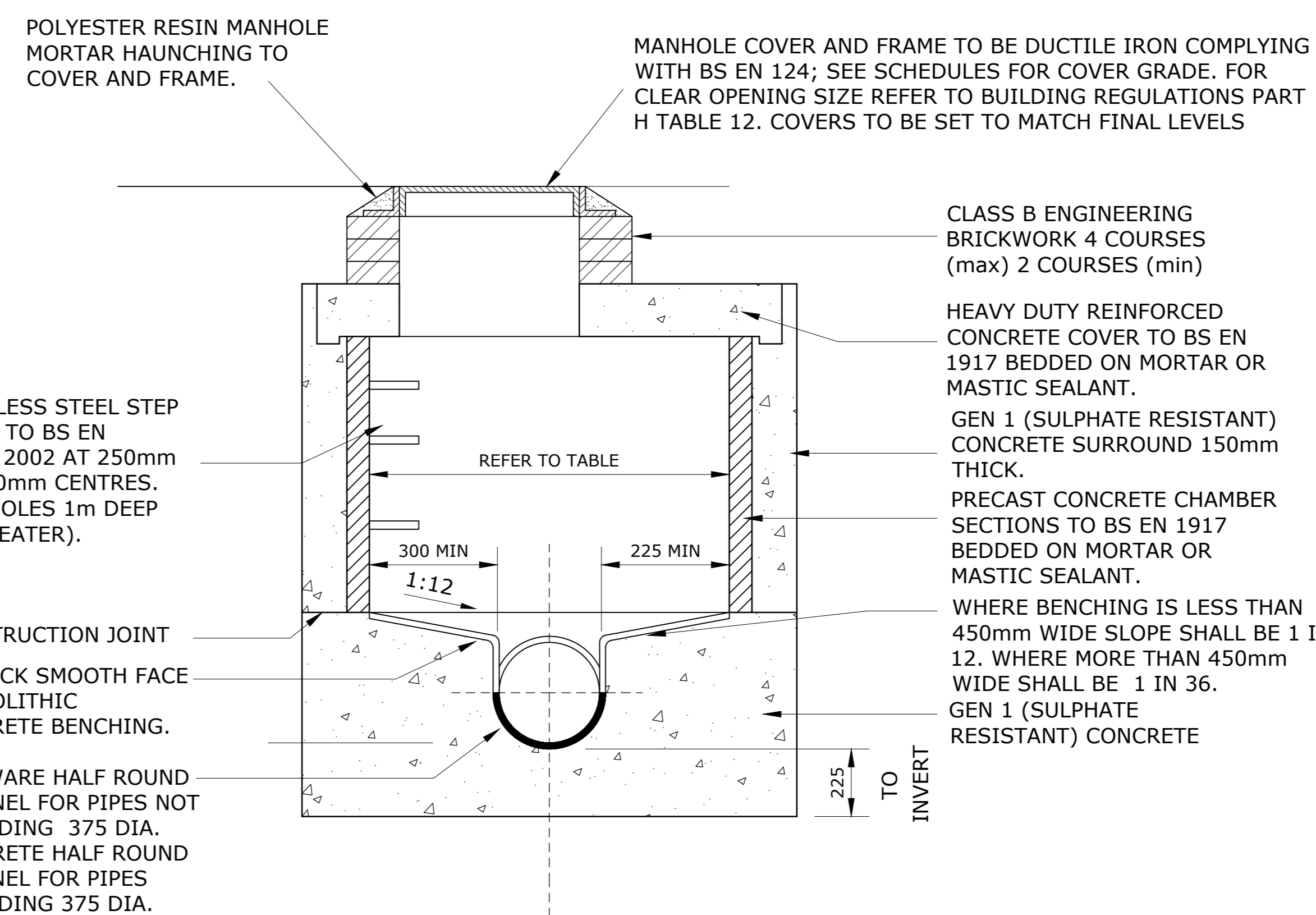

**PRIVATE PRECAST CONCRETE MANHOLE**

PIPES ENTERING & LEAVING MANHOLES SHALL HAVE A FLEXIBLE JOINT WITHIN 150mm OF THE INSIDE FACE OF THE MANHOLE JOINING WITH A SHORT 'ROCKER PIPE'.

PIPE DIA.	ROCKER PIPE LENGTH
LESS THAN 300	600mm
300 - 450	750mm
450 - 1000	1000mm

COVER GRADES AND AREAS OF USE	
COVER GRADE TO BS EN 124	LOCATION
D400	FOR USE IN ACCESS ROADS AND PARKING AREAS ACCESSIBLE TO ALL TYPES OF ROAD VEHICLES INCLUDING HGV'S.
B125	FOR USE IN FOOTWAYS, PEDESTRIAN AREAS, DRIVEWAYS AND CAR PARKS ACCESSIBLE BY LIGHT VEHICLES ONLY.

TABLES PROVIDE GUIDANCE TO MANHOLE SIZES/COVER GRADES.

DIA. PIPE	DIA. CHAMBER
150-300	1200
>300	1500

REFER TO LAYOUT FOR FURTHER DETAILS

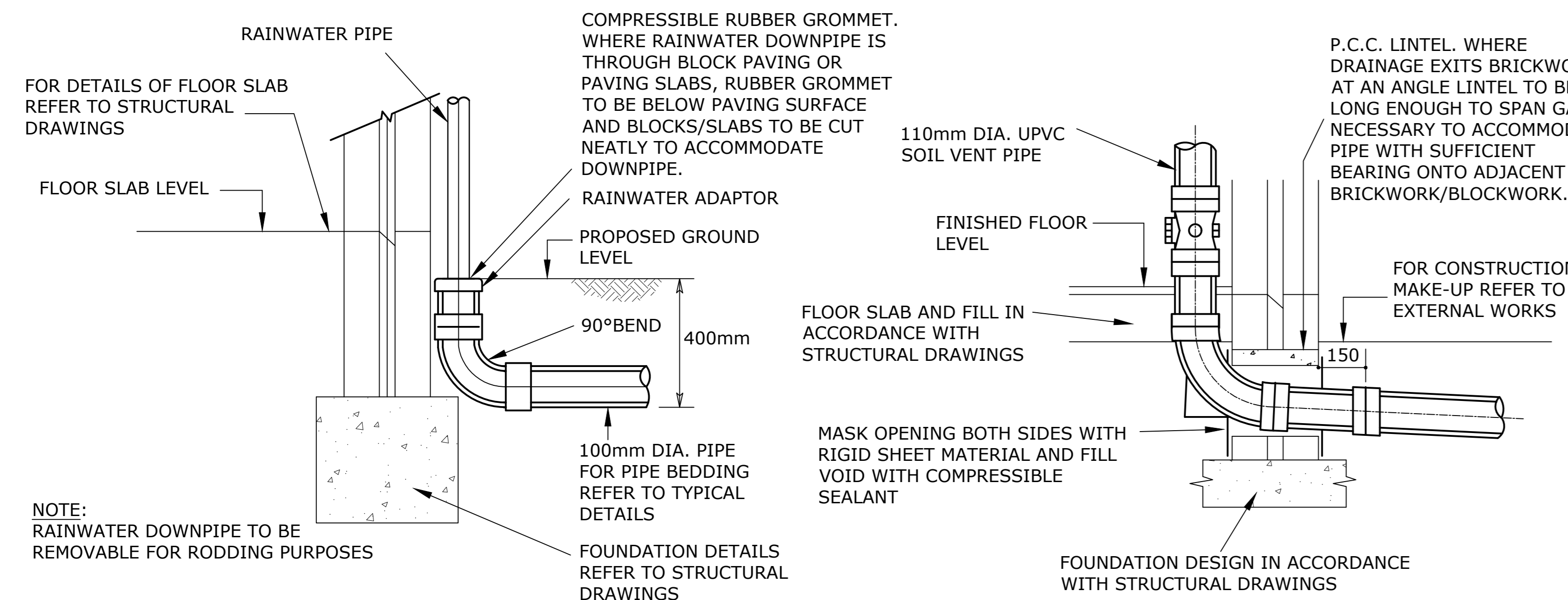

**RAINWATER PIPE CONNECTION**

**SOIL VENT PIPE CONNECTION**

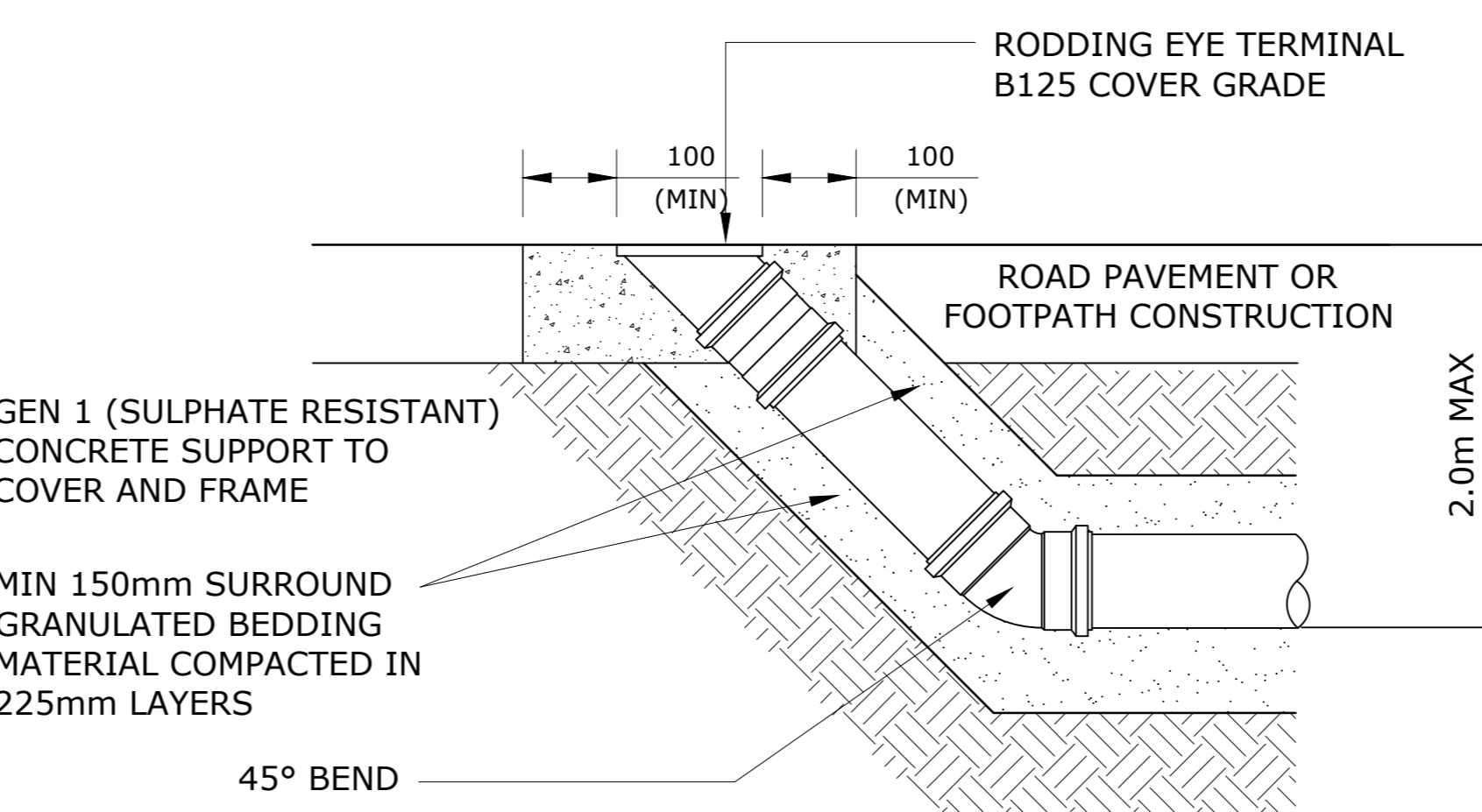

**LIGHT DUTY RODDING EYE DETAIL**  
(PEDESTRIAN/LIGHTLY TRAFFICKED AREAS)

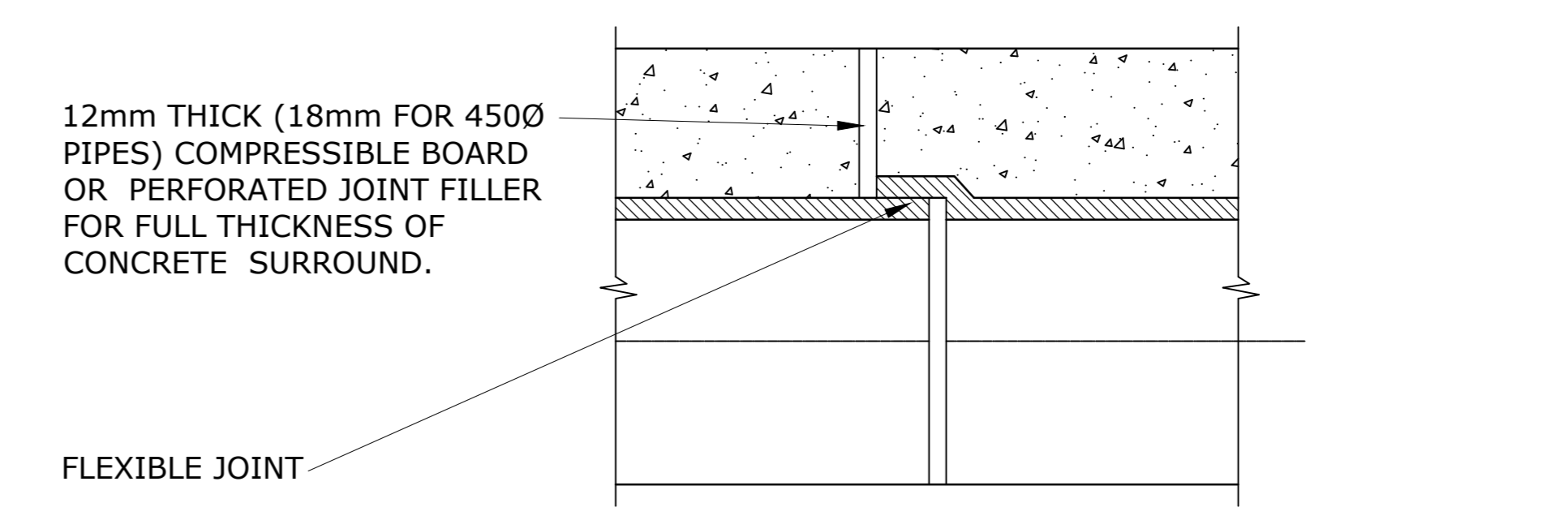

**DETAIL OF MOVEMENT JOINT FOR PIPES WITH CONCRETE BED AND SURROUND**  
(TO BE PROVIDED AT ALL PIPE JOINTS)

**NOTES**

- DO NOT SCALE FROM THIS DRAWING MANUALLY OR ELECTRONICALLY.
- THIS DRAWING IS TO BE READ IN CONJUNCTION WITH ALL OTHER RELEVANT PROJECT INFORMATION.
- ALL DATUM LEVELS ARE IN METRES AND DIMENSIONS ARE IN MILLIMETRES UNLESS OTHERWISE STATED.

**CONSTRUCTION (DESIGN AND MANAGEMENT) REGULATIONS 2015**

**DESIGNERS HAZARD INFORMATION FOR CONSTRUCTION**

- IF YOU DO NOT FULLY UNDERSTAND THE RISKS INVOLVED DURING THE CONSTRUCTION OF THE ITEMS INDICATED ON THIS DRAWING ASK YOUR MANAGER, HEALTH & SAFETY ADVISOR OR A MEMBER OF THE DESIGN TEAM BEFORE PROCEEDING.

THE ABOVE NOTES REFER SPECIFICALLY TO THE INFORMATION SHOWN ON THIS DRAWING.

REFER TO THE HEALTH AND SAFETY PLAN FOR FURTHER INFORMATION.

Rev	Date	Amendment Details	Dr'n	Chk	App
C01	04.08.2022	ISSUED FOR CONSTRUCTION	JD	HB	CH
P01	31.03.2022	TENDER ISSUE	JD	HB	CH

This drawing should not be relied on or used in circumstances other than those for which it was originally prepared and for which Sweco UK Limited was commissioned. Sweco UK Limited accepts no responsibility for this drawing to any party other than the person by whom it was commissioned. Any party which breaches the provisions of this disclaimer shall identify Sweco UK Limited for all loss or damage arising therefrom. COPYRIGHT © Sweco 2021

Sweco  
North Kiln, Felaw Maltings  
46 Felaw Street  
Ipswich  
IP2 8PN  
Tel: +44 (0)1473 231 100  
Web: www.sweco.co.uk



Client

**MEMORIA**

Project Title

**FAVERSHAM CREMATORIUM**

Drawing Title

**DRAINAGE CONSTRUCTION DETAILS SHEET 1**

Purpose Of Issue  
**CONSTRUCTION**

Status: **S4** Status Description: **FOR REVIEW AND AUTHORIZATION**

Designed	Drawn	Checked	Approved
HB	HB	CH	CH

Sheet Size	Scale	SWECO Ref	Revision
A1	1:20	65204882	C01

Drawing Number  
**65204882-SWE-ZZ-XX-DR-C-0200**