

00000.000mE 00000.000mE 00000.000mE 00000.000mE 00000.000mE 00000.000mE 00000.000mE 236780.000mN 236780.000mN 236740.000mN 236720.000mN 236700.000mN

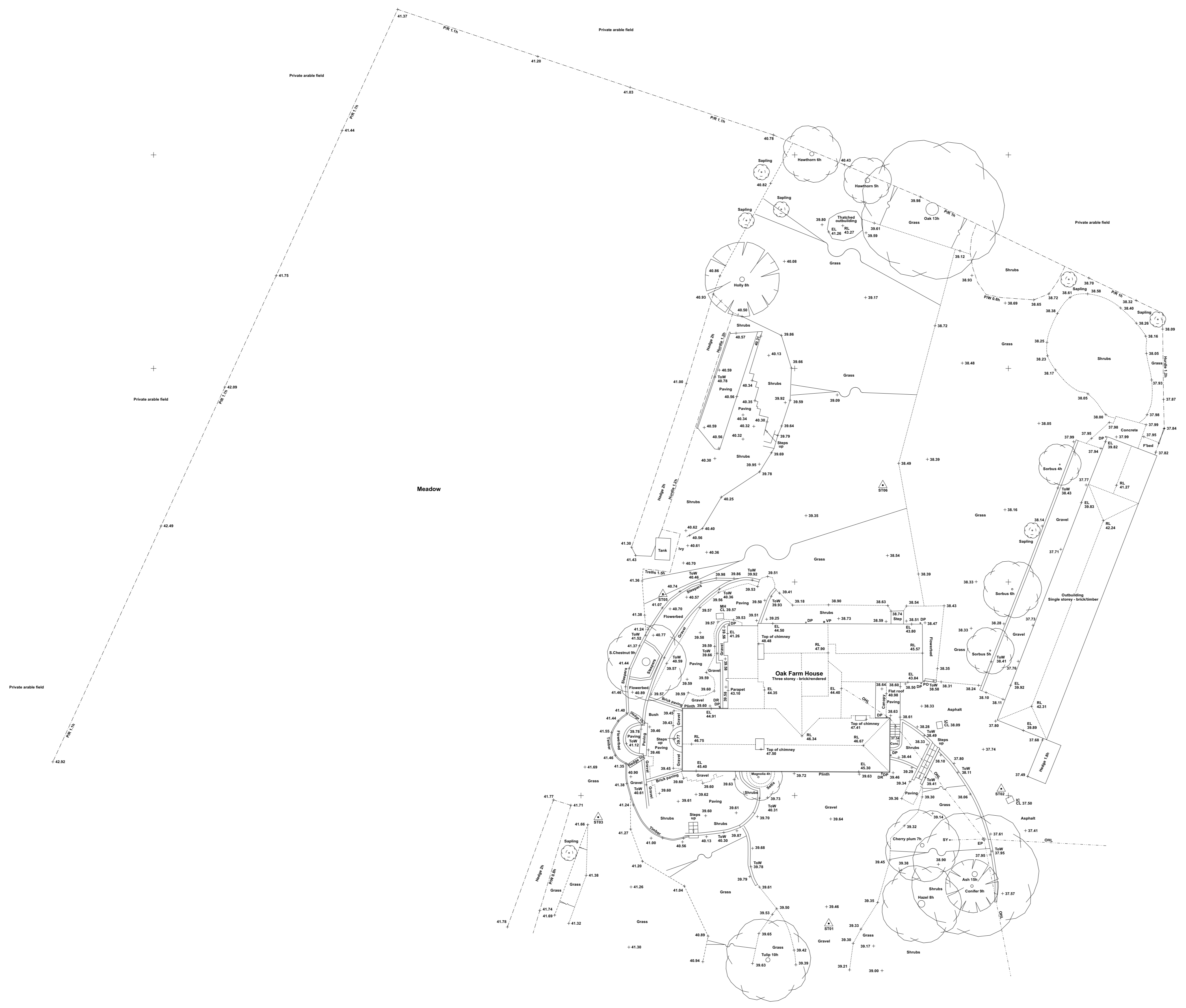
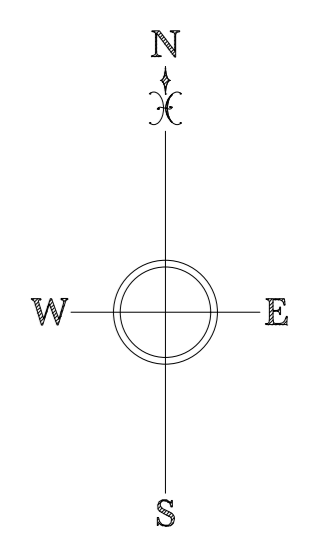

**ROGER BALMER
DESIGN**

FOUNTAIN HOUSE STUDIO THE STREET EAST BERGHOLT COLCHESTER CO7 6TB
Telephone: 01206 299477 Email: enquiries@rogerbalmerdesign.co.uk

| | | |
|-----------------------|----------------------------------|----------------------------------|
| Client | Project | Drawing |
| Mr and Mrs Torrington | Oak Farm House Holton St Mary | Site / Block Plan as Existing |

| | | | | |
|-------------|---------------|------|-------------|------|
| Scale | Date | Del. | Drawing no. | Rev. |
| 1:200 at A1 | November 2023 | BOC | 3523 - 02 | |

Contractors must verify all dimensions and information on site prior to commencement of work. Do not scale from drawing.
© Roger A Balmer Ltd