

Important Information:

Any Drainage that has been investigated should be checked against statutory records to confirm details before proceeding with any design work.

We advise that an arborologist be appointed to correctly determine the species and condition of all trees surveyed prior to any design work.

All information contained in this drawing (including digital data) should be checked and verified prior to any fabrication or construction.

Survey Legend

FENCES		ABBREVIATIONS	
BARRIED WIRE FENCE	BW	BW	MARKER
CORRUGATED IRON FENCE	CI	BT	NOTICE BOARD
CLOSE BOARD FENCE	CB	CPS	PARKING METER
CHESTNUT PALING FENCE	CP	CL	ROAD NAME PLATE
IRON PALING FENCE	IP	DK	ROAD SIGN
POST AND CHAIN FENCE	PC	EC	RODDING EYE
POST AND RAIL FENCE	PR	EP	RETAINING WALL
POST AND WIRE FENCE	PW	EP	RAINWATER PIPE
CHAIN LINK FENCE	CL	FB	STOP VALVE
LARCH LAP FENCE	LL	FP	TELEGRAPH POLE
WIRE MESH FENCE	WM	GV	TELEPHONE CALL BOX
INTERWOVEN FENCE	IW	GY	TRAFFIC LIGHT
WIRE MESH FENCE	WM	IC	UNABLE TO LIFT
		IL	UNDRUNN
		KD	VENT PIPE
		MH	WATER METER
		TH	DIAMETER

Key Plan

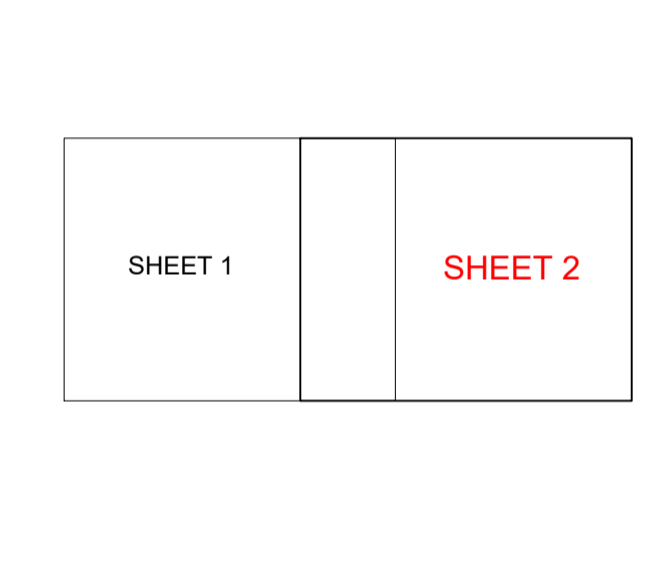

Station Identification

Station	Easting	Northing	Level
MB1	483500E	133200N	95.81
MB2	483500E	133200N	95.81
MB3	483500E	133200N	95.81
T1	483500E	133200N	95.81
T2	483500E	133200N	95.81
T3	483500E	133200N	95.81
T4	483500E	133200N	95.81
T5	483500E	133200N	95.81
T6	483500E	133200N	95.81
T7	483500E	133200N	95.81
T8	483500E	133200N	95.81
T9	483500E	133200N	95.81

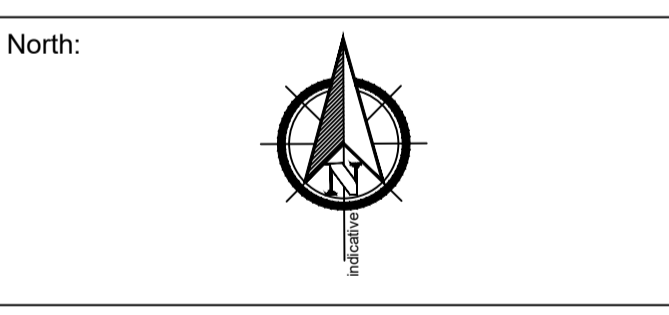

Grid: OS GPS
 Levelling: OS GPS

Drawing Title: Topographical Survey

Site Address: Ladybrook, Burgh Hill, Bramshott, Liphook, GU30 7RQ

Client: Mr & Mrs Edward Cartwright

Surveyor: MB	Drawn By: PV	Verified By: AF	Date: 29-04-23
CM No: CM23131	Rev:		
Scale: 1:200m @ A1	Date: APRIL 2023		

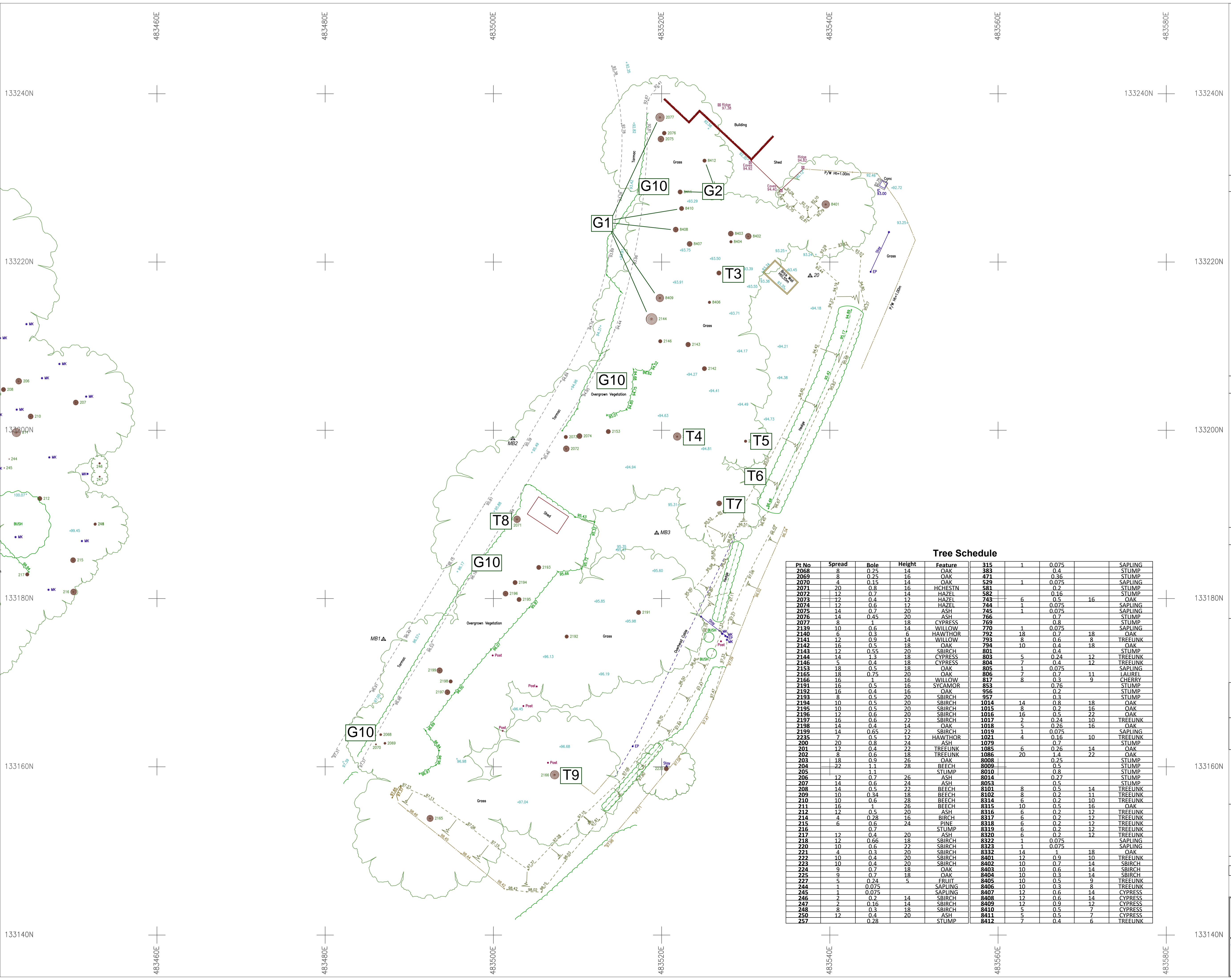

Tree Schedule

Pt No	Spread	Bole	Height	Feature	315	1	0.075	
2068	8	0.25	14	OAK	383		0.4	STUMP
2069	8	0.25	16	OAK	471		0.36	STUMP
2070	4	0.15	14	OAK	529	1	0.075	SAPLING
2071	20	0.8	16	HICHESTN	581		0.2	STUMP
2072	12	0.7	14	HAZEL	582		0.16	STUMP
2073	12	0.4	12	HAZEL	743	6	0.5	16 OAK
2074	12	0.6	12	HAZEL	744	1	0.075	SAPLING
2075	14	0.7	20	ASH	745	1	0.075	STUMP
2076	14	0.45	20	ASH	766		0.7	STUMP
2077	8	1	18	CYPRESS	769		0.8	STUMP
2139	10	0.6	14	WILLOW	770	1	0.075	SAPLING
2140	6	0.3	6	HAWTHOR	792	18	0.7	18 OAK
2141	12	0.9	14	WILLOW	793	8	0.6	8 TREEUNK
2142	16	0.5	18	OAK	794	10	0.4	18 OAK
2143	12	0.55	20	SBIRCH	801		0.4	STUMP
2144	14	1.3	18	CYPRESS	803	5	0.24	12 TREEUNK
2146	5	0.4	18	CYPRESS	804	7	0.4	12 TREEUNK
2153	18	0.5	18	OAK	805	1	0.075	SAPLING
2165	18	0.75	20	OAK	806	7	0.7	11 LAUREL
2166	16	1	16	WILLOW	817	8	0.3	9 CHERRY
2191	16	0.5	16	SYCAMOR	853		0.76	STUMP
2192	16	0.4	16	OAK	956		0.2	STUMP
2193	8	0.5	20	SBIRCH	957		0.3	STUMP
2194	10	0.5	20	SBIRCH	1014	14	0.8	18 OAK
2195	10	0.5	20	SBIRCH	1015	8	0.2	16 OAK
2196	12	0.6	20	SBIRCH	1016	16	0.5	22 OAK
2197	16	0.6	22	SBIRCH	1017	2	0.24	10 TREEUNK
2198	14	0.4	14	OAK	1018	5	0.26	16 OAK
2199	14	0.65	22	SBIRCH	1019	1	0.075	SAPLING
2235	7	0.5	12	HAWTHOR	1021	4	0.16	10 TREEUNK
200	20	0.8	24	ASH	1079		0.7	STUMP
201	12	0.4	22	TREEUNK	1085	6	0.26	14 OAK
202	8	0.6	18	TREEUNK	1086	20	1.4	22 OAK
203	18	0.9	26	OAK	8008		0.25	STUMP
204	22	1.1	28	BEECH	8009		0.5	STUMP
205	12	0.7	26	ASH	8010		0.8	STUMP
206	12	0.7	26	ASH	8011		0.77	STUMP
207	14	0.6	24	ASH	8053		0.5	STUMP
208	14	0.5	22	BEECH	8101	8	0.5	14 TREEUNK
209	10	0.34	18	BEECH	8102	8	0.2	11 TREEUNK
210	10	0.6	20	BEECH	8314	6	0.2	10 TREEUNK
211	16	0.6	26	BEECH	8315	10	0.5	16 OAK
212	12	0.5	20	ASH	8316	6	0.2	12 TREEUNK
214	4	0.28	16	BIRCH	8317	6	0.2	12 TREEUNK
215	6	0.6	24	PIALR	8318	6	0.2	12 TREEUNK
216	6	0.7	24	STUMP	8319	6	0.2	12 TREEUNK
217	12	0.4	20	ASH	8320	6	0.2	12 TREEUNK
218	12	0.66	18	SBIRCH	8322	1	0.075	SAPLING
220	10	0.6	22	SBIRCH	8323	1	0.075	SAPLING
221	4	0.3	20	SBIRCH	8332	14	1	18 OAK
222	10	0.4	20	SBIRCH	8401	12	0.9	10 TREEUNK
223	10	0.4	20	SBIRCH	8402	10	0.7	14 SBIRCH
224	9	0.7	18	OAK	8403	10	0.6	14 SBIRCH
225	9	0.7	18	OAK	8404	10	0.3	14 SBIRCH
227	5	0.24	5	FRUIT	8405	10	0.5	9 TREEUNK
244	1	0.075		SAPLING	8406	10	0.3	8 TREEUNK
245	1	0.075		SAPLING	8407	12	0.6	14 CYPRESS
246	2	0.2	14	SBIRCH	8408	12	0.6	14 CYPRESS
247	2	0.16	14	SBIRCH	8409	12	0.9	12 CYPRESS
248	8	0.3	18	SBIRCH	8410	5	0.5	7 CYPRESS
250	12	0.4	20	ASH	8411	5	0.5	7 CYPRESS
257		0.28		STUMP	8412	7	0.4	6 TREEUNK