

REFERENCES

- Plot 1 - Existing residential annexe to Chequers
- Plot 2 - Residential unit approved under application UTT/17/2637/FUL
- - - Plot 3 - New Plot
- Chequers
- /// Shared Access

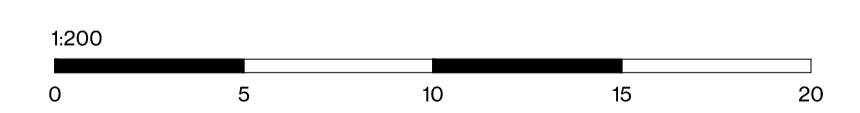
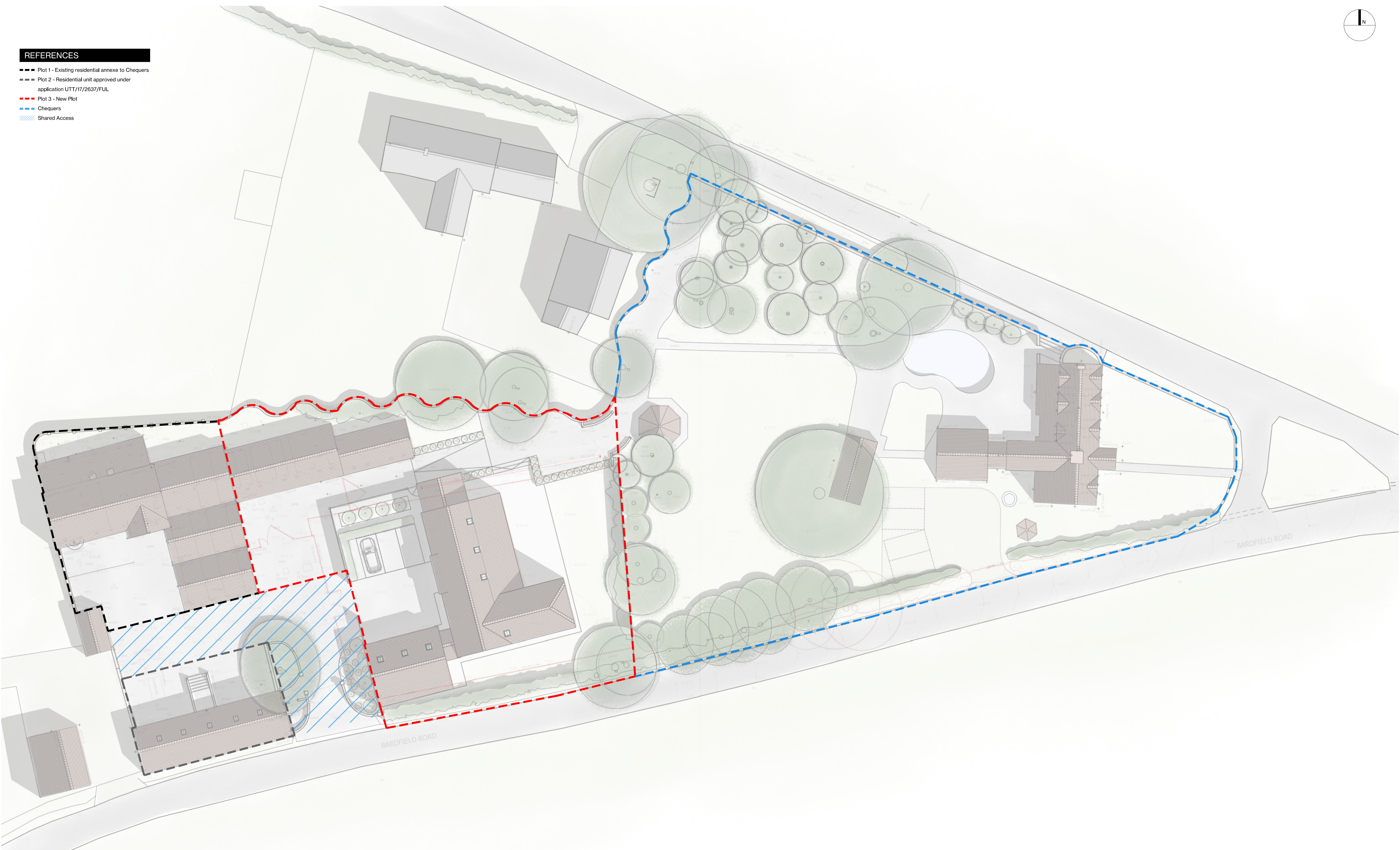

KEY

REVISION / DATE / DESCRIPTION
A - 23/10/2023 - Parking to Chequers revised following arboriculture comments.
B - 16/11/2023 - Parking to Chequers revised following updated topographical survey

ADDRESS	Chequers, Little Bardfield, CM7 4TW
CLIENT	Mr & Mrs Noble
TITLE	Proposed Plot Distributions
PROJECT DESCRIPTION	Proposed New Build Dwelling

DATE	Nov 2023
SCALE @ A1	1:200
PROJECT NO	12301
DRAWING NO / REV	