

**EXIT**  
DELIVERY: REVERSE TO TURN AND EXIT IN FORWARD GEAR

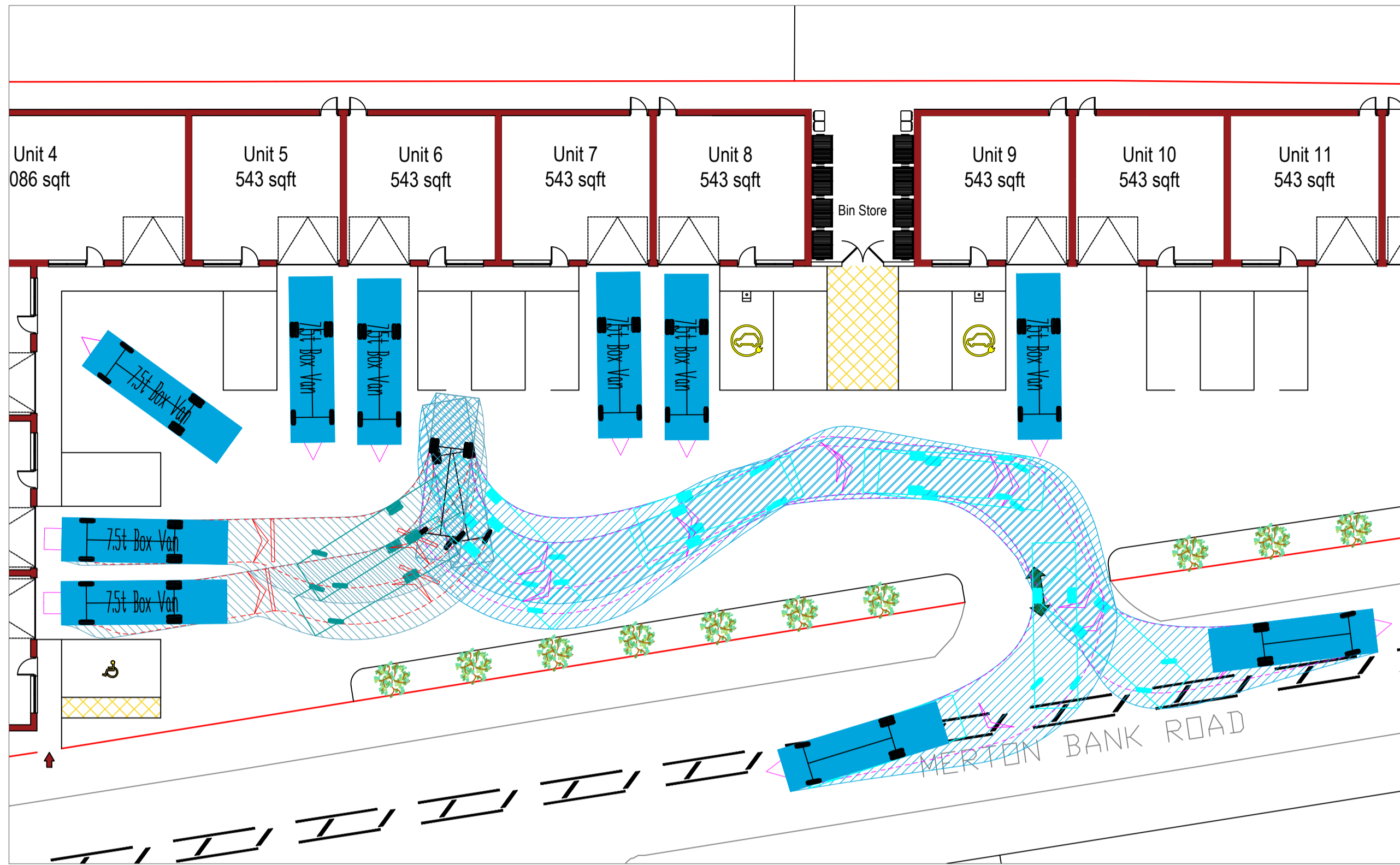

**EXIT**  
DELIVERY: REVERSE TO TURN AND EXIT IN FORWARD GEAR

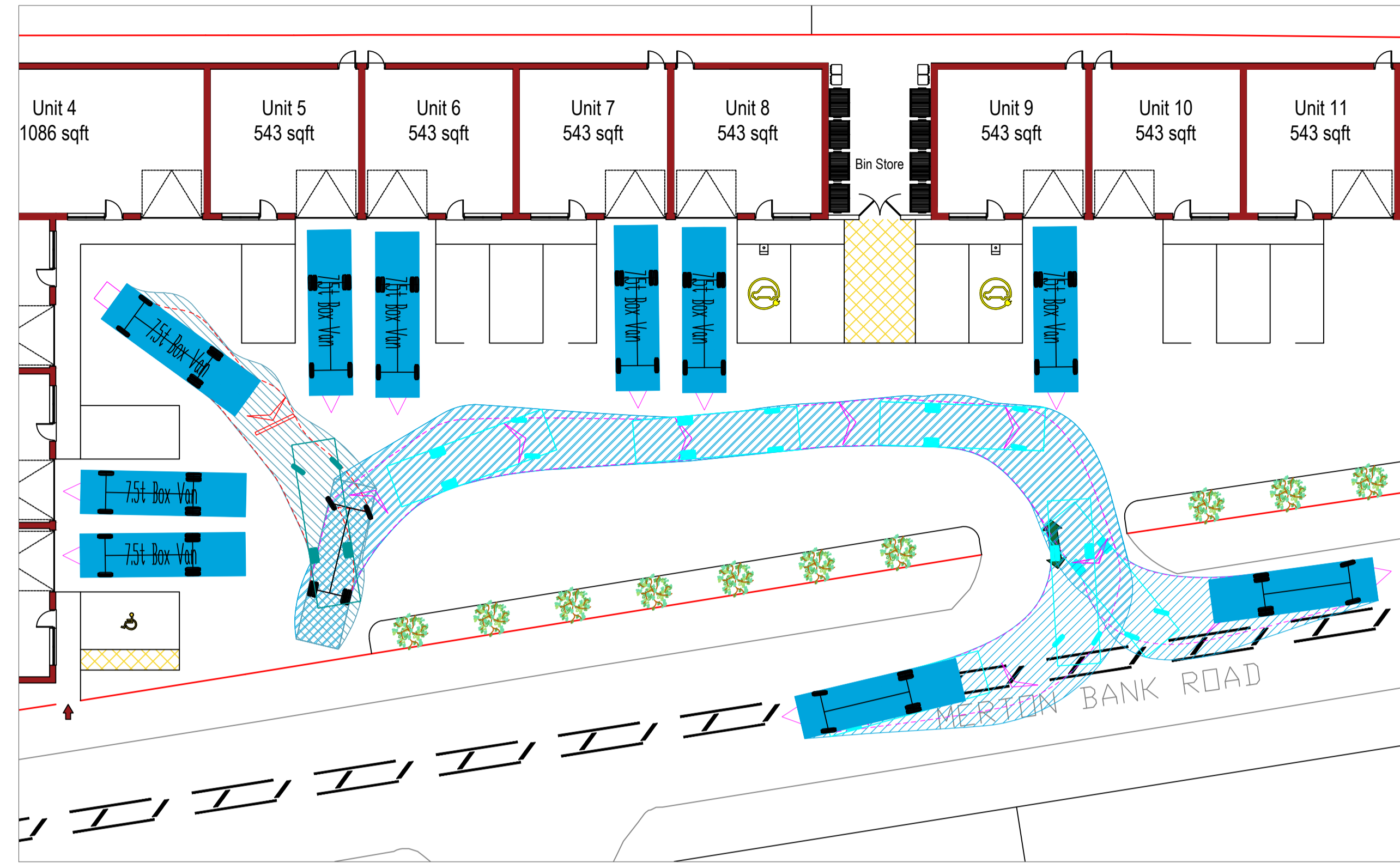

**EXIT**  
DELIVERY: EXIT IN FORWARD GEAR

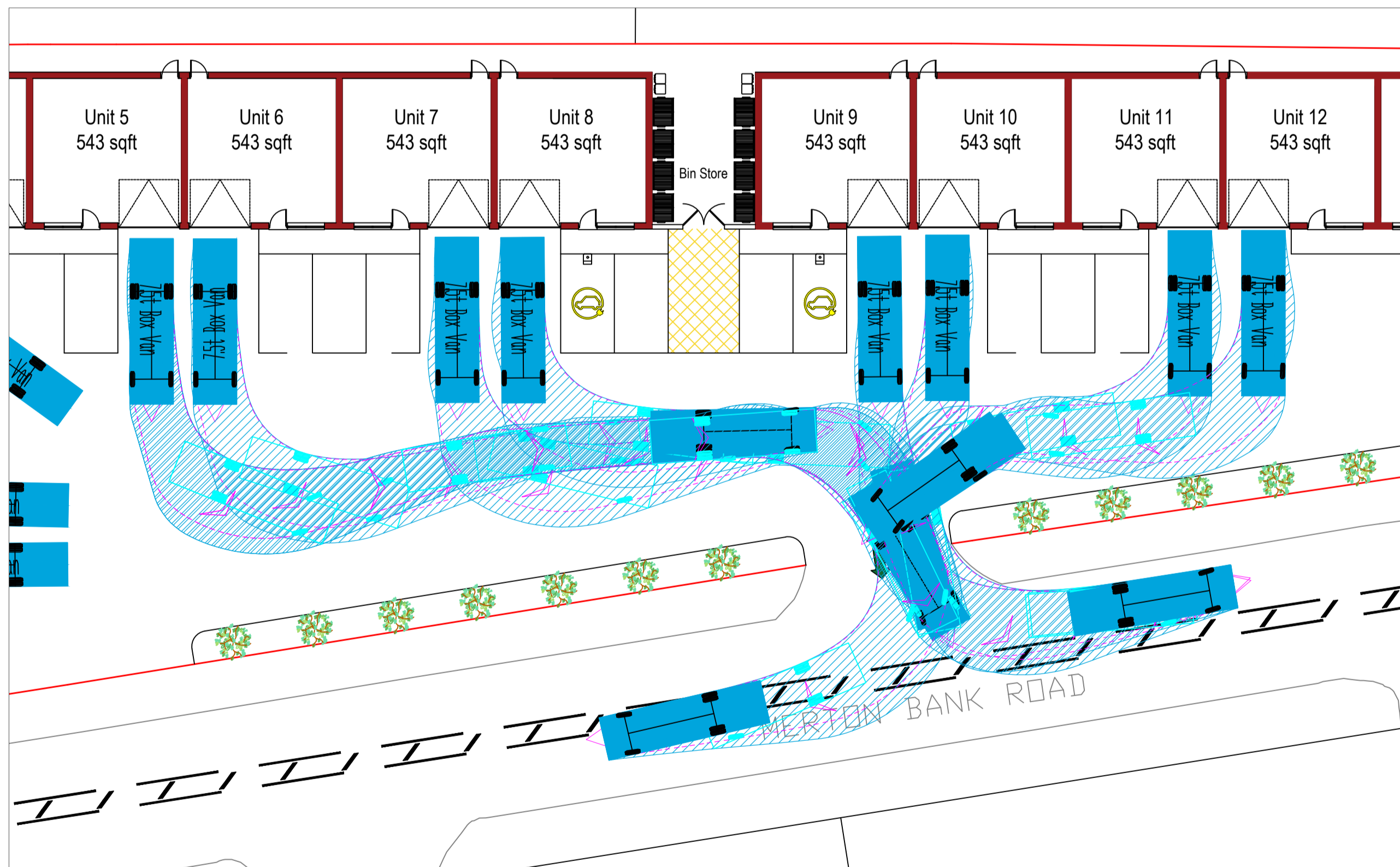

**EXIT**  
DELIVERY: 3-POINT TURN TO EXIT IN FORWARD GEAR

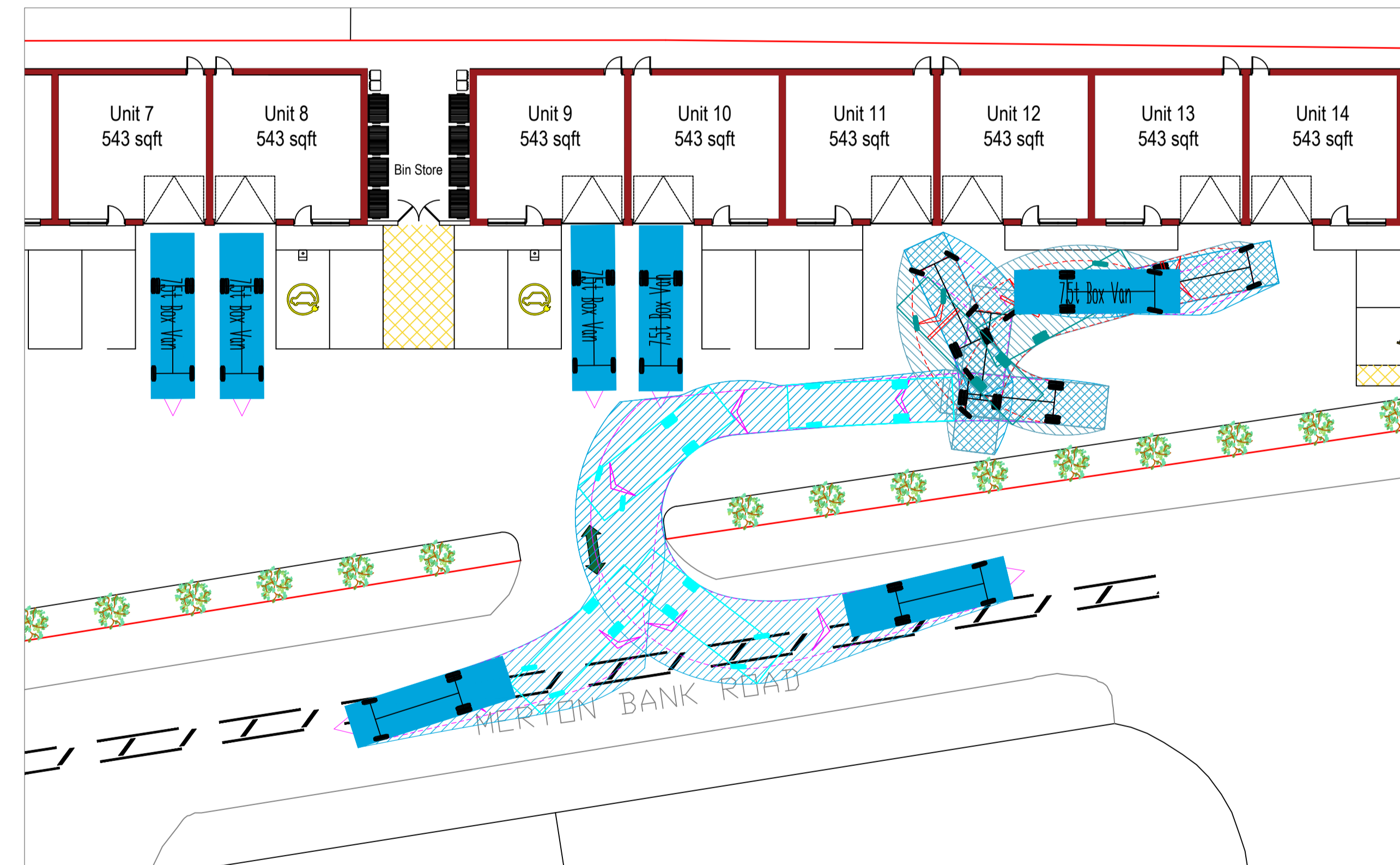

7.5t Box Van	8.010m
Overall Length	2.100m
Overall Width	3.556m
Overall Body Height	0.351m
Min Body Ground Clearance	2.064m
Track Width	4.00s
Lock to lock time	7.400m
Kerb to Kerb Turning Radius	

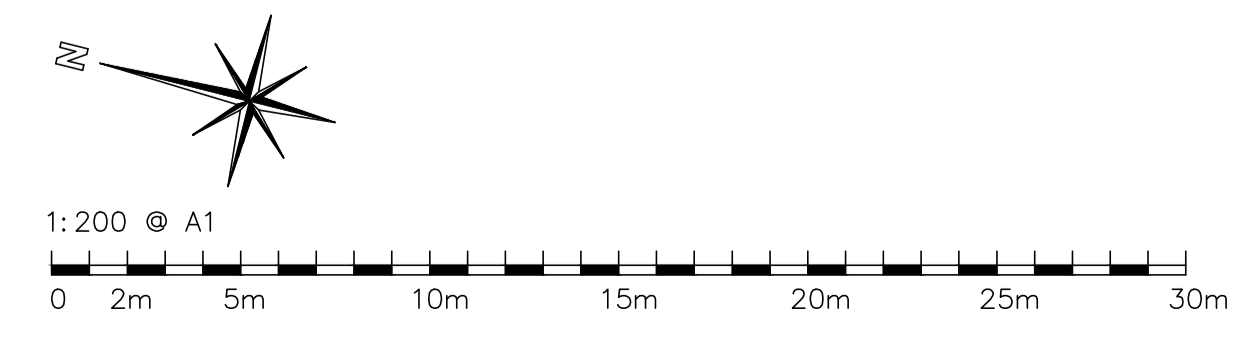
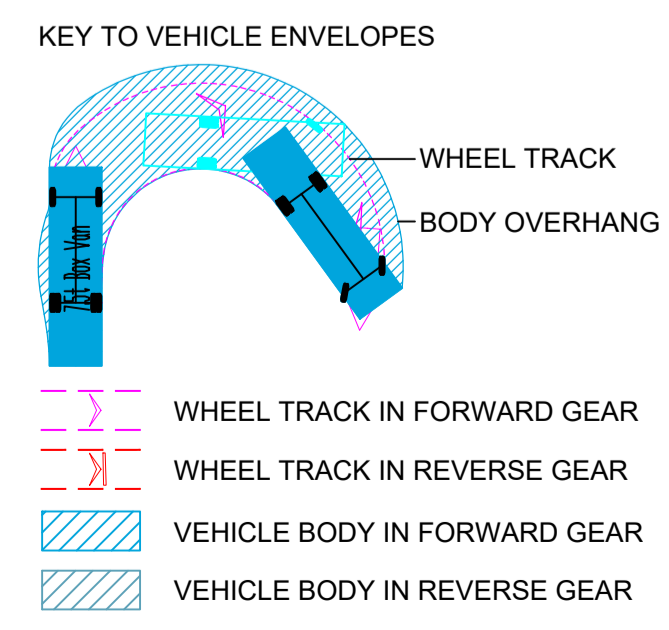

CLIENT:	LYNWOOD BUILDING CONSULTANCY		
PROJECT:	SUREGROW, COLLINS INDUSTRIAL ESTATE, ST HELENS WA9 1HY		
TITLE:	SWEPT PATH ANALYSIS		
DESCRIPTION:	7.5T 8M BOX VAN		
STATUS:	PLANNING		
DATE:	18.10.23	DRAWN BY:	JG
JOB NO:	JG.101.23	SCALE:	1:200 @ A1
REV:		DRAWING NO:	JG03

- NOTES**
- This drawing and any ancillary drawings or data are copyright of JG Highway Design Ltd, and may not be used, copied, or amended for any purpose whatsoever without written approval.
  - This drawing is only to be used for the purposes described in the status box above.
  - Work to figured dimensions only. All dimensions and levels to be checked on site by the contractor before commencement of any work. If in doubt, ask.
  - This drawing is to be read in conjunction with all other drawings, details and specifications pertaining to the work described. It should only be used for the purpose marked in the status box above and shall not be used for construction unless clearly marked CONSTRUCTION.
  - Materials and workmanship shall comply to the appropriate British Standards and Codes of Practice unless otherwise stated.
  - The activities required to construct the work, shown on drawings clearly marked CONSTRUCTION, may be subject to the provisions of the Construction (Design & Management) Regulations 2015. The Contractor and Client must ensure that they are adequately conversant with these regulations and that the appropriate procedures required under the regulations are always observed.
  - Swept path analysis: When generic vehicles are used for swept path analysis, they may differ from specific makes and models of that type. Driver ability can vary hugely. What one driver is capable of, another may not be so any analysis shown to be tight on space will come down driver ability and the difference between make and models of vehicles.
  - UTILITIES NOTE: The position of any existing public or private sewers, utility services, plant or apparatus shown on this drawing is believed to be correct, but no warranty to this is expressed or implied. Other such plant or apparatus may also be present but not shown. The Contractor is therefore advised to undertake his own investigation where the presence of any existing sewers, services, plant, or apparatus may affect his operations.
  - Printed drawings not valid in black and white.

**REVISIONS**