

Notes:
 This drawing is based upon Randall Survey LLP Drawing No:17134/MC/2A
 1. Levels are related to the O.S. National GPS network.

Do not scale off this drawing. All dimensions to be checked onsite

REVISIONS



KEY:
 [Double line symbol] New studwork wall.
 [Single line symbol] Existing timber floors to be lifted, insulated and refitted.

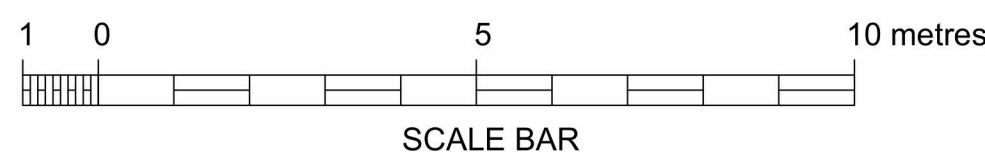
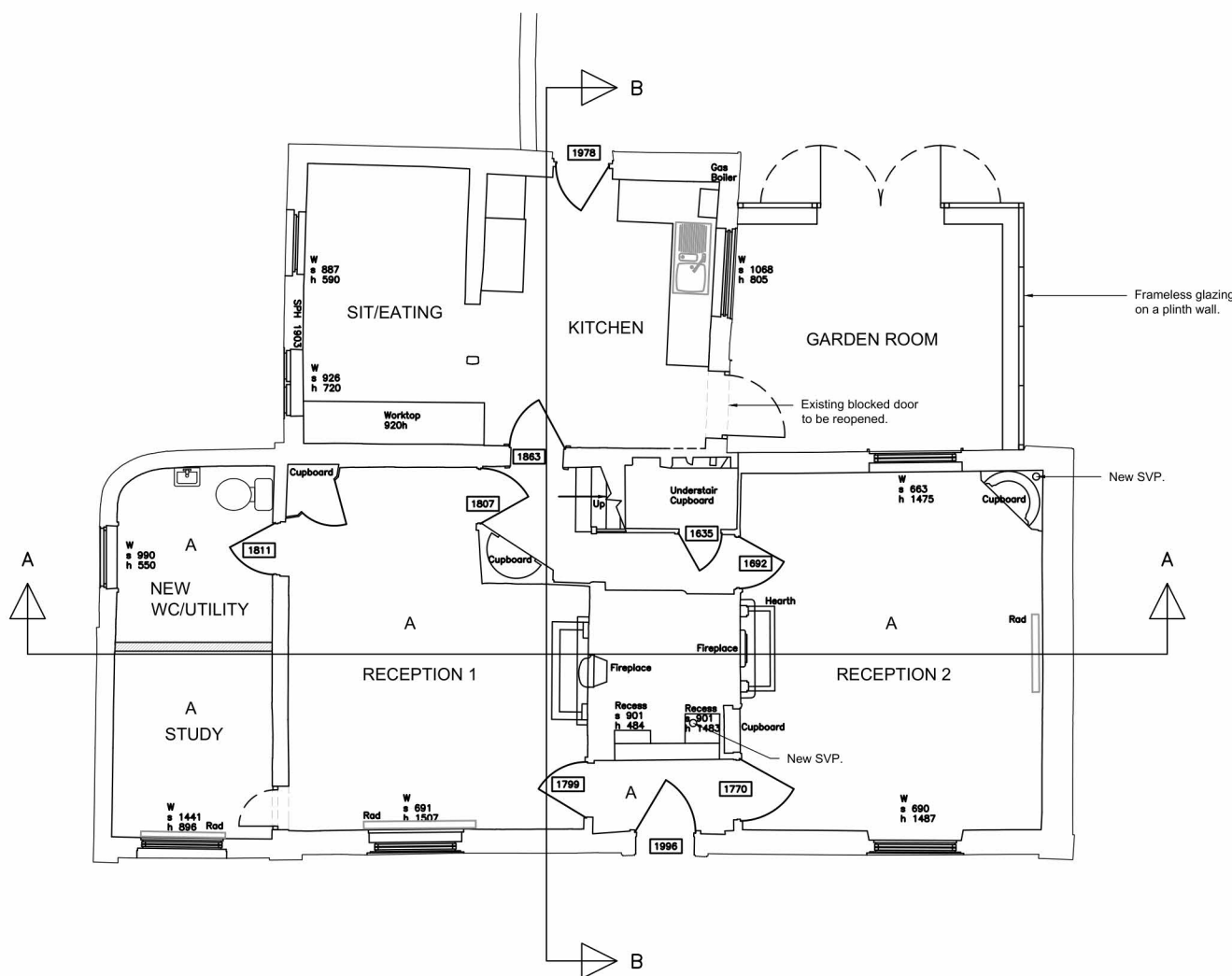

| | |
|---------------|---|
| CLIENT | Mr & Mrs E. Haig-Thomas |
| PROJECT | Hawthorns, High Street, Thorpe Le Soken |
| DRAWING TITLE | Proposed Ground Floor Plan |
| SIZE & SCALE | A3 1:100 |
| DATE | November 2023 |

| | |
|-------------|------------|
| JOB NUMBER | 2022/92 |
| DRAWING NO. | 2022/92/09 |
| REVISION | |

CBA cbarchitecture
 The Studio
 47 Colchester Road
 West Bergholt
 CO6 3JQ
 m. [Redacted]
 e. [Redacted]