

Key:

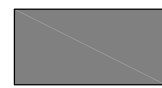

Hatch denotes footprint of Stileways, to be retained.

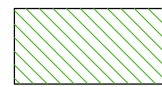

Hatch denotes footprint of proposed new dwelling.



Hatch denotes existing buildings and structures to be demolished.



BLOCK PLAN

1:500 SCALE

1:500 (m)

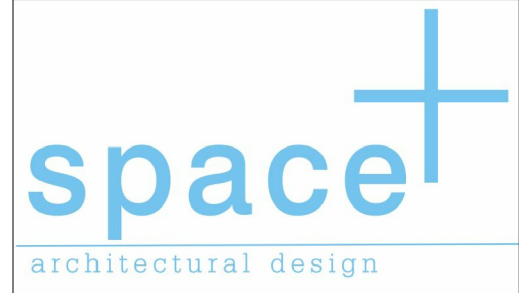

Nick & Ann Smythe
 Stileways
 Wraxhall
 Bristol
 BS48 1PH

BLOCK PLAN SHOWING EXISTING & PROPOSED BUILDINGS

Date : 05/04/2023

Scale at A3 : As indicated

Drawing: Smythe-Stileways-FP-07 -A

Rev:	Date:	Details:
A	09/11/23	Parking revised

Drawn by:

TR	AR
----	----

NOTES

1. This drawing is copyright of Space Plus Architectural Design. Reproduction is only to take place with written authority.
2. These plans are subject to Planning & Building Regulation Approval or any other statute in law before building work commences.
3. Any structural work where mentioned on this drawing is subject to a qualified structural and civil engineer calculations before building work commences.
4. All boundaries are assumed. To be confirmed on site before building work commences.
5. All drawings marked preliminary are not to be built or manufactured from.
6. Only Local Authority Planning Departments may scale dimensions from the drawings.
7. Use figured dimensions only & all dimensions to be checked on site.
8. If any discrepancies are found in the drawings these are to be brought to the attention of Space Plus Architectural Design for rectification.

Space Plus Architectural Design

07973 163 665

Tamsin@space-plus.co.uk

www.space-plus.co.uk

PRELIMINARY - SUBJECT TO PLANNING APPROVAL