

Scale 1:100

note: Unavailable lines as per survey external access measured from inside

S 0.89 H 1.89
 S 0.96 H 2.01
 S 0.94 H 2.00

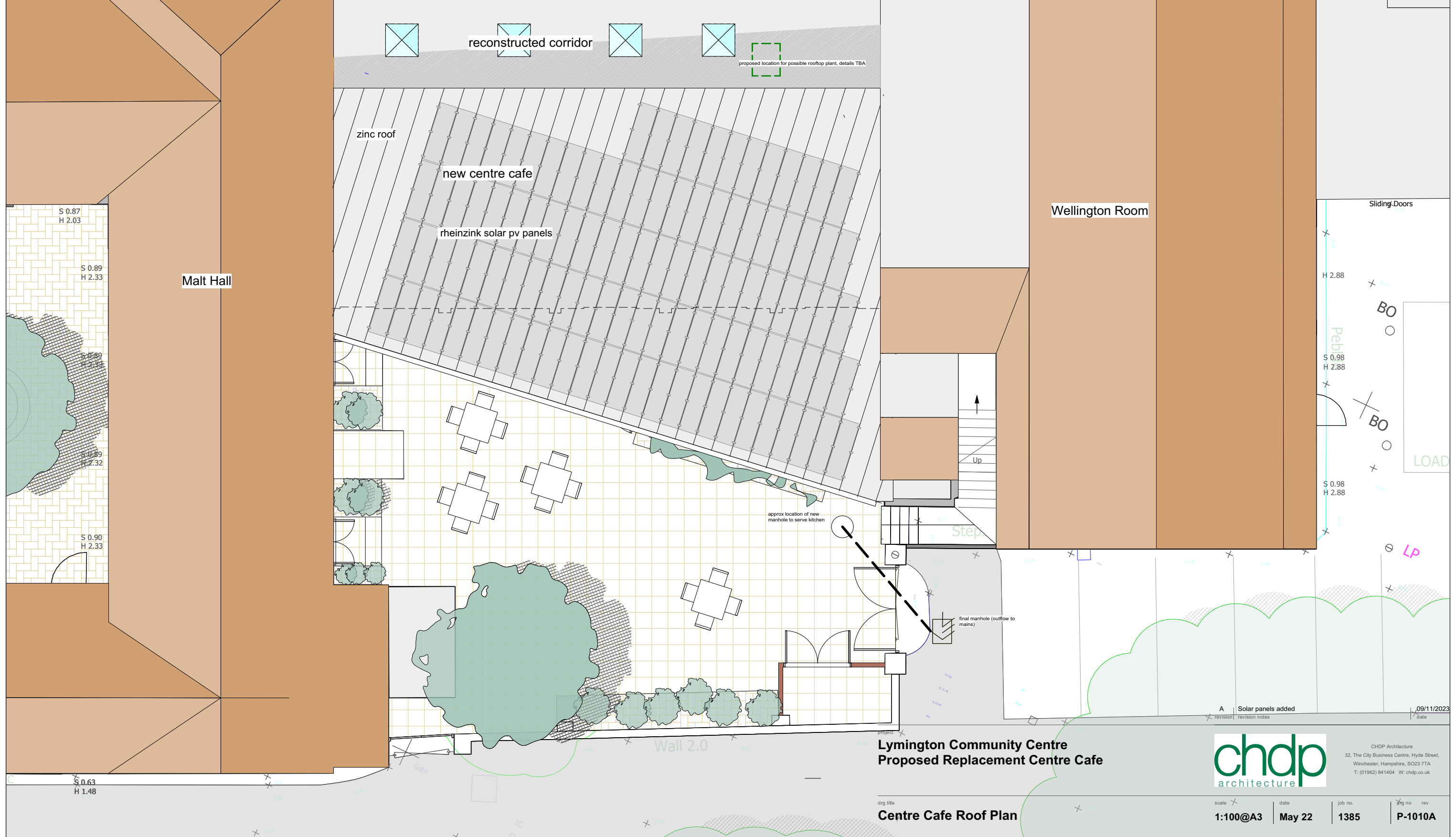

**Lymington Community Centre
 Proposed Replacement Centre Cafe**



CHDP Architecture
 32, The City Business Centre, Hyde Street,
 Winchester, Hampshire, SO23 7TA
 T: (01962) 841404 W: chdp.co.uk

Centre Cafe Roof Plan

scale 1:100@A3 date May 22 job no. 1385 dwg no. rev P-1010A