

# SOLID GROUND FLOOR

U-value 0.18 W/m<sup>2</sup>K  
P/A Ratio 0.5

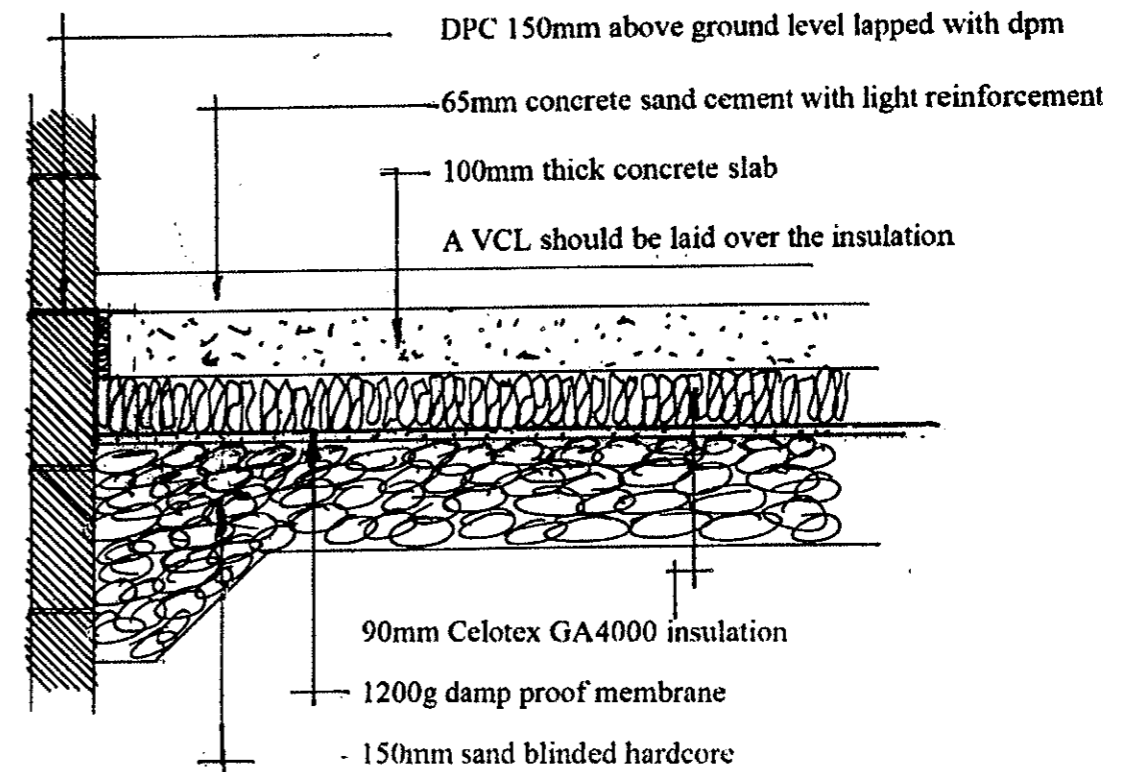
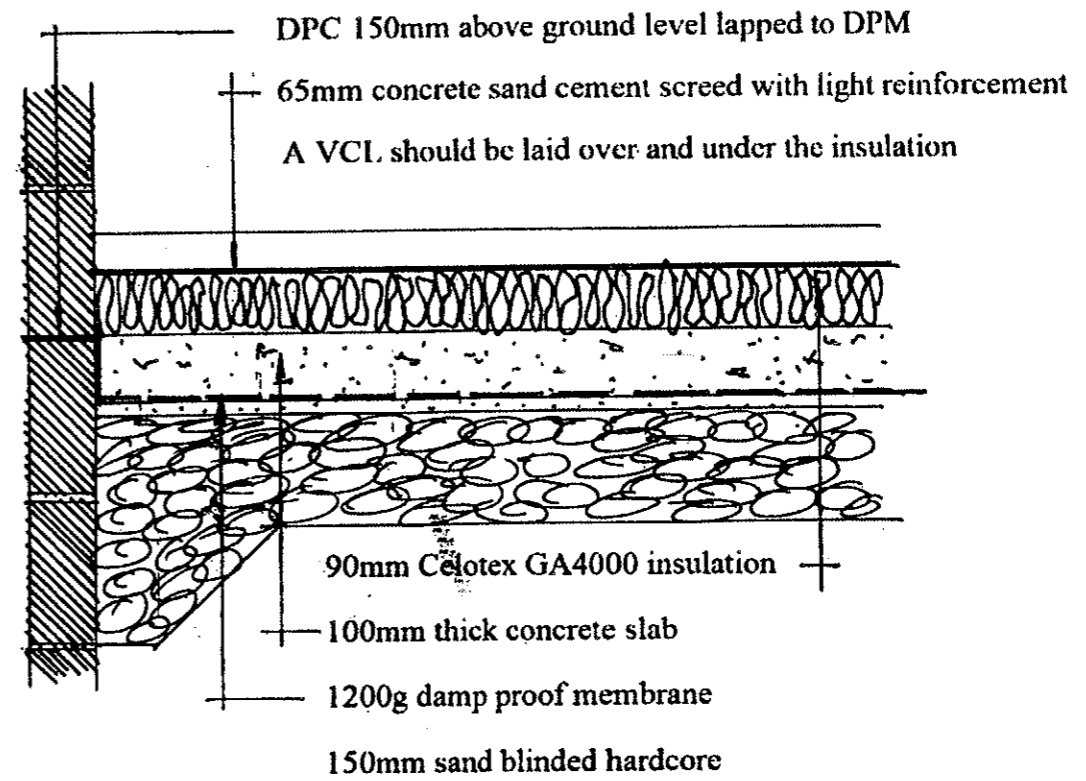

# SOLID GROUND FLOOR

U-value 0.18 W/m<sup>2</sup>K

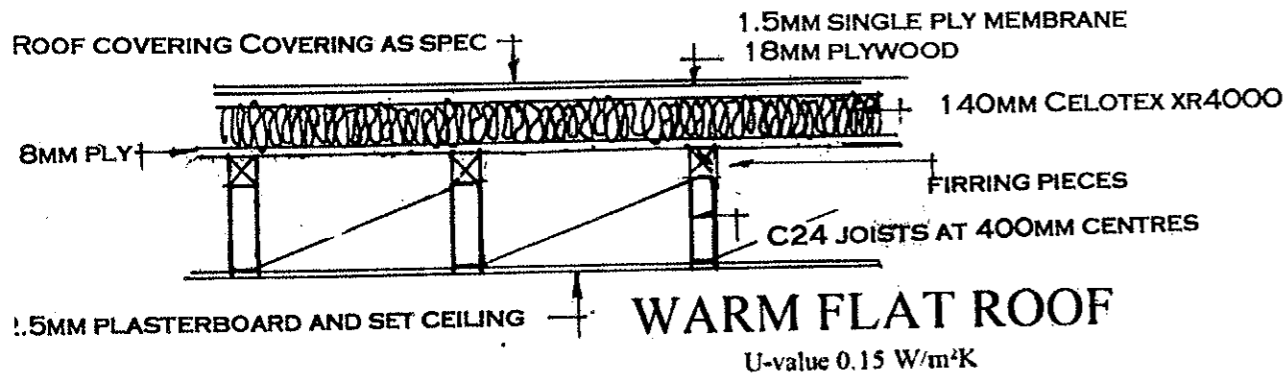

# WARM FLAT ROOF

U-value 0.15 W/m<sup>2</sup>K

**PROPOSED SINGLE STOREY REAR ADDITION.  
45, BROOKLANDS RD, BEDHAMPTON, HANTS.  
FOR MR & MRS B. WAIN.**

AMENDED DEC 2023 ( CORNER SPLAY )

# CAVITY WALL

U-value 0.18 W/m<sup>2</sup>K

Walls to be built with 1:1:6 cement mortar

75mm facing brick

Stainless steel retaining wall ties built in at 750mm ctrs horizontally, 450mm vertically and 225mm ctrs at reveals and corners in staggered rows

Horizontal strip polyiner (hyload) damp proof course to both leafs minimum 150mm above external ground level

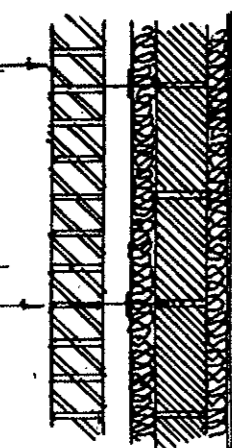

100MM CAVITY

Cavity wall skins - 100mm lightweight 0.15 W/mK

Cavity partially filled with 50mm Celotex GA4000 insulation plus 52.5mm PIR insulated plasterboard internally, e.g. Celotex PL4000. Insulated plasterboard to be dot and dabbed to internal wall or mechanically fixed using battens. VCL provided if required by BCO

Finish with plaster skim

**NOT TO SCALE**

PETER J. WALKER  
ISLAND DESIGN  
182 SEAFRONT, HAYLING ISLAND, HANTS  
PO11 9AN  
TEL: 02392467571