

SCHEDULE OF EXTERNAL MATERIAL

Paths/patio: Natural Indian Sandstone in "Buff".

Driveway: Permeable "Oxford Stone" shingle edged in granite setts.

Fencing: treated softwood close board with provision for "Hedgehog holes" in gravel board - refer to separate notes

SOFT LANDSCAPING

Note - the existing site is already an established residential garden with mature trees and border planting. All of the trees on site to be retained and protected except for those identified on MacIntyre Arboricultural Impact Assessment Report. All existing border planting to be retained. It is not intended to plant any additional trees or hedges

New herb garden to be created to encourage birds, bees and butterflies and to comprise a mix of Mediterranean herbs such as:

- Mint
- Rosemary
- Sage
- Thyme
- Chives

Annual and biennial herbs, such as basil, parsley, coriander, dill and purslane

The proposed work will undoubtedly disturb lawn areas and all lawn affected by the proposed work will be reinstated upon completion using good quality grass turf or reseeded.

For specifications and details of all trees on site, which are to be retained, protected or for those trees to be removed, reference to be made to MacIntyre Arboricultural Impact Assessment Report.

MINIMUM 3.0M CLEARANCE BETWEEN SEWER AND NEW FOUNDATION

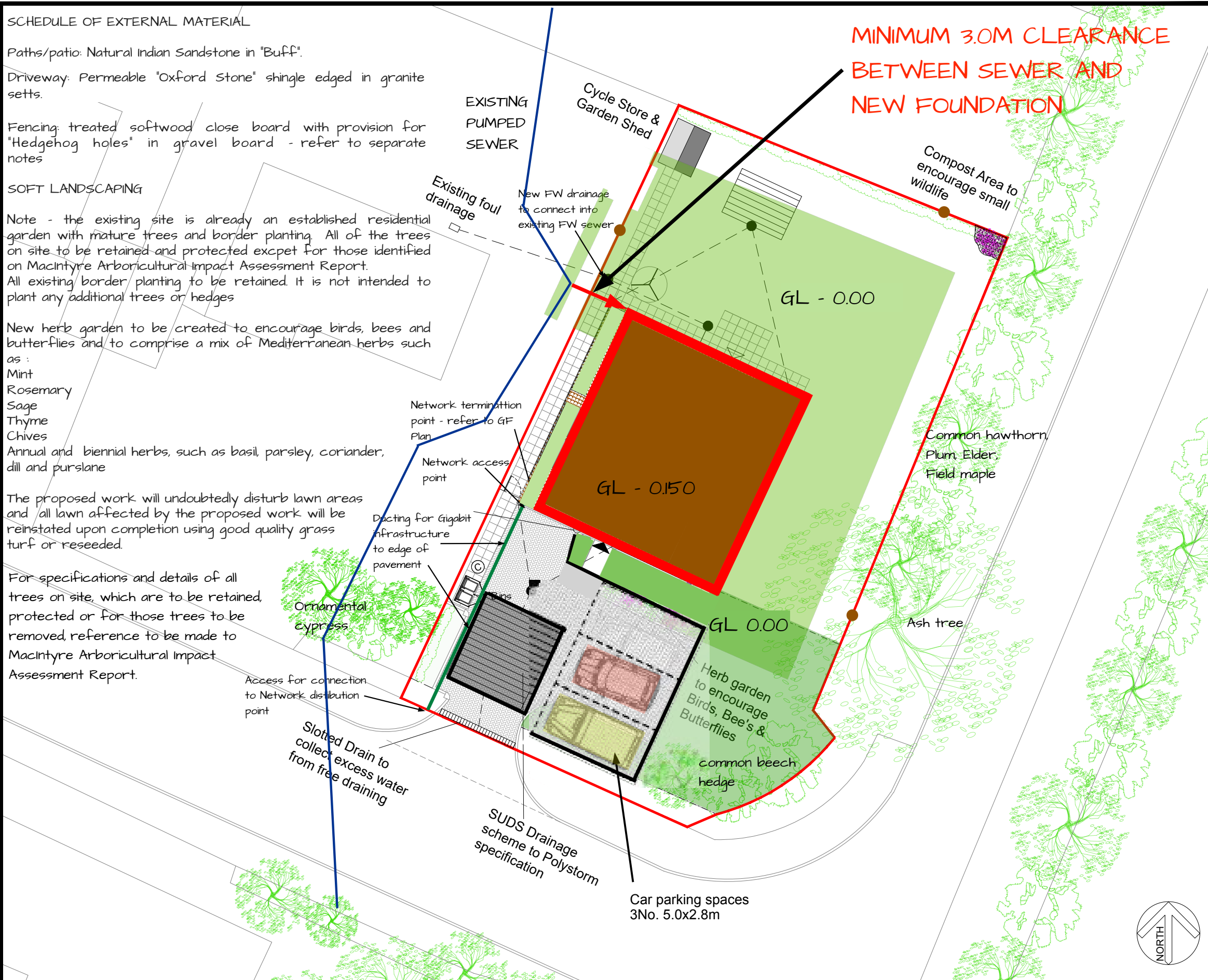

Hedgehogs: Boundaries and barriers within and surrounding the development, including fencing, railing and gates to be made permeable to hedgehogs through the provision of 'Hedgehog Highways' created by 130x130mm holes at ground level within fences, or by leaving a sufficient gap beneath gates and/or leaving brick spaces at the base of brick walls. Alternatively, hedgehog friendly gravel boards are suitable (as shown above sourced by Kebur Garden Materials and Jacksons Fencing). To ensure holes are kept open 'Hedgehog Highway' signage should be provided (as shown above sourced by Peoples Trust for Endangered Species and/or the British Hedgehog Preservation Society) and secured above the holes. Refer to brown dots on the drawing

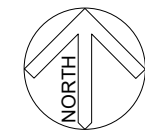
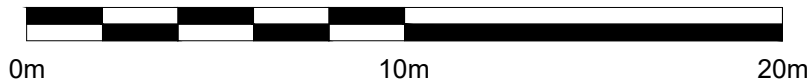

| | | |
|----------------------------------------------------------------------------------------------------------------------------|----------|----------|
| | | |
| | | |
| A | Date | Revision |
| ALL DIMENSIONS SHOULD BE CHECKED ON SITE. ANY DISCREPANCIES TO BE NOTIFIED TO THE ARCHITECTURAL DESIGNER. | | |
| David Rowe Dip Surv MCIOB | | |
| D design | | |
| 29 Mill Road, Bletchley, Milton Keynes, Bucks Tel: 01295 468036 Mob: 07862 977 075 E-mail: davidrowedesign@gmail.com | | |
| Client Mr R Taylor & Miss E Hogg | | |
| Project Land Adjacent To 2 Magpie Way Winslow Buckinghamshire | | |
| Project Erection of detached dwelling - Site Plan and parking layout | | |
| Scale 1: 200 | | |
| Date | Drawn by | |
| Nov 2023 | | |
| Drg No. 23-RT005 | | Rev |