

SP - Existing Site Plan
1:250

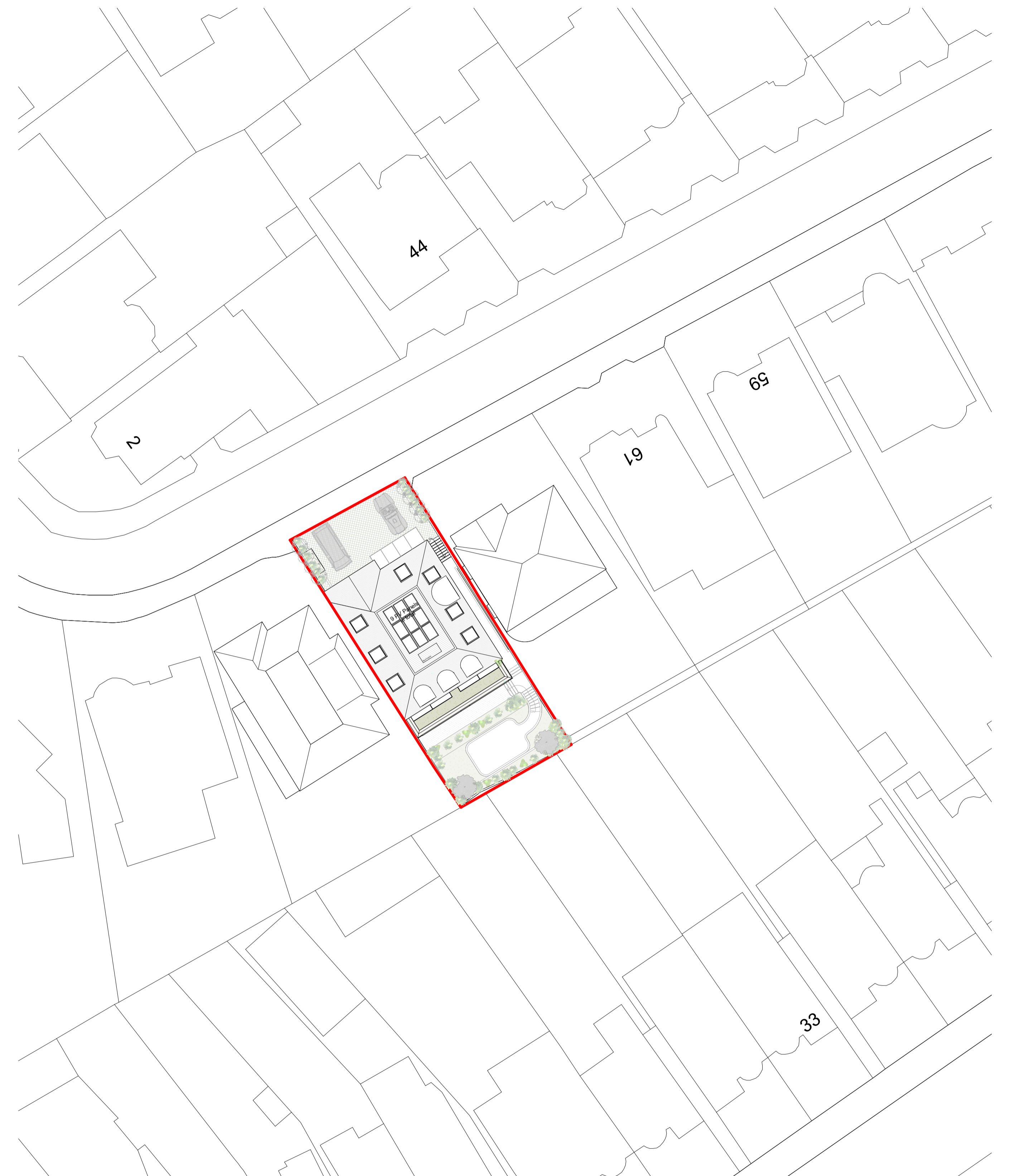

SP - Proposed Site Plan
1:250

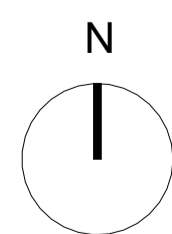

- PLEASE NOTE:
1. ALL DIMENSIONS TO BE VERIFIED ON SITE BEFORE FABRICATION.
 2. CONTRACTOR TO REFER TO ENGINEERS DRAWINGS BEFORE PROCEEDING WITH WORKS.
 3. ALL DRAWINGS AND DESIGNS ARE THE INTELLECTUAL PROPERTY OF THE ARCHITECT AND MAY NOT BE DISTRIBUTED, COPIED OR ISSUED WITHOUT WRITTEN PERMISSION OF THE ARCHITECT.
 4. THE ARCHITECT OWNS THE COPYRIGHT IN ALL ORIGINAL WORKS PRODUCED IN THE PERFORMANCE OF THIS PROJECT

ADDITIONAL NOTES:

1:250 @ A1 / 1:500 @ A3
 meters 5 10 15 20 25

REVISIONS

No	Date	Issued For	Issued By
P1	26.06.23	First Issue For Comments	JZ
P2	11.09.23	Post Pre-App Updates	JZ
P3	02.10.23	Planning Application	JZ
P4	27.10.23	Application Submission	JZ

Client:

Private Client

Project:

65 Highfield Gardens, London

Title:

Existing and Proposed Site Plan

Drawn:

JZ

Scale:

1:250

Chk:

YP

Drawing No:

0010

Project Number:

2308

Rev

P4



IGUANA
ARCHITECTS

Office Architecture: 07554 695 226

info@iguana-architects.com

WWW.IGUANA-ARCHITECTS.COM