

MOLEHILL GREEN, TAKELEY.

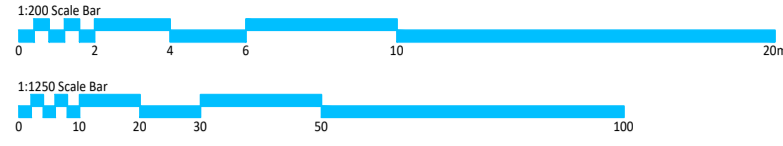

General:
 This drawing is the copyright of More Space Architecture Ltd, which cannot be copied without prior consent.
 The drawing is to be read in conjunction with all other drawings, schedules and specifications, and all other relevant consultants and/or specialists' information relating to the project.
 All dimensions are in millimetres unless otherwise stated. Do not scale from this drawing, use figure dimensions only. All levels and dimensions to be checked on site prior to commencement of works.
 All discrepancies to be relayed back to More Space Architecture Ltd as soon as possible.
 The contractor is to comply in all respects with the current Building Regulations whether or not specifically stated on these drawings.
 IMPORTANT NOTE: Works to be fully compliant with the CDM 2015 Regulations.

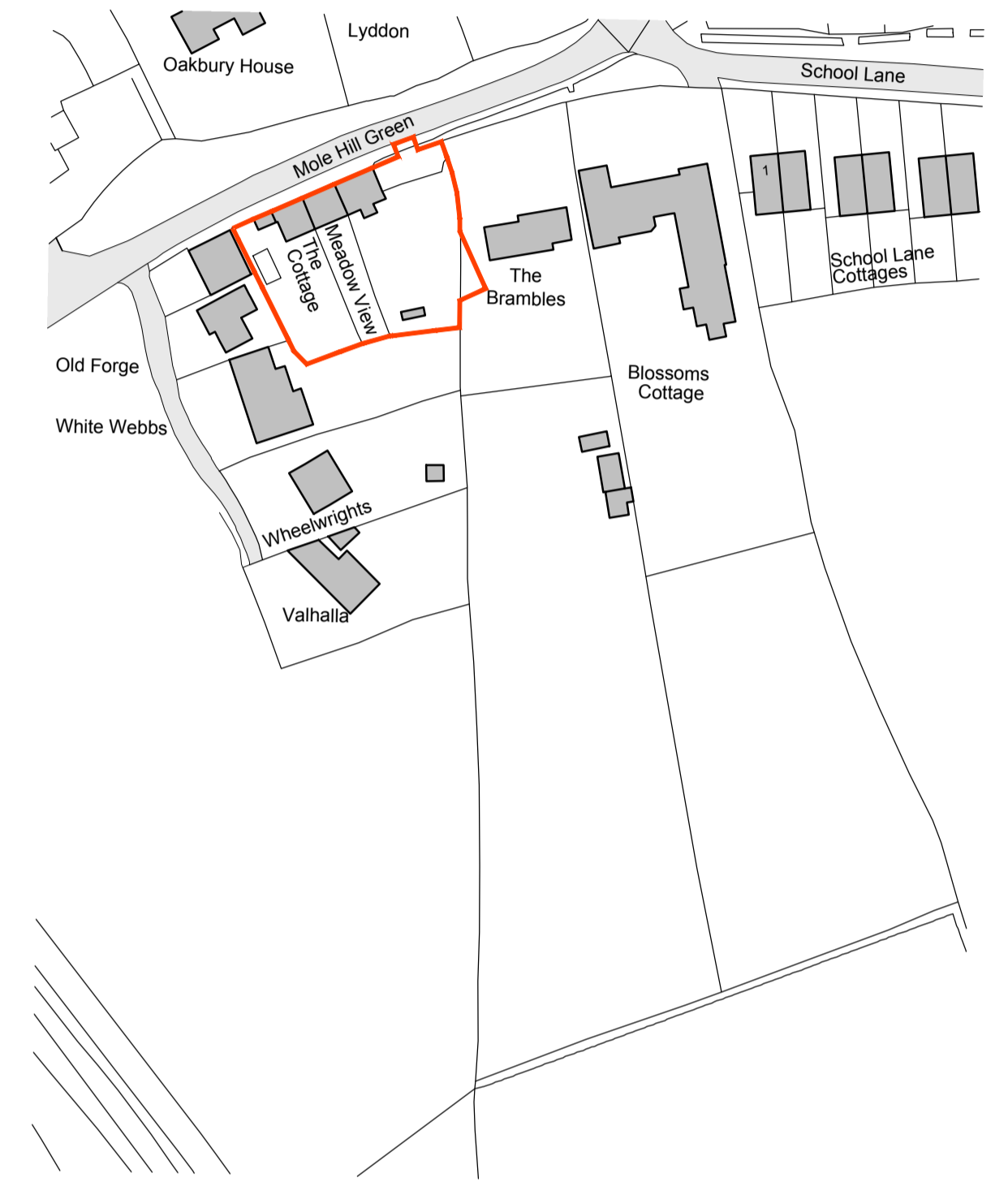
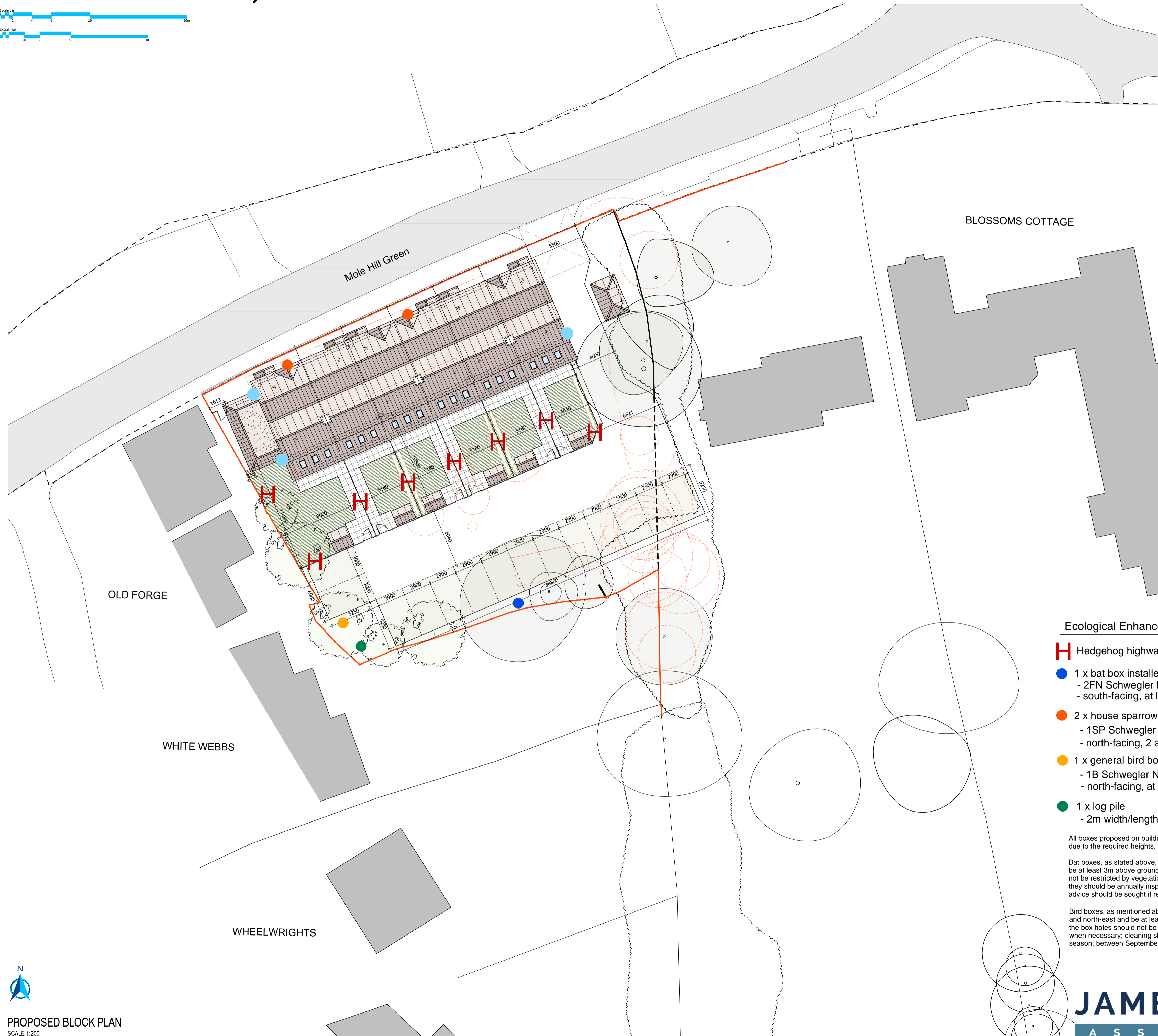

SITE LOCATION PLAN
 SCALE 1:1250

Ecological Enhancements

- H** Hedgehog highways
- 1 x bat box installed on retained tree
 - 2FN Schwegler Bat Box (or similar)
 - south-facing, at least 3m above ground
- 2 x house sparrow terraces installed on building
 - 1SP Schwegler Sparrow Terrace (or similar)
 - north-facing, 2 and 5 m above ground
- 1 x general bird box installed on retained tree
 - 1B Schwegler Nest Box (or similar)
 - north-facing, at least 2m above ground
- 1 x log pile
 - 2m width/length and 1 m in height
- 3 x integrated bat boxes on building
 - Vivara Pro Build-in WoodStone Bat Box (or similar)
 - at least 4m high, with at least 1m clear space below for safe emergence
 - away from artificial lighting

All boxes proposed on buildings should be on residential properties rather than garages due to the required heights.

Bat boxes, as stated above, should be positioned between south-east and south-west, be at least 3m above ground and away from artificial lighting. Additionally, boxes should not be restricted by vegetation. The suggested bat boxes above are 'self-cleaning' but they should be annually inspected for damages and replaced when required. Ecologist advice should be sought if replacement boxes are required.

Bird boxes, as mentioned above, should be positioned between north-west and north-east and be at least 2m above ground. Additionally, entrances to the box holes should not be restricted. Boxes should be inspected and cleaned when necessary; cleaning should be undertaken outside the breeding bird season, between September and February.

Note: Base plan/map produced by MSA (see detail below).
 Ecological Enhancement mark-up produced by JBA.

REV.	DATE:	COMMENT:



t: 01702 690745 m: 07500 300320
 e: info@morespacearchitecture.co.uk
 studio on the green, ballards gore golf club,
 gore road, rochford, essex, ss4 2da

CLIENT:	MOLE HILL GREEN LTD.		
PROJECT:	MEADOW VIEW/THE COTTAGE MOLEHILL GREEN TAKELEY CM22 6PQ		
DRAWING:	PROPOSED BLOCK PLAN AND SITE LOCATION PLAN		
SCALE:	AS NOTED @ A1	DATE:	14.07.2023
PROJECT NO:	23-039	DRAWING NO:	200
		REVISION:	00
DESIGN - PLANNING - BUILDING REG'S			

JAMES BLAKE
 ASSOCIATES

PROPOSED BLOCK PLAN
 SCALE 1:200