

This drawing remains copyright to Ashby Building Consultants Ltd and may only be reproduced with our consent.

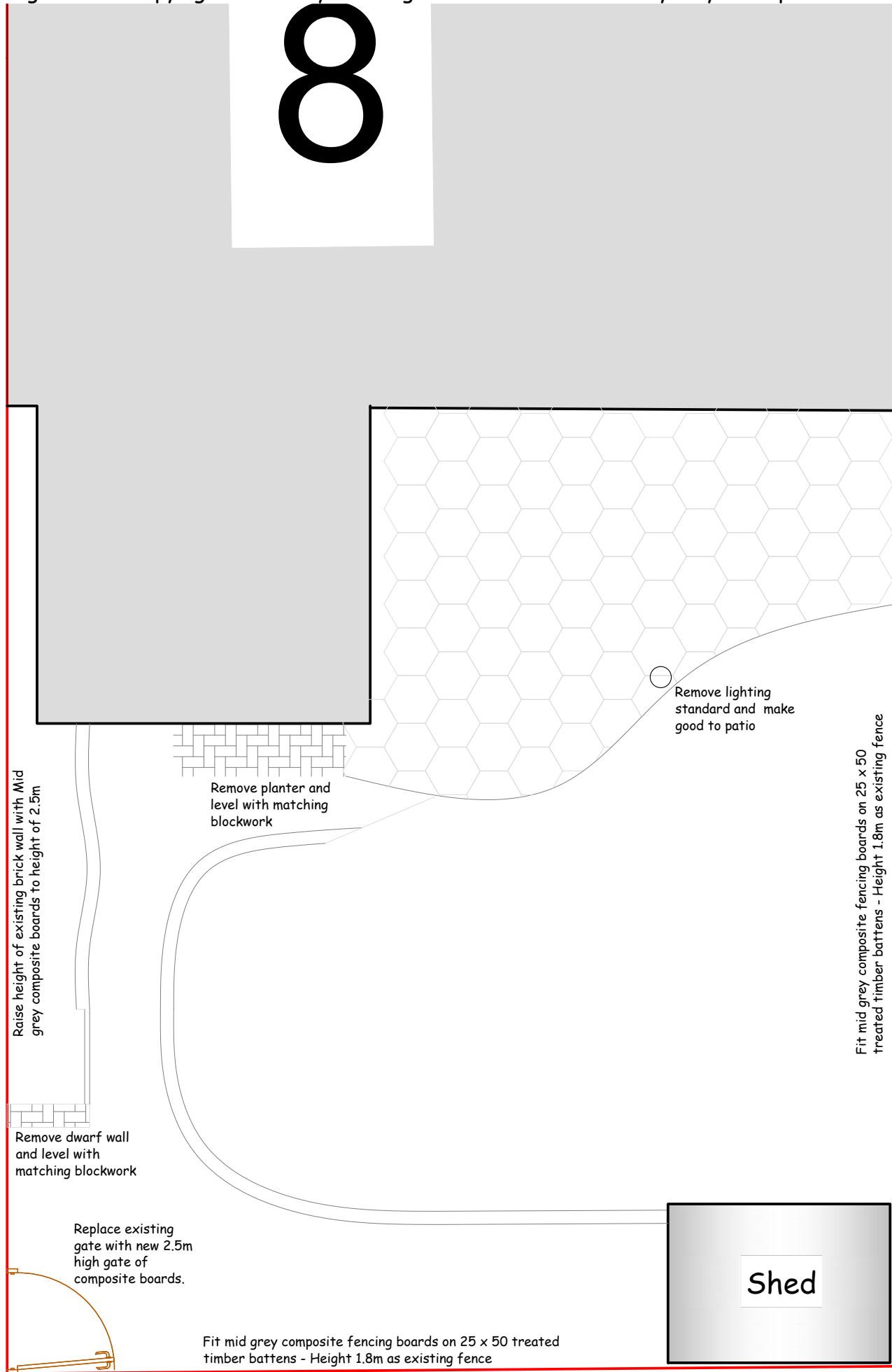

Proposed Ground Floor Plan 1:50

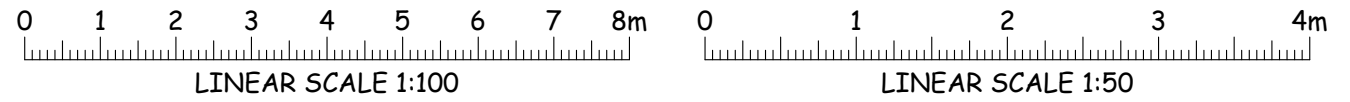
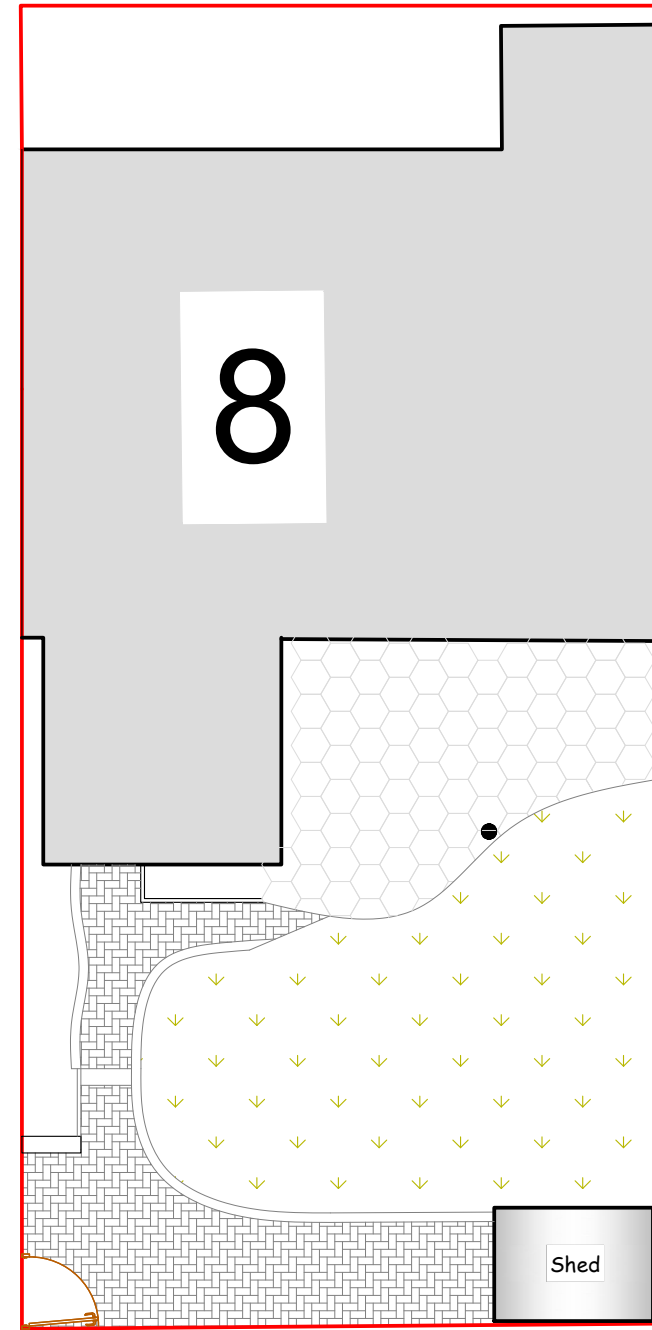

Existing Ground Floor Plan 1:100

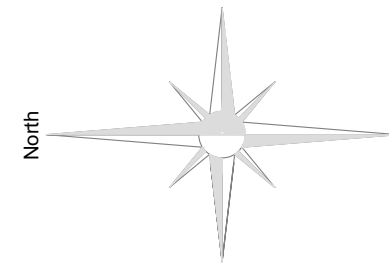

Title
Proposed adaptations
Client
Alan Trto
Address
8 Ingleton
Bracknell
Berkshire RG12 7RN



1 Hainsworth Close, Langham,
Oakham, Rutland, LE15 7HS.
Tel: 07973 105170
e-mail ian@ashbybuildingconsultants.co.uk

Date
November 2023
Scale
1:50 + 1:100

Drawing No.
5842/2