

Fig. A shows the arrangement of areas 1 and 2 in the site of application. Being aware of Area 1 to be developed to the extent as shown in the plan and the boundary lines and of July 2013.

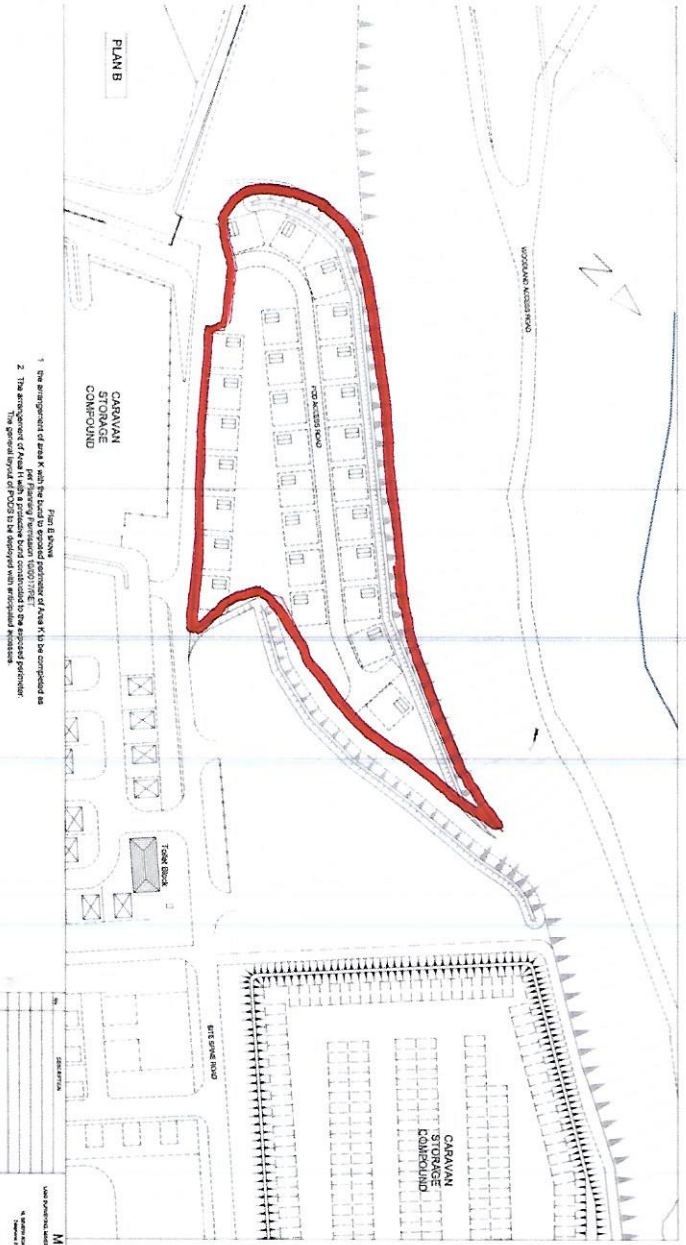
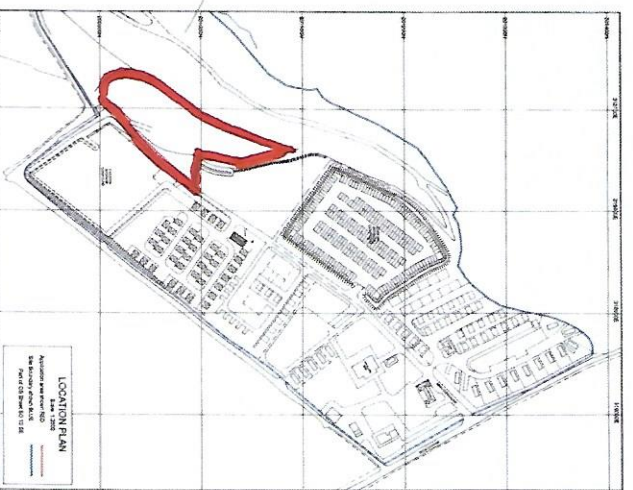

Fig. B shows the arrangement of areas 1 and 2 in the site of application. Being aware of Area 1 to be developed to the extent as shown in the plan and the boundary lines and of July 2013.

Table with 4 columns: Item, Qty, Unit, Price. The table lists various items and their quantities and prices.

Item	Qty	Unit	Price
1. Cabana Storage Compound	1	Lot	1000000
2. Toilet Block	1	Unit	50000
3. Site Spine Road	1	Lot	1000000
4. Woodland Access Road	1	Lot	1000000



THESE PLANS HAVE BEEN MADE BY US ON THE BASIS OF THE INFORMATION PROVIDED TO US BY THE CLIENT. WE ACCEPT NO LIABILITY FOR ANY ERRORS OR OMISSIONS IN THESE PLANS. THE CLIENT IS ADVISED THAT THESE PLANS ARE NOT TO BE USED FOR ANY OTHER PURPOSES WITHOUT OUR WRITTEN CONSENT.

DATE: 15/07/2013 SCALE: 1:1000

MJ ASSOCIATES
 1000 Commercial Street, Suite 100, Vancouver, BC V6C 2T8
 Tel: 604-681-1111 Fax: 604-681-1112
 www.mjassociates.com

CLIENT
 PLYMOUTH ASSOCIATES LTD
 1000 Commercial Street, Suite 100, Vancouver, BC V6C 2T8
 Tel: 604-681-1111 Fax: 604-681-1112

DESCRIPTION OF WORK
 PROPOSAL TO DEVELOP THE SITE OF AREA 1 AND AREA 2 FOR CABANA STORAGE AND TOILET BLOCK CONSTRUCTION AT PLYMOUTH ASSOCIATES PARK.

DATE: 15/07/2013 SCALE: 1:1000