

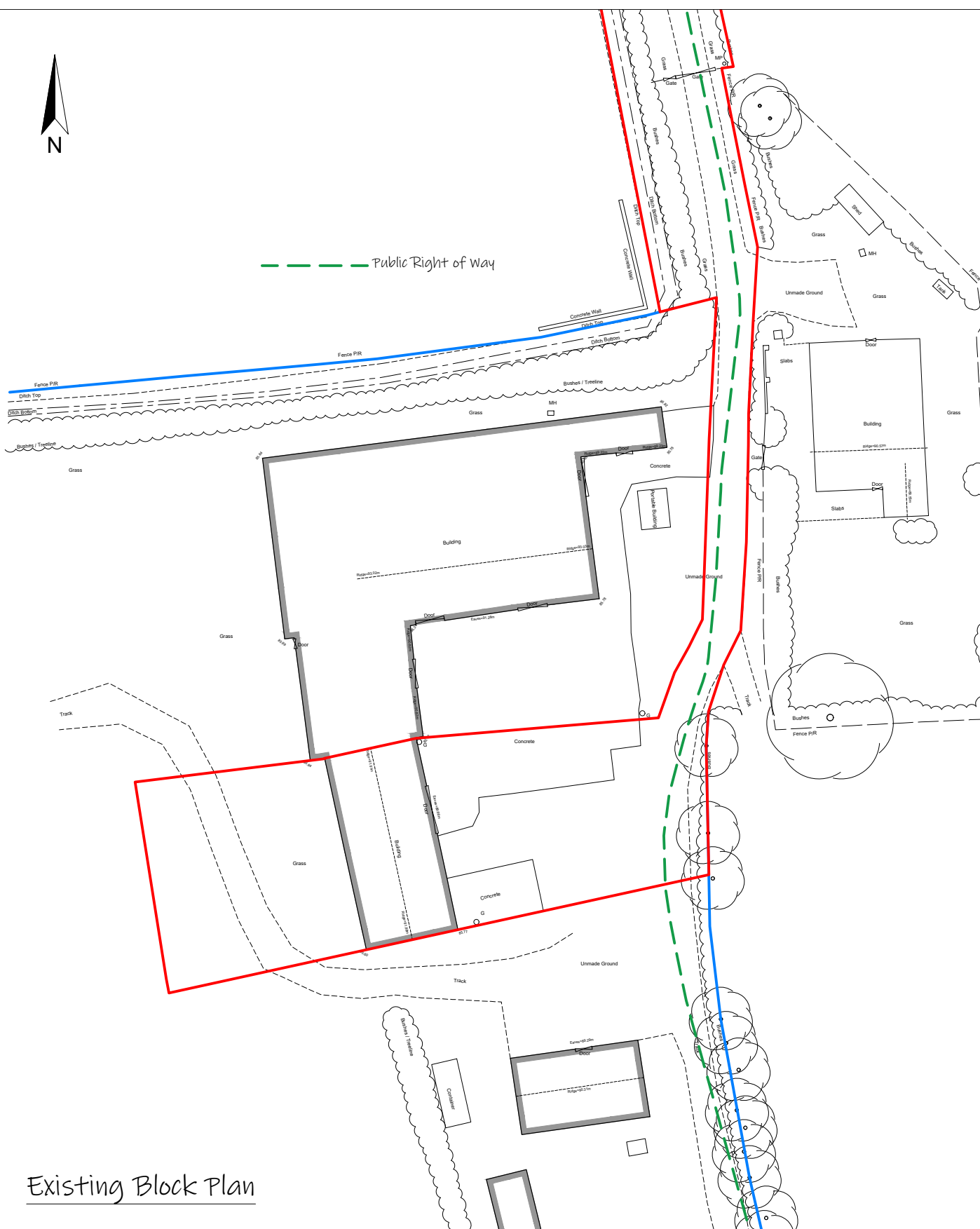

Public Right of Way

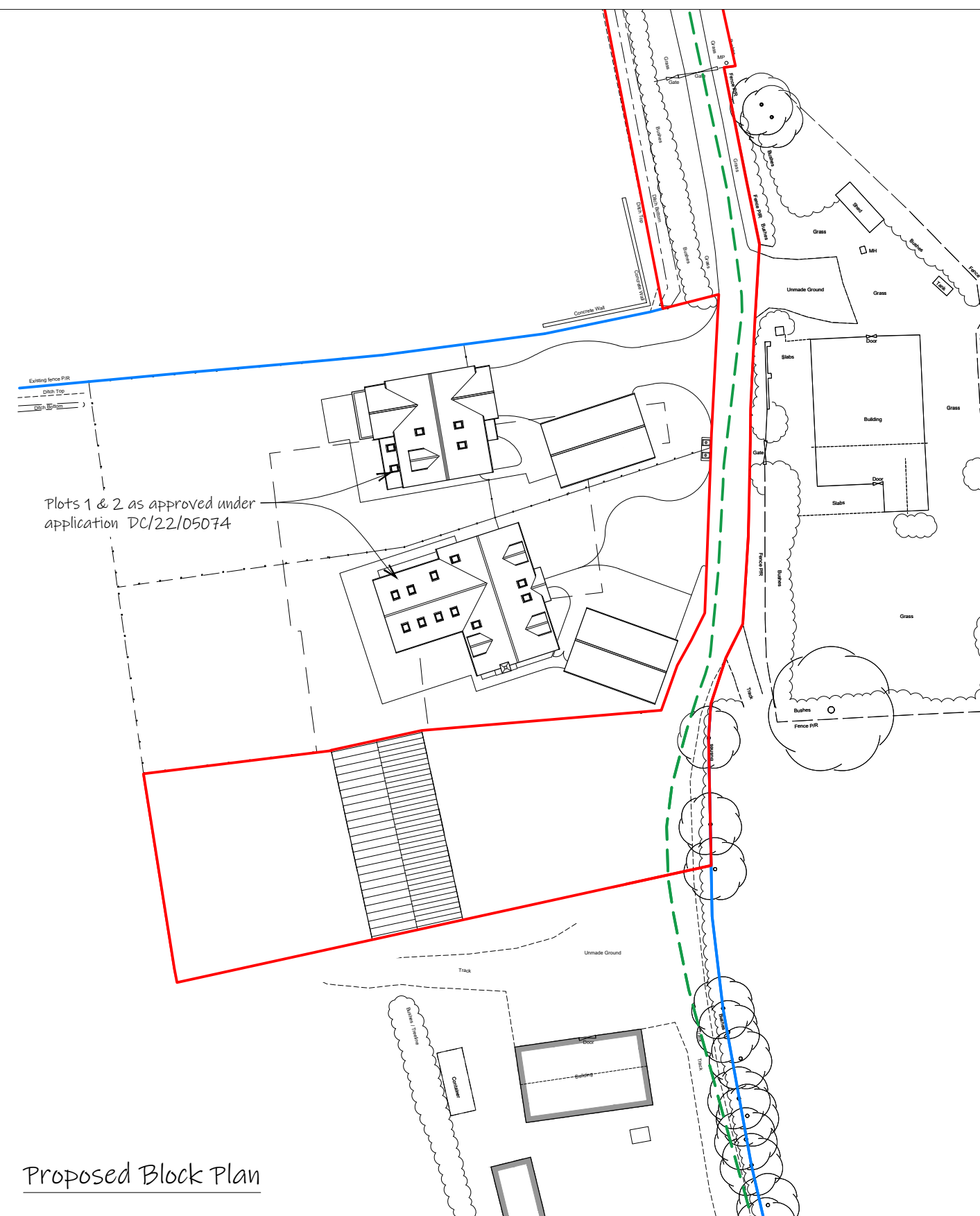

Existing Block Plan



Proposed Block Plan

Plots 1 & 2 as approved under application DC/22/05074

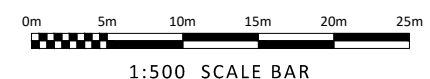

Ian Smillie Architectural Services
75 Camden Road, Ipswich IP3 8JN
telephone 01473 714209
Do not scale from this drawing
- if in doubt ASK.

Existing and Proposed Block Plans
Conversion of Existing Commercial Building
Stoke Farm, Straight Road, Battisford, Stowmarket, Suffolk
scale: 1:500 @ A3 drg. number 2021155/201 rev. -