

MAYPOLE LANE

Ex Public SW  
MH 0501  
CL 151.39  
IL 149.51

Ex Public SW 2250 1:1.14

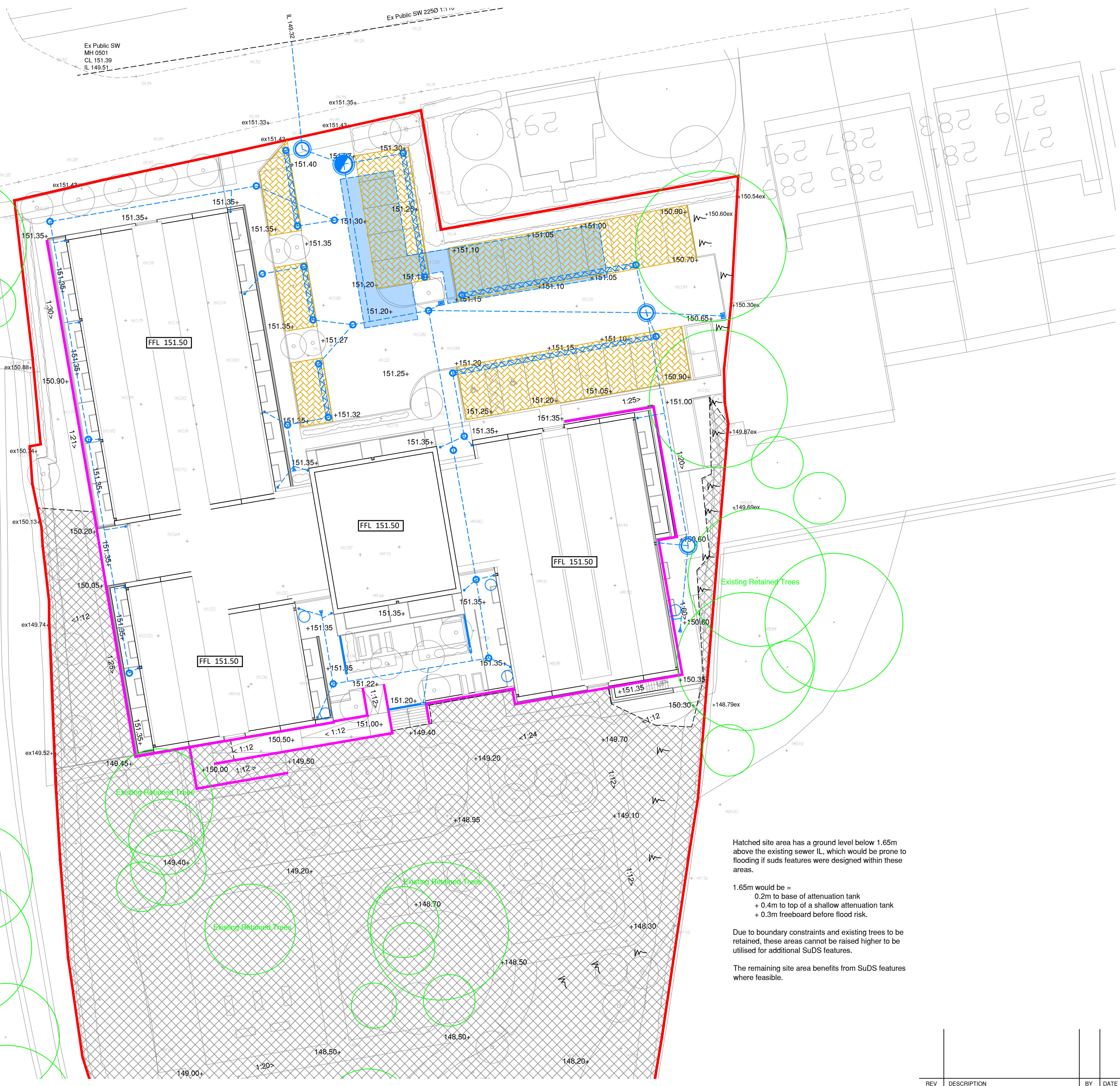

Hatched site area has a ground level below 1.65m above the existing sewer IL, which would be prone to flooding if suDS features were designed within these areas.

1.65m would be =  
 + 0.2m to base of attenuation tank  
 + 0.4m to top of a shallow attenuation tank  
 + 0.3m freeboard before flood risk.

Due to boundary constraints and existing trees to be retained, these areas cannot be raised higher to be utilised for additional SuDS features.

The remaining site area benefits from SuDS features where feasible.

REV	DESCRIPTION	BY	DATE

DRAWING  
**Constraints for  
 SuDS Features**  
 PWS No CS230702-111  
 REV

DRAWN BY  
**DMcC**  
 CHECKED BY  
 DATE  
**08.08.2023**  
 SCALE  
**1:250 @A2**

PROJECT  
**Redevelopment of former  
 Prince of Wales, Shirley**  
 PHASE  
**PLANNING**

CLIENT  
**MACC Group**

**CTSDSIGN**  
 CONSULTING ENGINEERS  
 20 LONGFORD CLOSE  
 BIRMINGHAM B52 4JL  
 WWW.CTSDSIGN.CO.UK  
 INFO@CTSDSIGN.CO.UK