

The historical maps shown were reproduced from maps predominantly held at the scale adopted for England, Wales and Scotland in the 1840's. In 1854 the 1:2500 scale was adopted for mapping urban areas; these maps were used to update the 1:10,560 maps. The published date given therefore is often some years later than the surveyed date. Before 1930, all Ordnance Survey maps were produced by hand-drawn methods. The first large-scale aerial photography was taken in 1909, and the first aerial photograph of Essex, showing the site, was produced in 1911. In the late 1940's, a Provisional Edition was produced which updated the 1:10,560 mapping from a number of sources. The maps appear unprinted - with all military camps and other strategic sites removed. These maps were initially overlaid with the National Grid. In 1970, the first 1:10,000 maps were produced using the Transverse Mercator Projection. The revision process continued until recently, with new editions appearing every 10 years or so for urban areas.

Map Name(s) and Date(s)

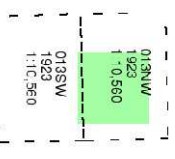

Historical Map - Slice A

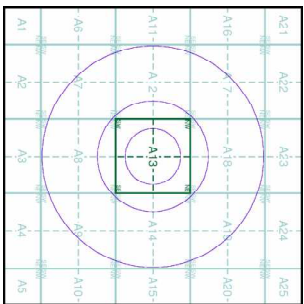

Order Details

Order Number: 317536487_1_1
 Customer Ref: 3404
 National Grid Reference: 548450, 235230
 Site: A
 Site Area (ha): 0.01
 Search Buffer (m): 1000

Site Details

Mulberry House Farm, Wenden Road, Arkesden, SAFFRON WALDEN, CB11 4HD

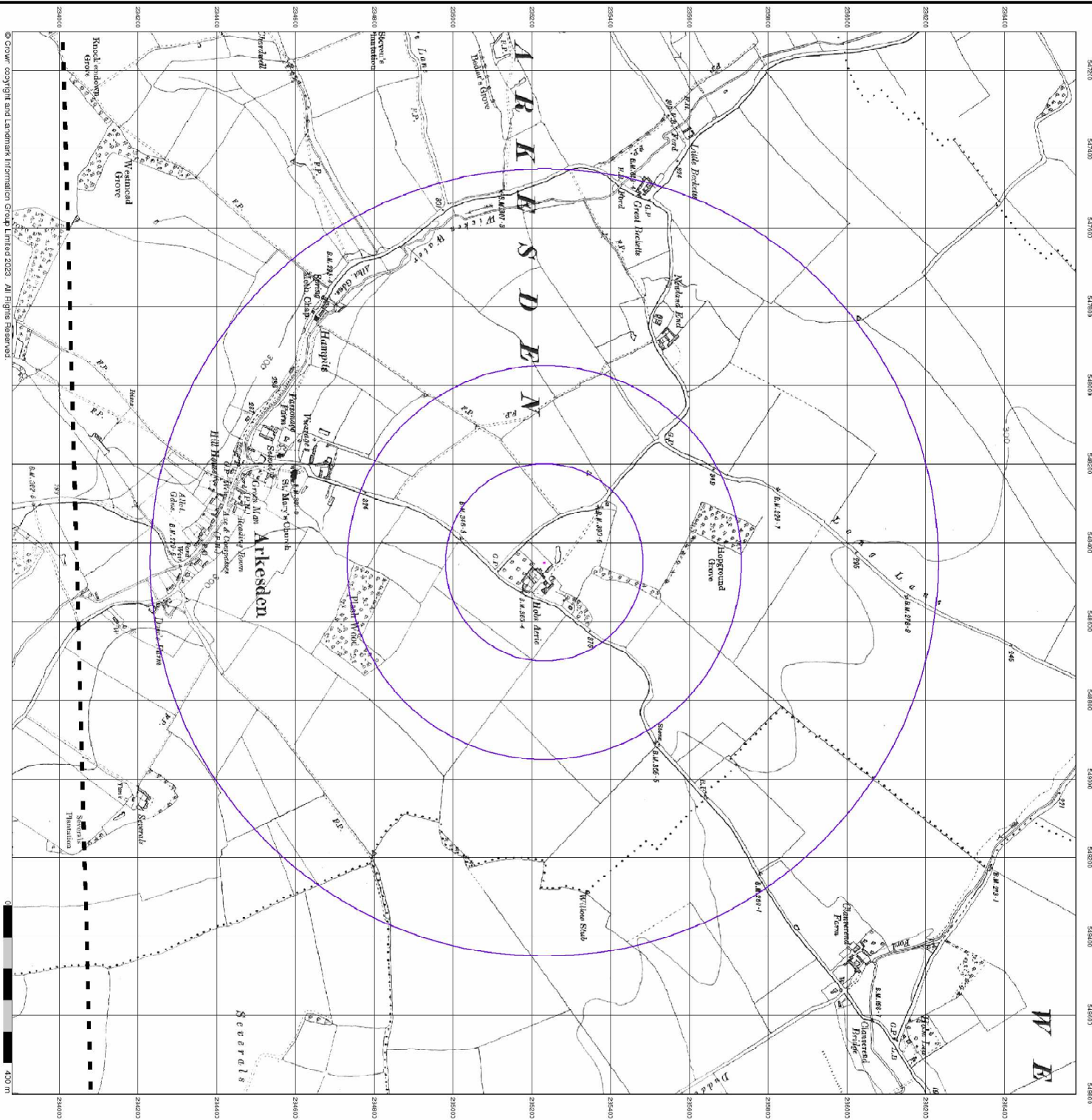

54720 54740 54760 54780 54800 54820 54840 54860 54880 54900 54920 54940 54960 54980 55000

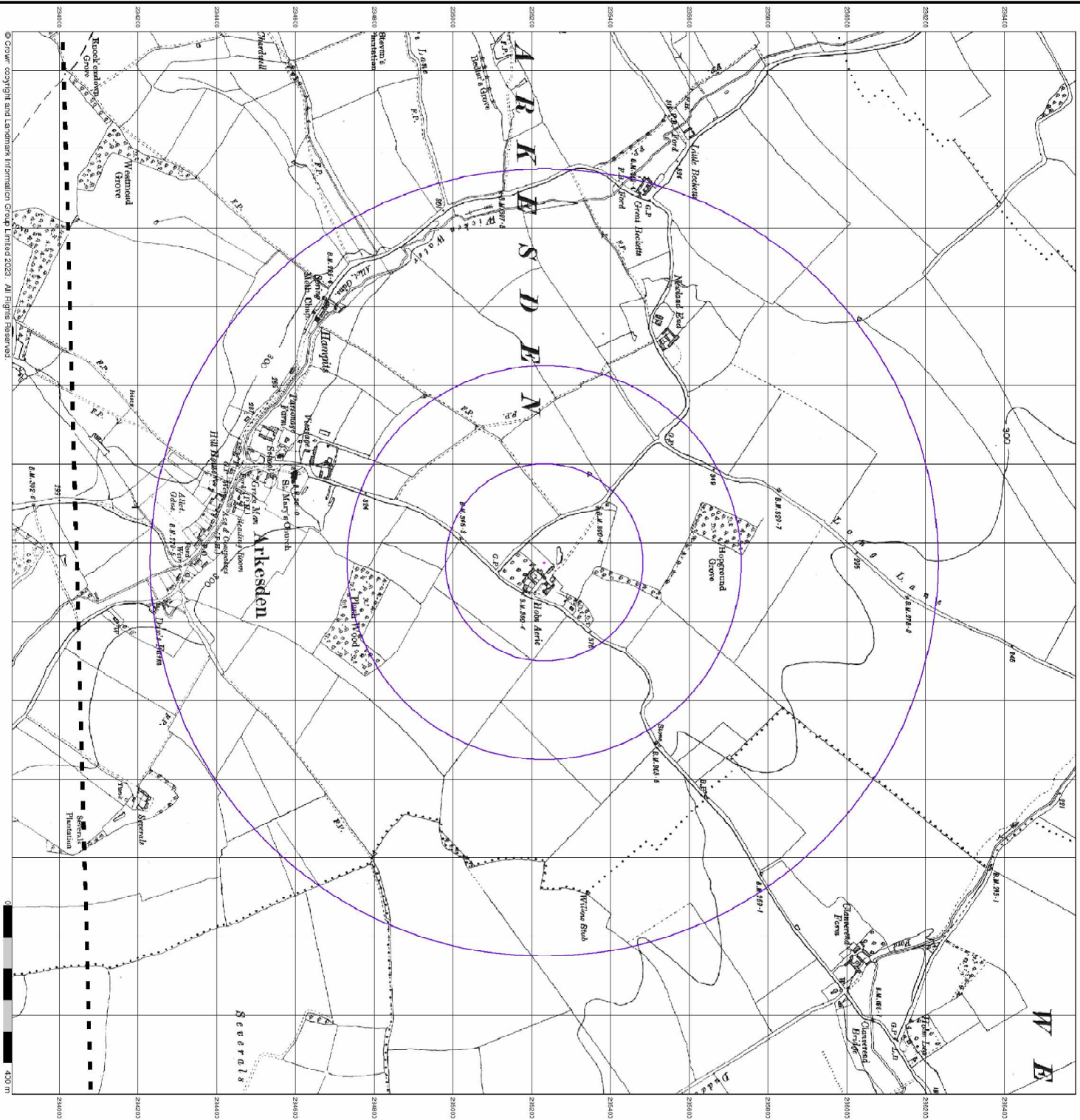

© Crown Copyright and Landmark Information Group Limited 2023. All Rights Reserved.

Envirocheck

LANDMARK INFORMATION GROUP

Essex

Published 1923

Source map scale - 1:10,560

The historical maps shown were reproduced from maps predominantly held at the scale adopted for England, Wales and Scotland in the 1840's. In 1854 the 1:2500 scale was adopted for mapping urban areas; these maps were used to update the 1:10,560 maps. The published date given therefore is often some years later than the surveyed date. Before 1930, all Ordnance Survey maps were produced by the Survey of England, which was a county by county process, producing maps to significant map scales in cutting areas. In the late 1940's, a Provincial Edition was produced which updated the 1:10,560 mapping from a number of sources. The maps appear unmodified - with all military camps and other strategic sites removed. These maps were initially overprinted with the National Grid. In 1970, the first 1:10,000 maps were produced using the Transverse Mercator Projection. The revision process continued until recently, with new editions appearing every 10 years or so for urban areas.

Map Name(s) and Date(s)

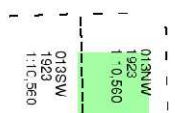

Historical Map - Slice A

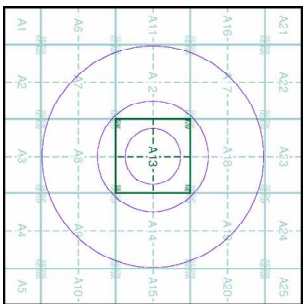

Order Details

Order Number: 317536487_1_1
 Customer Ref: 3404
 National Grid Reference: 548450, 235230
 Slice: A
 Site Area (ha): 0.01
 Search Buffer (m): 1000

Site Details

Mulberry House Farm, Wenden Road, Arkesden, SAFFRON WALDEN, CB11 4HD



Tel: 0844 844 9952
 Fax: 0844 844 9951
 Web: www.envirocheck.co.uk

Essex

Published 1950

Source map scale - 1:10,560

The historical maps shown were reproduced from maps predominantly held at the scale adopted for England, Wales and Scotland in the 1840's. In 1854 the 1:2,500 scale was adopted for mapping urban areas, these maps were used to update the 1:10,560 maps. The published date given therefore is often some years later than the surveyed date. Before 1930, all Ordnance Survey maps were produced by the Survey of the Kingdom of Great Britain. In the late 1940's, a Provincial Edition was produced which updated the 1:10,560 mapping from a number of sources. The maps appear unmodified - with all military camps and other strategic sites removed. These maps were initially overlaid with the National Grid. In 1970, the first 1:10,000 maps were produced using the Transverse Mercator Projection. The revision process continued until recently, with new editions appearing every 10 years or so for urban areas.

Map Name(s) and Date(s)

- 013SNW 1950
- 1:10,560
- 013SW 1950
- 1:10,560

Historical Map - Slice A

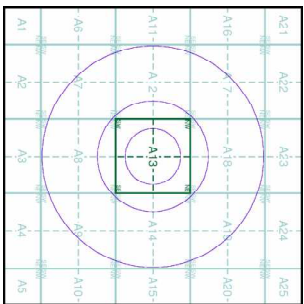

Order Details
 Order Number: 317536487_1_1
 Customer Ref: 3404
 National Grid Reference: 548450, 235230
 Slice: A
 Site Area (ha): 0.01
 Search Buffer (m): 1000

Site Details
 Mulberry House Farm, Wenden Road, Arkesden, SAFFRON WALDEN, CB11 4HD

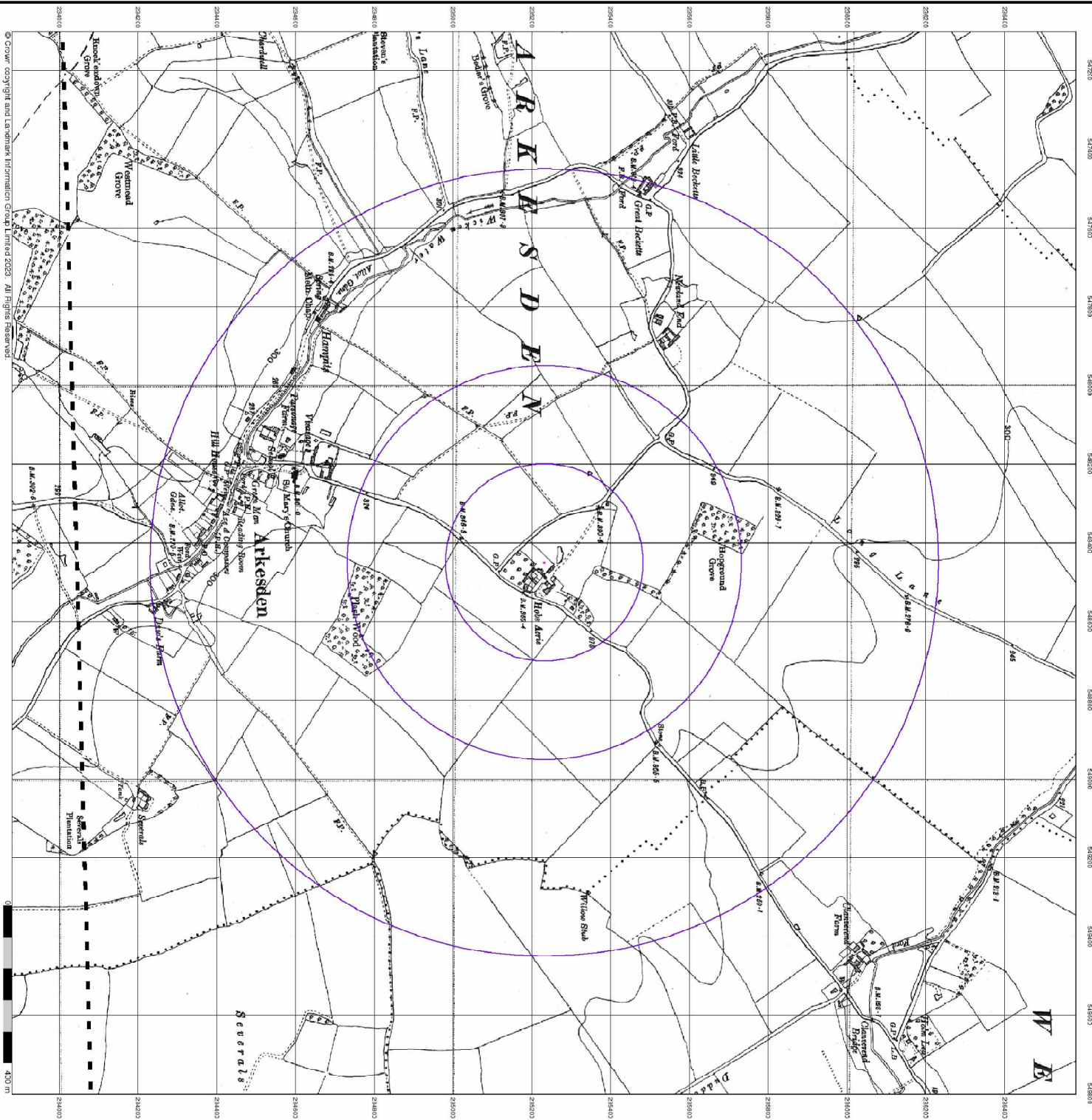

The historical maps shown were reproduced from maps predominantly held at the scale adopted for England, Wales and Scotland in the 1840's. In 1854 the 1:2,500 scale was adopted for mapping urban areas, these maps were used to update the 1:10,560 maps. The published date given therefore is often some years later than the surveyed date. Before 1930, all OS maps were produced on a grid of squares, published to significant measured units in county areas. In the late 1940's, a Provisional Edition was produced which updated the 1:10,560 mapping from a number of sources. The maps appear unfinished - with all military camps and other strategic sites removed. These maps were initially overlaid with the Transverse Mercator Projection. The 1:10,000 maps were produced using the National Grid. In 1970, the first revision process continued until recently, with new editions appearing every 10 years or so for urban areas.

Map Name(s) and Date(s)

- 062BNW 1951
- 1:10,560
- JCE3SW 1951
- 1:10,560

Historical Map - Slice A

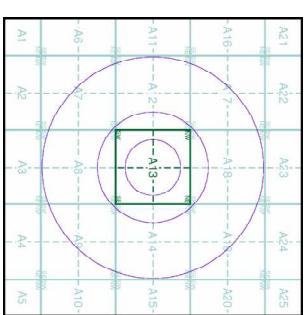

Order Details

Order Number: 317536487_1_1
 Customer Ref: 3404
 National Grid Reference: 548450, 235230
 Slice: A
 Site Area (ha): 0.01
 Search Buffer (m): 1000

Site Details

Mulberry House Farm, Wenden Road, Akedden, SAFFRON WALDEN, CB11 4HD

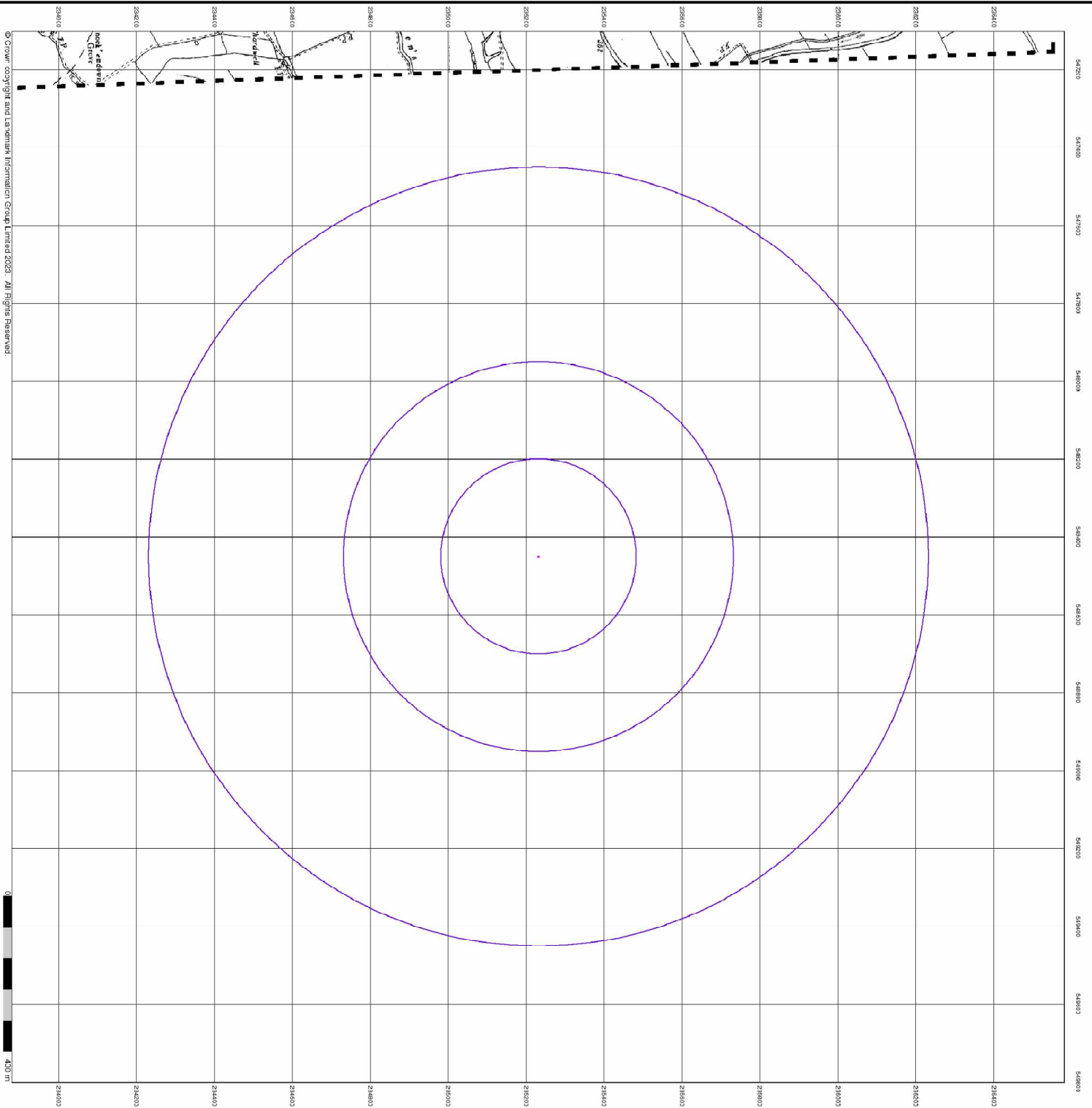

Ordnance Survey Plan
Published 1960

Source map scale - 1:10,000

The historical maps shown were reproduced from maps predominantly held at the scale adopted for England, Wales and Scotland in the 1940's. In 1954 the 1:2500 scale was adopted for mapping urban areas; these maps were used to update the 1:10,000 maps. The published date given therefore is often some years later than the surveyed date. Before 1930, all OS maps were produced by a group of courses, intended to significant measured in outline areas. In the late 1940's, a Provisional Edition was produced which updated the 1:10,000 mapping from a number of sources. The maps appear unshaded - with all military camps and other strategic sites removed. These maps were initially overwritten with the National Grid. In 1970, the first 1:10,000 maps were produced using the Transverse Mercator Projection. The revision process continued until recently, with new editions appearing every 10 years or so for urban areas.

Map Name(s) and Date(s)

TL43NE	1960
1:10,560	
TL43SE	1960
1:10,560	

Historical Map - Slice A

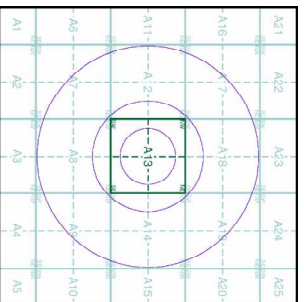

Order Details

Order Number: 317536487_1_1
Customer Ref: 3404
National Grid Reference: 548450, 235230
Slice: A
Site Area (ha): 0.01
Search Buffer (m): 1000

Site Details

Mulberry House Farm, Wenden Road, Arkelden, SAFFRON WALDEN, CB11 4HD

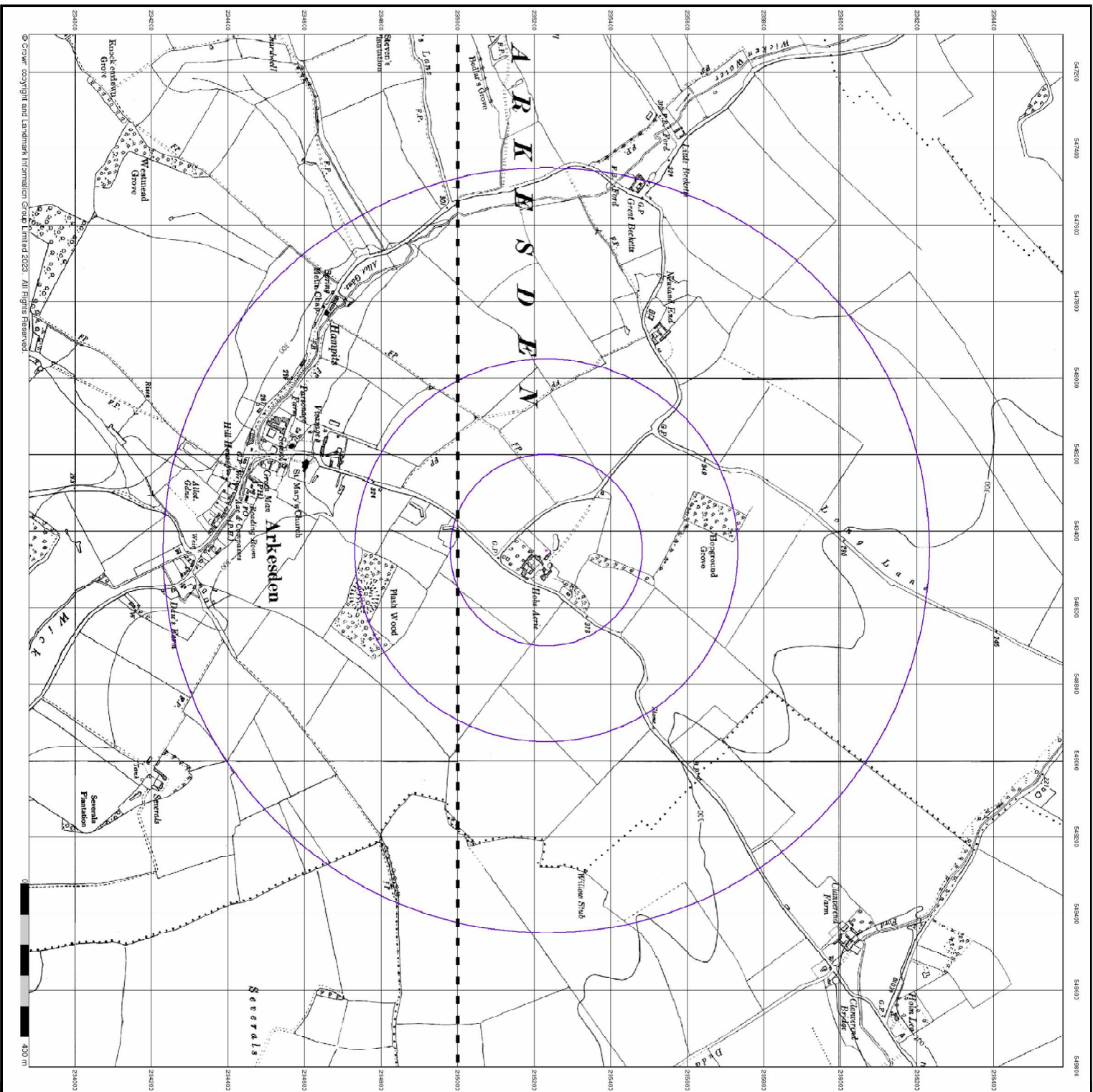

Ordnance Survey Plan

Published 1982

Source map scale - 1:10,000

The historical maps shown were reproduced from maps predominantly held at the scale adopted for England, Wales and Scotland in the 1840's. In 1854 the 1:2500 scale was adopted for mapping urban areas, these maps were used to update the 1:10,000 maps. The published date given therefore is often some years later than the surveyed date. Before 1930, all OS single county maps were produced by the Ordnance Survey, although in some counties a group of counties operated to significant measure in earlier years. In the late 1940's, a Provisional Edition was produced which updated the 1:10,000 mapping from a number of sources. The maps appear unmodified - with all military camps and other strategic sites removed. These maps were initially overlaid with the National Grid. In 1970, the first 1:10,000 maps were produced using the Transverse Mercator Projection. The revision process continued until recently, with new editions appearing every 10 years or so for urban areas.

Map Name(s) and Date(s)

- TL43NE 1 1982
- 1:10,000
- TL43SE 1 1982
- 1:10,000

Historical Map - Slice A

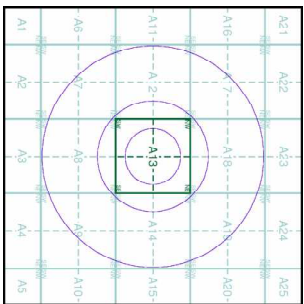

Order Details

Order Number: 317536487_1_1
 Customer Ref: 3404
 National Grid Reference: 548450, 235230
 Site: A
 Site Area (ha): 0.01
 Search Buffer (m): 1000

Site Details

Mulberry House Farm, Wenden Road, Arkesden, SAFFRON WALDEN, CB11 4HD

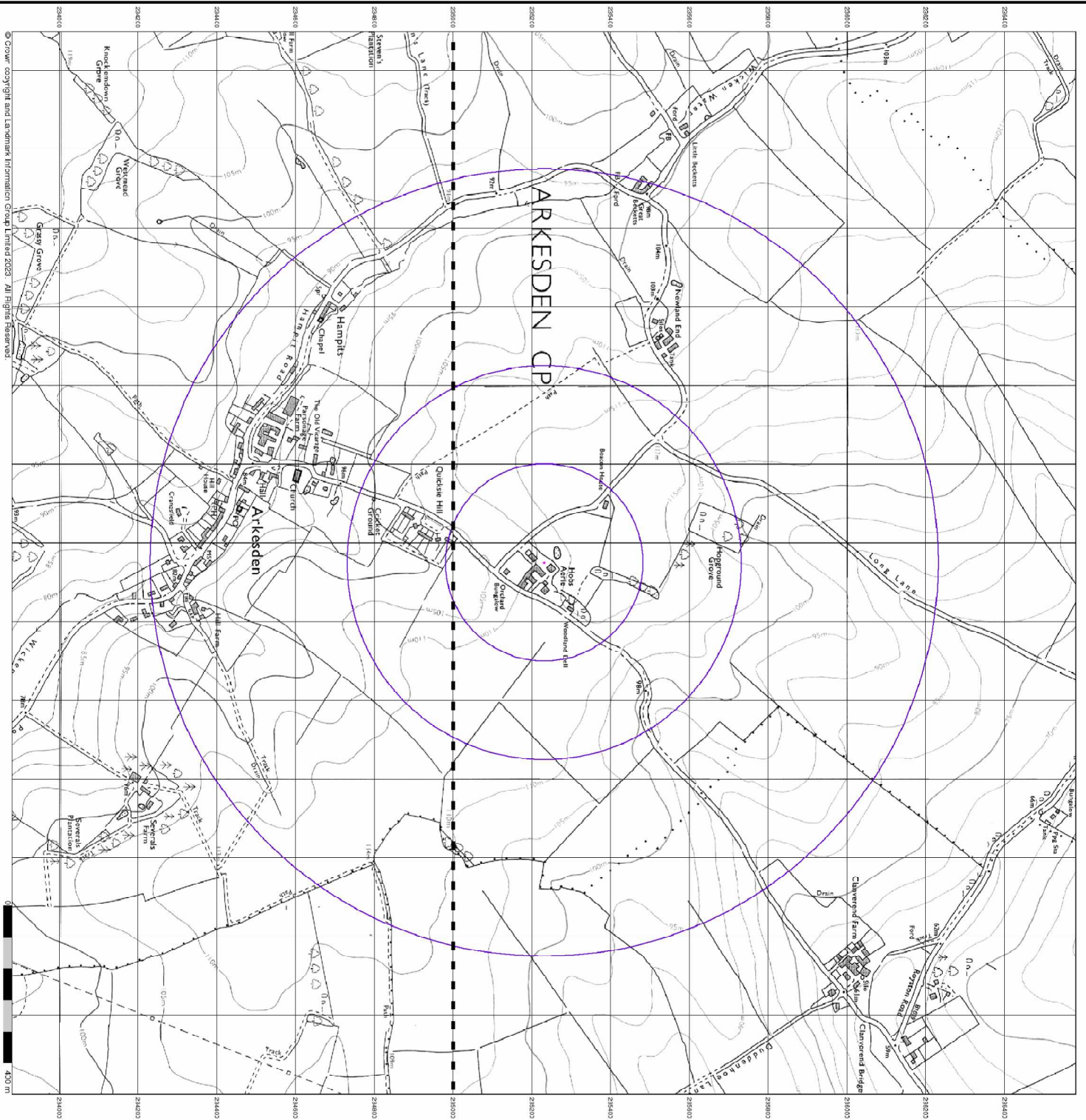

10k Raster Mapping

Published 1999

Source map scale - 1:10,000

The historical maps shown were produced from the Ordnance Survey's 1:10,000 colour raster mapping. These maps are derived from Landplan which replaced the old 1:10,000 maps originally published in 1970. The data is highly detailed showing buildings, fences and field boundaries as well as all roads, tracks and paths. It also includes together with the raster map, the associated vector data. This vector data includes information on the map's projection, datum, county, unitary authority, district, civil parish and constituency.

Map Name(s) and Date(s)

- TL43N2 1599
- 1:10,000
- TL43SE 1599
- 1:10,000

Historical Map - Slice A

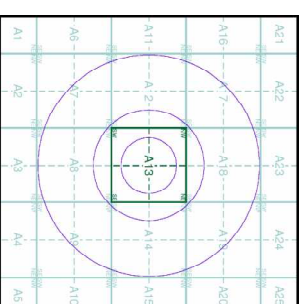

Order Details

Order Number: 317536487_11
 Customer Ref: 3404
 National Grid Reference: 548450, 235230
 Site: A
 Site Area (Ha): 0.01
 Search Buffer (m): 1000

Site Details

Mulberry House Farm, Wenden Road, Arkesden, SAFFRON WALDEN, CB11 4HD

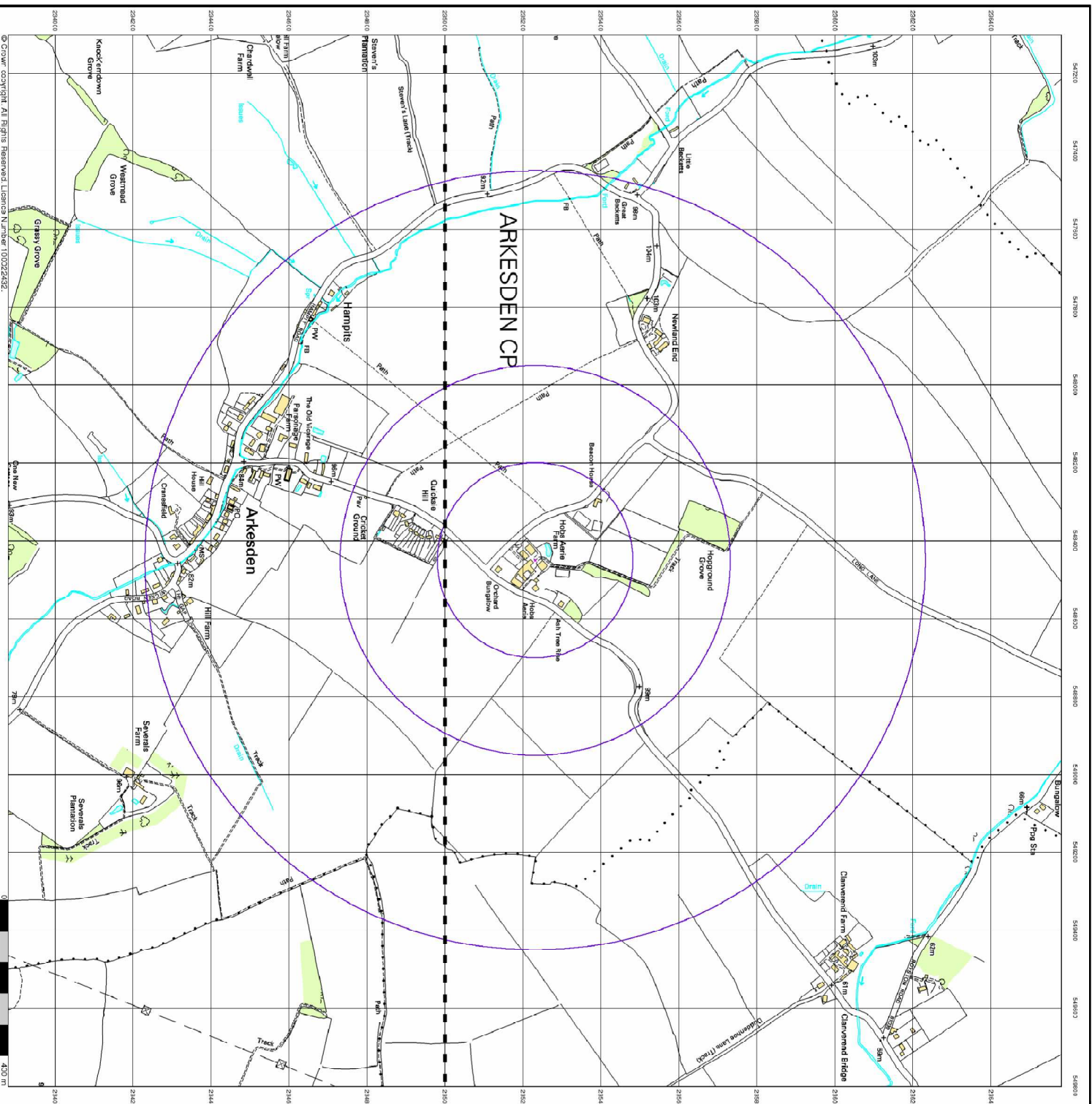

Street View

Published 2023

Source map scale - 1:10,000

Street View is a street-level map for the whole of Great Britain produced by the Ordnance Survey. These maps are provided at a nominal scale of 1:10,000

Map Name(s) and Date(s)

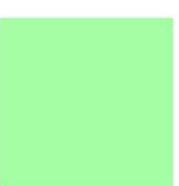

Street View Map - Slice A

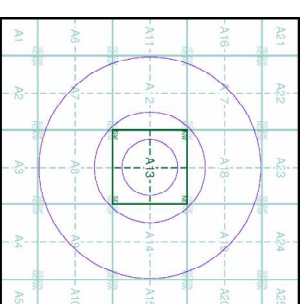

Order Details

Order Number: 317536487_1_1
 Customer Ref: 3404
 National Grid Reference: 548450, 235230

Site:
 Site Area (Ha): A
 Search Buffer (m): 1000

Site Details
 Mulberry House Farm, Wenden Road, Arkesden, SAFFRON
 WALDEN, CB11 4HD

Landmark
 INFORMATION GROUP

Tel: 0944 844 9952
 Fax: 0944 844 9951
 Web: www.envirocheck.co.uk

A Landmark Information Group Service v50.0 28-Sep-2023 Page 12 of 12

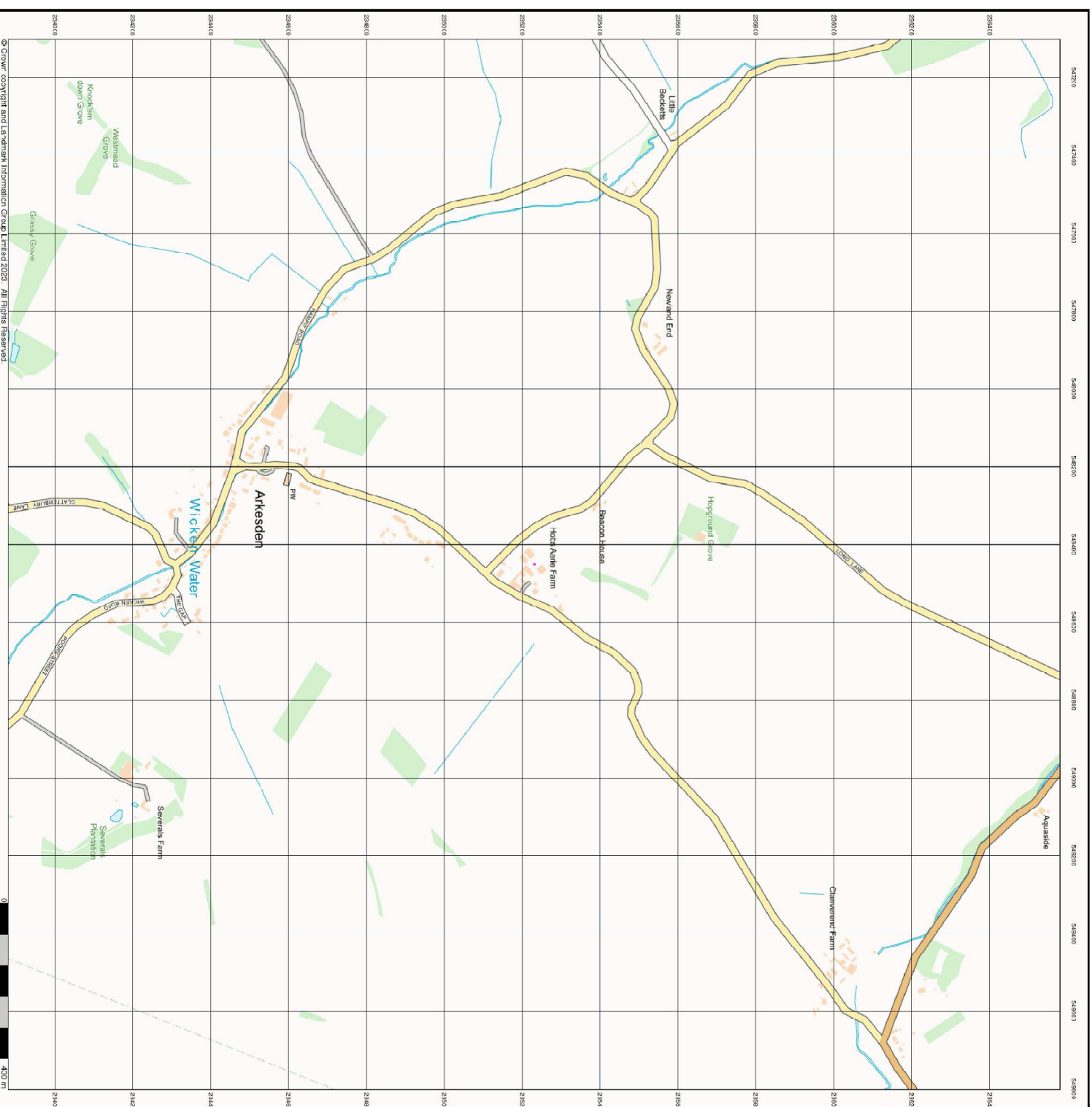

Historical Mapping Legends

Ordnance Survey County Series and Ordnance Survey Plan 1:2,500

Ordnance Survey Plan, Additional SIMs and Supply of Unpublished Survey Information 1:2,500 and 1:1,250

Large-Scale National Grid Data 1:2,500 and 1:1,250

Envirocheck

LANDMARK INFORMATION GROUP

Historical Mapping & Photography included:

Mapping Type	Scale	Date	Pg
Essex	1:2,500	1877	2
Essex	1:2,500	1897	3
Essex	1:2,500	1921	4
Ordnance Survey Plan	1:2,500	1979	5
Large-Scale National Grid Data	1:2,500	1993	6
Large-Scale National Grid Data	1:2,500	1993	7

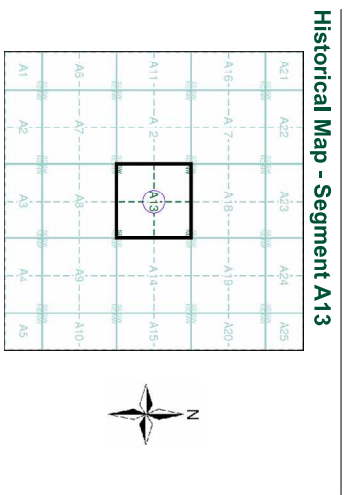

Order Details

Order Number: 317536487_1_1
 Customer Ref: 3404
 National Grid Reference: 548450, 235230
 Site: A
 Site Area (Ha): 0.01
 Search Buffer (m): 100

Site Details

Mulberry House Farm, Wenden Road, Atkesden, SAFFRON WALDEN, CB11 4HD

Landmark

LANDMARK INFORMATION GROUP

A Landmark Information Group Service v50.0 28-Sep-2023 Page 1 of 7

Tel: 0944 844 9952
 Fax: 0944 844 9951
 Web: www.envirocheck.co.uk

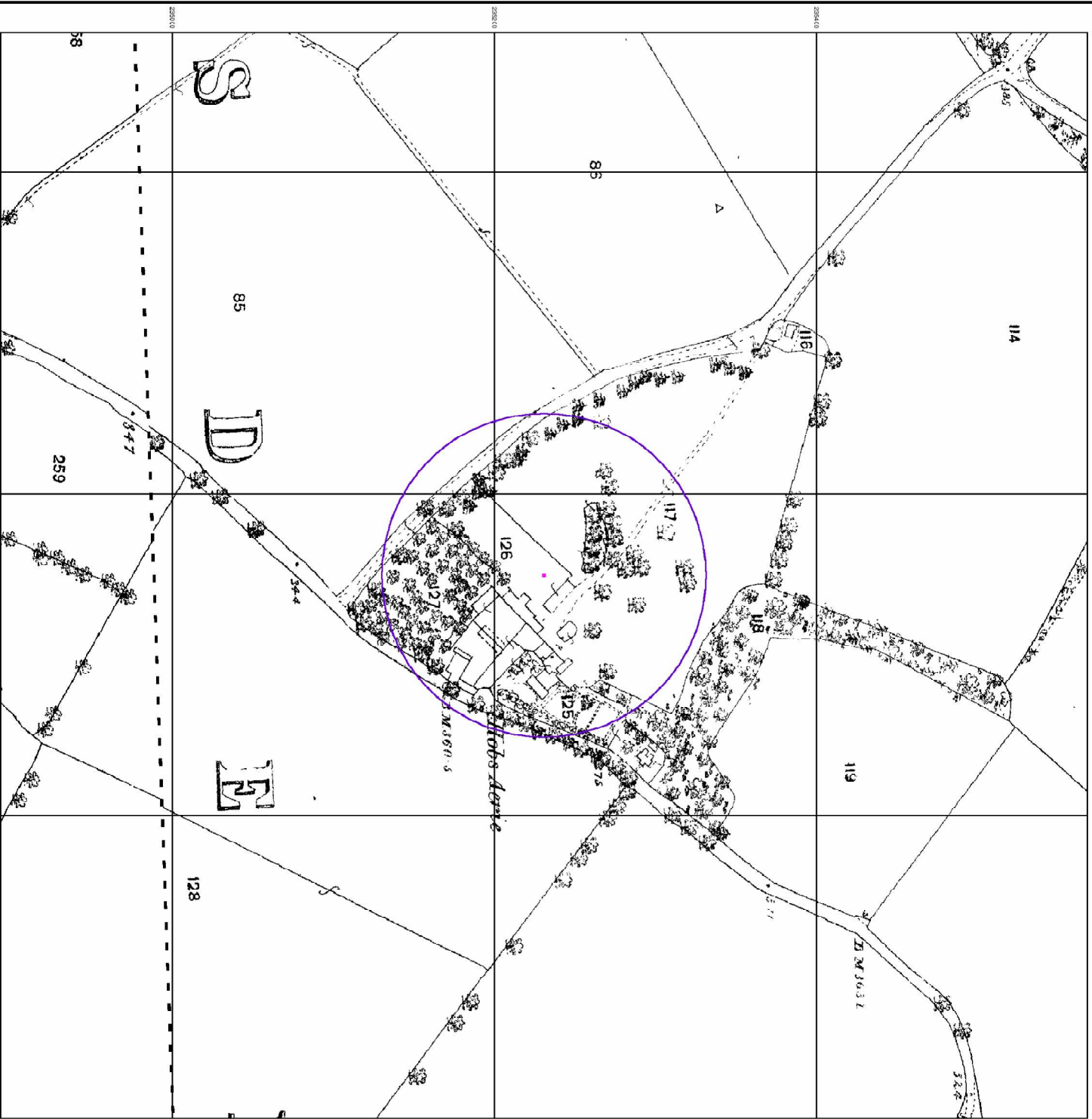

© Crown Copyright and Landmark Information Group Limited 2023. All Rights Reserved.

0 130 M

Envirocheck®

LANDMARK INFORMATION GROUP®

Essex

Published 1877

Source map scale - 1:2,500

The historical maps shown were reproduced from maps predominantly held at the scale adopted for England, Wales and Scotland in the 1840s. In 1854 the 1:2,500 scale was adopted for mapping urban areas and by 1895 it covered the whole of what were considered to be the cultivated parts of Great Britain. The published source map below is often some years later than the original. The published source map is a simple copy of a single county or group of counties, giving rise to significant inaccuracies in outlying areas.

Map Name(s) and Date(s)

009 - 11	1877
1008 - 15	1877
1077	1877
12500	1877

Historical Map - Segment A13

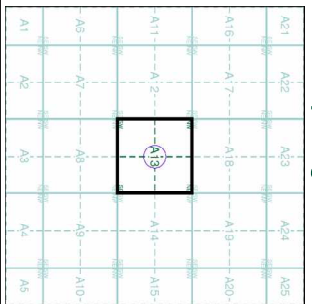

Order Details

Order Number: 317536487_1_1
 Customer Ref: 3404
 National Grid Reference: 548450, 235230
 Slice: A
 Site Area (Ha): 0.01
 Search Buffer (m): 100

Site Details

Mulberry House Farm, Wenden Road, Atkesden, SAFFRON WALDEN, CB11 4HD

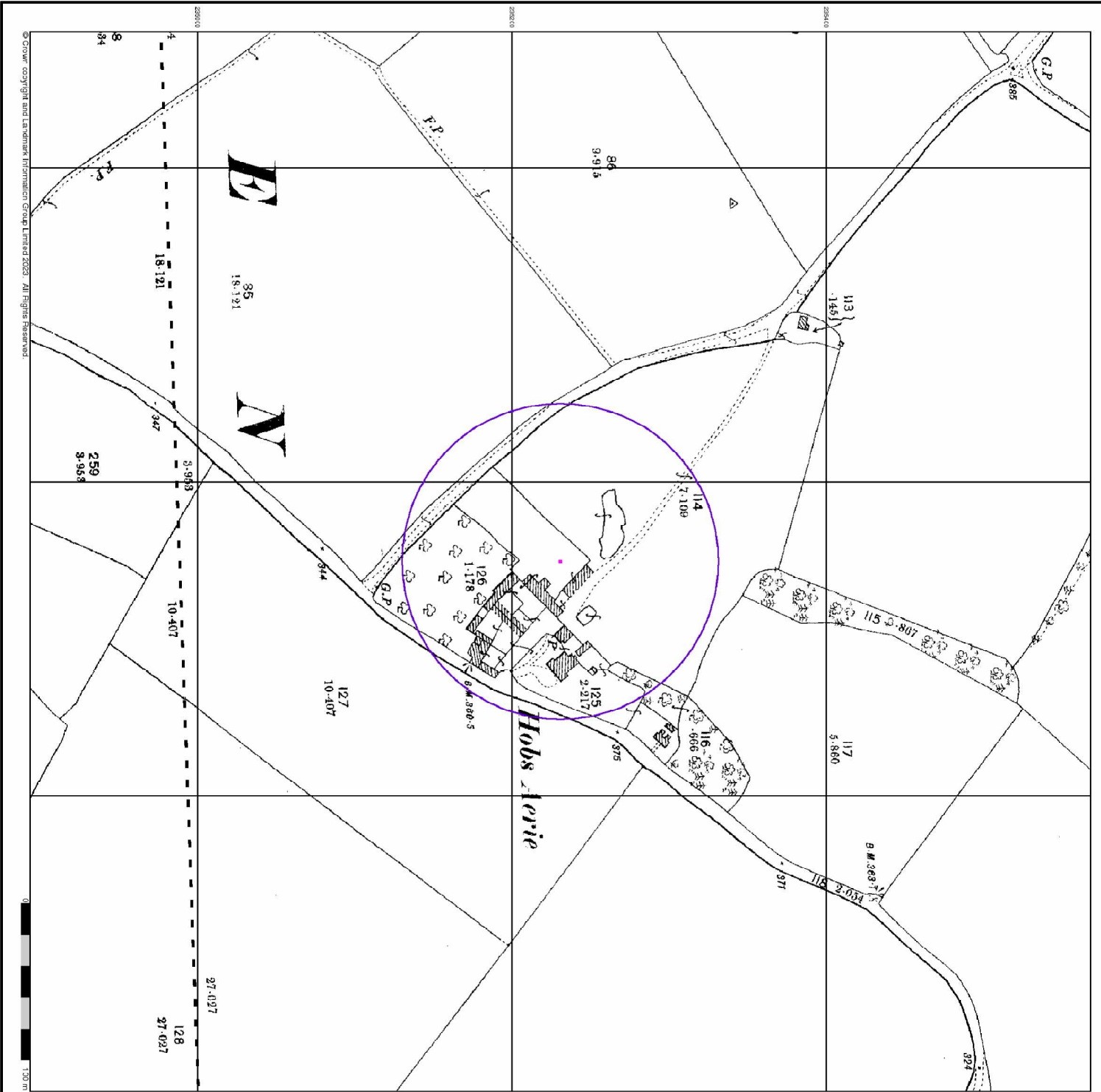

Envirocheck®

LANDMARK INFORMATION GROUP®

Essex

Published 1897

Source map scale - 1:2,500

The historical maps shown were reproduced from maps predominantly held at the scale adopted for England, Wales and Scotland in the 1840's. In 1854 the 1:2,500 scale was adopted for mapping urban areas and by 1897 it covered the whole of what were considered to be the cultivated parts of Great Britain. The post-1897 edition is often some years later than the original and has been independently surveyed of a single county or group of counties, giving rise to significant inaccuracies in outlying areas.

Map Name(s) and Date(s)

003 - 11	1997
1008 - 15	1997
1009 - 15	1997
1010 - 15	1997
1011 - 15	1997
1012 - 15	1997
1013 - 15	1997
1014 - 15	1997
1015 - 15	1997
1016 - 15	1997
1017 - 15	1997
1018 - 15	1997
1019 - 15	1997
1020 - 15	1997
1021 - 15	1997
1022 - 15	1997
1023 - 15	1997
1024 - 15	1997
1025 - 15	1997
1026 - 15	1997
1027 - 15	1997
1028 - 15	1997
1029 - 15	1997
1030 - 15	1997
1031 - 15	1997
1032 - 15	1997
1033 - 15	1997
1034 - 15	1997
1035 - 15	1997
1036 - 15	1997
1037 - 15	1997
1038 - 15	1997
1039 - 15	1997
1040 - 15	1997
1041 - 15	1997
1042 - 15	1997
1043 - 15	1997
1044 - 15	1997
1045 - 15	1997
1046 - 15	1997
1047 - 15	1997
1048 - 15	1997
1049 - 15	1997
1050 - 15	1997

Historical Map - Segment A13

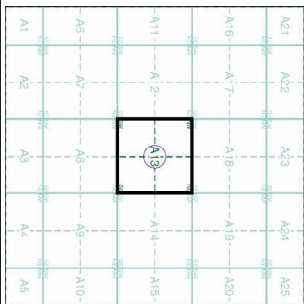

Order Details

Order Number: 317536487_1_1
 Customer Ref: 3404
 National Grid Reference: 548450, 235230
 Slice: A
 Site Area (Ha): 0.01
 Search Buffer (m): 100

Site Details
 Mulberry House Farm, Wenden Road, Arkessen, SAFFRON
 WALDEN, CB11 4HD