

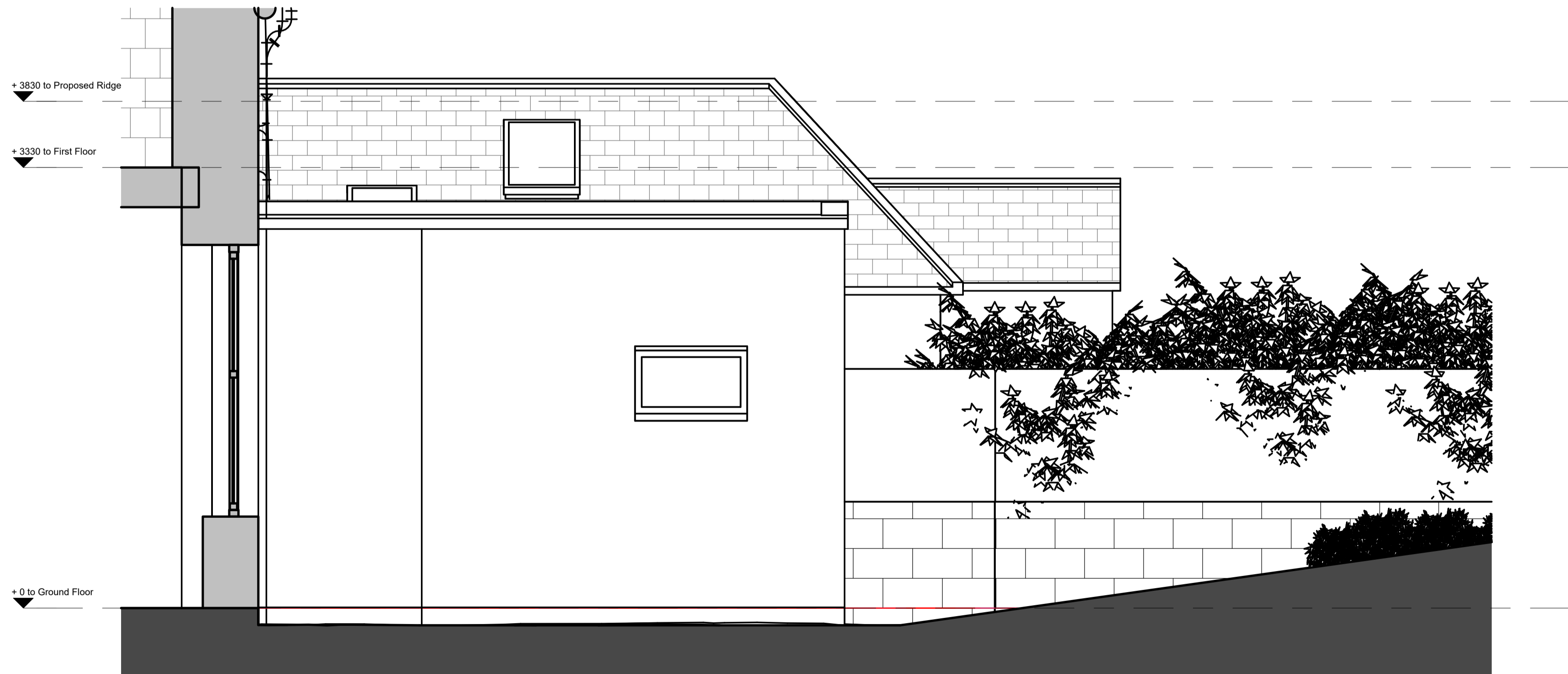

Existing Section 3

1 : 25



Existing Section 4

1 : 25

Rev	Description	By	Date
A	First Issue	AS	04.12.23



Client: Mr & Mrs Livingstone

Project: 81 Gray Street
Aberdeen, AB10 6JD

Title: Existing Sections 3 & 4

Sheet No: 4285_EX_05_002 **Date:** 28/11/23

Drawn by: AS **Checked by:** CT **Scale:** 1 : 25

tinto.co.uk
44 (0) 1224 821 670
File Name: 4285_TIN_ZZ_XX_M01_81GS_Planning

Millhouse
Grandholm Crescent
Bridge of Don
Aberdeen, AB22 8BB

Copyright of TINTO Architecture Ltd
Reg in Scotland No. SC283811
This drawing must not be used and
any reproduction must be brought
to the attention of TINTO immediately