

2. All sizes to be checked on site prior to construction.
3. This drawing is the copyright of the author.

Ordinance Survey © Crown Copyright. All rights reserved.
License Number 10020449.

Produced with the authority of Ordnance Survey pursuant to section 47 of the Copyrights, Designs and Patents Act 1988. Unless that act provides a relevant exception to copyright, the copy must not be copied without the prior permission of the copyright owner. This copy has no evidential status.



Key
Application Boundary

Armco vehicle impact barrier to front of retaining wall. installed in accordance with manufactures details. Engineer to review with regards to type ie. bolt down or cast in type.

RETAINING WALL to be designed by structural engineer and included as part of the foundation design for the building.

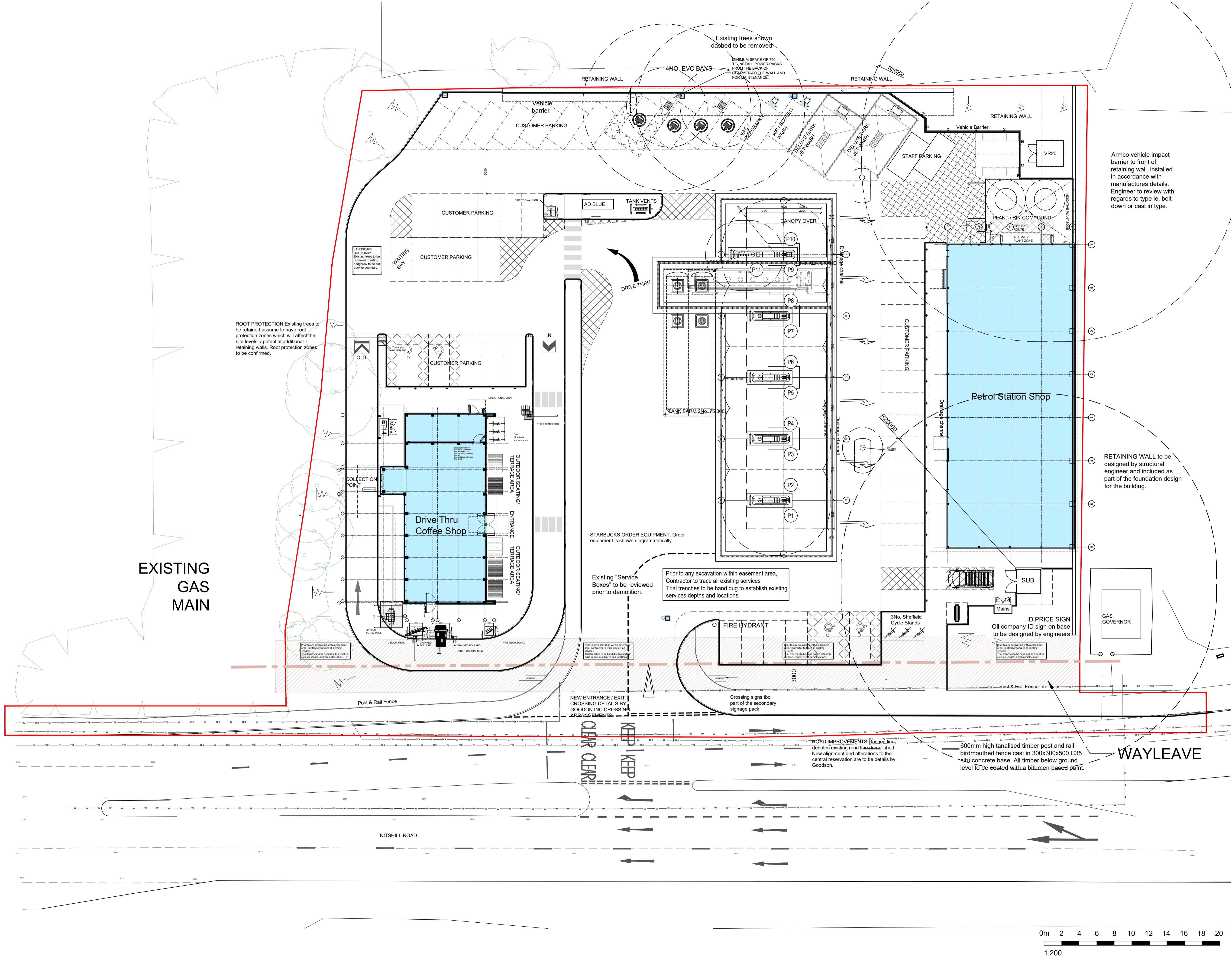

G	04.11.2023	Scale bar added	AGe
F	20.04.2023	EV charging bays updated.	AGe
E	04.12.2022	WARRANT ISSUE	KL
D	09.09.2022	Tracking added to the site plan. Kerb line updated at entrance.	KL
C	27.04.2022	SBX ET14 location updated.	KL
B	24.05.2022	CONSTRUCTION ISSUE	KL
A	11.04.2022	TENDER ISSUE	KL
1	19.11.2021	WARRANT ISSUE	AGe

smith design associates
Glasgow Leatherhead Dumfries
14 Lynedoch Crescent, Glasgow G3 6EQ
glasgow@smithdesign.co.uk
0141 353 3501
www.smithdesign.co.uk

client	Euro Garages	project	Proposed Development Nitshill Road, Glasgow
drawing	Proposed Site Plan	original size	A1
scale	1:200	drawn	AGe
date	15.11.2021	checked	
status	INFORMATION	passed	
job no.	G2967	drawing no.	AL(0)003
		revision	G

