

Notes:  
 This drawing & any design thereon is the copyright of ar2 architects limited and must not be reproduced without their written consent.  
 ar2 architects limited is registered in England and Wales with the Registration number 05825486. The Registered Office is Unit 17, Brough Business Centre, Sillings Lane, Brough, East Yorkshire. HU15 1EN.  
 Drawings  
 Contractors must verify all dimensions on site before commencing any work or stop drawings. This drawing is not to be scaled. Use figured dimensions only.  
 Subject to statutory approvals and survey.  
 Areas  
 Building areas are liable to adjustment over the course of the design process due to the ongoing construction detailing developments.  
 Risk Assessment  
 In accordance with CDM Regulation 7, 11 & 15, significant hazards have been identified and are annotated thus:  
 Refer to the current Designers Risk Information Schedule for further details.

Site Area: 853.30m<sup>2</sup>  
 0.211 Acres

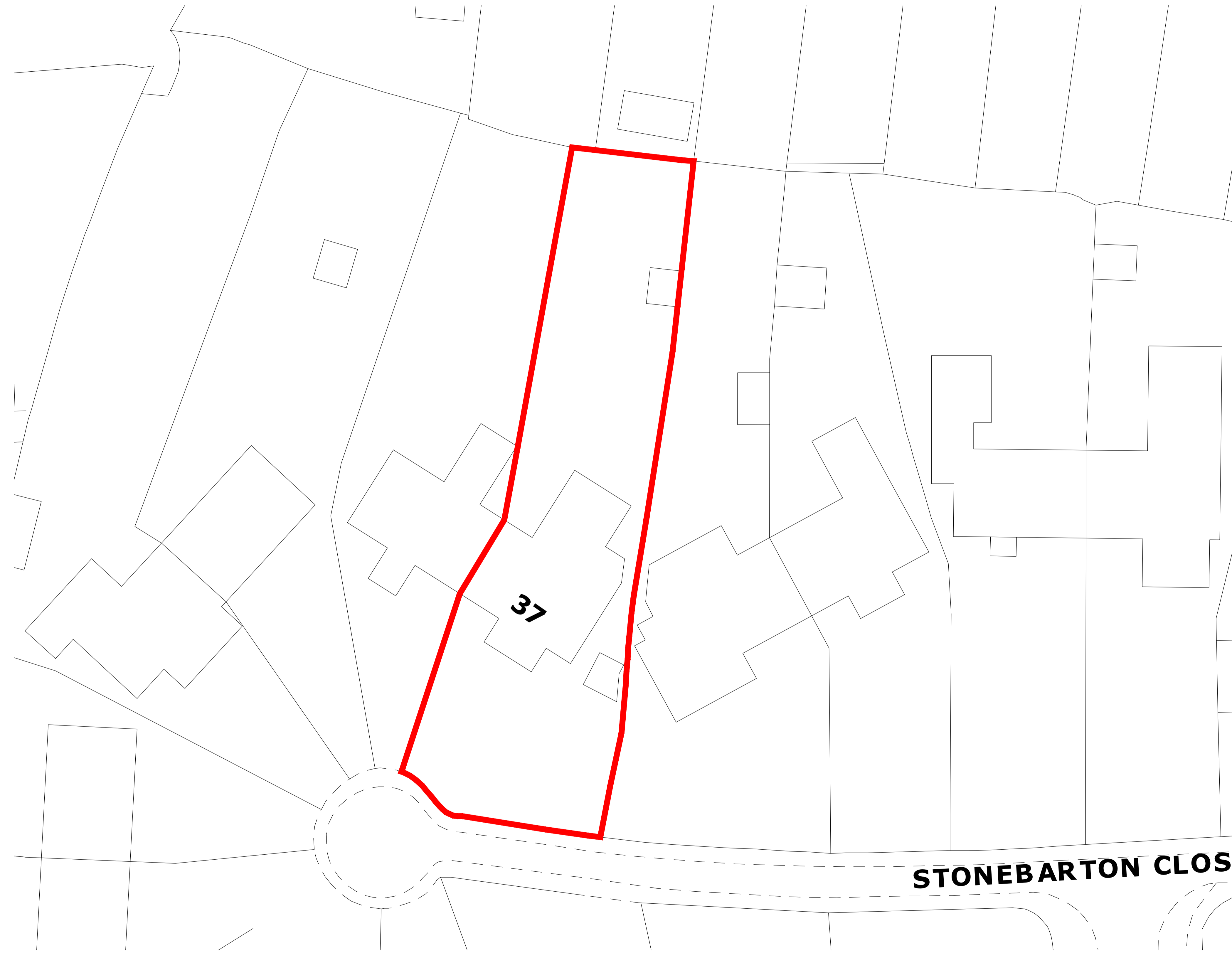

**NOTE:**  
 THIS DRAWING IS ONLY INDICATIVE & IS BASED ON DRAWINGS PROVIDED BY OTHERS.  
 ALL DIMENSIONS TO CHECKED AND MEASURED ON SITE

revisions

PLANNING

ar<sup>2</sup> architects ltd

Unit 17, Brough Business Centre, Brough, East Yorkshire, HU15 1EN  
 T: 01482 66.90.80 E: enquiries@ar2architects.co.uk

Project: STONE BARTON CLOSE Job Number: AR482-23  
 PLYMOUTH PL7 4LN

Client: THE CAMBIAN GROUP

Drawing Title: PROPOSED SITE BLOCK PLAN Drawing Size A1

Drawn LC	Date 22.11.2023	Scale 1:200	Co-file -
Reviewed by RRB	Drawing No. (100)-01	Rev. P1	

PROPOSED SITE BLOCK PLAN  
 Scale - 1:200 @ A1 - Licence Ref: 100057546



STONE BARTON CLOSE  
 PLANNING SUBMISSION

