

SCALE 1:100

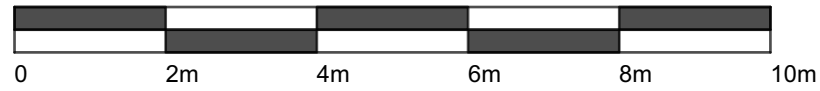

DRAWINGS ARE TO DISCUSS CONCEPT LAYOUT IDEAS ONLY. NOT TO BE USED FOR ANY OTHER PURPOSE INCLUDING PRICING, CONSTRUCTION. MEASUREMENTS MAY NOT BE ACCURATE. DESIGNS TO BE DEVELOPED TO COMPLY WITH BUILDING REGULATIONS.

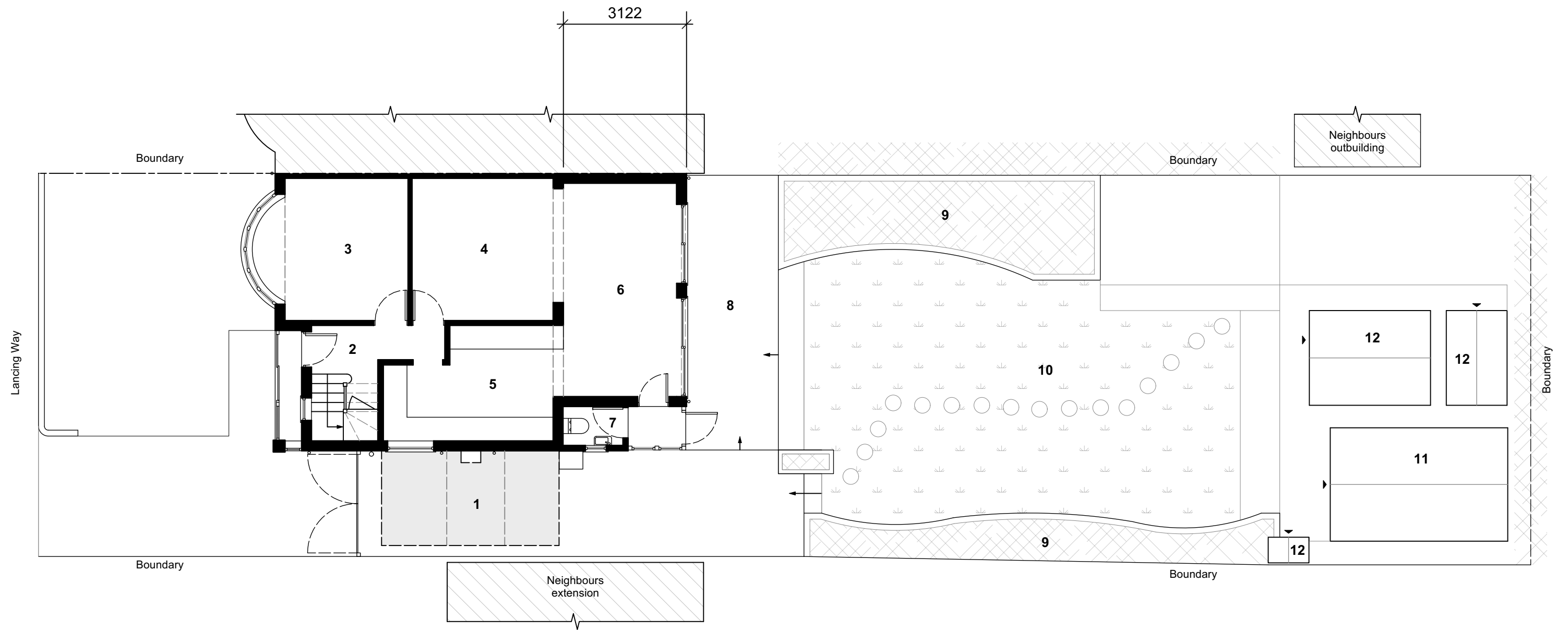

NOTES

- 1. Carport + side access
- 2. Entry
- 3. Lounge
- 4. Sitting room
- 5. Kitchen
- 6. Dining
- 7. WC
- 8. Raised patio
- 9. Vegetation
- 10. Grass lawn
- 11. Garage
- 12. Outbuilding

■ Existing walls

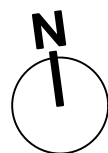

**LIVE SITE {STUDIO}**

Live Site Ltd trading as Live Site (studio)

Contact : architect@livesitestudio.co.uk

Drawing no.

**LSS341-EX001**

<b>Drawing title</b>	Existing Ground Floor Plan
<b>Drawing status</b>	Planning
<b>Size</b>	1:100 @ A3
<b>Date</b>	November 2023
<b>Client</b>	Mr and Mrs McMillan-Jackson
<b>Project</b>	Replacement rear extension, replacement car port + rear patio.
<b>Address</b>	3 Lancing Way, Coxley Green, WD3 3LW