

SCHEDULE OF ACCOMMODATION – EXISTING – GROSS INTERNAL AREA (GIA)

- COMMERCIAL SHOP UNIT – GROUND FLOOR – GIA 64.6sqm
- COMMERCIAL STORAGE FOR SHOP UNIT – GROUND FLOOR – GIA 39.7sqm
- EXTERNAL WC (SHOP) – GROUND FLOOR – GIA 1.5sqm
- COMMERCIAL SHOP UNIT / STORAGE – GROUND FLOOR TOTAL – GIA 105.8sqm
- EXTERNAL COVERED STORAGE AREA (SHOP) – GROUND FLOOR TOTAL – 41.5sqm
- FLAT (2 BED) – GROUND FLOOR – GIA 11.5sqm
- FLAT (2 BED) – GROUND FLOOR EXTERNAL UTILITY – GIA 2.1sqm
- FLAT (2 BED) – FIRST FLOOR – GIA 49sqm
- FLAT (2 BED) – FLAT GROUND/FIRST FLOOR TOTAL – GIA 62.6sqm

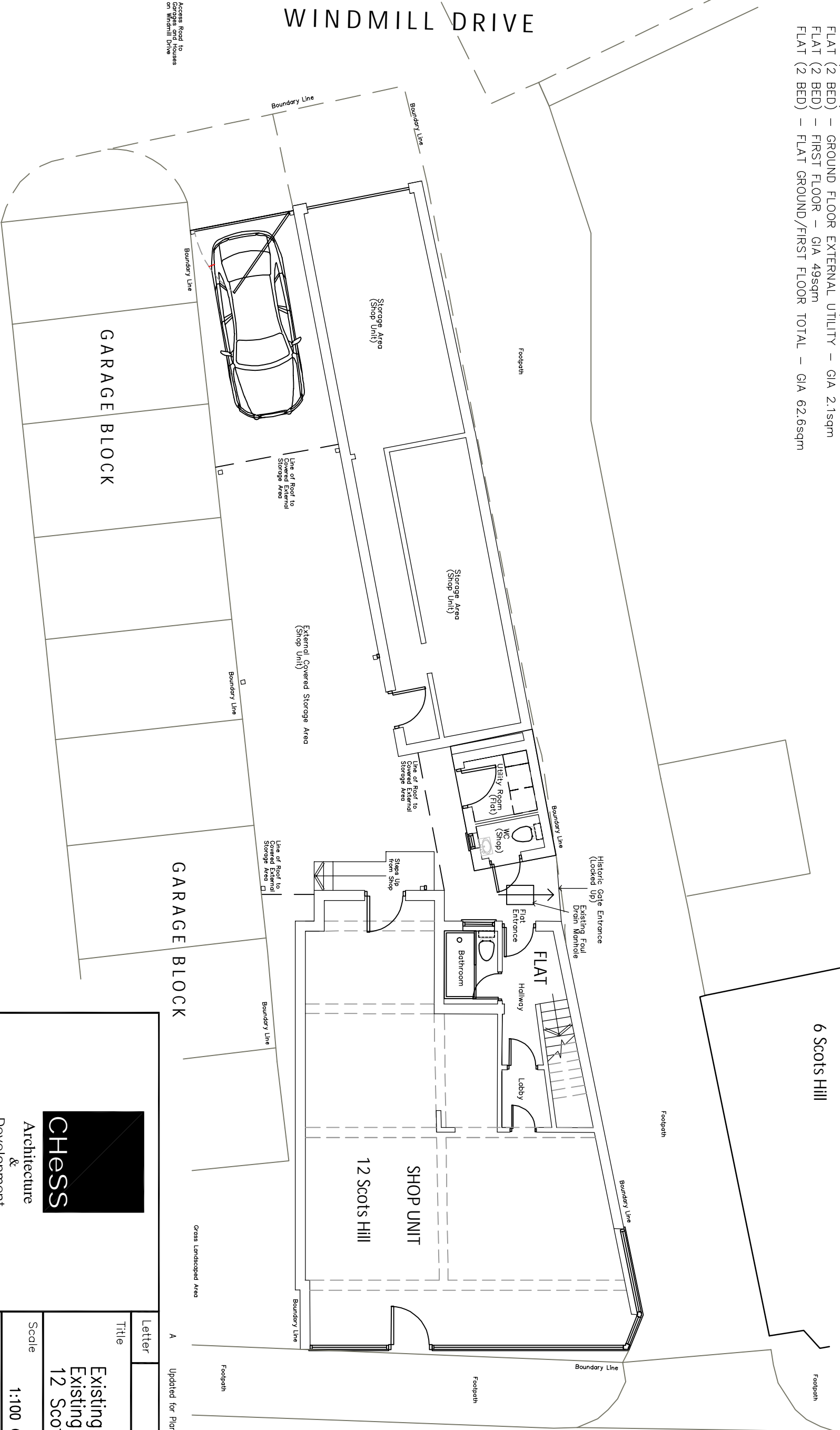

Access Road to  
Plot 11 on  
Windmill Drive

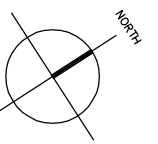

Client  
**Mr. K. VAIRAVANATHAN**  
12 Scots Hill  
Croley Green  
Hertfordshire  
WD3 3AD

DO NOT SCALE THIS DRAWING. USE FIGURED DIMENSIONS ONLY  
CONTRACTORS ARE RESPONSIBLE FOR TAKING AND CHECKING SITE DIMENSIONS  
DESIGN COPYRIGHT IS VESTED IN THE ARCHITECT FROM WHOM  
CONSENT MUST BE OBTAINED FOR COPYING OR REPRODUCING THIS DRAWING

**NOTES AND SCHEDULES**

This drawing has been reproduced from the drawing prepared by ES Architecture Limited ES Architecture drawing no. 21/065\_S1

A Updated for Planning Application. 25/09/23

**CHES**  
Architecture  
&  
Development  
L i m i t e d

PIA House 4 Norfolk Court Norfolk Road  
Rickmansworth Hertfordshire WD3 1LA  
T. 01923 718565 F. 01923 712255  
E. info@chessad.com W. www.chessad.com

Letter	Revisions	Date
A	Updated for Planning Application.	25/09/23
Title		
Existing Site Plan Existing Ground Floor Plan 12 Scots Hill WD3 3AD		
Scale	1:100 @ A3	Date Aug '23
Drawn	MM	Checked
CAD FILE:-- m:\2316-101.dwg		
Job No.	2316	
Sheet No.	101 - A	