

This drawing is the copyright & intellectual property of William Grant & Sons Distillers Limited.
 No part thereof may be copied or reproduced in any format, without the express written permission of an authorised William Grant & Sons representative.
 Do not scale from this drawing, if in doubt about any information on this drawing ASK.



Please think of the environment and only post this drawing if absolutely necessary.

DRAWING NO: SITE PLAN AS PROPOSED

DRAWING NO: ARE-SI-L(-)-0012

REVISION: B

rev	date	by	description
A	16.10.17	CT	FIRST ISSUE
B	15.11.17	CT	PLAN UPDATED TO SHOW AS PROPOSED SITE AREA IN M2, ACRES AND HECTARES / AS PROPOSED PLAN UPDATED AFTER DETAILED DESIGN RECEIVED FROM ALLEN ASSOCIATES

project:	ARETE PROPOSED TANK FARM		
drawing:	PLANNING APPLICATION SITE PLAN AS PROPOSED		
drawing no:	ARE-SI-L(-)-0012		
revision:	B		
scale:	1:250	sheet:	A1
status:	PRE PLANNING		
drawn by:	CT	date:	16.10.17
approved by:	PL	date:	16.10.17

WILLIAM GRANT & SONS
 INDEPENDENT FAMILY DISTILLERS SINCE 1887

William Grant & Sons Distillers Limited
 Customer Service Centre
 Phoenix Crescent
 Strathclyde Business Park
 Bellshill,
 ML4 3AN
 Scotland

Tel: +44 1698 843643

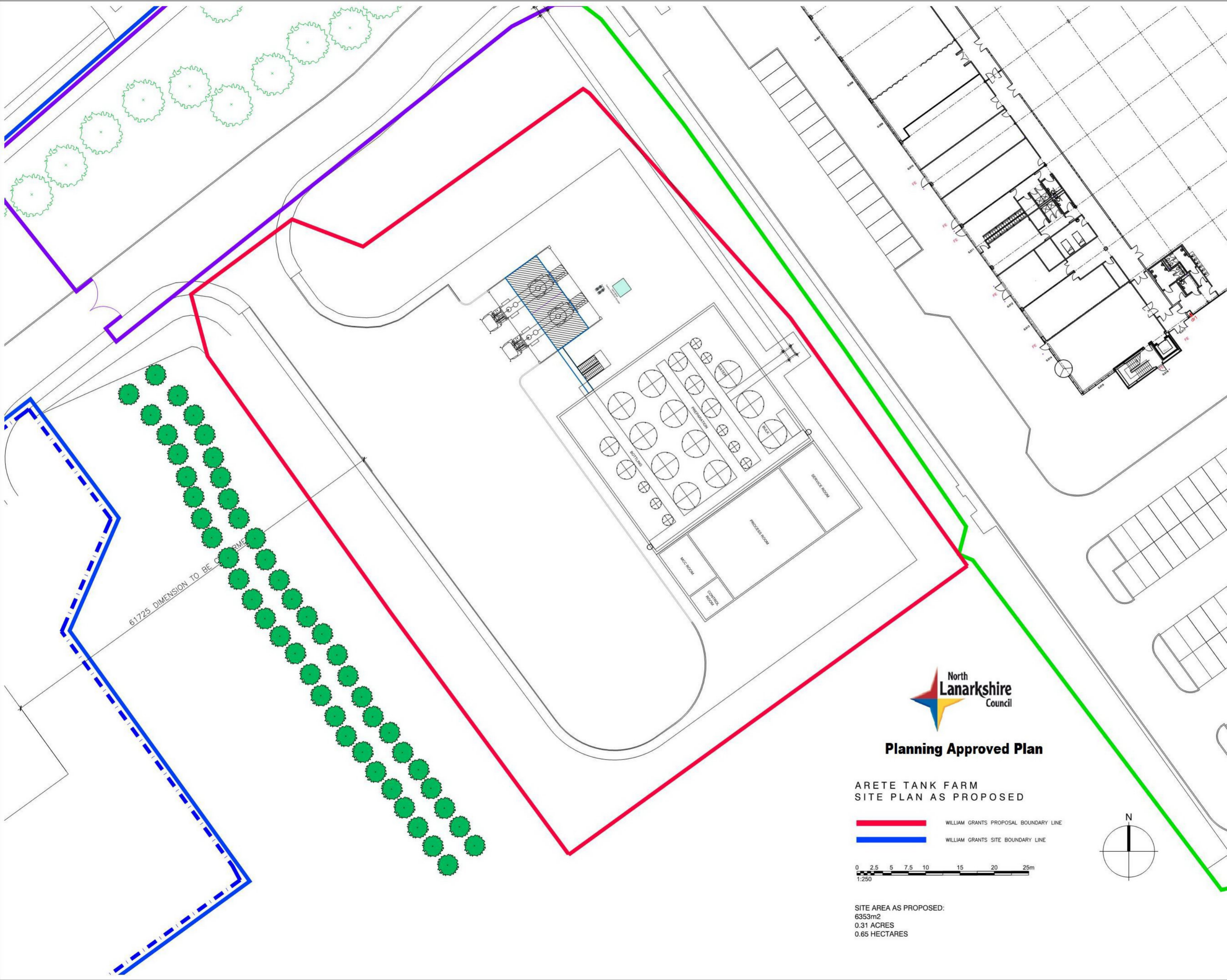

Planning Approved Plan

**ARETE TANK FARM
 SITE PLAN AS PROPOSED**

- WILLIAM GRANTS PROPOSAL BOUNDARY LINE
- WILLIAM GRANTS SITE BOUNDARY LINE



SITE AREA AS PROPOSED:
 6353m²
 0.31 ACRES
 0.65 HECTARES

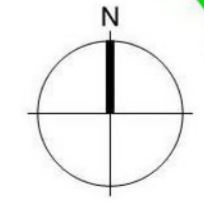

61725 DIMENSION TO BE CONFIRMED