

Rev. Date Description

A	18.10.22	Carwash & jet wash relocated to the center of the site. Jet wash nudged against car wash. Acoustic screening added to the edges of the site, adjacent to the car wash and parallel to the site boundary. Yard and AdBlue tank area surface changed to concrete.
B	23.01.23	Updated to match latest proposed site plan.
C	09.05.23	Updated to match latest proposed site plan (drive thru lane).
D	01.06.23	Updated to match latest proposed site plan (yard area orientation)
E	18.10.23	Pedestrian path and close board fence added

LEGEND

1	CANOPY forecourt Area = 198.11m <sup>2</sup>	10	BLOCK PAVING Area = 37.48m <sup>2</sup>
2	ROOF shop Area = 235.22m <sup>2</sup>	11	BLOCK PAVING Area = 93.94m <sup>2</sup>
3	ROOF car wash Area = 57.60m <sup>2</sup>	12	BLOCK PAVING Area = 43.32m <sup>2</sup>
4	ROOF jet wash Area = 88.80m <sup>2</sup>	19	BLOCK PAVING Area = 17.00m <sup>2</sup>
22	ROOF plant room Area = 10.80m <sup>2</sup>	13	BLOCK PAVING Area = 774.22m <sup>2</sup>
5	CONCRETE forecourt Area = 325.91m <sup>2</sup>	17	TARMAC Area = 134.20m <sup>2</sup>
6	CONCRETE car wash ends Area = 24.86m <sup>2</sup>	18	TARMAC Area = 63.96m <sup>2</sup>
7	CONCRETE jet wash Area = 9.75m <sup>2</sup>	25	TARMAC Area = 29.70m <sup>2</sup>
8	CONCRETE yard area Area = 32.70m <sup>2</sup>	14	GRASS Area = 66.33m <sup>2</sup>
9	CONCRETE store ramp Area = 6.72m <sup>2</sup>	20	GRASS Area = 6.20m <sup>2</sup>
24	BLOCK PAVING pedestrian path Area = 175.70m <sup>2</sup>	23	EXISTING TREES AREA Area = 419.00m <sup>2</sup>

TOTAL EXPOSED SURFACE AREAS

CANOPIES / ROOFS Area = 590m <sup>2</sup>	GREEN AREA Area = 492m <sup>2</sup>
CONCRETE Area = 400m <sup>2</sup>	TARMAC Area = 228m <sup>2</sup>
BLOCK PAVING Area = 1141m <sup>2</sup>	
DEVELOPMENT SITE Area = 2900m <sup>2</sup>	TOTAL PROPOSED PERMEABLE GROUND (GREEN AREAS & BLOCK PAVING) Area = 1633m <sup>2</sup>
	TOTAL PROPOSED IMPERMEABLE GROUND Area = 628m <sup>2</sup>



Castlecroft Business Centre Tom Johnston Road  
Dundee DD4 8XD  
T: 01382 774111 F: 01382 739382  
mail@amcaarchitect.co.uk

Job  
Garvock Filling Station  
86 Halbeath Road  
Dunfermline  
KY12 7RS

Drawing  
Proposed Surfacing Areas

Date  
Sept 2023

Scale  
1:250 @ A3

Job No  
3891

Drwg No  
PL\_030

Rev  
E

CAD Ref: 3891\_PL\_030\_B\_PROPOSED SURFACING AREAS.dwg

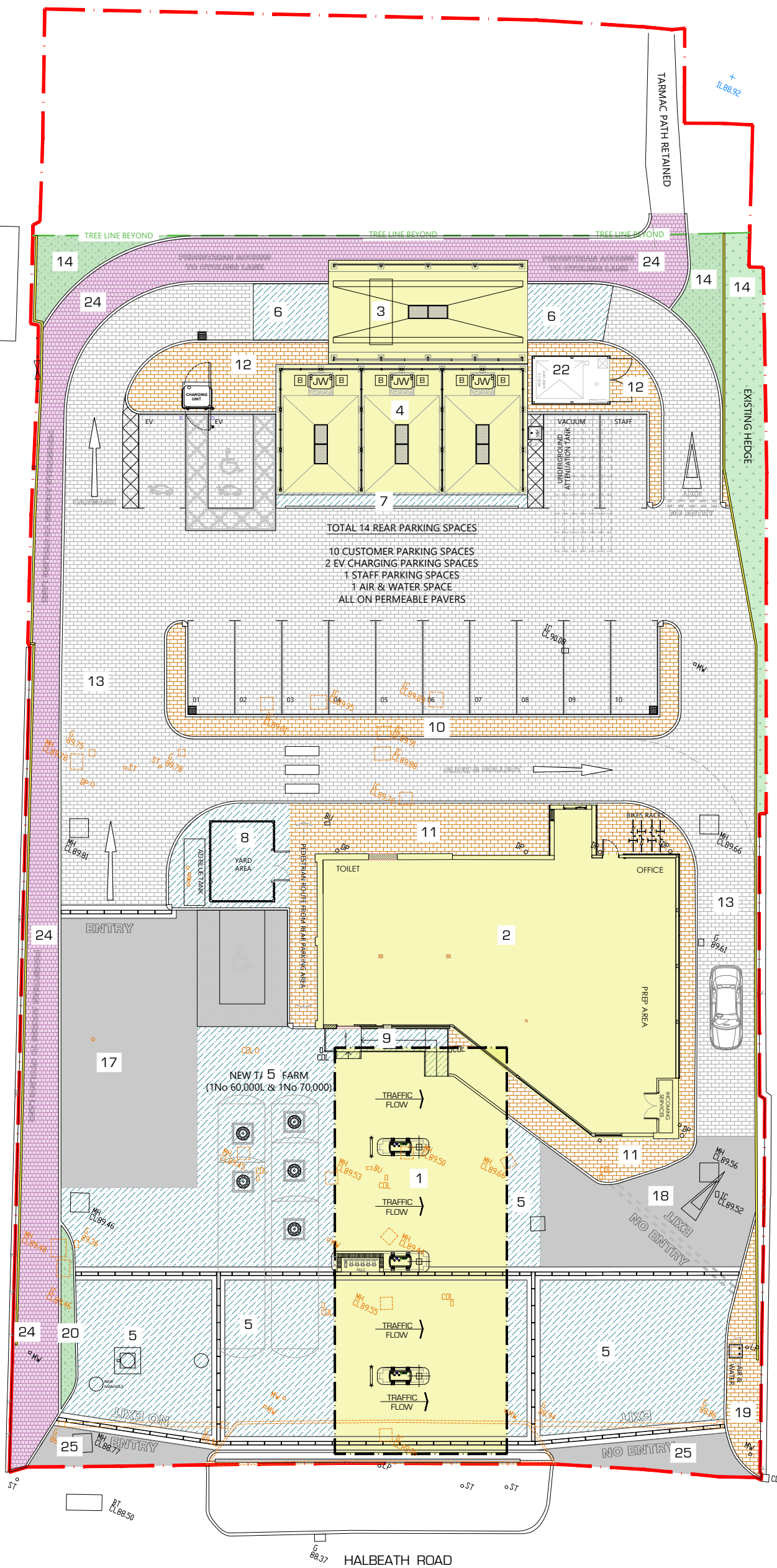

PROPOSED SURFACING AREAS 1:250 @ A3

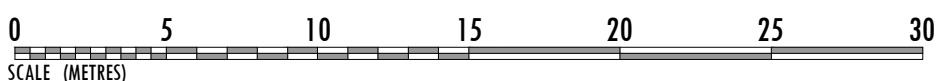

--- SITE BOUNDARY