

Do Not Scale Dimensions From Drawing

Rev.	Date	Description
A	02.06.23	Added OS to show context around site
B	18.10.23	Pedestrian path and new close board fence added.

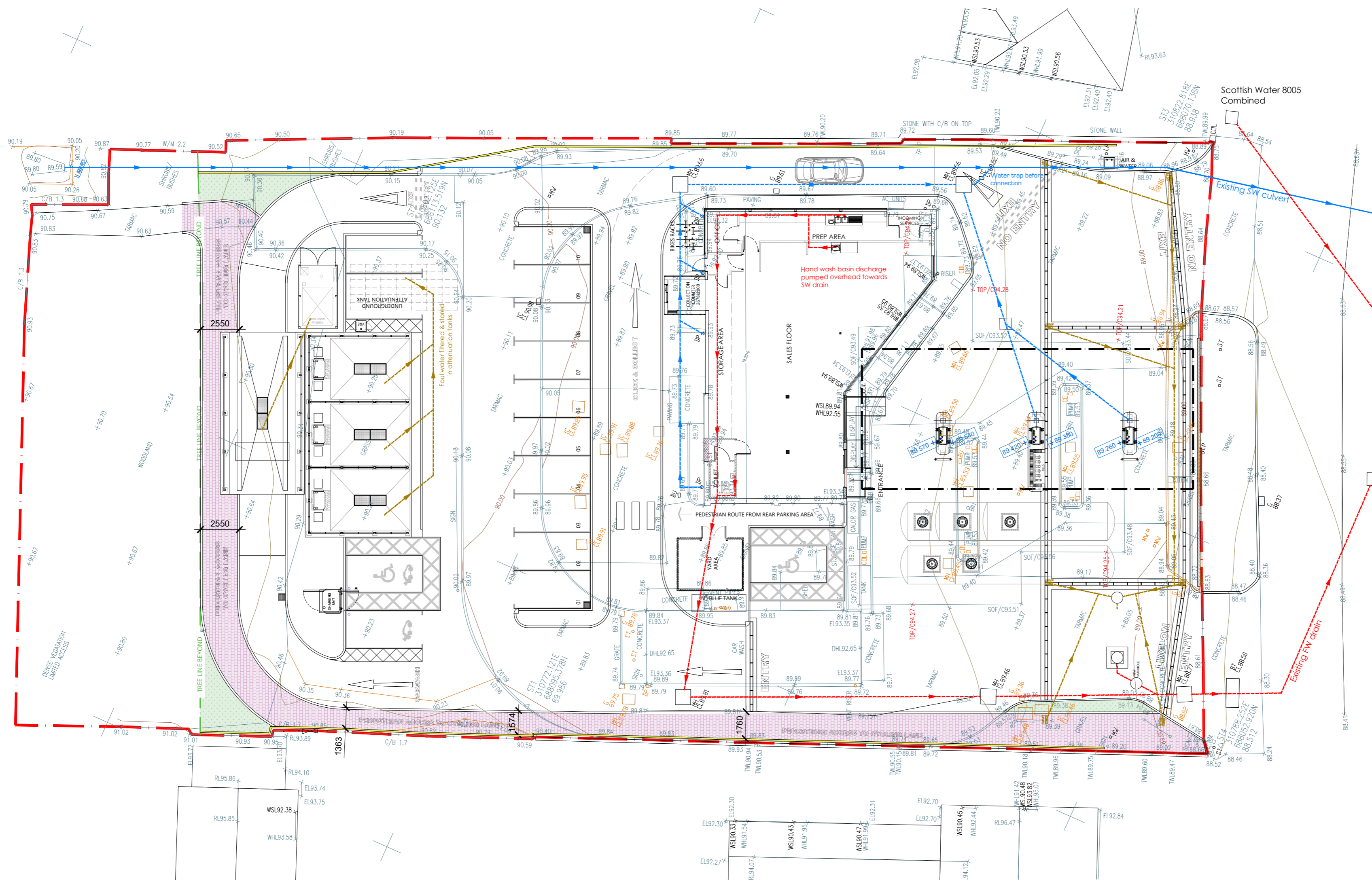
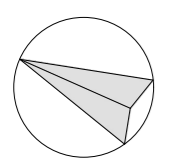

Unknown Asset
MH Chamber for Culvert
leading to asset 8901 through to 8902
through to open wet stream
(traced via tracing die)

LEGEND

- SITE BOUNDARY
- SURFACE WATER CULVERT
- SURFACE WATER (150VC)
- CATCHMENT SURFACE WATER (150VC)
- FOUL/WASTE WATER (150VC)
- XX.XXX PROPOSED LEVELS

AMCA ARCHITECTS
 Castlecroft Business Centre Tom Johnston Road
 Dundee DD4 8XD
 T: 01382 774111 F: 01382 739382
 mail@amcaarchitect.co.uk

Job
Garvock Filling Station

86 Halbeath Road
Dunfermline KY12 7RS

Drawing
Proposed Drainage

Proposed Drainage
1:200@A2

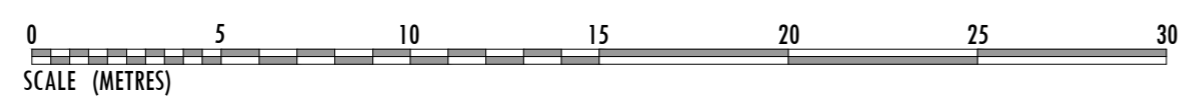

EXISTING DRAINAGE TO BE REDONE TO ACCOMMODATE LARGER PIPE DIAMETER

FORECOURT INTERCEPTOR INLET/OUTLET DIAMETER = 100mm PVCu

Date	Scale	
01 Nov 2023	1:200 @ A2	
Job No	Drwg No	Rev
3891	PL_014	B
CAD Ref: 3891_PL_014_PROPOSED DRAINAGE.dwg		