

NOTES:-

THIS DRAWING HAS BEEN PRODUCED SOLELY FOR THE PURPOSE OF SUBMISSION OF A PLANNING APPLICATION. IT SHOULD NOT BE CONSTRUED AS BEING A CONSTRUCTION DRAWING.

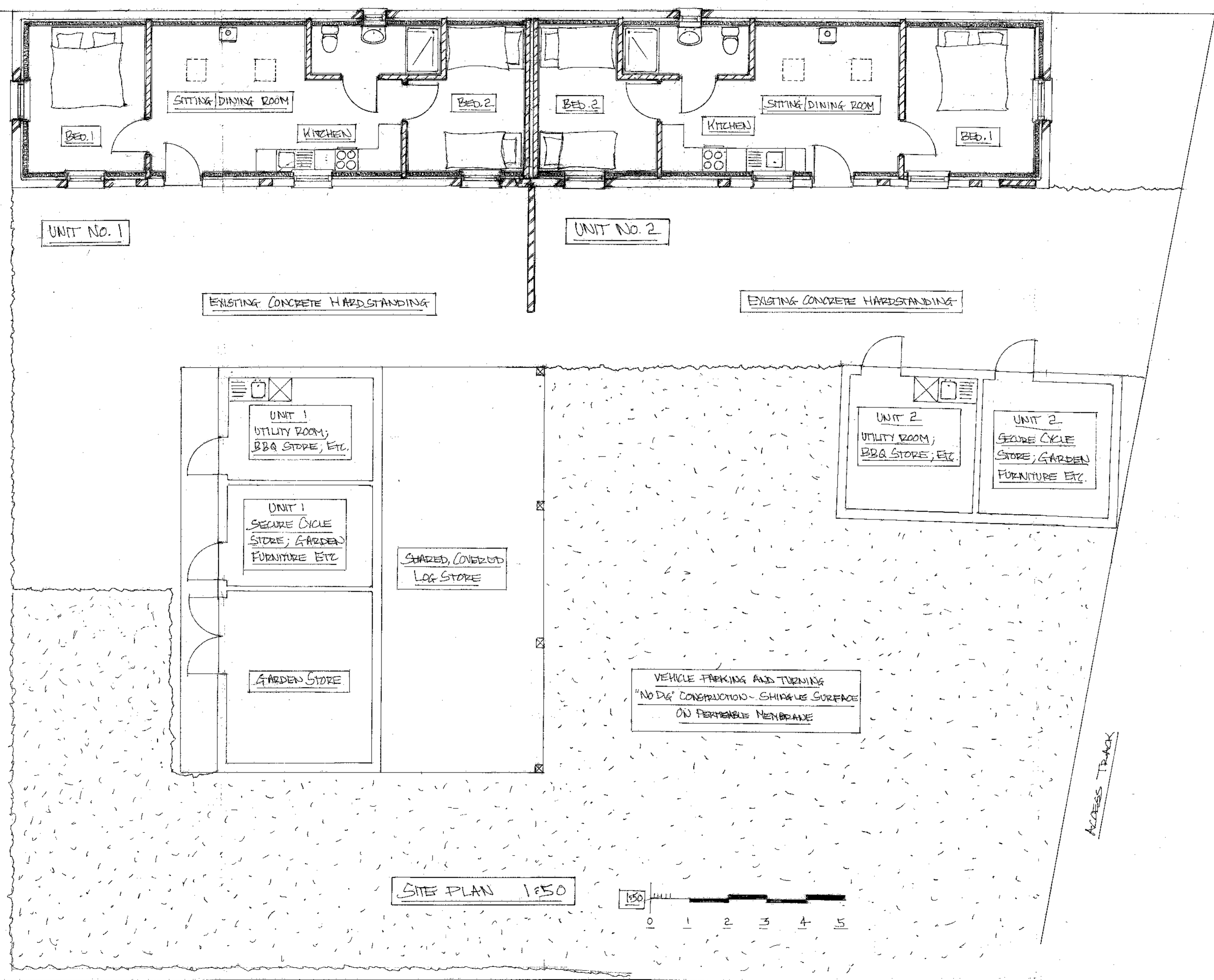

PROPOSED CHANGE OF USE OF EXISTING STABLES COMPLEX TO FORM 2 NO. HOLIDAY LETS AT "OLD VICARAGE", ELY ROAD, MILGAY, NORFOLK, PE38 0JN

DRN: JOHN STEPHENSON  
01366 203715

REVISIONS:-

SCALES:- 1:50  
DATE:- NOV. 2023  
DRG. NO:- 1737.1