

Site Location Plan (Road Identification) | NTS

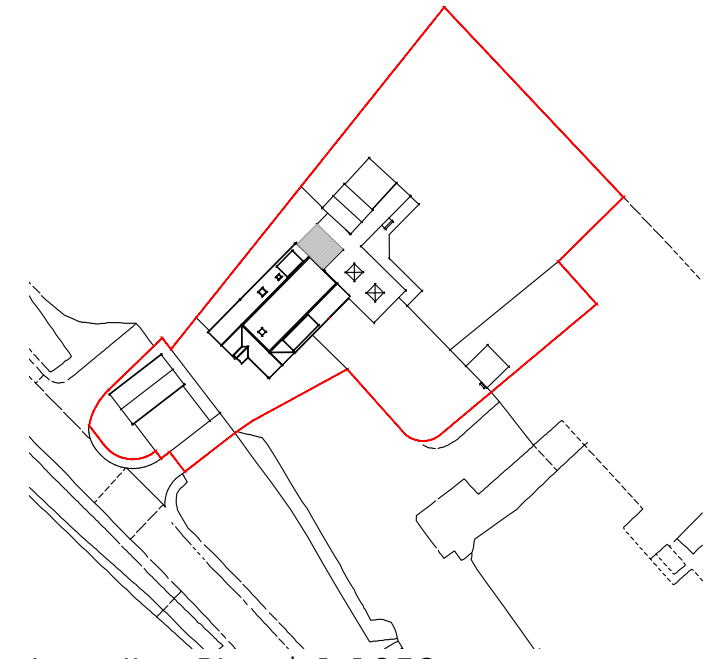

Location Plan | 1:1250

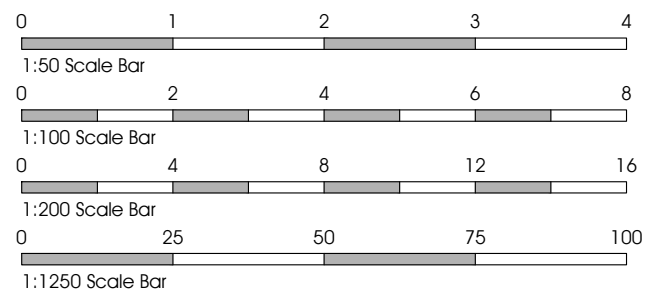
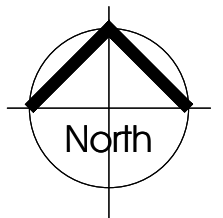

Rev | A | Updated for Planning  
Revision: Description:

07/12/2023  
Date:

*Scott Francis Allan*  
Architectural Design

36 Wallace Avenue | Wallyford | East Lothian | EH21 8BZ  
Mobile: 07790 846 990 | Email: scott@ego3d.co.uk  
Facebook.com/scottfrancisallan

### Planning and Building Warrant

Project:  
**Proposed Change in Garage Roof with Dormers providing Ancillary Accommodation Sweethope, North Lodge, Whitecraig, Musselburgh, EH21 8PT**

Client:  
**David and Marie Deery**

Drawing:  
**Location Plan**

Drawing No. <b>2023-13-000A</b>	Scale: <b>As Noted</b>	Date: <b>Nov 2023</b>	Name: <b>SFAllan</b>	Sheet Size: <b>A3</b>
------------------------------------	---------------------------	--------------------------	-------------------------	--------------------------