

NOTES:- RESPONSIBILITY IS NOT ACCEPTED FOR ERRORS MADE BY OTHERS IN SCALING FROM THIS DRAWING. ALL CONSTRUCTION INFORMATION SHOULD BE TAKEN FROM FIGURED DIMENSIONS ONLY. ALL DIMENSIONS ARE IN MILLIMETERS

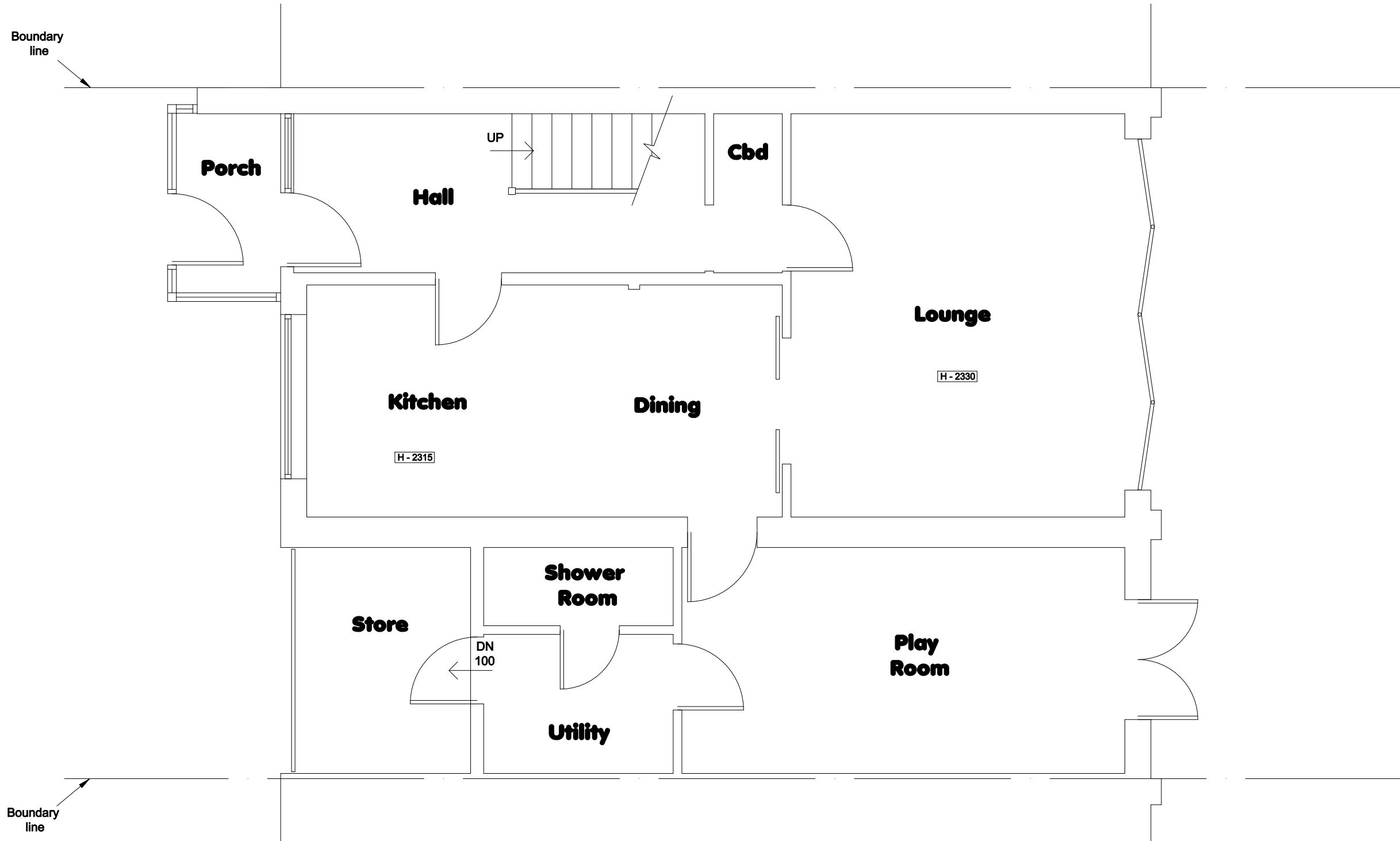

Clifton Design (Bristol) 17 Lower Redland Road Redland Bristol BS6 6TB 0117 973 6000	Rev:	Description of Changes:	Drawn:	Date:	Client:	Postcode:	Drawing Title:			
	-	-	-	-	Mr I Pritchard	BS9 3LR	Ground Floor Plan - Existing			
	1:50 @ A3					Address:	Date:	Drawing No: 5/WC/WOT/01/P		
					5 Westover Close, Westbury on Trym	Nov 2023	Drawn: D.H	Option: -	Rev: -	