

Notes:

1. Drawing must be used solely for the status indicated only
  2. All dimensions and setting out shall be checked and confirmed and any discrepancies to be reported to the Architect prior to commencement of any work.
  3. This is a CAD Drawing. Under no circumstances shall manual alterations be made. Figured dimensions take preference to scale.
  4. All work and materials to be in accordance with current statutory legislation, relevant codes of practice and British Standards.
  5. Drawing to be read in accordance with relevant consultants and sub-contractors drawings and specifications.
- Disclaimer:**  
The hard copy accompanying the electronic date is the legal. Copyright is Reserved.

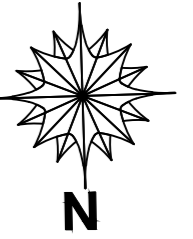

Copyright is Reserved.  
© Copying or reproduction of this drawing or any electronic data without the written permission of 'Seesaw Studios' is not permitted. All rights reserved.

ARCHITECTRUUE

dilekarchitectureart@gmail.com

Client: MR&MRS LION

Project:  
10 FEENAN ROAD  
RM18 8JJ

Drawing Title:  
Existing and Proposal Plan

Date: Drawing Status:

21.08.23 Building Regulations

Drawing Number: Revision

001 - A -

Scale: Drawn By:

50@A2 ED

Chimney removal to be confirm by Structure Engineer

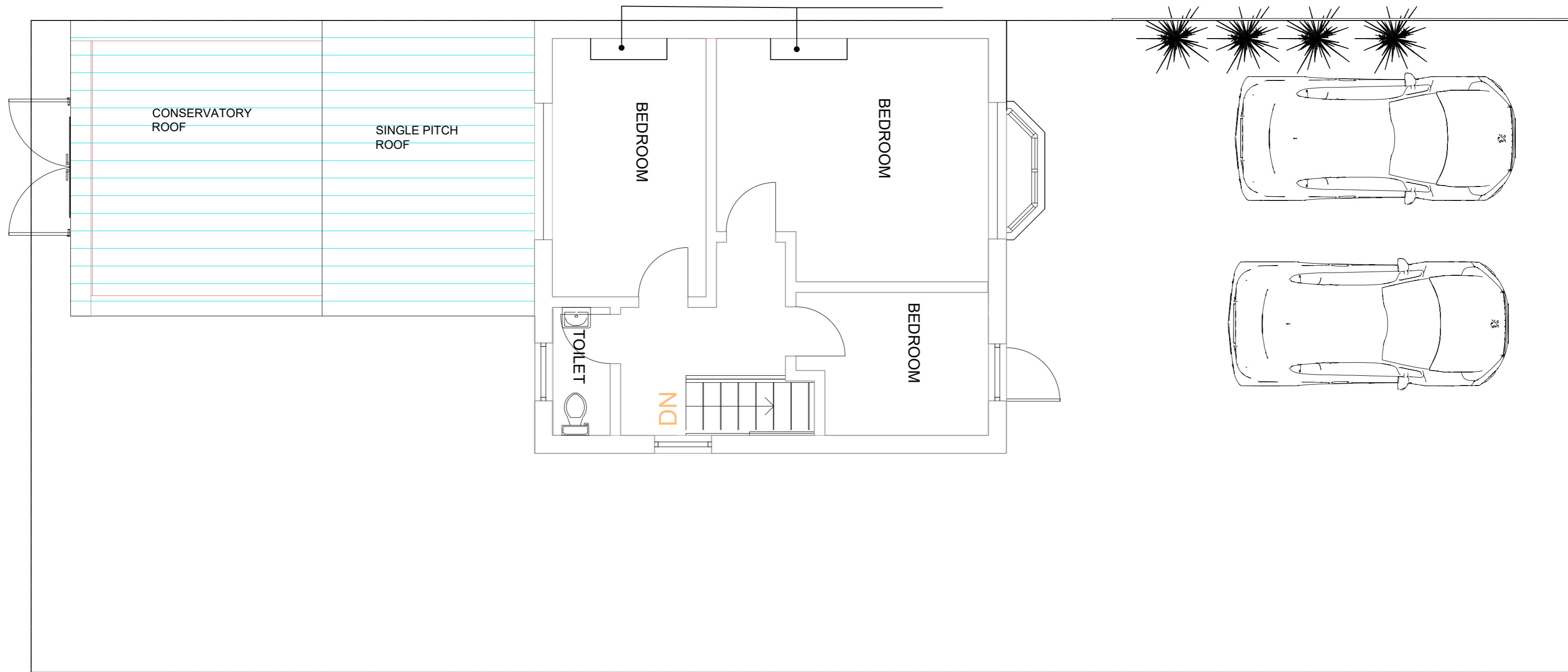

Existing First Floor Plan

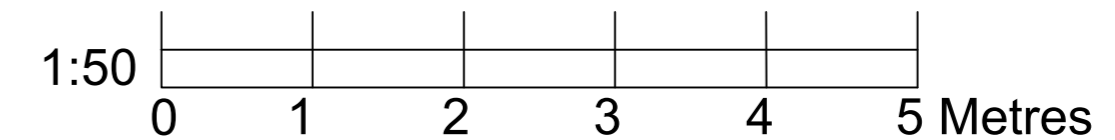

- KEY**
- Boundary line
  - <sub>rwp</sub> Rain water pipe
  - <sub>svp</sub> Soil vent pipe
  - ⊕ Heat detector
  - Ⓢ Smoke detector
  - ⊠ mechanical ventilation extract unit

- WALL / PARTITION TYPE KEY**
- Demolition (cross-hatched pattern)
  - Demolition (solid red line)
  - EXISTING WALL / PARTITION (solid black)
  - EW1 - External Wall (hatched pattern)
  - See drawing Ref No. SE 1579/B-20

- IW1 - 125mm stud partition
- 100x50mm treated SW timber stud work partition with:
- 1 layer of Gypsum Sound Block on each side studs at 600mm c/c or as specified by SE
- 25mm ISOVER between studs / MINERAL WOOL
- 30 mins FIRE RESISTANCE
- See Drawing Ref No. SE 1579/B-21

- IW2 - 125mm stud partition (WET ROOMS)
- 100x50mm treated SW timber stud work partition with:
- 1 layer of 12.5mm Gypsum Habito and skim on one side of stud
- 1 layer of 12.5mm Gyproc Moisture resistance and files on one side of stud
- 25mm ISOVER / MINERAL WOOL between studs
- 30 mins FIRE RESISTANCE
- NO SOCKETS
- See Drawing Ref No. SE 1579/B-21

- Demolition (cross-hatched pattern)
- Demolition (solid red line)
- <sub>svp</sub> Soil vent pipe
- Ⓢ Emergency light