

Approval of Details Reserved by Condition

Rev /.

06.12.2023

Location **Bury Farmhouse, Station Road, Essex, CM6 3EZ**

Reference: UTT/22/2638/FUL Date: 10th January 2023
 UTT/23/1247/FUL Date: 17th October 2023

Case Officer: Thomas Gabriel

Applicant: Mr and Mrs Peacock

Proposal: Proposed demolition of existing dwelling and other outbuildings and erection of 1 no. replacement dwelling and garage with associated works.

Condition 3 of UTT/23/1247/FUL

Prior to commencement of the development above slab level, hereby approved, a schedule of the types and colours of the materials to be used in the external finishes shall be submitted to and approved in writing by the local planning authority. Thereafter, the development shall be implemented strictly in accordance with the approved materials.

Bricks

Main building plinth and chimneys.



Imperial Bricks: Rosewater Blend, metric (215 x 102.5 x 65 mm)

Laying and pointing

Natural hydraulic lime mortar, NHL2.

*Light beige colour with pale and dark coloured larger aggregate particles.
Pointed full with brushed finish.*

Air bricks

Cast iron air bricks.



Cast Iron Air Brick Company: FLY6, 225 x 150 mm, flood screen; raw finish.

Lime render

Lime render.



Anglia Lime Company: thermalime with finelime topcoat.

External paint

Mineral paint (to lime render).

Keim Roaylan: Mineral Silicate Paint; warm cream.

Plain clay tiles

Plain clay roof tiles; half-round ridge tiles to main roofs and dormer roofs.



Lifestiles Limited: Woburn Clay Tiles, Reclamation Mix, 265 x 165 mm.

Half-round ridge tiles to match (vented and non-vented).

Roof vent terminators

Below-tile / in-tile roof ventilators.



*Tudor Roof Tile Co. Ltd:
Under-tile Invisible Vent.*



*Tudor Roof Tile Co. Ltd:
In-tile (hidden design)*

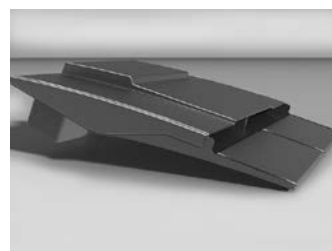

Roof

Oak sprockets, struts, bargeboards, and fascias.

Dormer cheeks and fronts

Lead, natural finish.

Roof windows

Roof windows.



Fakro GB Limited: Top-hung and centre-pivot, aluminium clad timber; factory painted, dark grey.

Windows

Hardwood casement windows (see typical manufacturer profiles on opposite page).

Timbertherm Windows Limited: hardwood casement windows; factory painted, dark grey.

- Hardwood mullions; natural finish / painted to match windows,
- Hardwood head drip; painted in with wall,
- Hardwood cill; factory painted, to match windows.

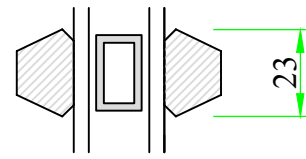
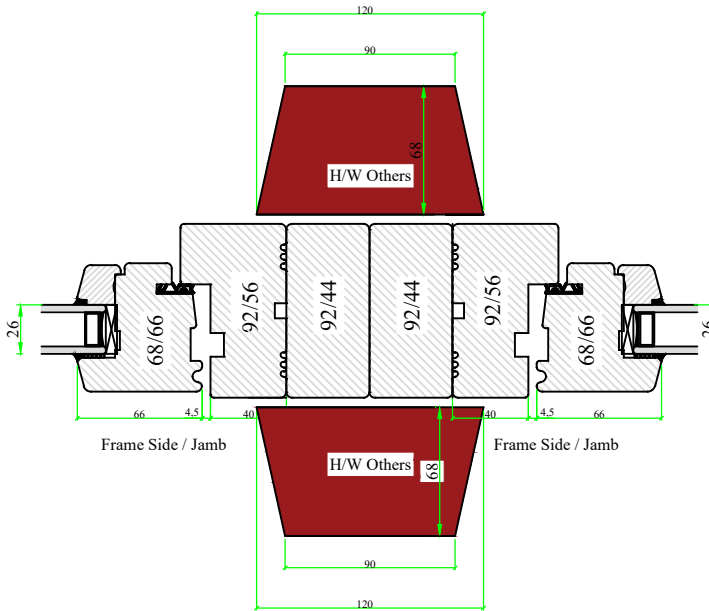

Glazing Bar

Frame Head

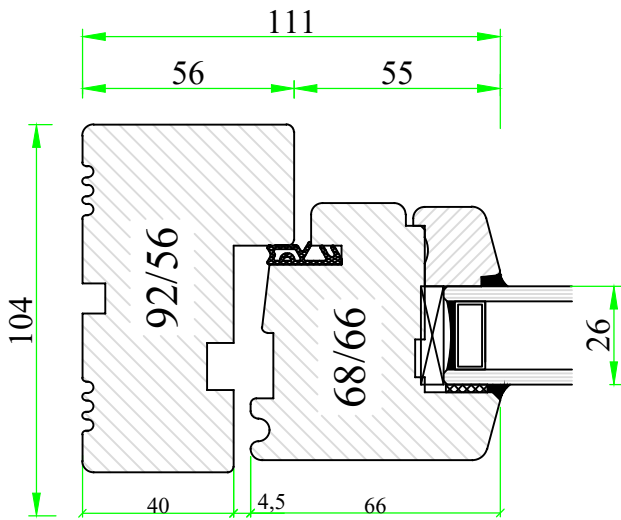

Frame Side / Jamb

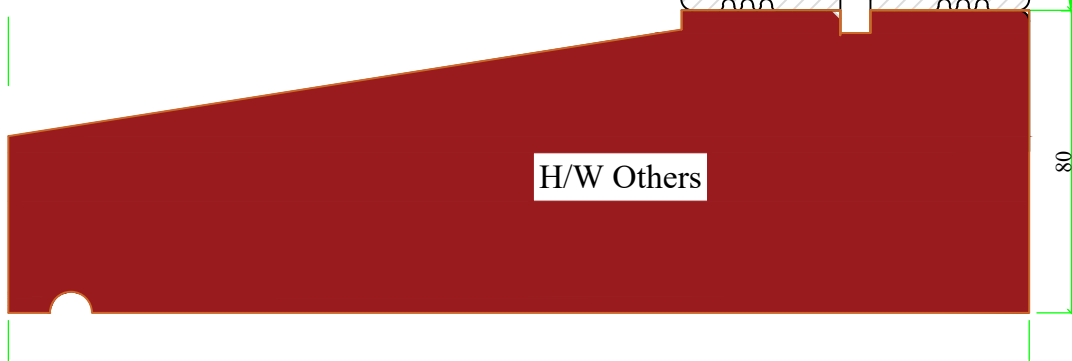
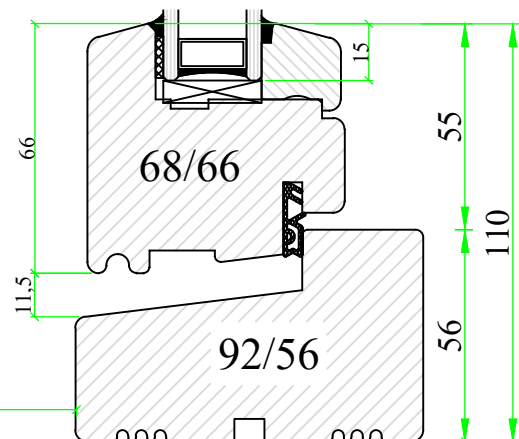
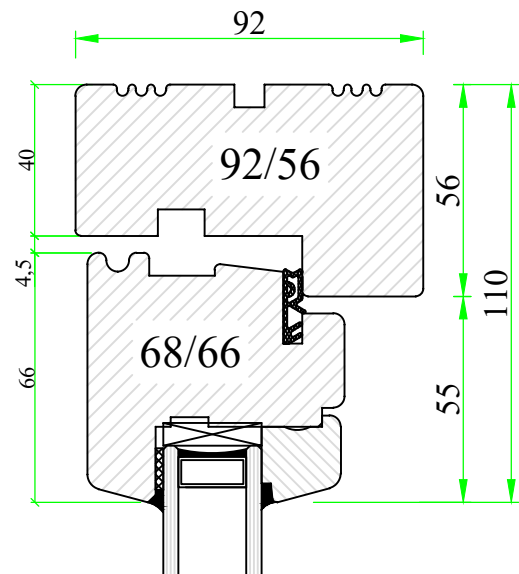

H/W Others

Doors

Doors to north elevation:

Timbertherm Windows Limited: hardwood doors, top-half glazed; factory painted, dark grey. See typical manufacturer profiles on opposite page.

- Hardwood mullions; natural finish / painted to match windows,
- Hardwood head drip; painted in with wall,
- Hardwood cill; factory painted, to match windows,
- Ironmongery, black finish.

Door to east elevation:

Timbertherm Windows Limited: hardwood door in a stable-door design, top-half glazed; factory painted, dark grey. See typical manufacturer profiles on opposite page.

- Hardwood mullions; natural finish / painted to match windows,
- Hardwood head drip; painted in with wall,
- Hardwood cill; factory painted, to match windows,
- Ironmongery, black finish.

Doors to south elevation:

25mm solid Oak vertical butted boards, screwed and plugged to outer and inner face of core panel. Eastern door (ED02) to have double-glazed, fixed oval light.

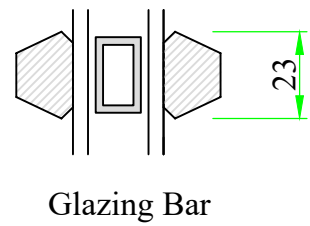
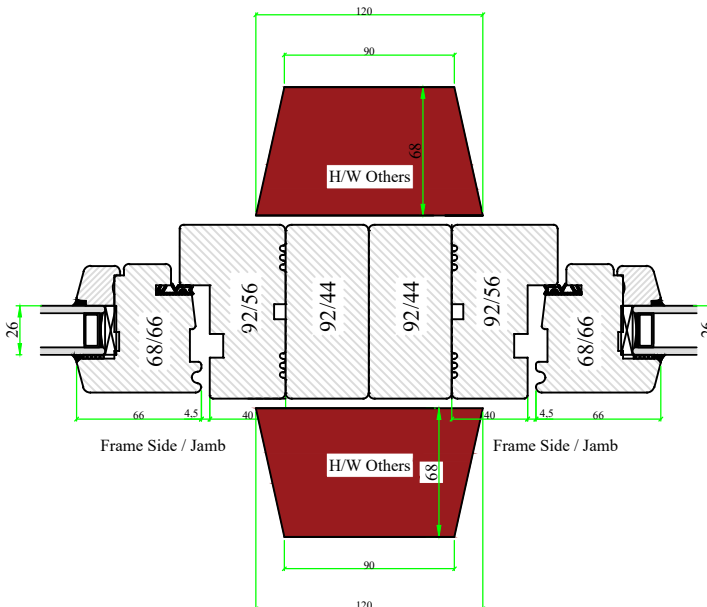
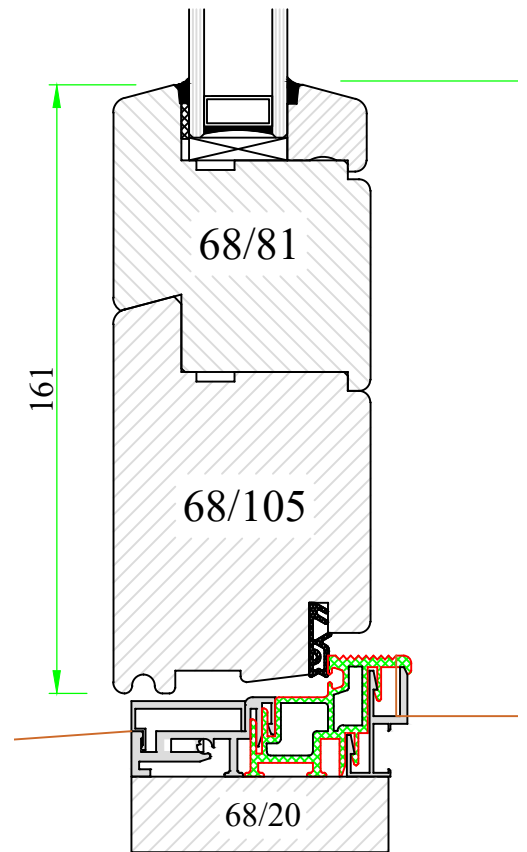
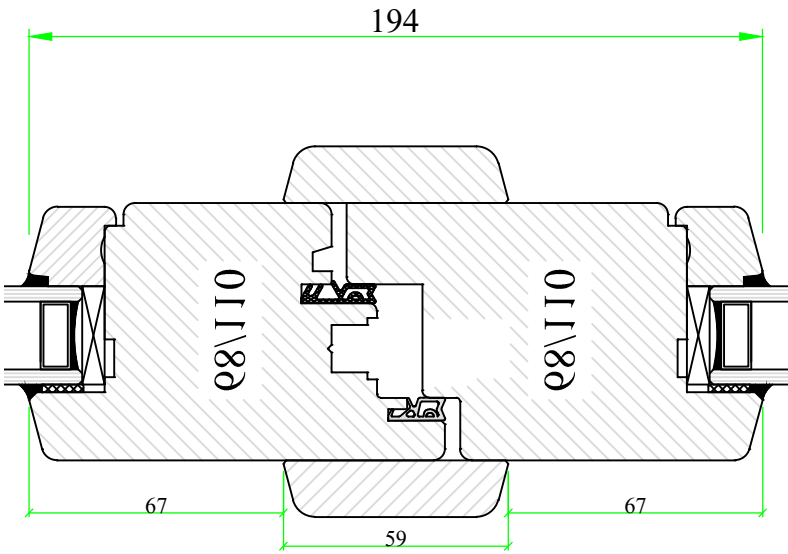
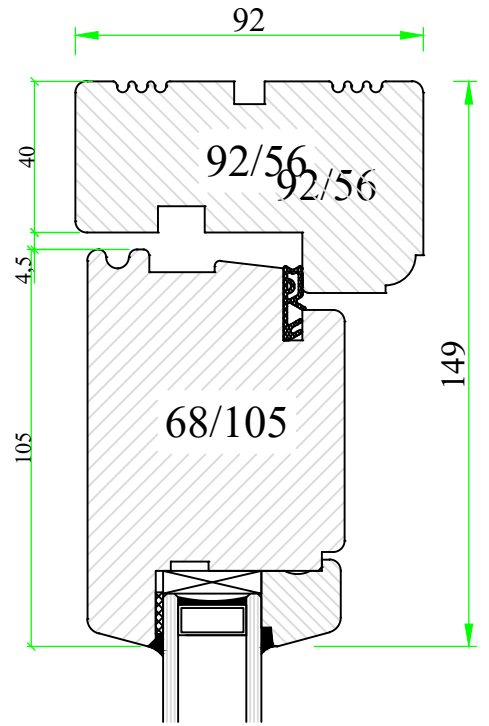
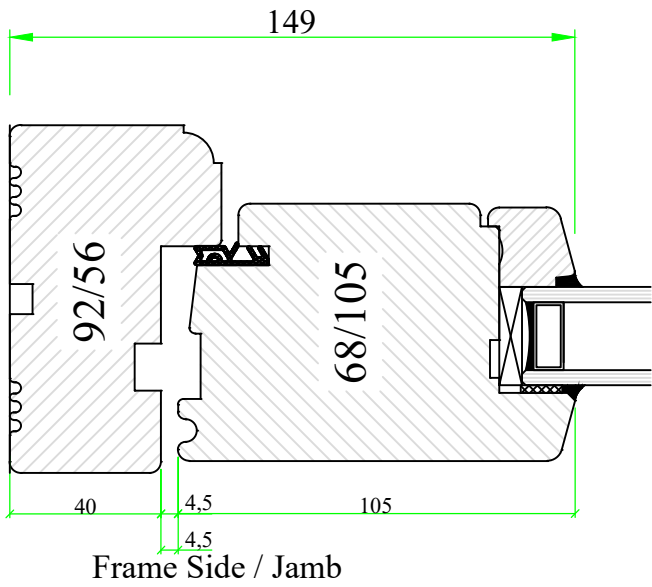

External Door thresholds

Stone threshold.

Stoke Ground Base bed, or similar.

Surface water goods

Gutters.

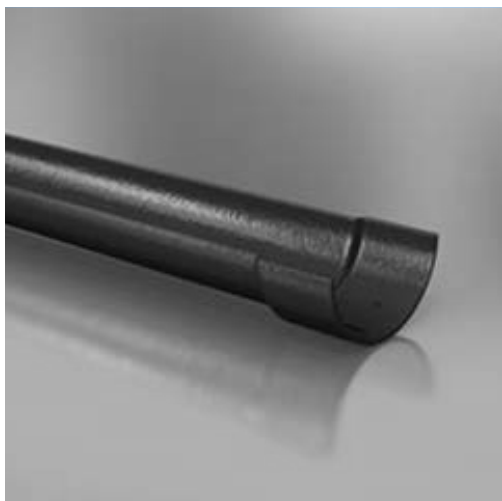

Alumasc Water Management Solutions, Heritage half-round, cast aluminium; painted dark grey.

Fittings: union clips, stop ends, outlets, side-fix rafter arms; painted to match gutters.

Downpipes.



Alumasc Water Management Solutions, Heritage Circular, cast aluminium; painted dark grey.

Fittings: offsets and clips; painted to match gutters.

Rainwater gullys.



Clay Access Gully with Cast Iron Grid.



Channel drains and gratings.



ACO Technologies PLC, Threshold Drain, with Cor Ten or Cast Iron grating.



ACO Technologies PLC, MiniKlassik / Klassik Drain, with Cast Iron grating.

Foul water goods

Inspection Chambers and Rodding Eye covers.



Ductile Iron covers and frames.

Chimney pots

Chimney Pots.



*Forterra Building Products Ltd:
List No. 1 Roll Top Pot, clay, 250mm (dia.) x 600 (h) mm.*



*Forterra Building Products Ltd:
List No. 116 Weatherguard Top, clay, 275mm (hood dia.) x 105 (h, exc. spigot) mm.*

Front Cartlodge

Brick plinth.



Imperial Bricks: Rosewater Blend, metric (215 x 102.5 x 65 mm).

Laying and pointing: natural hydraulic lime mortar, NHL2.

Light beige colour with pale and dark coloured larger aggregate particles. Pointed full with brushed finish.

Roof.



Lifestiles Limited: Chatsworth Slate, Spanish blue-black 500 x 250mm.

UK Slate: Clay Capped 90° Angle Ridge; Slate Black.

Oak fascias.

Walls.



Oak frame with Oak weatherboarding; 150mm, natural finish.

Doors.

25mm x 150mm solid Oak butted boards, screwed and plugged to timber frame (ledged and braced).

Ironmongery, black finish.

Surface water goods.

As main building, to match in design, finish, and colour.